

SERVICE MANUAL

**DATSUN
PICK-UP**

MODEL 520 SERIES



NISSAN MOTOR CO., LTD.



BODY

NISSAN MOTOR CO., LTD.

BODY

BODY

Disconnectig & Fixing

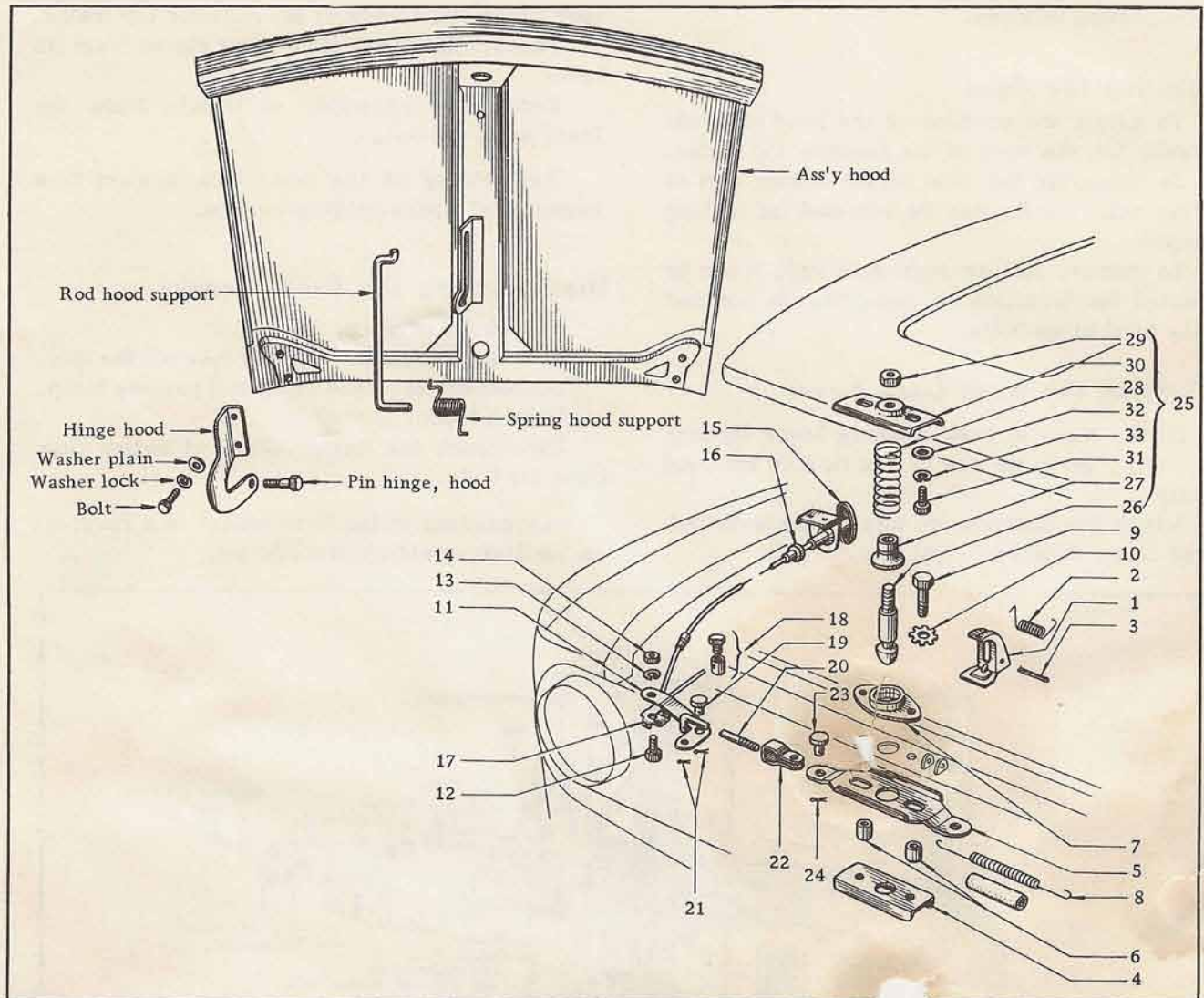

Hood Lock

1	Hood-safety catch	12	Bolt	23	Pin-lever, hood lock
2	Spring-safety catch hook	13	Washer-lock	24	Pin-cotter
3	Pin-cotter	14	Nut	25	Ass'y-lock, hood male
4	Ass'y-body, hood lock	15	Ass'y-cable, hood control handle	26	Bolt-hood lock, dovetail
5	Lever-hood lock	16	Gum-insulation, cowl	27	Retainer-lift spring
6	Collar-lever, fix bolt	17	Clip-wire, hood lock control	28	Spring-hood lock lift
7	Plate-dovetail bolt guide	18	Comp.-clamp, cable	29	Nut
8	Spring-hood lock lever	19	Rivet-bell crank, hood lock	30	Ass'y-seat, dovetail bolt
9	Bolt	20	Rod-hood lock to bell crank	31	Bolt
10	Washer-lock	21	Pin-cotter	32	Washer-plain
11	Bell crank-hood lock	22	Clamp-lever, hood lock	33	Washer-lock

DATSUN PICK-UP

Hood

To completely remove the hood, detach the bolts of hinges at left and right side.

Assembling of the hood is a reversal of disconnecting process.

Adjusting the Hood

To adjust the position of the hood lock bolt dovetail for the hole of the radiator top frame.

By removing the nuts of the center bolt of spring unit, spring can be adjusted for locking position.

To remove left or right side way, it can be adjusted the direction by removing the position of the hood hinge bolts.

Adjusting the Hood Lock Lever

In the case of hook working loose through the lever, the hood lock cannot be hold the hood tightly.

Adjust the position by turning the hood lock lever clamp to left or right way.

Disassembling of the Hood Lock

Detach the grille of radiator from the front of body.

Disconnect the return spring of the hood lock lever from back of the radiator top frame.

Remove the hood lock lever clamp from its lever.

Detach the assembly of female from the front panel of hood.

Assembling of the hood lock system is a reversal of disassembling routine.

Disconnecting the Front Fender

Detach the bumper.

Jack up the front wheel and take off the tire.

Disconnect the head lamp and parking lamp.

Detach fender mirror.

Disconnect the fixing bolts and screw nuts from the body.

Assembling of the front fender is a reversal of the disassembling procedures.

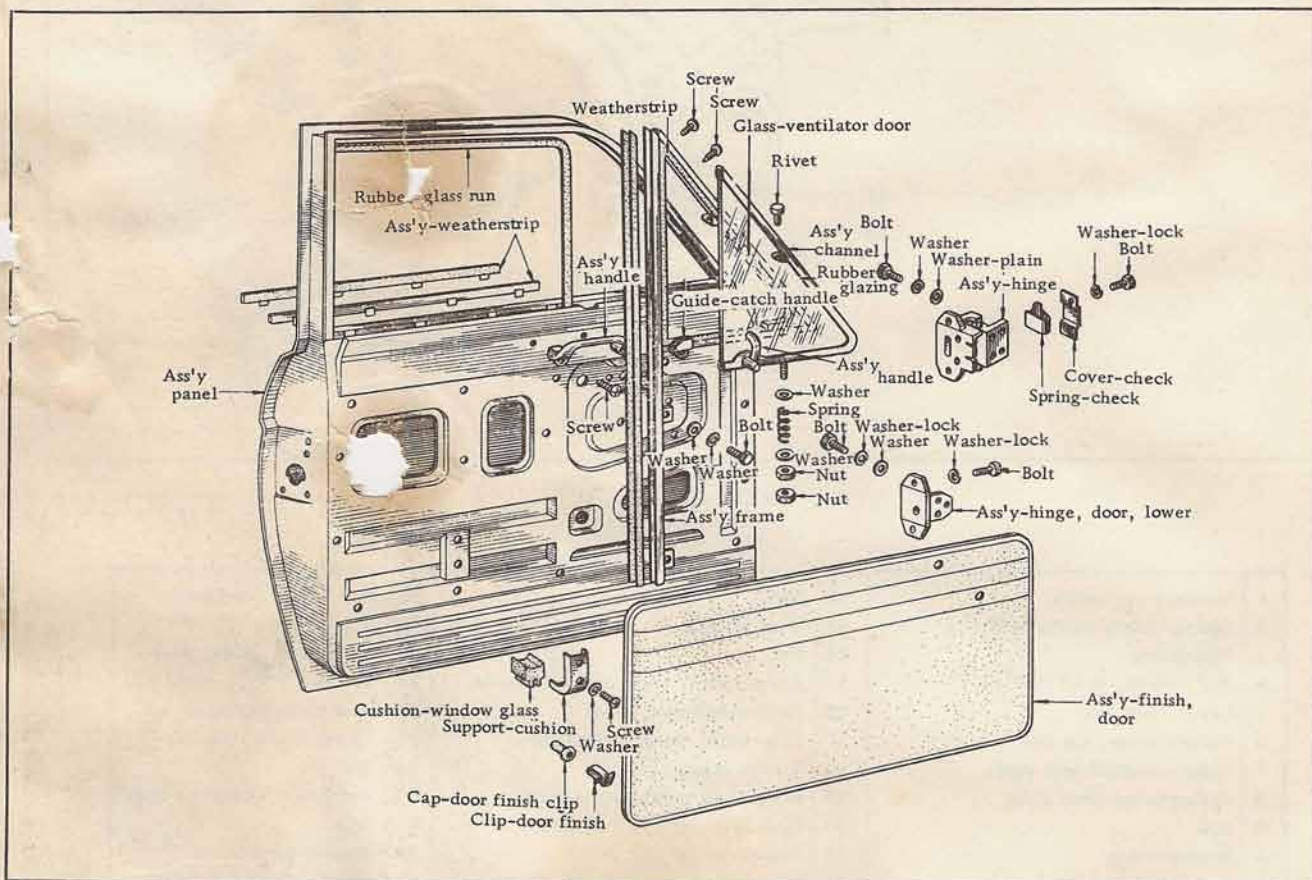

Door Trim Panel

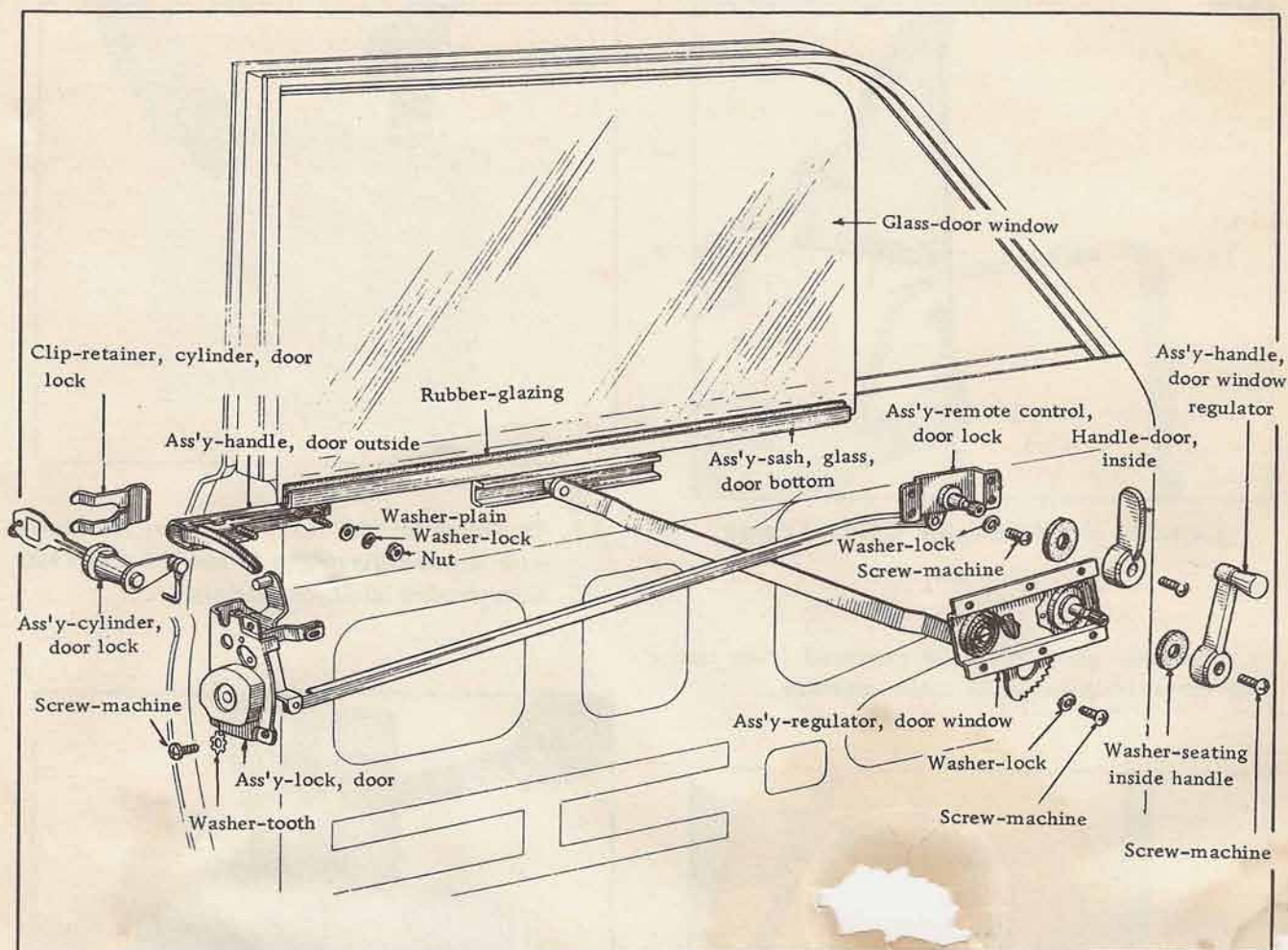

Constructure of Door

Disassembly

- 1) Take out the door inside handle and window regulator handle.
- 2) Take off the weatherstrip.
- 3) Remove clips the door finish plate from inside of door by screwdriver.

Assembling of the door trim is a reversal of the disassembling procedure.

Removal of Door Glass

Take off the door trim and strip the vinyl cover on the operation hole.

Loosing the screws, remove the door regulator.



Detaching Door Regulator



Remove the Ventilator Glass Frame

The door glass must be removed from the door upwards through the main aperture.



Remove the Glass

Removing the front door glass from the bezel of channel

1. Remove the glass of channel by tapping slightly with wooden hammer.

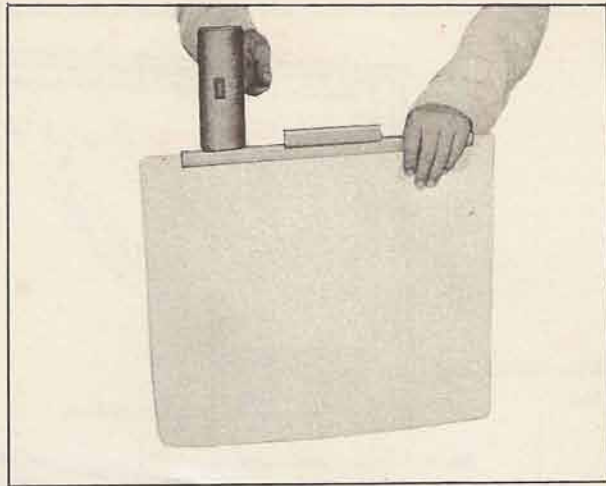

2. To fixing for the channel, insert the glass with the weatherstrip in the bezel and tap with wooden hammer slightly.

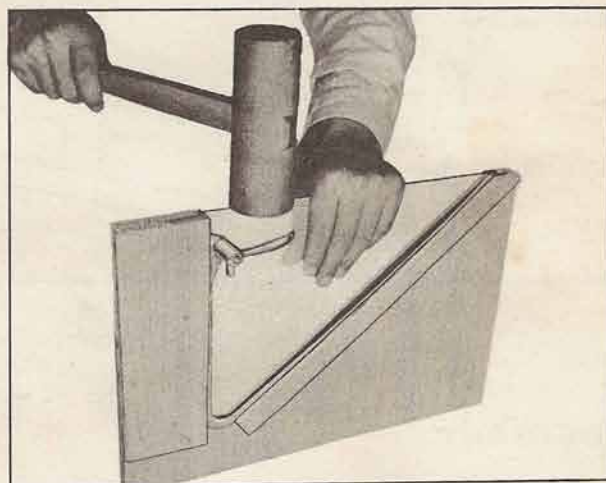

- (1) Remove the nut of pivot pin and the spring.
- (2) Detach the rivet and then remove the ventilator window.
- (3) Take off the lock of ventilator.
- (4) Change the glass as same as the method of the front glass replacement.

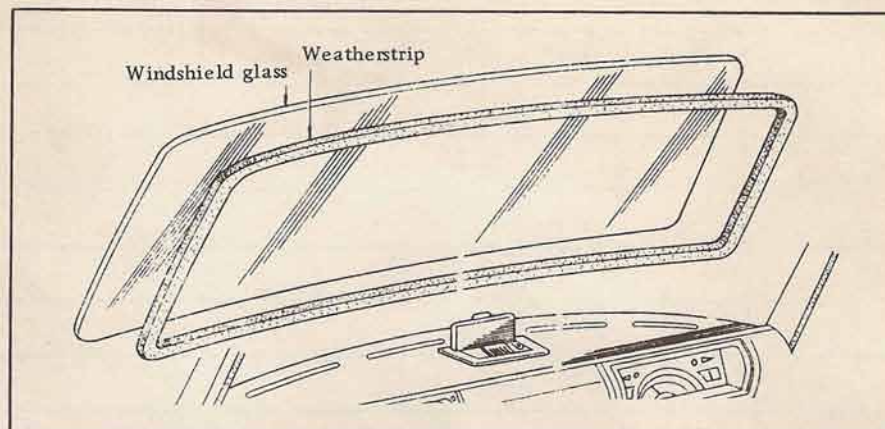

Disconnecting of Windshield

- Take off the wiper arm of windshield.
- Remove the outside moulding of windshield.
- Separate weatherstrip from frame of body with a spatula at the outside and inside.
- Disconnect the front windglass from frame of body.

Fixing the Windshield Glass with Weatherstrip

Assembling the weatherstrip with sealing material (Cemedine) to the windshield glass around, insert the strong cotton rope or cord in pinch of rubber channel completely windshield around

The ends of it put to inside surface of glass at bottom center of it.

Insert the above prepared windshield glass with weatherstrip to the frame of the front body where the bezel is to fit.

Set the window to the aperture frame of the car from the outside and whilst one operator maintains pressure on the glass the operator on the inside of the car should peel out the cord of the inner lip which fits over the aperture frame.

The outside operator then arrange the outer edge which will bring the outer rubber lip over the scuttle, side and top window frame. Finally peel out the cord so that the rubber lip settles over the side fillets and heading.

Pushing the front windglass assembly into the frame of it, assemble the glass as pushed in cotton string to a right angle slowly.

Filling up the sealing material (Cemedine 366E) between the weatherstrip and frame of body.

Clean and wipe off the excess sealing material around the weatherstrip by a spatula.

DATSUN PICK-UP

