A

SECTION ACC

ACC

ACCELERATOR CONTROL SYSTEM

C

CONTENTS

D

PRECAUTION 2	Exploded View 3	F
PRECAUTIONS 2	Removal and Installation 3	
Precaution for Supplemental Restraint System (SRS) "AIR BAG" and "SEAT BELT PRE-TENSIONER" 2	SERVICE DATA AND SPECIFICATIONS (SDS) 5	G
REMOVAL AND INSTALLATION 3	SERVICE DATA AND SPECIFICATIONS (SDS) 5	H
ACCELERATOR CONTROL SYSTEM 3	Accelerator Control 5	I

J

K

L

M

N

O

P

PRECAUTIONS

< PRECAUTION >

PRECAUTION

PRECAUTIONS

Precaution for Supplemental Restraint System (SRS) "AIR BAG" and "SEAT BELT PRE-TENSIONER"

INFOID:000000011097195

The Supplemental Restraint System such as "AIR BAG" and "SEAT BELT PRE-TENSIONER", used along with a front seat belt, helps to reduce the risk or severity of injury to the driver and front passenger for certain types of collision. Information necessary to service the system safely is included in the SR and SB section of this Service Manual.

WARNING:

- To avoid rendering the SRS inoperative, which could increase the risk of personal injury or death in the event of a collision which would result in air bag inflation, all maintenance must be performed by an authorized NISSAN/INFINITI dealer.
- Improper maintenance, including incorrect removal and installation of the SRS, can lead to personal injury caused by unintentional activation of the system. For removal of Spiral Cable and Air Bag Module, see the SR section.
- Do not use electrical test equipment on any circuit related to the SRS unless instructed to in this Service Manual. SRS wiring harnesses can be identified by yellow and/or orange harnesses or harness connectors.

PRECAUTIONS WHEN USING POWER TOOLS (AIR OR ELECTRIC) AND HAMMERS

WARNING:

- When working near the Airbag Diagnosis Sensor Unit or other Airbag System sensors with the Ignition ON or engine running, DO NOT use air or electric power tools or strike near the sensor(s) with a hammer. Heavy vibration could activate the sensor(s) and deploy the air bag(s), possibly causing serious injury.
- When using air or electric power tools or hammers, always switch the Ignition OFF, disconnect the battery and wait at least three minutes before performing any service.

ACCELERATOR CONTROL SYSTEM

< REMOVAL AND INSTALLATION >

REMOVAL AND INSTALLATION

ACCELERATOR CONTROL SYSTEM

Exploded View

INFOID:0000000010484177

ACC

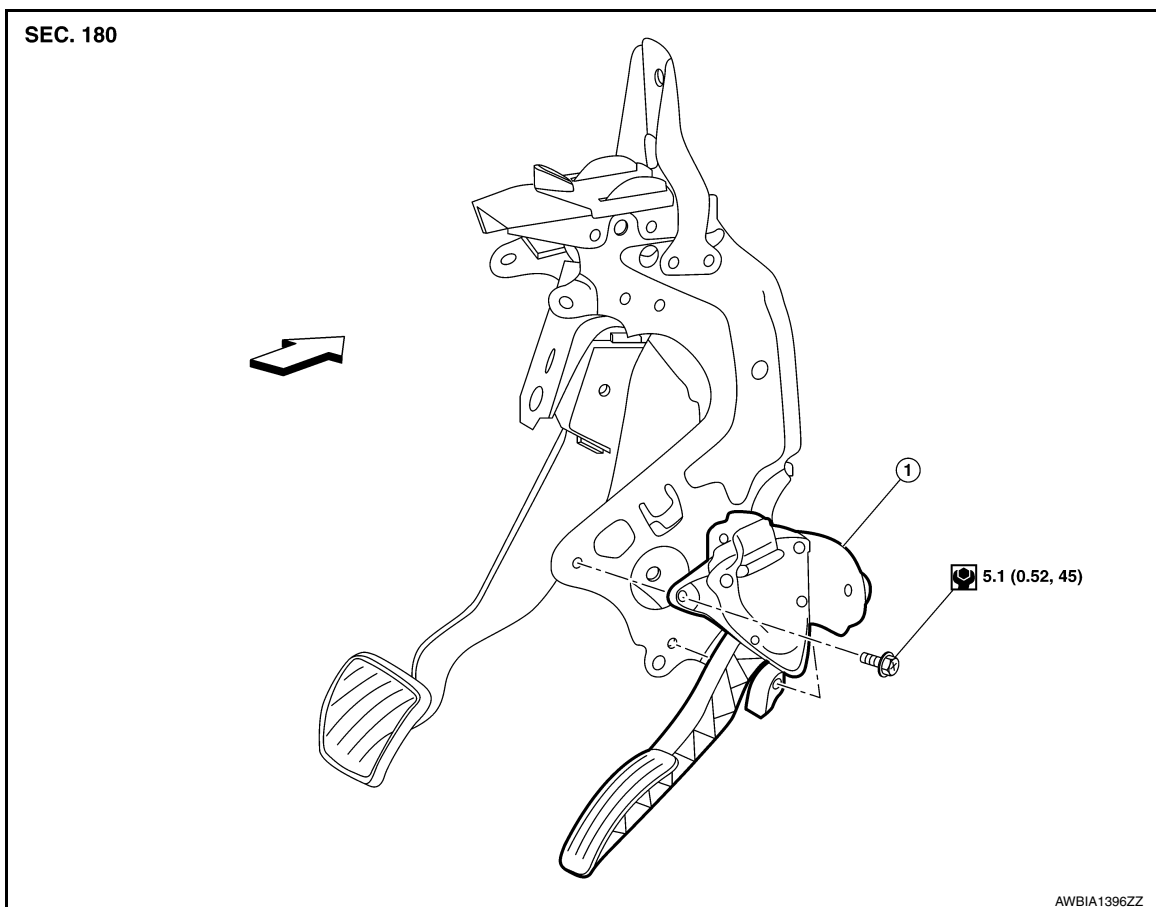

1. Accelerator pedal assembly

← Front

Removal and Installation

INFOID:0000000010484178

REMOVAL

1. Disconnect the harness connector from accelerator pedal assembly.
2. Remove the two accelerator pedal bolts.
3. Remove the accelerator pedal assembly.

CAUTION:

- Do not disassemble the accelerator pedal assembly.
- Do not drop or impact the accelerator pedal assembly.
- Do not expose the accelerator pedal assembly to water.

INSTALLATION

Installation is in the reverse order of removal.

ACCELERATOR CONTROL SYSTEM

< REMOVAL AND INSTALLATION >

- Check the accelerator pedal moves smooth within the specified range.

Accelerator pedal stroke (A) : Refer to [ACC-5, "Accelerator Control"](#).

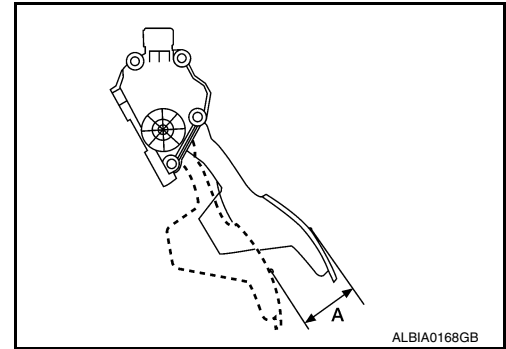

CAUTION:

- Whenever the harness connector of the accelerator pedal position sensor is disconnected, perform the "Accelerator pedal released position learning". Refer to [EC-178, "Work Procedure"](#) (QR25DE) or [EC-692, "Work Procedure"](#) (VQ35DE).
- The accelerator pedal should return smoothly to the fully raised position.

SERVICE DATA AND SPECIFICATIONS (SDS)

< SERVICE DATA AND SPECIFICATIONS (SDS)

SERVICE DATA AND SPECIFICATIONS (SDS)

SERVICE DATA AND SPECIFICATIONS (SDS)

Accelerator Control

INFOID:0000000010484179

A

ACC

Unit: mm (in)

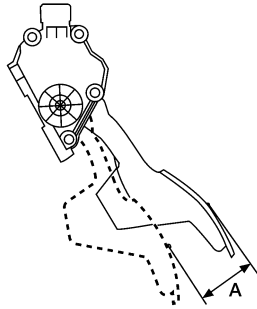

ALBIA0168GB

Accelerator pedal stroke (A)

50.5 - 53.5 (1.99 - 2.11)

C

D

E

F

G

H

I

J

K

L

M

N

O

P