

SECTION

LU

ENGINE LUBRICATION SYSTEM

CONTENTS

QR25DE	SERVICE DATA AND SPECIFICATIONS	
PRECAUTION	(SDS)	19
PRECAUTIONS	SERVICE DATA AND SPECIFICATIONS	
Precaution for Supplemental Restraint System	(SDS)	19
(SRS) "AIR BAG" and "SEAT BELT PRE-TENSIONER"	Oil Pressure	19
Precaution for Liquid Gasket	Oil Pump	19
	Regulator Valve	19
	Oil Capacity	19
PREPARATION	VQ35DE	
	PRECAUTION	20
PREPARATION	PRECAUTIONS	20
Special Service Tools	Precaution for Supplemental Restraint System	
Commercial Service Tools	(SRS) "AIR BAG" and "SEAT BELT PRE-TENSIONER"	20
	Precaution for Liquid Gasket	20
SYSTEM DESCRIPTION	PREPARATION	22
LUBRICATION SYSTEM	PREPARATION	22
Lubrication Circuit	Special Service Tools	22
Schematic	Commercial Service Tools	22
PERIODIC MAINTENANCE	SYSTEM DESCRIPTION	24
ENGINE OIL	LUBRICATION SYSTEM	24
Inspection	Lubrication Circuit	24
Changing Engine Oil	Schematic	25
	PERIODIC MAINTENANCE	26
OIL FILTER	ENGINE OIL	26
Removal and Installation	Inspection	26
	Changing Engine Oil	27
REMOVAL AND INSTALLATION	OIL FILTER	28
OIL PUMP	Removal and Installation	28
Exploded View	REMOVAL AND INSTALLATION	30
Removal and Installation		
Disassembly and Assembly		
Inspection		
OIL COOLER		
Exploded View		
Removal and Installation		
Inspection		

OIL PUMP	30	SERVICE DATA AND SPECIFICATIONS	
Exploded View	30	(SDS)	35
Removal and Installation	30		
Disassembly and Assembly	30	SERVICE DATA AND SPECIFICATIONS	
Inspection	31	(SDS)	35
OIL COOLER	33	Oil Pressure	35
Exploded View	33	Oil Pump	35
Removal and Installation	33	Regulator Valve	35
		Oil Capacity	35

PRECAUTION

PRECAUTIONS

Precaution for Supplemental Restraint System (SRS) "AIR BAG" and "SEAT BELT PRE-TENSIONER"

INFOID:000000010483205

The Supplemental Restraint System such as "AIR BAG" and "SEAT BELT PRE-TENSIONER", used along with a front seat belt, helps to reduce the risk or severity of injury to the driver and front passenger for certain types of collision. Information necessary to service the system safely is included in the SR and SB section of this Service Manual.

WARNING:

- To avoid rendering the SRS inoperative, which could increase the risk of personal injury or death in the event of a collision which would result in air bag inflation, all maintenance must be performed by an authorized NISSAN/INFINITI dealer.
- Improper maintenance, including incorrect removal and installation of the SRS, can lead to personal injury caused by unintentional activation of the system. For removal of Spiral Cable and Air Bag Module, see the SR section.
- Do not use electrical test equipment on any circuit related to the SRS unless instructed to in this Service Manual. SRS wiring harnesses can be identified by yellow and/or orange harnesses or harness connectors.

PRECAUTIONS WHEN USING POWER TOOLS (AIR OR ELECTRIC) AND HAMMERS

WARNING:

- When working near the Airbag Diagnosis Sensor Unit or other Airbag System sensors with the Ignition ON or engine running, DO NOT use air or electric power tools or strike near the sensor(s) with a hammer. Heavy vibration could activate the sensor(s) and deploy the air bag(s), possibly causing serious injury.
- When using air or electric power tools or hammers, always switch the Ignition OFF, disconnect the battery and wait at least three minutes before performing any service.

Precaution for Liquid Gasket

INFOID:0000000011097192

REMOVAL OF LIQUID GASKET SEALING

- After removing the bolts and nuts, separate the mating surface and remove the liquid gasket using Tool (A).

Tool Number : KV10111100 (J-37228)

CAUTION:

Be careful not to damage the mating surfaces.

- In areas where the cutter is difficult to use, use a plastic hammer to lightly tap (1) the cutter where the liquid gasket is applied. Use a plastic hammer to slide (2) the cutter by tapping on the side.

CAUTION:

Do not damage the mating surfaces.

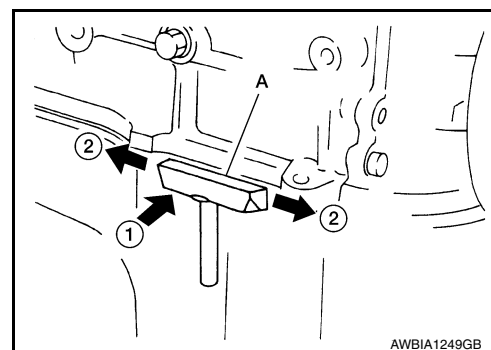

AWBIA1249GB

LIQUID GASKET APPLICATION PROCEDURE

1. Using suitable tool (A), remove old liquid gasket adhering to the liquid gasket application surface and the mating surface.
 - Remove liquid gasket completely from the groove of the liquid gasket application surface, mounting bolts, and bolt holes.
2. Thoroughly clean the mating surfaces and remove adhering moisture, grease and foreign materials.

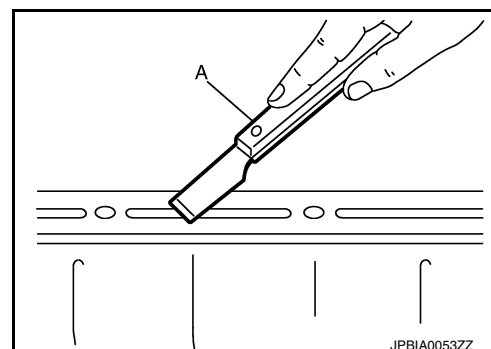

JPBIA0053ZZ

PRECAUTIONS

[QR25DE]

< PRECAUTION >

3. Attach liquid gasket tube to the suitable tool.
Use Genuine Silicone RTV Sealant, or equivalent. Refer to [GI-21, "Recommended Chemical Products and Sealants"](#).
4. Apply liquid gasket without gaps to the specified location according to the specified dimensions.
 - If there is a groove for liquid gasket application, apply liquid gasket to the groove.

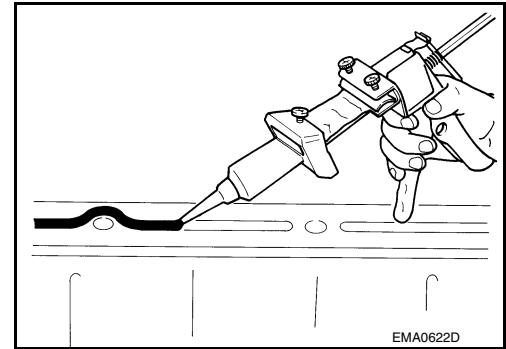

- As for bolt holes (B), normally apply liquid gasket inside the holes. Occasionally, it should be applied outside the holes. Check to read the text of this manual.

(A) : Groove

⇐ : Inside

- Within five minutes of liquid gasket application, install the mating component.
- If liquid gasket protrudes, wipe it off immediately.
- Do not retighten mounting bolts or nuts after the installation.
- After 30 minutes or more have passed from the installation, fill engine oil and engine coolant. Refer to [LU-10, "Changing Engine Oil"](#) and [CO-10, "Changing Engine Coolant"](#).

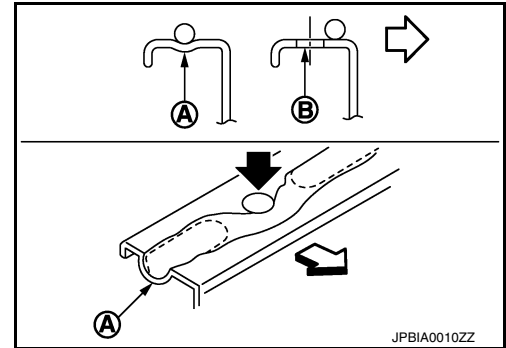

CAUTION:

If there are more specific instructions in the procedures contained in this manual concerning liquid gasket application, observe them.

PREPARATION

< PREPARATION >

[QR25DE]

PREPARATION

PREPARATION

Special Service Tools

INFOID:0000000011103036

The actual shape of the tools may differ from those illustrated here.

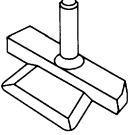
Tool number (TechMate No.) Tool name	Description
KV10111100 (J-37228) Seal cutter	Removing oil pan (lower) etc.
 NT046	

Commercial Service Tools

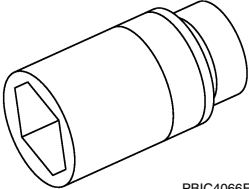
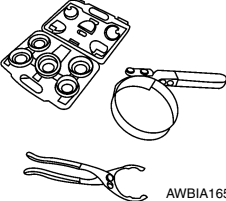
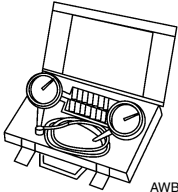

INFOID:0000000011103037

Tool name	Description
Deep socket	Removing and installing oil pressure sensor 27 mm (1.06 in)
 PBIC4066E	
— (223-50000) Oil filter wrench assortment	Removing oil filter
 AWBIA1656ZZ	
— (16-5610) Oil pressure kit	Measuring oil pressure. Comes with adapter and hose. Designed to be used for both static and on road testing.
 AWBIA1657ZZ	

PREPARATION

< PREPARATION >

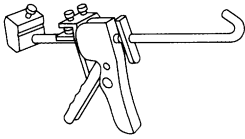
[QR25DE]

Tool name	Description
Tube presser  NT052	Pressing the tube of liquid gasket
Power tool  PIIB1407E	Loosening nuts, screws and bolts

SYSTEM DESCRIPTION

LUBRICATION SYSTEM

Lubrication Circuit

INFOID:0000000010483209

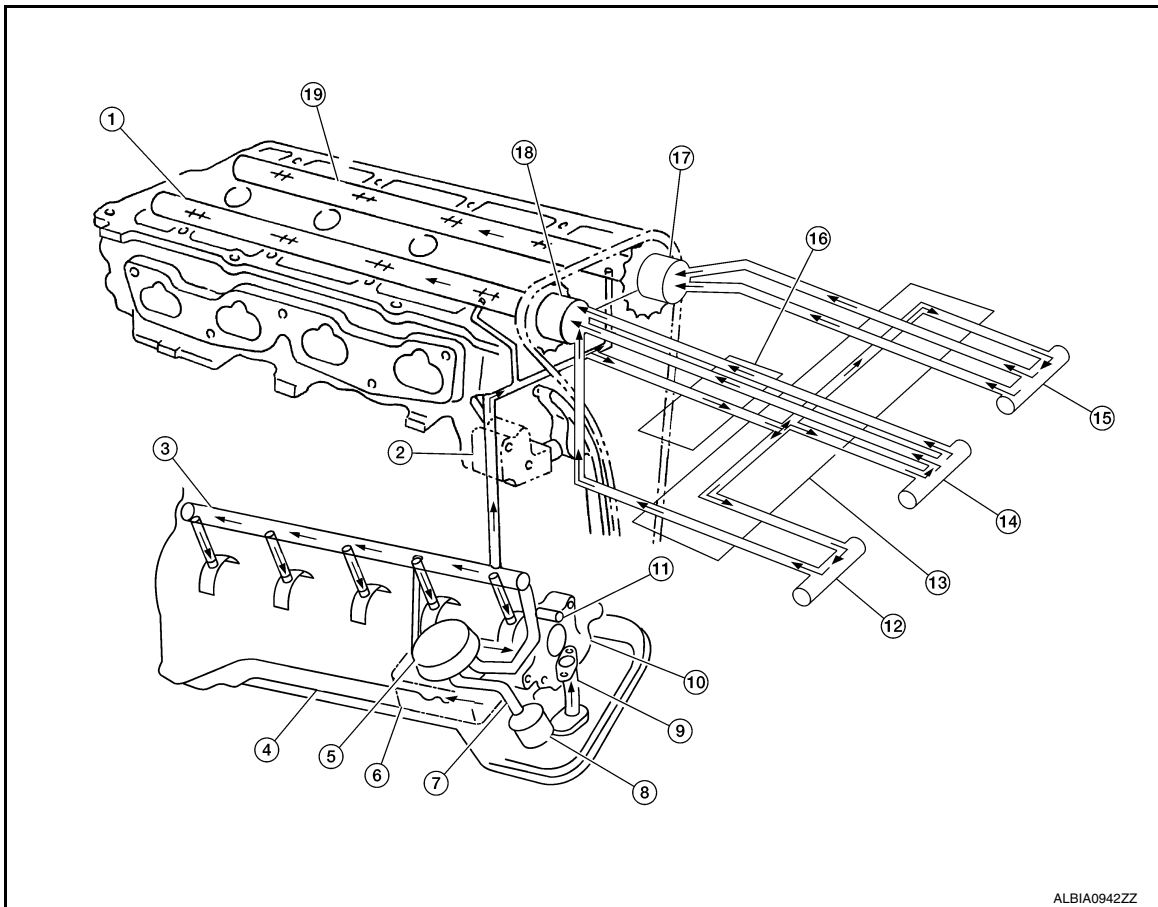

- | | | |
|---------------------------------------|---|--|
| 1. Camshaft (INT) | 2. Chain tensioner | 3. Main gallery |
| 4. Oil pan | 5. Oil cooler | 6. Balancer unit |
| 7. Oil pan oil gallery | 8. Oil filter (with relief valve) | 9. Oil Strainer |
| 10. Oil pump | 11. Timing chain and balancer unit timing chain oil jet | 12. Intake valve timing intermediate lock-control solenoid valve |
| 13. Intake valve timing control cover | 14. Intake valve timing control solenoid valve | 15. Exhaust valve timing control solenoid valve |
| 16. Front cover | 17. Exhaust valve timing controller | 18. Intake valve timing controller |
| 19. Camshaft (EXH) | | |

LUBRICATION SYSTEM

< SYSTEM DESCRIPTION >

[QR25DE]

Schematic

INFOID:000000010483210

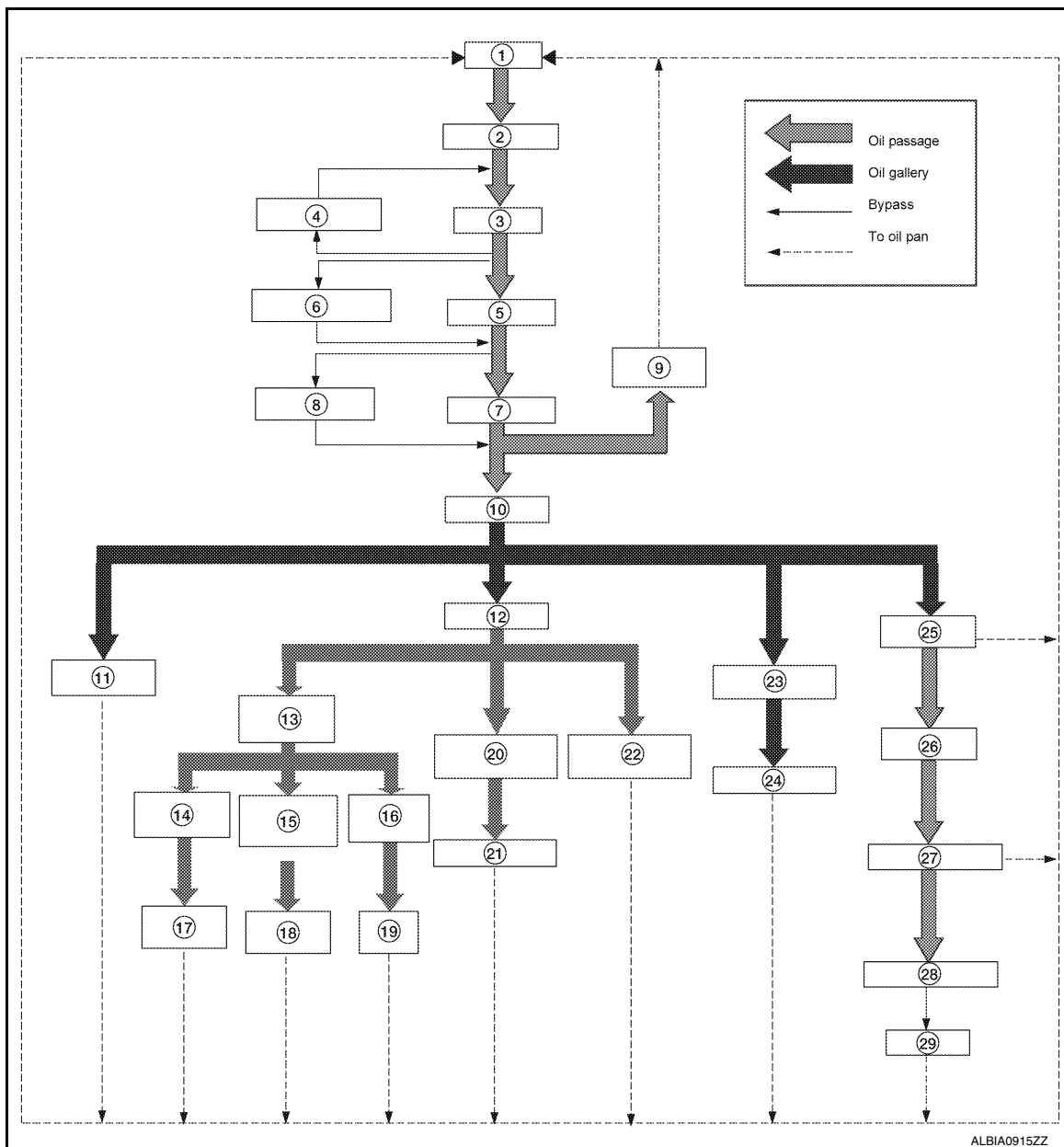

- | | | |
|---|--|--|
| 1. Oil pan | 2. Oil strainer | 3. Oil pump |
| 4. Regulator valve | 5. Oil filter | 6. Relief valve (Built in oil filter) |
| 7. Oil cooler | 8. Relief valve | 9. Chain oil jet |
| 10. Main gallery | 11. Piston oil jet | 12. Cylinder head |
| 13. Oil filter | 14. Intake valve timing intermediate lock control solenoid valve | 15. Intake valve timing control solenoid valve |
| 16. Exhaust valve timing control solenoid valve | 17. C-VTC intermediate | 18. C-VTC intake |
| 19. C-VTC exhaust | 20. Camshaft journal | 21. Camshaft |
| 22. Chain tensioner | 23. Balancer housing | 24. Balancershaft journal |
| 25. Main bearing | 26. Crankshaft | 27. Connecting rod bearing |
| 28. Connecting rod | 29. Piston | |

PERIODIC MAINTENANCE

ENGINE OIL

Inspection

INFOID:0000000011103053

LU

OIL LEVEL

- Before starting the engine, check the oil level. If the engine is already started, stop it and allow 10 minutes before checking.
- Check that the oil level is within the range (A) as shown.
- If it is out of range, adjust it.

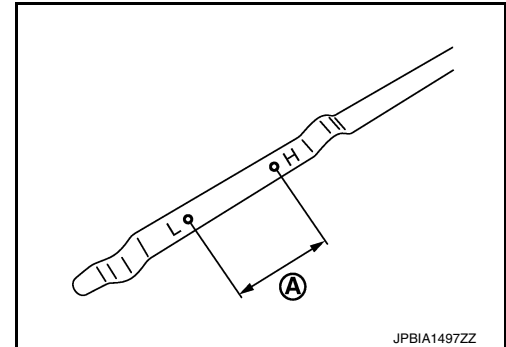

ENGINE OIL APPEARANCE

- Check engine oil for white milky appearance or excessive contamination.
- If engine oil becomes milky, it is highly probable that it is contaminated with engine coolant. Repair or replace damaged parts.

OIL LEAKS

Check for oil leaks around the following areas:

- Oil cooler
- Oil level gauge assembly O-ring
- Crankshaft position sensor
- Oil temperature sensor
- Camshaft position sensors
- Oil pan (upper and lower)
- Oil pan drain plug
- Oil pressure switch
- Oil filter
- Oil cooler
- Valve timing control cover and valve timing control solenoid valve
- Front cover
- Mating surface between cylinder block and cylinder head
- Mating surface between cylinder head and rocker cover
- Crankshaft oil seal (front and rear)
- Mating surface between cylinder block and lower cylinder block

OIL PRESSURE CHECK

WARNING:

- **Be careful not to burn yourself, as engine oil may be hot.**
- **Put shift selector in the Park "P" position.**

1. Check engine oil level.
2. Remove fender protector side cover (RH). Refer to [EXT-26, "FENDER PROTECTOR : Exploded View"](#).

ENGINE OIL

< PERIODIC MAINTENANCE >

[QR25DE]

3. Disconnect oil pressure switch harness connector at oil pressure switch. Remove oil pressure switch. Install suitable tool (A/B) to inspect oil pressure.

CAUTION:

Do not drop or shock oil pressure switch.

4. Start engine and warm it up to normal operating temperature.
5. Check oil pressure with engine running under no-load, using suitable tools (A/B).

NOTE:

- When engine oil temperature is low, engine oil pressure becomes high.
- If difference is extreme, check oil passage and oil pump for oil leaks.

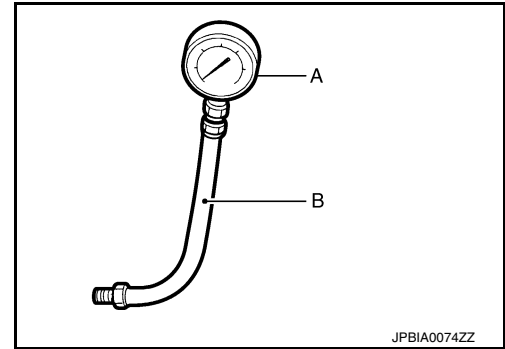

Engine oil pressure : Refer to [LU-19, "Oil Pressure"](#)

6. After the inspections, install oil pressure switch as follows:
 - a. Remove old liquid gasket adhering to oil pressure switch.
 - b. Apply liquid gasket and tighten oil pressure switch to specification. Refer to [LU-3, "Precaution for Liquid Gasket"](#).

Use Genuine RTV Silicone Sealant or equivalent.

Oil pressure switch : Refer to [EM-90, "Exploded View"](#)

- c. After warming up engine, make sure there are no engine oil leaks.
7. Install fender protector side cover (RH). Refer to [EXT-26, "FENDER PROTECTOR : Exploded View"](#).
8. Check engine oil level.

Changing Engine Oil

INFOID:0000000010483212

WARNING:

- **Be careful not to burn yourself, as the engine oil may be hot.**
- **Prolonged and repeated contact with used engine oil may cause skin cancer: try to avoid direct skin contact with used oil. If skin contact is made, wash thoroughly with soap or hand cleaner as soon as possible.**

1. Position the vehicle so it is level on the hoist.
2. Warm up the engine and check for oil leaks from the engine.
3. Stop engine and wait for 10 minutes.
4. Remove the oil pan drain plug (1) and oil filler cap.

⇐ : Front

5. Drain the engine oil.
6. Install the oil pan drain plug with a new washer and refill the engine with new engine oil.

Oil specification and viscosity : Refer to [MA-12, "Engine Oil Recommendation"](#).

Oil pan drain plug : [EM-36, "Exploded View"](#)

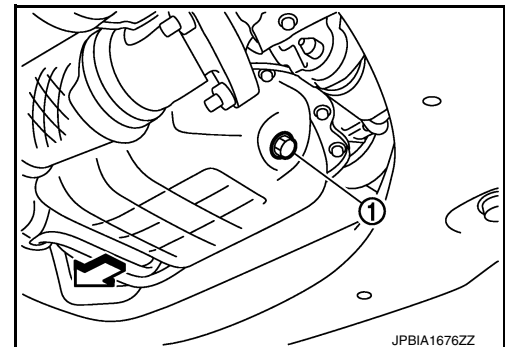

CAUTION:

- **Be sure to clean the oil pan drain plug and install using a new washer.**
- **The refill capacity depends on the oil temperature and drain time. Use these specifications for reference only. Always use the oil level gauge to determine when the proper amount of oil is in the engine.**

7. Warm up the engine and check around the drain plug and oil filter for oil leaks.
8. Stop the engine and wait for 10 minutes.

9. Check the oil level using the oil level gauge.

CAUTION:

Do not overfill the engine with engine oil.

A

LU

C

D

E

F

G

H

I

J

K

L

M

N

O

P

OIL FILTER

Removal and Installation

INFOID:000000011103060

REMOVAL

1. Remove fender protector side cover (RH). Refer to [EXT-26, "FENDER PROTECTOR : Exploded View"](#).
2. Drain engine oil. Refer to [LU-10, "Changing Engine Oil"](#).
3. Remove the oil filter using suitable tool (A).

WARNING:

- Be careful not to get burned, the engine and engine oil may be hot.

CAUTION:

- When removing, prepare a shop cloth to absorb any oil leaks or spillage.
- Do not allow engine oil to adhere to the drive belts.
- Completely wipe off any oil that adheres to the engine and the vehicle.

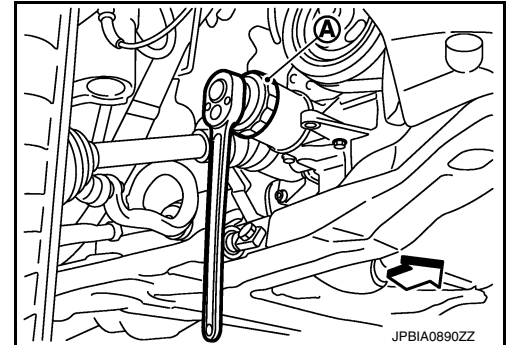

- The oil filter has a built in pressure relief valve. Use a Genuine NISSAN oil filter or equivalent

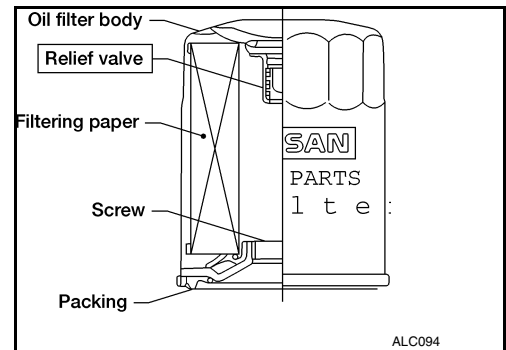

INSTALLATION

1. Remove foreign materials adhering to the oil filter installation surface.
2. Apply clean engine oil to the oil seal contact surface of the new oil filter.

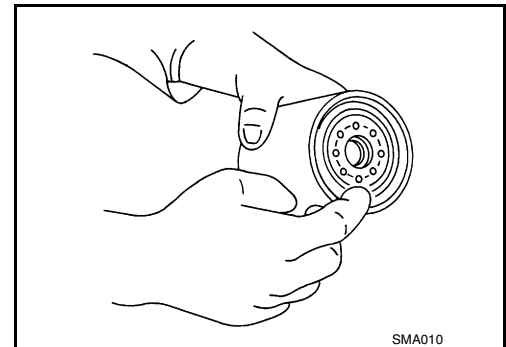

3. Screw the oil filter manually until it touches the installation surface, then tighten it by 2/3 turn (A). Or tighten to specification below.

Oil filter : 17.7 N·m (1.8 kg-m, 13 ft-lb)

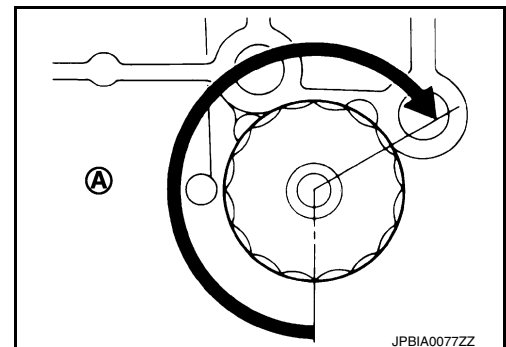

4. Refill engine with new engine oil. Refer to [LU-10, "Changing Engine Oil"](#).

OIL FILTER

< PERIODIC MAINTENANCE >

[QR25DE]

5. After warming up the engine, check for engine oil leaks. Repair as necessary.
6. Install fender protector side cover (RH). Refer to [EXT-26, "FENDER PROTECTOR : Exploded View"](#).

A

LU

C

D

E

F

G

H

I

J

K

L

M

N

O

P

REMOVAL AND INSTALLATION

OIL PUMP

Exploded View

INFOID:0000000011103069

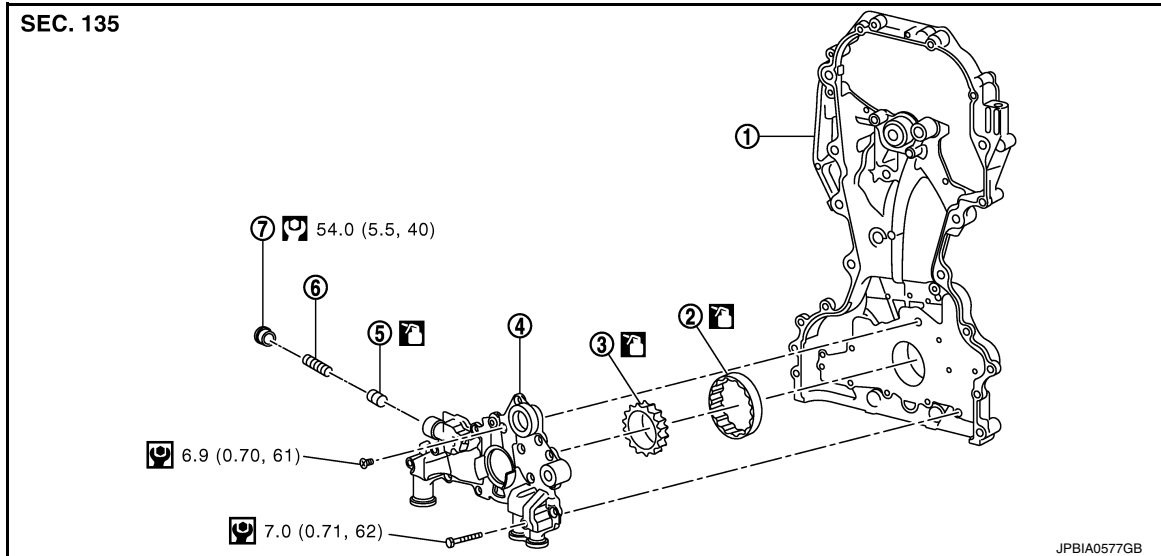

- | | | |
|---------------------------------------|--------------------|---------------------------|
| 1. Front cover (Oil pump body united) | 2. Outer rotor | 3. Inner rotor |
| 4. Oil pump cover | 5. Regulator valve | 6. Regulator valve spring |
| 7. Regulator valve plug | | |

CAUTION:

Before assembly, apply new engine oil to the parts as shown above.

Removal and Installation

INFOID:0000000011103070

REMOVAL

Remove front cover. Refer to [EM-60, "Exploded View"](#).

NOTE:

Oil pump is built into front cover.

INSTALLATION

Installation is in the reverse order of removal.

- When installing, align crankshaft flat faces with inner rotor flat faces.

Disassembly and Assembly

INFOID:0000000011103071

DISASSEMBLY

1. Remove bolts and oil pump cover.
2. Remove inner rotor and outer rotor from front cover.
3. After removing regulator valve plug, remove regulator valve spring and regulator valve.

ASSEMBLY

Assembly is in the reverse order of disassembly.

OIL PUMP

< REMOVAL AND INSTALLATION >

[QR25DE]

- Install the inner rotor and outer rotor with the punched marks on the oil pump cover side.

CAUTION:

Before assembly apply new engine oil to the parts specified.

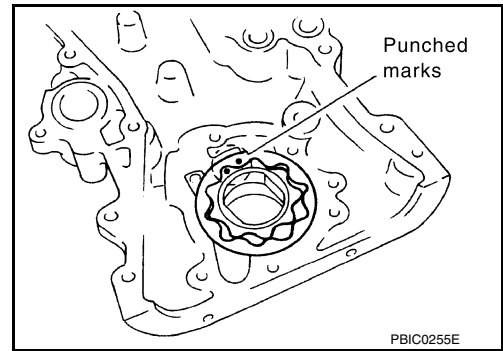

Inspection

INFOID:0000000011103072

INSPECTION AFTER DISASSEMBLY

OIL PUMP CLEARANCE

- Measure the clearance with suitable tool (A).
- Clearance between outer rotor (B) and front cover (C)

Standard : Refer to [LU-19, "Oil Pump"](#).

- Tip clearance between inner rotor (C) and outer rotor (B)

Standard : Refer to [LU-19, "Oil Pump"](#).

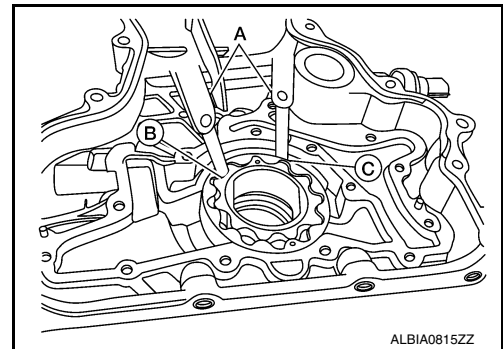

- Measure the clearance using suitable tools (A/B).
- Side clearance between inner rotor (3) and front cover (1)

Standard : Refer to [LU-19, "Oil Pump"](#).

- Side clearance between outer rotor (2) and front cover (1)

Standard : Refer to [LU-19, "Oil Pump"](#).

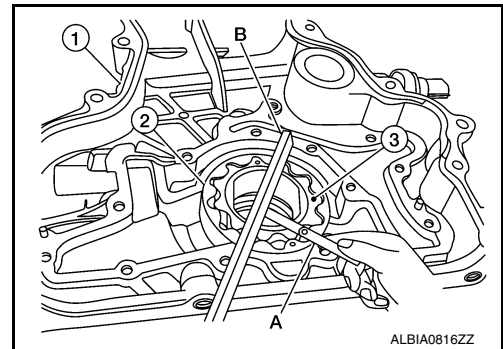

- Calculate the clearance between oil pump inner rotor and oil pump body as follows:
- Measure the outer diameter of protruded portion of inner rotor (1) using suitable tool (A).

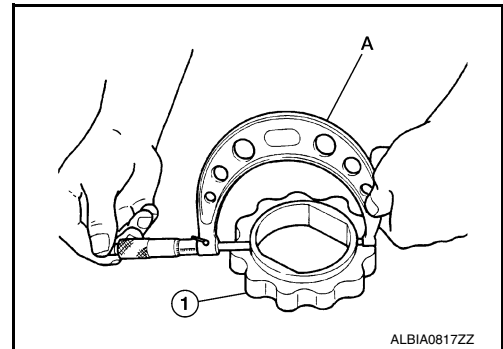

OIL PUMP

[QR25DE]

< REMOVAL AND INSTALLATION >

- Measure the inner diameter of inner rotor (1) using suitable tool (A).

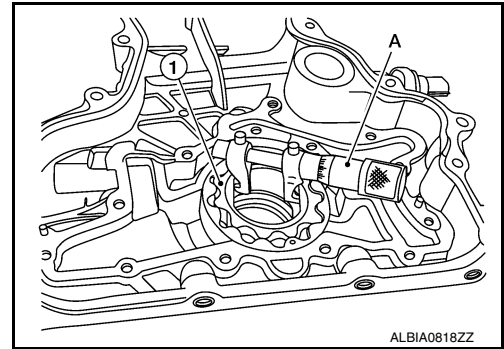

- (Clearance) = (Inner rotor inner diameter) – (Oil pump inner rotor outer diameter)

Standard : Refer to [LU-19, "Oil Pump"](#).

- If measured/calculated values are out of the standard, replace front cover and oil pump assembly.

REGULATOR VALVE TO OIL PUMP COVER CLEARANCE

- (Clearance) = (Regulator valve hole (1) diameter) – (Regulator valve (2) outer diameter)

Standard : Refer to [LU-19, "Oil Pump"](#).

- If the calculated value is out of the standard, replace front cover and oil pump assembly.

CAUTION:

- Coat regulator valve with engine oil.
- Make sure that it falls smoothly into valve hole by its own weight.

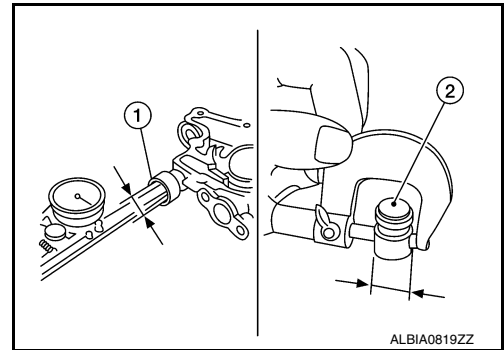

INSPECTION AFTER INSTALLATION

1. Check the engine oil level. Refer to [LU-9, "Inspection"](#).
2. Start the engine, and check that there is no leakage of engine oil.
3. Stop the engine and wait for 10 minutes.
4. Check the engine oil level and adjust the level. Refer to [LU-9, "Inspection"](#).

OIL COOLER

Exploded View

INFOID:0000000011103094

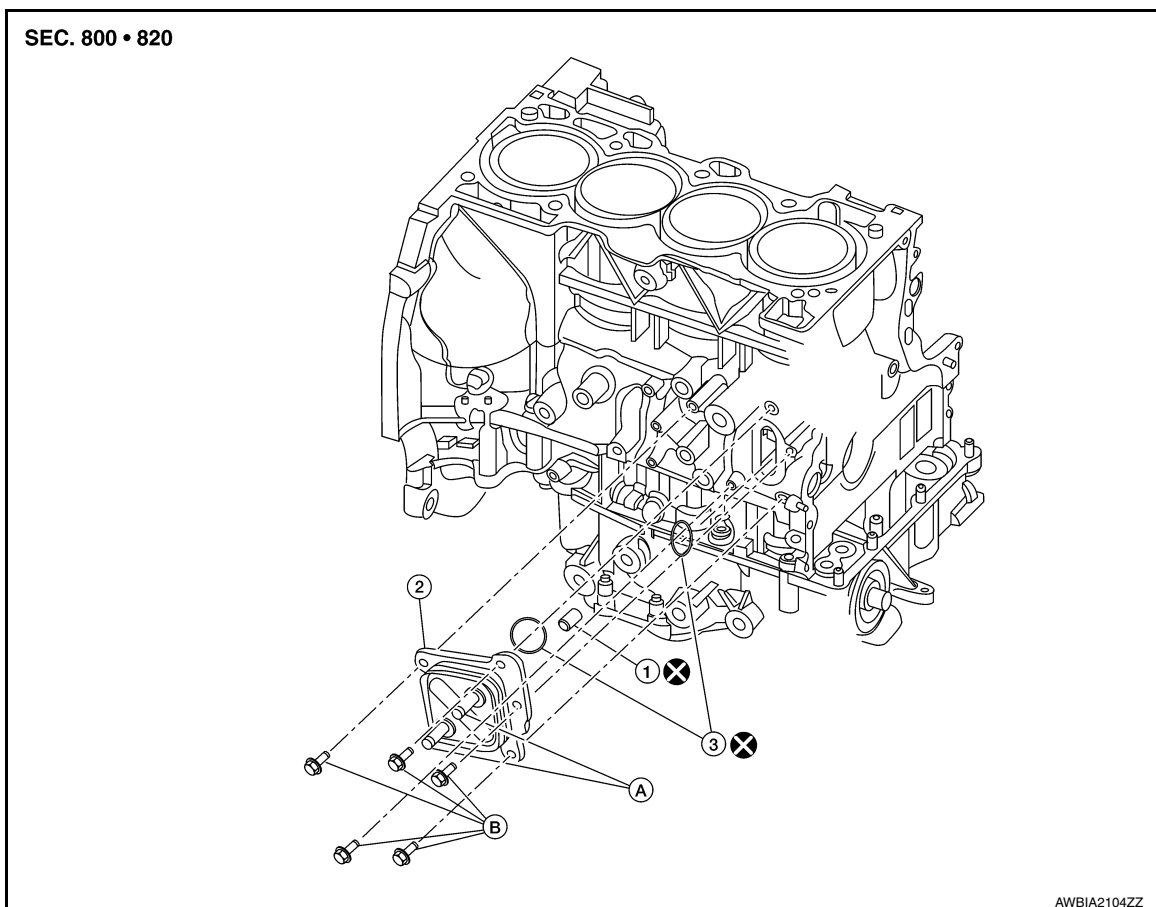

- | | | |
|------------------|--------------------------|-----------|
| 1. Relief valve | 2. Oil cooler | 3. O-ring |
| A. To water hose | B. Refer to INSTALLATION | |

Removal and Installation

INFOID:0000000011103095

WARNING:

Be careful not to burn yourself, as engine oil and engine coolant may be hot.

NOTE:

When removing components such as hoses, tubes/lines, etc., cap or plug openings to prevent fluid from spilling.

REMOVAL

1. Remove RH front road wheel and tire. Refer to [WT-55, "Adjustment"](#).
2. Remove RH fender protector. Refer to [EXT-26, "FENDER PROTECTOR : Removal and Installation"](#).
3. Drain engine coolant by removing water drain plug on cylinder block and radiator drain plug. Refer to [CO-10, "Changing Engine Coolant"](#).
4. Disconnect hoses from the oil cooler.
5. Remove oil cooler bolts in reverse numerical order.
6. Remove oil cooler.
7. Remove relief valve and O-rings.

INSTALLATION

Installation is in the reverse order of removal.

CAUTION:

OIL COOLER

< REMOVAL AND INSTALLATION >

[QR25DE]

- Do not reuse O-ring.

NOTE:

Tighten oil cooler bolts to specification in sequence as shown:

Oil cooler bolts : 9 N·m (0.9 kg-m, 80 in-lb)

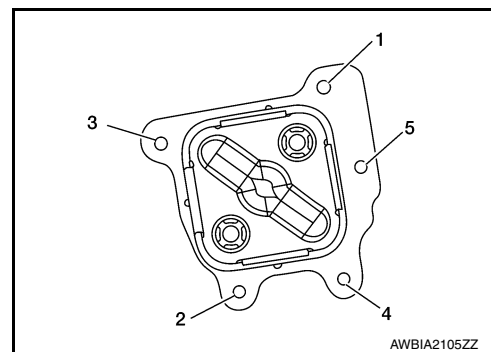

INFOID:0000000011103096

Inspection

INSPECTION AFTER REMOVAL

Oil Cooler

Check oil cooler for cracks. Check oil cooler for clogging by blowing through engine coolant inlet. If necessary, replace oil cooler.

INSPECTION AFTER INSTALLATION

1. Check the engine oil level and the engine coolant level and add engine oil and engine coolant. Refer to [CO-9, "System Inspection"](#) and [LU-9, "Inspection"](#).
2. Start the engine, and check that there are no leaks of engine oil or engine coolant.
3. Stop the engine and wait for 10 minutes.
4. Check the engine oil level and the engine coolant level again. Refer to [CO-9, "System Inspection"](#) and [LU-9, "Inspection"](#).

SERVICE DATA AND SPECIFICATIONS (SDS)

< SERVICE DATA AND SPECIFICATIONS (SDS)

[QR25DE]

SERVICE DATA AND SPECIFICATIONS (SDS)

SERVICE DATA AND SPECIFICATIONS (SDS)

Oil Pressure

INFOID:0000000011103105

Unit: kPa (kg/cm², psi)

Engine speed	Approximate discharge oil pressure*
600 rpm	98 (0.98, 1.0, 14)
2,000 rpm	294 (2.94, 3.0, 43)
6,000 rpm	392 (3.92, 4.0, 57)

*: Engine oil temperature at 80°C (176°F)

Oil Pump

INFOID:0000000011103106

Unit: mm (in)

Clearance between outer rotor and oil pump body	0.114 - 0.179 (0.0045 - 0.0070)
Tip clearance between inner rotor and outer rotor	0.170 - 0.220 (0.0067 - 0.0087)
Side clearance between inner rotor and oil pump body	0.030 - 0.070 (0.0012 - 0.0028)
Side clearance between outer rotor and oil pump body	0.060 - 0.110 (0.0024 - 0.0043)
Inner rotor to brazed portion of housing clearance	0.035 - 0.070 (0.0014 - 0.0028)

Regulator Valve

INFOID:0000000011103107

Unit: mm (in)

Regulator valve to oil pump cover clearance	0.040 - 0.097 (0.0016 - 0.0038)
---	---------------------------------

Oil Capacity

INFOID:0000000011103108

Unit: ℓ (US qt, Imp qt)

Drain and refill	With oil filter change	Approximately 4.6 (4-7/8, 4)
	Without oil filter change	Approximately 4.3 (4-1/2, 3-3/4)
Dry engine (engine overhaul)		Approximately 5.3 (5-5/8, 4-5/8)

PRECAUTION

PRECAUTIONS

Precaution for Supplemental Restraint System (SRS) "AIR BAG" and "SEAT BELT PRE-TENSIONER"

INFOID:000000010483225

The Supplemental Restraint System such as "AIR BAG" and "SEAT BELT PRE-TENSIONER", used along with a front seat belt, helps to reduce the risk or severity of injury to the driver and front passenger for certain types of collision. Information necessary to service the system safely is included in the SR and SB section of this Service Manual.

WARNING:

- To avoid rendering the SRS inoperative, which could increase the risk of personal injury or death in the event of a collision which would result in air bag inflation, all maintenance must be performed by an authorized NISSAN/INFINITI dealer.
- Improper maintenance, including incorrect removal and installation of the SRS, can lead to personal injury caused by unintentional activation of the system. For removal of Spiral Cable and Air Bag Module, see the SR section.
- Do not use electrical test equipment on any circuit related to the SRS unless instructed to in this Service Manual. SRS wiring harnesses can be identified by yellow and/or orange harnesses or harness connectors.

PRECAUTIONS WHEN USING POWER TOOLS (AIR OR ELECTRIC) AND HAMMERS

WARNING:

- When working near the Airbag Diagnosis Sensor Unit or other Airbag System sensors with the Ignition ON or engine running, DO NOT use air or electric power tools or strike near the sensor(s) with a hammer. Heavy vibration could activate the sensor(s) and deploy the air bag(s), possibly causing serious injury.
- When using air or electric power tools or hammers, always switch the Ignition OFF, disconnect the battery and wait at least three minutes before performing any service.

Precaution for Liquid Gasket

INFOID:0000000011103116

REMOVAL OF LIQUID GASKET SEALING

- After removing the bolts and nuts, separate the mating surface and remove the liquid gasket using Tool (A).

Tool Number : KV10111100 (J-37228)

CAUTION:

Be careful not to damage the mating surfaces.

- In areas where the cutter is difficult to use, use a plastic hammer to lightly tap (1) the cutter where the liquid gasket is applied. Use a plastic hammer to slide (2) the cutter by tapping on the side.

CAUTION:

Do not damage the mating surfaces.

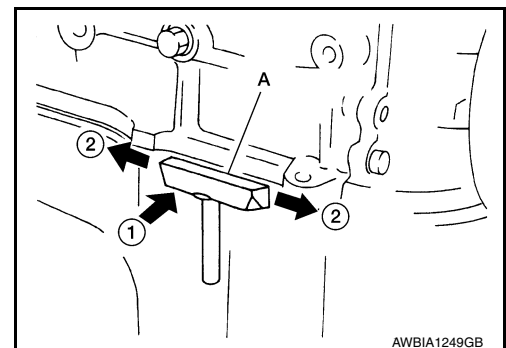

LIQUID GASKET APPLICATION PROCEDURE

1. Using suitable tool (A), remove old liquid gasket adhering to the liquid gasket application surface and the mating surface.
 - Remove liquid gasket completely from the groove of the liquid gasket application surface, mounting bolts, and bolt holes.
2. Thoroughly clean the mating surfaces and remove adhering moisture, grease and foreign materials.

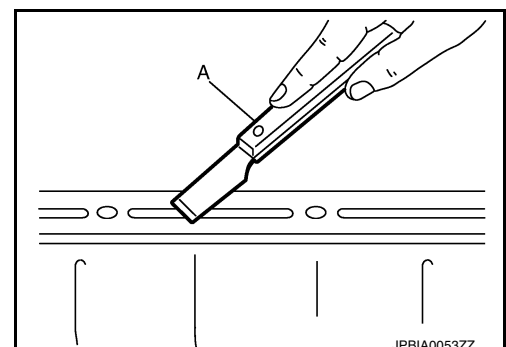

PRECAUTIONS

[VQ35DE]

< PRECAUTION >

3. Attach liquid gasket tube to the suitable tool.
Use Genuine Silicone RTV Sealant, or equivalent. Refer to [GI-21, "Recommended Chemical Products and Sealants"](#).
4. Apply liquid gasket without gaps to the specified location according to the specified dimensions.
 - If there is a groove for liquid gasket application, apply liquid gasket to the groove.

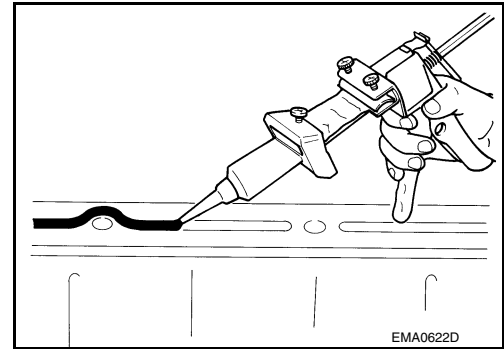

- As for bolt holes (B), normally apply liquid gasket inside the holes. Occasionally, it should be applied outside the holes. Check to read the text of this manual.

(A) : Groove

⇐ : Inside

- Within five minutes of liquid gasket application, install the mating component.
- If liquid gasket protrudes, wipe it off immediately.
- Do not retighten mounting bolts or nuts after the installation.
- After 30 minutes or more have passed from the installation, fill engine oil and engine coolant. Refer to [LU-27, "Changing Engine Oil"](#) and [CO-35, "Changing Engine Coolant"](#).

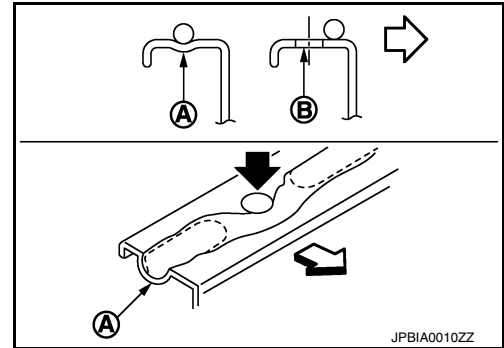

CAUTION:

If there are more specific instructions in the procedures contained in this manual concerning liquid gasket application, observe them.

PREPARATION

< PREPARATION >

[VQ35DE]

PREPARATION

PREPARATION

Special Service Tools

INFOID:0000000011103117

The actual shape of the tools may differ from those illustrated here.

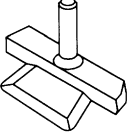
Tool number (TechMate No.) Tool name	Description
KV10111100 (J-37228) Seal cutter	Removing oil pan (lower) etc.
 <p>NT046</p>	

Commercial Service Tools

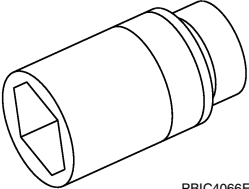
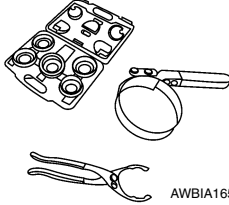
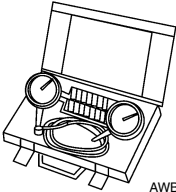

INFOID:0000000011103118

Tool name	Description
Deep socket	Removing and installing oil pressure sensor 27 mm (1.06 in)
 <p>PBIC4066E</p>	
— (223-50000) Oil filter wrench assortment	Removing oil filter
 <p>AWBIA1656ZZ</p>	
— (16-5610) Oil pressure kit	Measuring oil pressure. Comes with adapter and hose. Designed to be used for both static and on road testing.
 <p>AWBIA1657ZZ</p>	

PREPARATION

< PREPARATION >

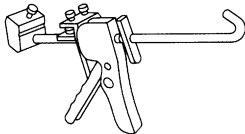
[VQ35DE]

Tool name	Description
<p>Tube presser</p>  <p>NT052</p>	<p>Pressing the tube of liquid gasket</p>
<p>Power tool</p>  <p>PIIB1407E</p>	<p>Loosening nuts, screws and bolts</p>

A

LU

C

D

E

F

G

H

I

J

K

L

M

N

O

P

SYSTEM DESCRIPTION

LUBRICATION SYSTEM

Lubrication Circuit

INFOID:000000010483229

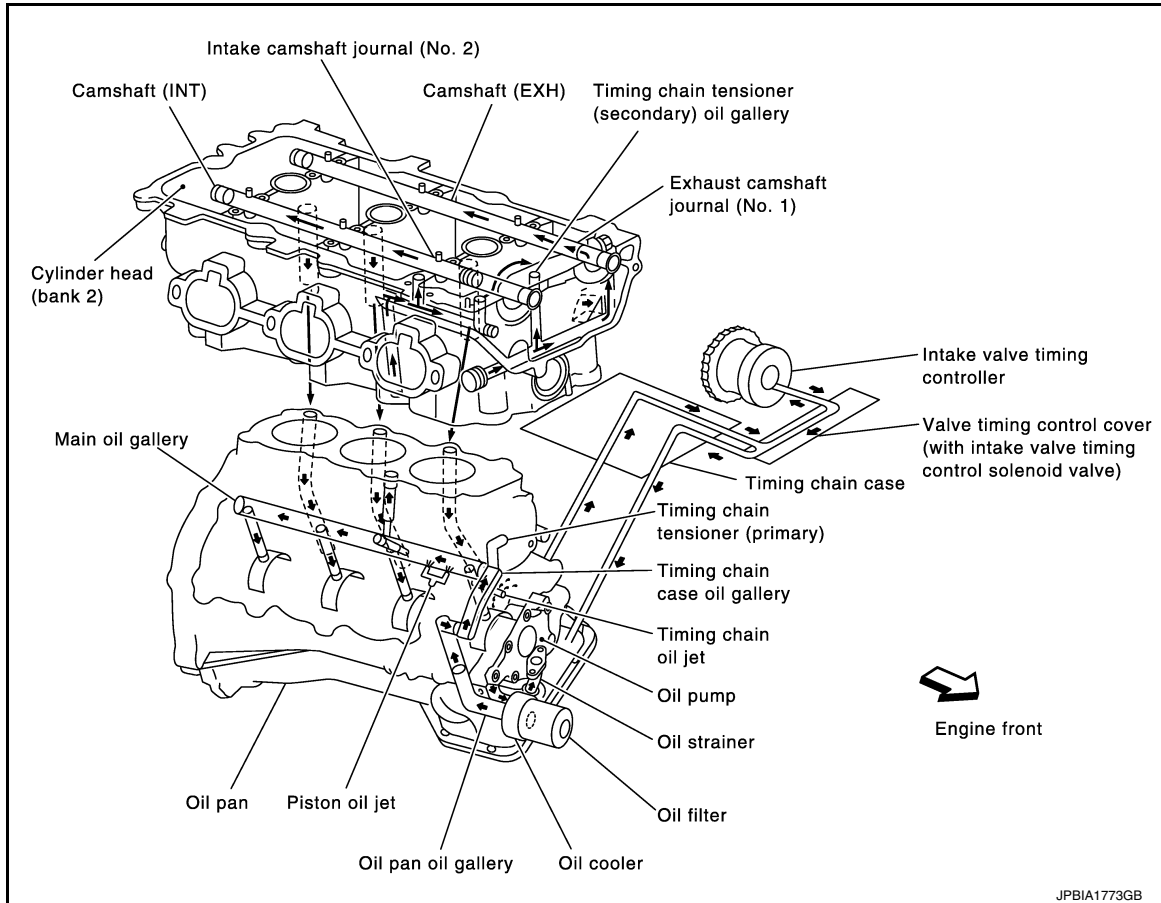

JPBIA1773GB

LUBRICATION SYSTEM

< SYSTEM DESCRIPTION >

[VQ35DE]

Schematic

INFOID:0000000010483230

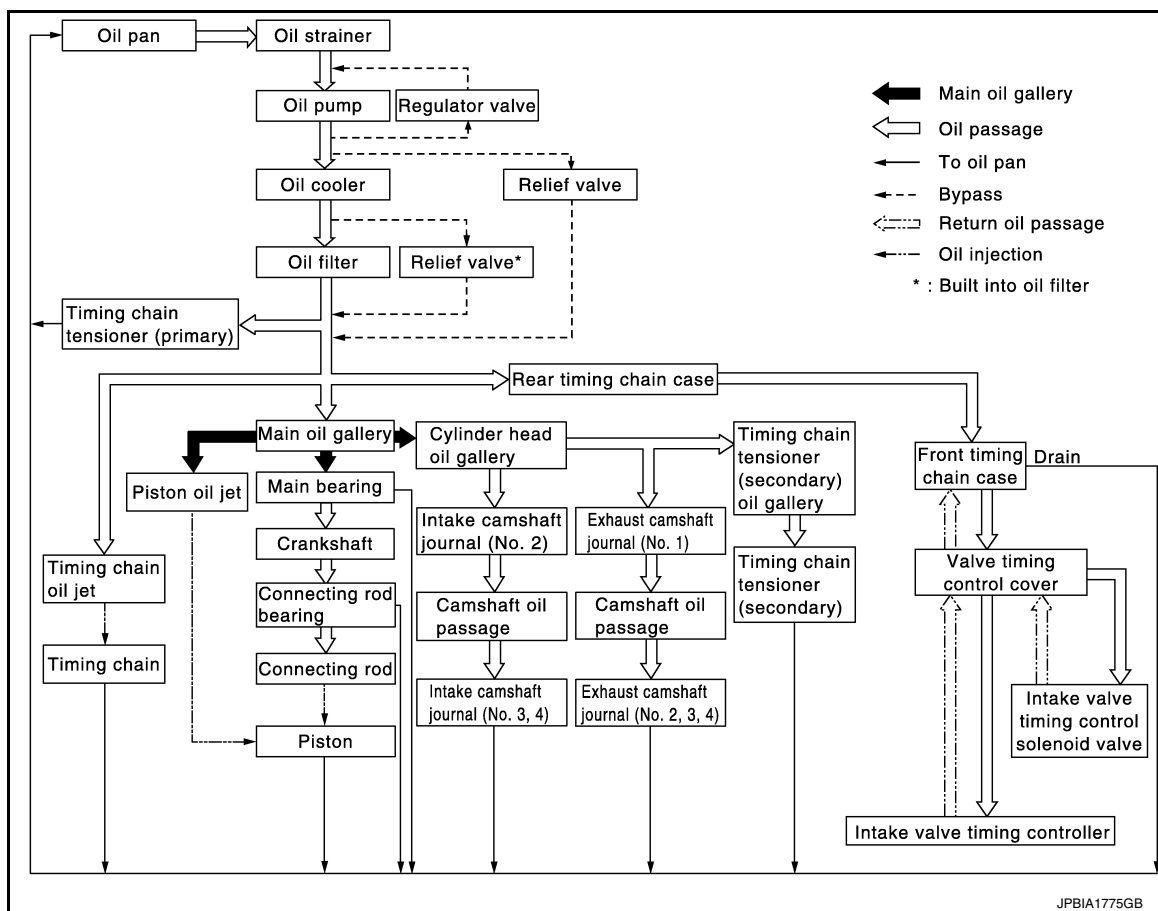

PERIODIC MAINTENANCE

ENGINE OIL

Inspection

INFOID:0000000011105404

ENGINE OIL LEVEL

NOTE:

- Before starting the engine, check the engine oil level. If the engine is already started, stop it and allow 10 minutes before checking.
- Check that the engine oil level is within the range as indicated on the dipstick.
- If it is out of range, add engine oil as necessary until the dipstick indicates the correct level.

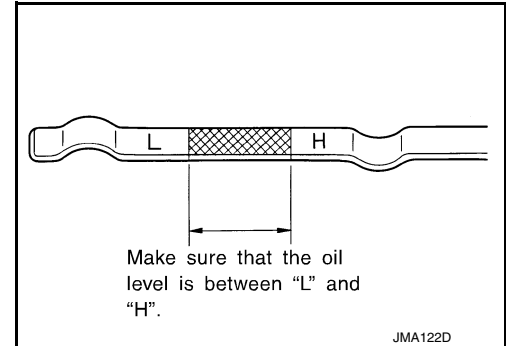

ENGINE OIL APPEARANCE

- Check engine oil for white milky appearance or excessive contamination.
- If engine oil becomes milky, it is highly probable that it is contaminated with engine coolant. Repair or replace damaged parts.

ENGINE OIL LEAKS

Check for engine oil leaks around the following areas:

- Oil pan
- Oil pan drain plug
- Oil pressure switch
- Oil filter
- Oil cooler
- Intake valve timing control cover
- Front timing chain cover
- Mating surface between cylinder block and cylinder head
- Mating surface between cylinder head and rocker cover
- Front oil seal
- Rear oil seal

ENGINE OIL PRESSURE CHECK

WARNING:

- **Be careful not to burn yourself, as engine oil may be hot.**
- **When checking engine oil pressure, shift selector position should be "P", and apply parking brake securely.**

1. Check the engine oil level. Refer to ENGINE OIL LEVEL.
2. Remove fender protector side cover. Refer to [EXT-26, "FENDER PROTECTOR : Exploded View"](#).
3. Disconnect oil pressure switch harness connector at the oil pressure switch. Remove oil pressure switch using suitable tool and install suitable tools (A/B).

CAUTION:

Do not drop or shock oil pressure switch.

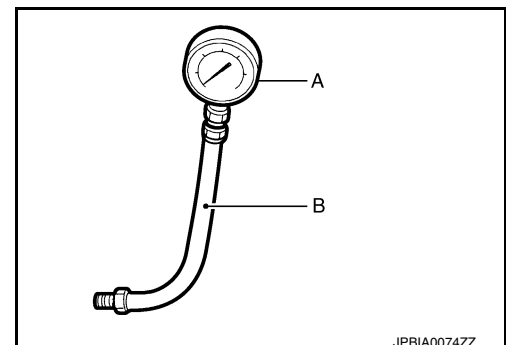

4. Start the engine and warm it up to normal operating temperature.

ENGINE OIL

< PERIODIC MAINTENANCE >

[VQ35DE]

5. Check oil pressure with engine running under no-load, using suitable tool.

NOTE:

- When engine oil temperature is low, engine oil pressure becomes high.
- If difference is extreme, check oil passage and oil pump for oil leaks.

Engine oil pressure : [LU-35, "Oil Pressure"](#)

6. After the inspections, install the oil pressure switch using suitable tool as follows:

- a. Remove the old sealant adhering to oil pressure switch and engine.
- b. Apply thread sealant and tighten the oil pressure switch to specification.

Use Genuine High Performance Thread Sealant, or equivalent. Refer to [GI-21, "Recommended Chemical Products and Sealants"](#).

Oil pressure switch : [EM-175, "Exploded View"](#)

- c. After warming up engine, make sure there are no engine oil leaks.
7. Install fender protector side cover. Refer to [EXT-26, "FENDER PROTECTOR : Exploded View"](#).

Changing Engine Oil

INFOID:0000000010483232

WARNING:

- **Be careful not to burn yourself, as the engine oil may be hot.**
- **Prolonged and repeated contact with used engine oil may cause skin cancer; try to avoid direct skin contact with used engine oil. If skin contact is made, wash thoroughly with soap or hand cleaner as soon as possible.**

1. Position the vehicle so it is level on the hoist.
2. Warm up the engine and check for engine oil leaks from the engine.
3. Stop engine and wait for 10 minutes.
4. Remove the oil pan drain plug (1) and oil filler cap.

⇐ : Front

5. Drain the engine oil.
6. Install the oil pan drain plug (1) with a new washer and refill the engine with new engine oil.

Oil specification and viscosity : Refer to [MA-12, "Engine Oil Recommendation"](#).

Oil pan drain plug : 34.3 N·m (3.5 kg-m, 25 ft-lb)

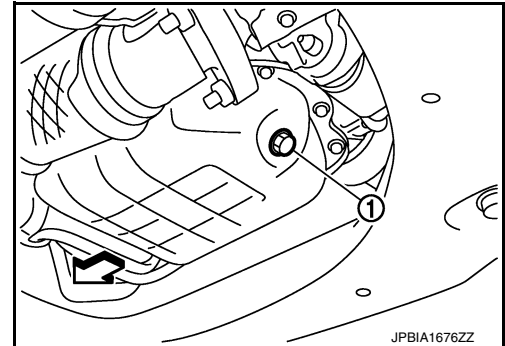

CAUTION:

- **Be sure to clean the oil pan drain plug and install with a new washer.**
- **The refill capacity depends on the oil temperature and drain time. Use these specifications for reference only. Always use the dipstick to determine when the proper amount of oil is in the engine.**

7. Warm up the engine and check around the oil pan drain plug and oil filter for oil leaks.
8. Stop engine and wait for 10 minutes.
9. Check the engine oil level using the oil level gauge.

CAUTION:

Do not overfill the engine with engine oil.

OIL FILTER

Removal and Installation

INFOID:000000010483233

REMOVAL

1. Drain engine oil. Refer to [LU-27, "Changing Engine Oil"](#).
2. Remove the fender protector side cover (RH). Refer to [EXT-26, "FENDER PROTECTOR : Exploded View"](#).
3. Remove the oil filter using suitable tool (A) as shown.

WARNING:

- Be careful not to get burned, the engine and engine oil may be hot.

CAUTION:

- When removing, prepare a shop cloth to absorb any oil leaks or spillage.
- Do not allow engine oil to adhere to the drive belts.
- Completely wipe off any oil that adheres to the engine and the vehicle.

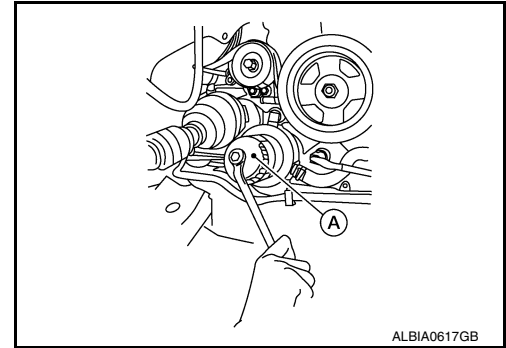

ALBIA0617GB

- The oil filter has a built in pressure relief valve. Use a Genuine NISSAN oil filter or equivalent

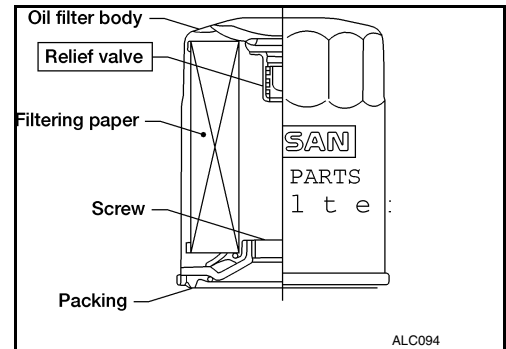

ALC094

INSTALLATION

1. Remove foreign materials adhering to the oil filter installation surface.
2. Apply clean engine oil to the oil seal contact surface of the new oil filter.

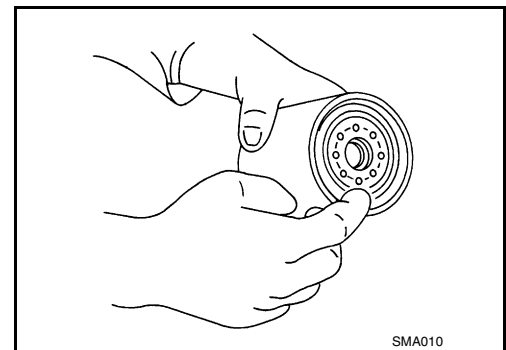

SMA010

3. Screw the oil filter manually until it touches the installation surface, then tighten it by 2/3 turn. Or tighten to specification below.

Oil filter : 17.7 N·m (1.8 kg-m, 13 ft-lb)

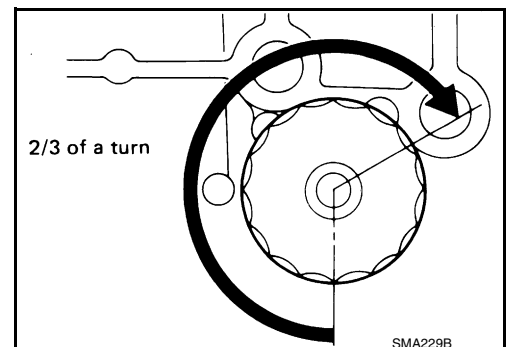

SMA229B

OIL FILTER

< PERIODIC MAINTENANCE >

[VQ35DE]

4. Refill engine with new engine oil. Refer to [LU-27. "Changing Engine Oil"](#).
5. After warming up the engine, check for any engine oil leaks.
6. Install the fender protector side cover (RH). Refer to [EXT-26. "FENDER PROTECTOR : Exploded View"](#).

A

LU

C

D

E

F

G

H

I

J

K

L

M

N

O

P

REMOVAL AND INSTALLATION

OIL PUMP

Exploded View

INFOID:0000000010483234

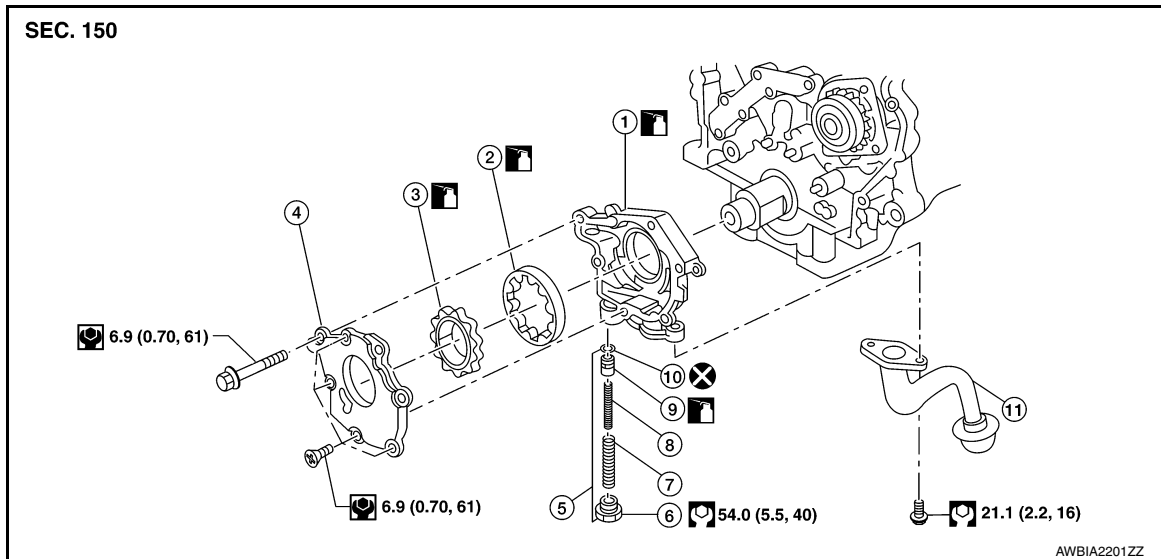

- | | | |
|---------------------------|---------------------------|-------------------------|
| 1. Oil pump housing | 2. Oil pump outer rotor | 3. Oil pump inner rotor |
| 4. Oil pump cover | 5. Regulator valve set | 6. Regulator plug |
| 7. Regulator valve spring | 8. Regulator valve spring | 9. Regulator valve |
| 10. O-ring | 11. Oil strainer | |

Removal and Installation

INFOID:0000000010483235

REMOVAL

1. Remove the engine assembly from the vehicle. Refer to [EM-222, "Removal and Installation"](#).
2. Remove the upper oil pan. Refer to [EM-158, "Removal and Installation \(Upper Oil Pan\)"](#).
3. Remove the timing chain. Refer to [EM-183, "Removal and Installation"](#).
4. Remove oil pump assembly.

INSTALLATION

Installation is in the reverse order of removal.

- When installing, align crankshaft flat faces with inner rotor flat faces.

Disassembly and Assembly

INFOID:0000000010483236

DISASSEMBLY

1. Remove the oil pump cover.
2. Remove inner rotor and outer rotor from oil pump housing.

CAUTION:

The outer rotor has directional vanes in relation to the rotation of the oil pump shaft. Note the outer rotor vane direction for assembly.

3. Remove oil strainer from oil pump housing.
4. After removing regulator plug, remove spring and regulator valve.

Assembly

CAUTION:

- Do not reuse O-ring.
- Before assembly apply new engine oil to the parts as specified.

OIL PUMP

< REMOVAL AND INSTALLATION >

[VQ35DE]

Assembly is in the reverse order of disassembly.

- Assemble the outer rotor in the correct vane orientation to rotation as noted during disassembly and the inner rotor with the groove on the oil pump cover side.

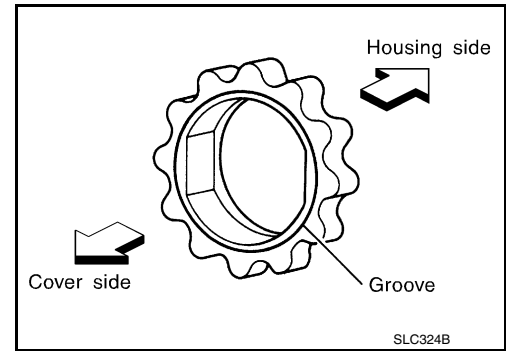

INFOID:000000010483237

Inspection

INSPECTION AFTER DISASSEMBLY

Clearance of Oil Pump Parts

- Measure clearance with feeler gauge.
- Clearance between outer rotor and oil pump body (position 1).

Standard : [LU-35, "Oil Pump"](#)

- Tip clearance between inner rotor and outer rotor (position 2).

Standard : [LU-35, "Oil Pump"](#)

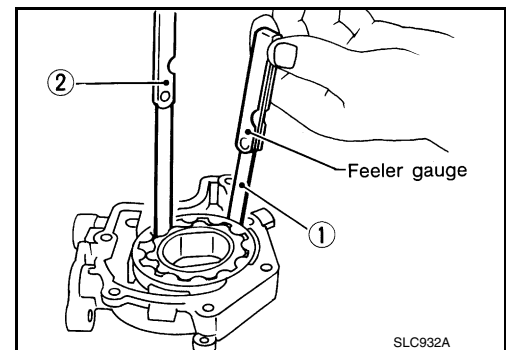

- Measure clearance with feeler gauge and straightedge.
- Side clearance between inner rotor and oil pump body (position 3).

Standard : [LU-35, "Oil Pump"](#)

- Side clearance between outer rotor and oil pump body (position 4).

Standard : [LU-35, "Oil Pump"](#)

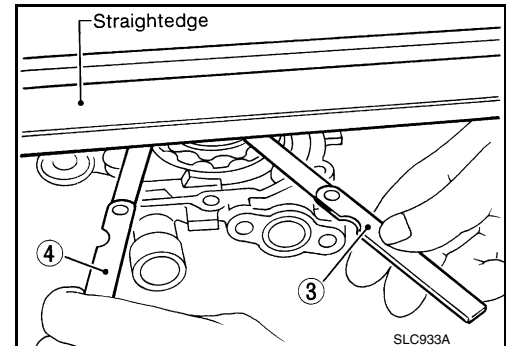

- Calculate the clearance between inner rotor and oil pump body as follows:

1. Measure the outer diameter of protruded portion of inner rotor (position A).
2. Measure the inner diameter of oil pump body with inside micrometer (position B).
(clearance 5) = (inner diameter of oil pump body B) – (outer diameter of inner rotor A)

Standard : [LU-35, "Oil Pump"](#)

3. If out of specifications, replace oil pump assembly.

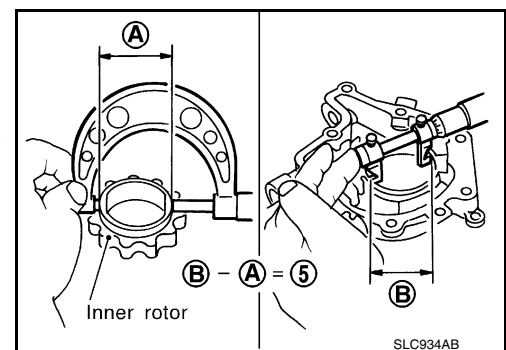

Regulator Valve

OIL PUMP

< REMOVAL AND INSTALLATION >

[VQ35DE]

1. Visually inspect components for wear and damage.
2. Check oil pressure regulator valve sliding surface and valve spring.
3. Coat regulator valve with engine oil. Check that it falls smoothly into the valve hole by its own weight.

If damaged, replace oil pump assembly.

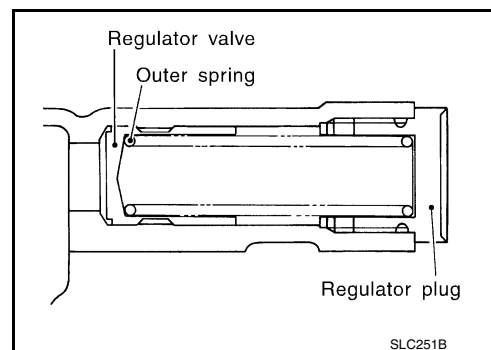

Regulator Valve Clearance

(Clearance 6) = D (Valve hole diameter) – E (Outer diameter of valve)

Standard : LU-35, "Regulator Valve"

If it exceeds the standard, replace the oil pump assembly.

CAUTION:

- Coat regulator valve with engine oil.
- Check that it falls smoothly into the valve hole by its own weight.

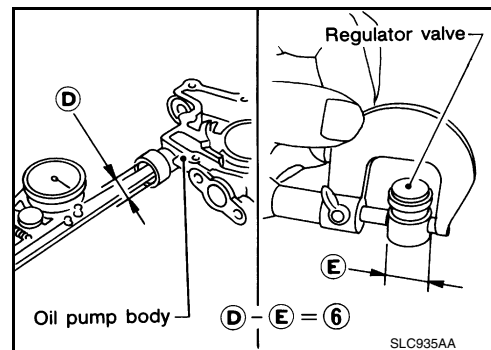

OIL COOLER

< REMOVAL AND INSTALLATION >

[VQ35DE]

OIL COOLER

Exploded View

INFOID:0000000010483238

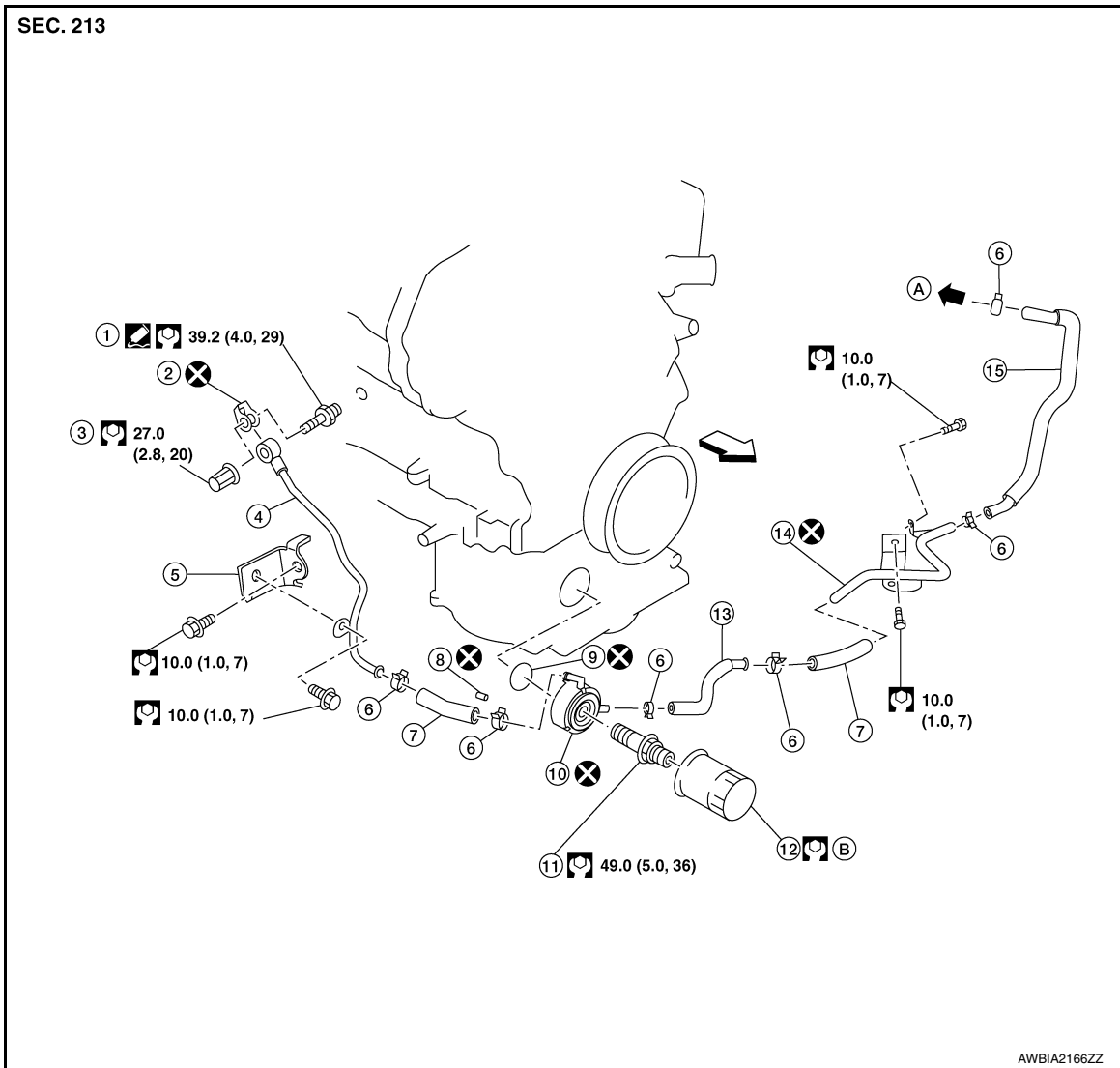

- | | | |
|-----------------------|---|----------------------|
| 1. Connector bolt | 2. Copper gasket | 3. Water drain plug |
| 4. Water pipe | 5. Bracket | 6. Clamp |
| 7. Water hose | 8. Relief valve | 9. Oil cooler O-ring |
| 10. Oil cooler | 11. Connector bolt | 12. Oil filter |
| 13. Water hose | 14. Water pipe | 15. Water hose |
| A. To water connector | B. Refer to LU-28. "Removal and Installation" | |

↔ : Engine front

◻ : Sealing point

Removal and Installation

INFOID:0000000010483239

WARNING:

Be careful not to burn yourself, as the engine oil may be hot.

CAUTION:

- When removing oil cooler, prepare a shop cloth to absorb any engine oil leaks or spillage.
- Completely wipe off any engine oil that adheres to the engine and the vehicle.

NOTE:

OIL COOLER

< REMOVAL AND INSTALLATION >

[VQ35DE]

When removing components such as hoses, tubes/lines, etc., cap or plug openings to prevent fluid from spilling.

REMOVAL

1. Remove the engine under cover. Refer to [EXT-17, "Removal and Installation"](#).
2. Remove the wheel and tire (RH) using a power tool. Refer to [WT-53, "Inspection"](#).
3. Remove the front fender protector side cover (RH). Refer to [EXT-26, "FENDER PROTECTOR : Exploded View"](#).
4. Drain engine coolant. Refer to [CO-35, "Changing Engine Coolant"](#).
CAUTION:
Do not spill engine coolant on the drive belt.
5. Disconnect water hoses from oil cooler.
6. Remove the oil filter. Refer to [LU-28, "Removal and Installation"](#).
7. Remove oil cooler.

INSPECTION AFTER REMOVAL

1. Check oil cooler for cracks.
2. Check oil cooler for clogging by blowing through coolant inlet. If necessary, replace oil cooler.

Oil Pressure Relief Valve

Inspect oil pressure relief valve for movement, cracks and breaks by pushing the ball. If replacement is necessary, remove valve by prying it out with a suitable tool. Install a new valve in place by tapping it.

INSTALLATION

Installation is in the reverse order of removal.

CAUTION:

- Do not reuse O-ring.
- Do not reuse copper gasket.
- When installing the oil cooler, align the oil cooler slot with the stopper of the oil pan.

INSPECTION AFTER INSTALLATION

1. Check the engine oil level and the engine coolant level and add engine oil and engine coolant. Refer to [CO-34, "System Inspection"](#) and [LU-26, "Inspection"](#).
2. Start the engine, and check that there are no leaks of engine oil or engine coolant.
3. Stop the engine and wait for 10 minutes.
4. Check the engine oil level and the engine coolant level again. Refer to [LU-26, "Inspection"](#) and [CO-34, "System Inspection"](#).

SERVICE DATA AND SPECIFICATIONS (SDS)

< SERVICE DATA AND SPECIFICATIONS (SDS)

[VQ35DE]

SERVICE DATA AND SPECIFICATIONS (SDS)

SERVICE DATA AND SPECIFICATIONS (SDS)

Oil Pressure

INFOID:0000000010483240

Unit: kPa (kg/cm², psi)

Engine speed	Approximate discharge oil pressure*
Idle speed	98 (1.0, 14)
2,000 rpm	294 (3.0, 43)
6,000 rpm	392 (4.0, 57)

*: Engine oil temperature at 80°C (176°F)

Oil Pump

INFOID:0000000010483241

Unit: mm (in)

Clearance between outer rotor and oil pump body	0.114 - 0.260 (0.0045 - 0.0102)
Tip clearance between inner rotor and outer rotor	At or below 0.180 (0.0071)
Side clearance between inner rotor and oil pump body	0.030 - 0.070 (0.0012 - 0.0028)
Side clearance between outer rotor and oil pump body	0.030 - 0.090 (0.0012 - 0.0035)
Clearance between inner rotor and oil pump body	0.045 - 0.091 (0.0018 - 0.0036)
Socket to side seal	0.010 - 0.060 (0.0004 - 0.0024)

Regulator Valve

INFOID:0000000010483242

Unit: mm (in)

Regulator valve to oil pump cover clearance	0.040 - 0.097 (0.0016 - 0.0038)
---	---------------------------------

Oil Capacity

INFOID:0000000010483243

Unit: ℓ (US qt, Imp qt)

Drain and refill	With oil filter change	4.8 (5-1/8, 4-1/4)
	Without oil filter change	4.5 (4-3/4, 4)
Dry engine (engine overhaul)		5.2 (5-1/2, 4-5/8)