

SECTION **HRN**
HORN

A
B
C
D
E
F
G
H
I
J
K
M
N
O
P

CONTENTS

COMPONENT DIAGNOSIS	2	Precaution for Supplemental Restraint System (SRS) "AIR BAG" and "SEAT BELT PRE-TENSIONER"	5
HORN	2	ON-VEHICLE REPAIR	6
Wiring Diagram - HORN -	2	HORN	6
PRECAUTION	5	Exploded View	6
PRECAUTIONS	5	Removal and Installation	6

HRN

HORN

< COMPONENT DIAGNOSIS >

COMPONENT DIAGNOSIS

HORN

Wiring Diagram - HORN -

INFOID:000000003138918

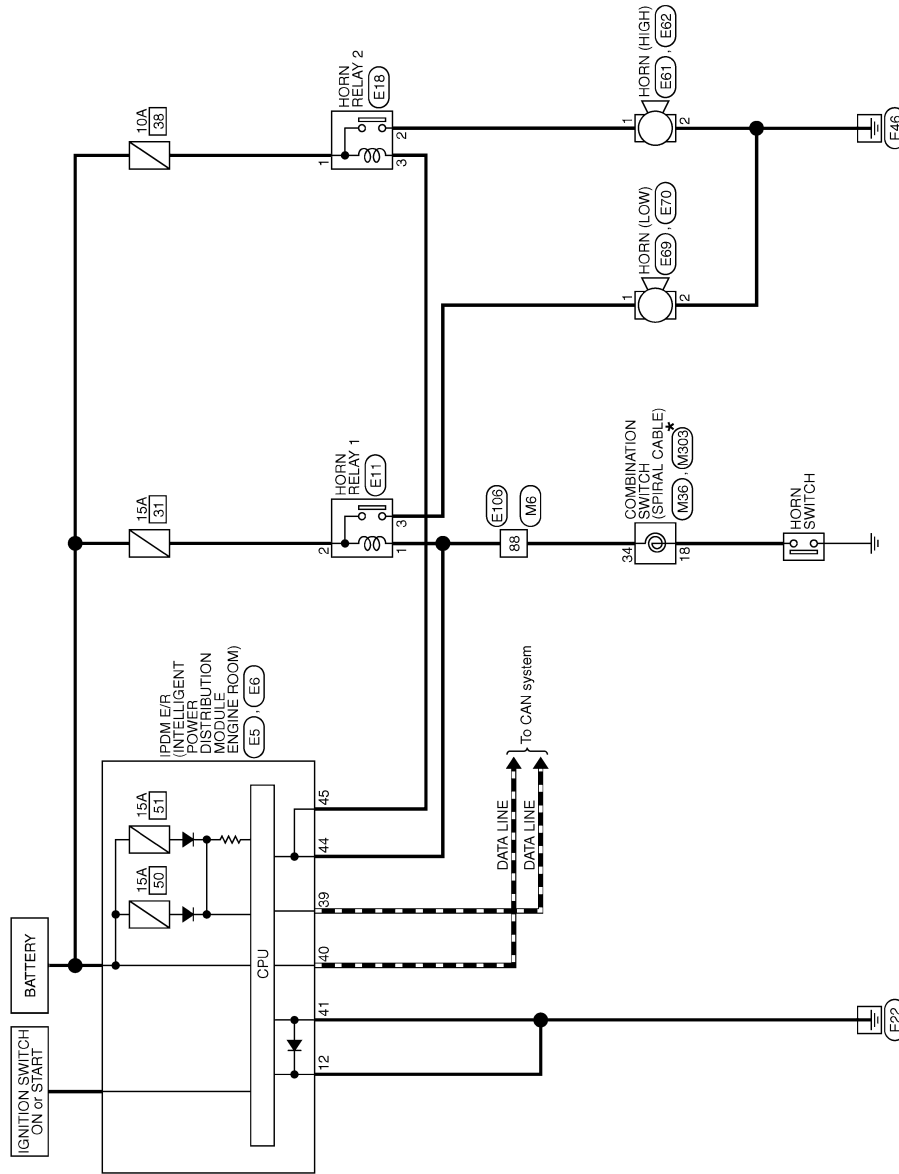

*: This connector is not shown in "Harness Layout".









HORN

2007/10/26

JCLWM1305GE

HORN

< COMPONENT DIAGNOSIS >

HORN		
Connector No.	E106	
Connector Name	WIRE TO WIRE	
Connector Type	TH807V-CS16-TM4	
		
Terminal No.	88	Signal Name [Specification]
Color of Wire	LG	
-		
Connector No.	M6	
Connector Name	WIRE TO WIRE	
Connector Type	TH808V-CS16-TM4	
		
Terminal No.	88	Signal Name [Specification]
Color of Wire	G	
-		
Connector No.	M36	
Connector Name	COMBINATION SWITCH (SPIRAL CABLE)	
Connector Type	TK6BFGY-IV	
		
Terminal No.	34	Signal Name [Specification]
Color of Wire	G	
-		
Connector No.	M303	
Connector Name	COMBINATION SWITCH (SPIRAL CABLE)	
Connector Type	TK6BFGY	
		
Terminal No.	18	Signal Name [Specification]
Color of Wire	G	
-		

JCLWM1307GE

PRECAUTIONS

< PRECAUTION >

PRECAUTION

PRECAUTIONS

Precaution for Supplemental Restraint System (SRS) "AIR BAG" and "SEAT BELT PRE-TENSIONER"

INFOID:000000003138919

The Supplemental Restraint System such as "AIR BAG" and "SEAT BELT PRE-TENSIONER", used along with a front seat belt, helps to reduce the risk or severity of injury to the driver and front passenger for certain types of collision. This system includes seat belt switch inputs and dual stage front air bag modules. The SRS system uses the seat belt switches to determine the front air bag deployment, and may only deploy one front air bag, depending on the severity of a collision and whether the front occupants are belted or unbelted. Information necessary to service the system safely is included in the "SRS AIRBAG" and "SEAT BELT" of this Service Manual.

WARNING:

- To avoid rendering the SRS inoperative, which could increase the risk of personal injury or death in the event of a collision which would result in air bag inflation, all maintenance must be performed by an authorized NISSAN/INFINITI dealer.
- Improper maintenance, including incorrect removal and installation of the SRS, can lead to personal injury caused by unintentional activation of the system. For removal of Spiral Cable and Air Bag Module, see the "SRS AIRBAG".
- Do not use electrical test equipment on any circuit related to the SRS unless instructed to in this Service Manual. SRS wiring harnesses can be identified by yellow and/or orange harnesses or harness connectors.

A
B
C
D
E
F
G
H
I
J
K
M
N
O
P

HRN

HORN

< ON-VEHICLE REPAIR >

ON-VEHICLE REPAIR

HORN

Exploded View

INFOID:000000003138920

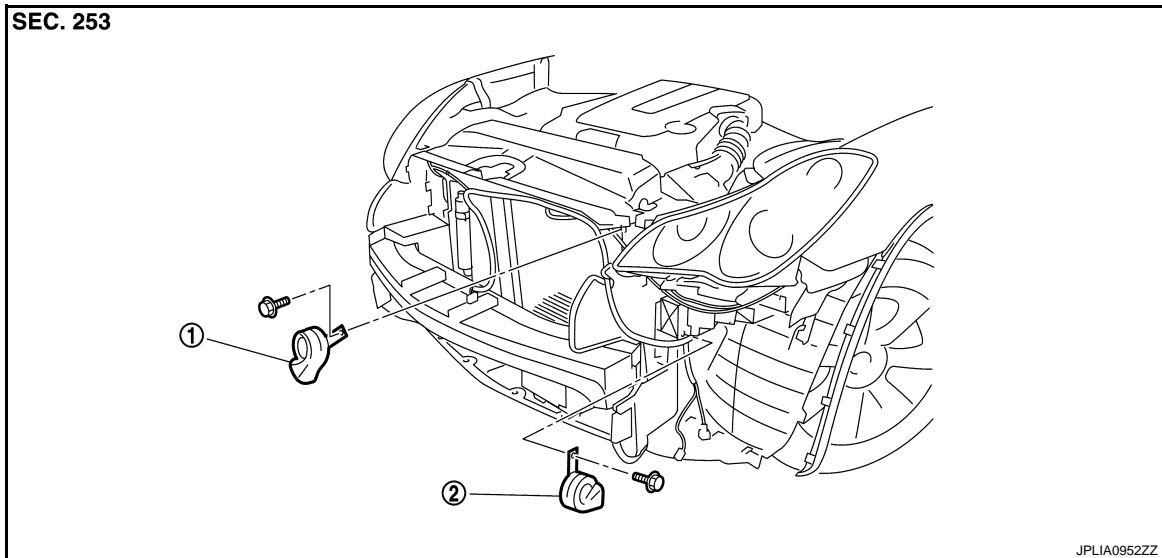

1. Horn (LOW)

2. Horn (HIGH)

Removal and Installation

INFOID:000000003138921

REMOVAL

Horn (LOW)

1. Remove radiator front grille. Refer to [EXT-20. "Exploded View"](#).
2. Disconnect the horn (LOW) connector.
3. Remove the horn mounting bolt, and remove the horn (LOW) from the vehicle.

Horn (HIGH)

1. Remove fender protector (front LH). Refer to [EXT-25. "FENDER PROTECTOR : Exploded View"](#).
2. Disconnect the horn (HIGH) connector.
3. Remove the horn mounting bolt, and remove the horn (HIGH) from the vehicle.

INSTALLATION

Install in the reverse order of removal.