

A  
B  
C

# SECTION **VTL**

## VENTILATION SYSTEM

### CONTENTS

<p><b>SYSTEM DESCRIPTION</b> ..... 3</p> <p><b>SWITCHES AND THEIR CONTROL FUNCTION</b> ..... 3</p> <p style="padding-left: 20px;">System Description .....3</p> <p><b>AIR DISTRIBUTION</b> ..... 6</p> <p style="padding-left: 20px;">System Description .....6</p> <p><b>PRECAUTION</b> ..... 7</p> <p><b>PRECAUTIONS</b> ..... 7</p> <p style="padding-left: 20px;">Precaution for Supplemental Restraint System (SRS) "AIR BAG" and "SEAT BELT PRE-TENSIONER" .....7</p> <p style="padding-left: 20px;">Precautions Necessary for Steering Wheel Rotation After Battery Disconnection .....7</p> <p><b>PREPARATION</b> ..... 9</p> <p><b>PREPARATION</b> ..... 9</p> <p style="padding-left: 20px;">Commercial Service Tool .....9</p> <p><b>PERIODIC MAINTENANCE</b> .....10</p> <p><b>IN-CABIN MICROFILTER</b> .....10</p> <p style="padding-left: 20px;">Exploded View ..... 10</p> <p style="padding-left: 20px;">Removal and Installation ..... 10</p> <p style="padding-left: 20px;">Replacement ..... 10</p> <p><b>REMOVAL AND INSTALLATION</b> .....11</p> <p><b>DUCT AND GRILLE</b> .....11</p> <p style="padding-left: 20px;">Exploded View ..... 11</p> <p><b>CENTER VENTILATOR GRILLE</b> .....12</p> <p style="padding-left: 20px;">CENTER VENTILATOR GRILLE : Removal and Installation ..... 12</p> <p><b>SIDE VENTILATOR GRILLE</b> .....12</p> <p style="padding-left: 20px;">SIDE VENTILATOR GRILLE : Removal and Installation ..... 12</p>	<p><b>FRONT DEFROSTER GRILLE</b> .....13</p> <p style="padding-left: 20px;">FRONT DEFROSTER GRILLE : Removal and Installation .....13</p> <p><b>VENTILATOR DUCT</b> .....13</p> <p style="padding-left: 20px;">VENTILATOR DUCT : Removal and Installation ....13</p> <p><b>ADAPTOR DUCT</b> .....14</p> <p style="padding-left: 20px;">ADAPTOR DUCT : Removal and Installation .....14</p> <p><b>DEFROSTER NOZZLE</b> .....14</p> <p style="padding-left: 20px;">DEFROSTER NOZZLE : Removal and Installation .....14</p> <p><b>SIDE DEFROSTER NOZZLE</b> .....14</p> <p style="padding-left: 20px;">SIDE DEFROSTER NOZZLE : Removal and Installation ..... 14</p> <p><b>SIDE DEFROSTER DUCT</b> .....15</p> <p style="padding-left: 20px;">SIDE DEFROSTER DUCT : Removal and Installation ..... 15</p> <p><b>REAR VENTILATOR GRILLE</b> .....15</p> <p style="padding-left: 20px;">REAR VENTILATOR GRILLE : Removal and Installation ..... 15</p> <p><b>REAR VENTILATOR DUCT 1</b> .....15</p> <p style="padding-left: 20px;">REAR VENTILATOR DUCT 1 : Removal and Installation ..... 16</p> <p><b>REAR VENTILATOR DUCT 2</b> .....16</p> <p style="padding-left: 20px;">REAR VENTILATOR DUCT 2 : Removal and Installation ..... 16</p> <p><b>FOOT GRILLE</b> .....16</p> <p style="padding-left: 20px;">FOOT GRILLE : Removal and Installation .....16</p> <p><b>FOOT DUCT</b> .....17</p> <p style="padding-left: 20px;">FOOT DUCT : Removal and Installation ..... 17</p> <p><b>HEATER DUCT</b> .....17</p> <p style="padding-left: 20px;">HEATER DUCT : Removal and Installation .....18</p> <p><b>REAR FLOOR DUCT 1</b> .....18</p>
---	--

A  
B  
C  
D  
E  
F  
G  
H  
VTL  
J  
K  
L  
M  
N  
O  
P

---

REAR FLOOR DUCT 1 : Removal and Installation		<b>BLOWER UNIT</b> .....	<b>20</b>
...	18	BLOWER UNIT : Removal and Installation .....	20
<b>BLOWER UNIT</b> .....	<b>19</b>	<b>BLOWER MOTOR</b> .....	<b>21</b>
Exploded View .....	19	BLOWER MOTOR : Removal and Installation .....	21

# SWITCHES AND THEIR CONTROL FUNCTION

< SYSTEM DESCRIPTION >

## SYSTEM DESCRIPTION

### SWITCHES AND THEIR CONTROL FUNCTION

System Description

INFOID:000000007460999

### SWITCHES AND THEIR CONTROL FUNCTION

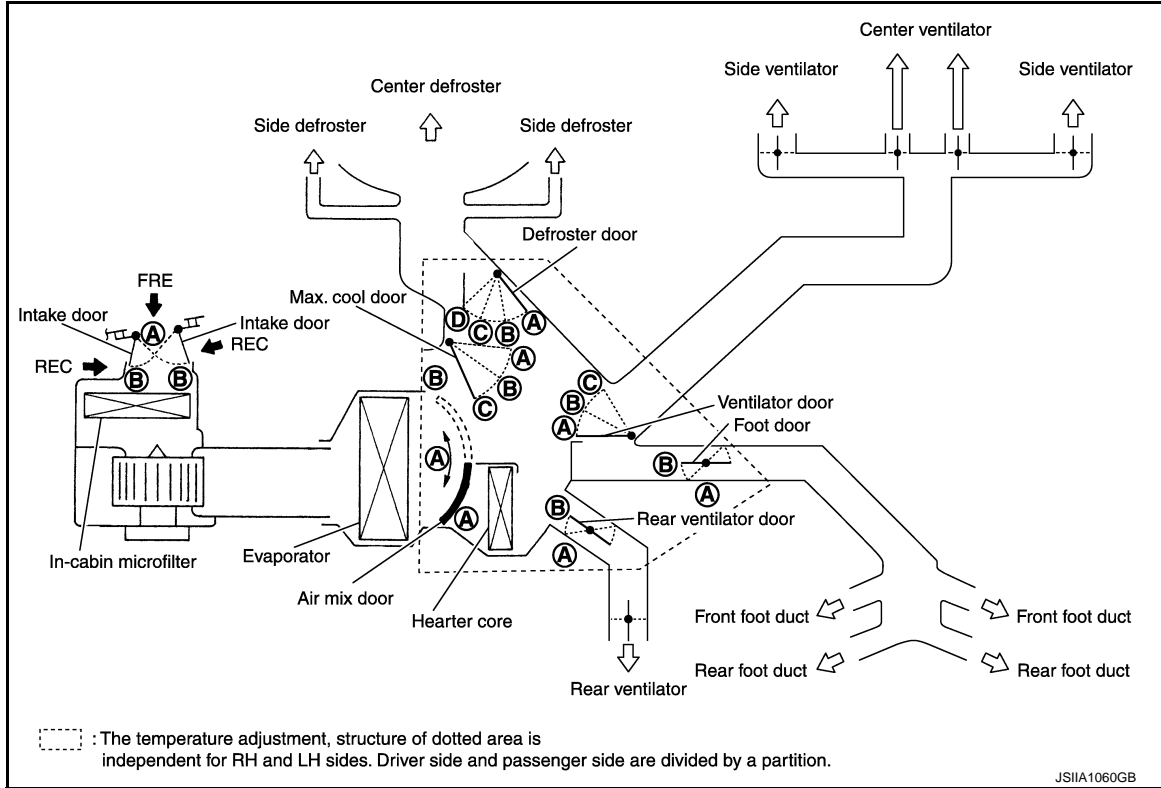

Without ACCS

Switch position		Door position						
		Ventila- tor door	Max. cool door	Defroster door	Foot door	Rear ventila- tor door	Intake door	Air mix door (Driver side)
AUTO switch	☀	AUTO						

# SWITCHES AND THEIR CONTROL FUNCTION

## < SYSTEM DESCRIPTION >

Switch position			Door position							Air mix door (Driver side)	Air mix door (Passenger side)
			Ventilator door	Max. cool door	Defroster door	Foot door	Rear ventilator door	Intake door			
MODE switch	VENT		A	A	D	B	B	—	—	—	
	B/L		B	B	D	B	B				
	FOOT		C	C	C	B	B				
	D/F				B	B	B	B			
DEF switch					A	A	A	B	—		
Intake switch	FRE								B*		
	REC								A*		
DUAL switch	DUAL									ON	
	OFF									OFF	
Temperature control dial (Driver side)	DUAL switch: OFF	18.0°C (60°F)								A	
		18.5°C ⇄ 31.5°C (61°F ⇄ 89°F)								AUTO	
		32.0°C (90°F)								B	
Temperature control dial (Driver side)	DUAL switch: ON	18.0°C (60°F)	—	—	—	—	—	—	A		
		18.5°C ⇄ 31.5°C (61°F ⇄ 89°F)							AUTO	—	
		32.0°C (90°F)							B		
Temperature control dial (Passenger side)	DUAL switch: ON	18.0°C (60°F)								A	
		18.5°C ⇄ 31.5°C (61°F ⇄ 89°F)							—	AUTO	
		32.0°C (90°F)								B	
OFF switch			C	C	C	B	B	B	—	—	

\*: Inlet status is displayed by indicator when activating automatic control

### With ACCS

Switch position		Door position							Air mix door (Driver side)	Air mix door (Passenger side)
		Ventilator door	Max. cool door	Defroster door	Foot door	Rear ventilator door	Intake door			
AUTO switch										AUTO

# SWITCHES AND THEIR CONTROL FUNCTION

## < SYSTEM DESCRIPTION >

Switch position			Door position							
			Ventila- tor door	Max. cool door	Defrost- er door	Foot door	Rear ventila- tor door	Intake door	Air mix door (Driver side)	Air mix door (Passen- ger side)
MODE switch	VENT		A	A	D	B	B	—	—	
	B/L		B	B	D	B	B			
	FOOT		C	C	C	B	B			
	D/F				B	B	B	B		
DEF switch					A	A	A	B	—	
Intake switch	AUTO							AUTO*2	—	
	REC							A*1	—	
	FRE							B*1	—	
DUAL switch	DUAL								ON	
	OFF								OFF	
Temperature control dial (Driver side)	DUAL switch: OFF	18.0°C (60°F)	—	—	—	—	—	—	A	
		18.5°C ↔ 31.5°C (61°F ↔ 89°F)							AUTO	
		32.0°C (90°F)							B	
Temperature control dial (Driver side)	DUAL switch: ON	18.0°C (60°F)	—	—	—	—	—	—	A	
		18.5°C ↔ 31.5°C (61°F ↔ 89°F)							AUTO	
		32.0°C (90°F)							B	
Temperature control dial (Passenger side)	DUAL switch: ON	18.0°C (60°F)	—	—	—	—	—	—	A	
		18.5°C ↔ 31.5°C (61°F ↔ 89°F)							—	
		32.0°C (90°F)							B	
OFF switch			C	C	C	B	B	B	—	—

\*1: Inlet status is displayed by indicator when activating automatic control

\*2: Intake door control applies a exhaust gas / outside odor detecting sensor





# AIR DISTRIBUTION

< SYSTEM DESCRIPTION >

## AIR DISTRIBUTION

### System Description

INFOID:000000007461000

Discharge air flow						
Mode position indication	Condition	Air outlet/distribution				
		VENT		FOOT		DEF
		Front	Rear	Front	Rear	
	DUAL switch: OFF Rear ventilator : OPEN	88%	12%	—	—	—
		49%	10%	25%	16%	—
		10%	12%	33%	22%	23%
		9%	11%	29%	18%	33%
		15%	—	—	—	85%

JSIIA0888GB

# PRECAUTIONS

< PRECAUTION >

## PRECAUTION

### PRECAUTIONS

#### Precaution for Supplemental Restraint System (SRS) "AIR BAG" and "SEAT BELT PRE-TENSIONER"

INFOID:000000007461001

The Supplemental Restraint System such as "AIR BAG" and "SEAT BELT PRE-TENSIONER", used along with a front seat belt, helps to reduce the risk or severity of injury to the driver and front passenger for certain types of collision. This system includes seat belt switch inputs and dual stage front air bag modules. The SRS system uses the seat belt switches to determine the front air bag deployment, and may only deploy one front air bag, depending on the severity of a collision and whether the front occupants are belted or unbelted. Information necessary to service the system safely is included in the "SRS AIR BAG" and "SEAT BELT" of this Service Manual.

#### **WARNING:**

Always observe the following items for preventing accidental activation.

- To avoid rendering the SRS inoperative, which could increase the risk of personal injury or death in the event of a collision that would result in air bag inflation, all maintenance must be performed by an authorized NISSAN/INFINITI dealer.
- Improper maintenance, including incorrect removal and installation of the SRS, can lead to personal injury caused by unintentional activation of the system. For removal of Spiral Cable and Air Bag Module, see "SRS AIR BAG".
- Never use electrical test equipment on any circuit related to the SRS unless instructed to in this Service Manual. SRS wiring harnesses can be identified by yellow and/or orange harnesses or harness connectors.

#### PRECAUTIONS WHEN USING POWER TOOLS (AIR OR ELECTRIC) AND HAMMERS

#### **WARNING:**

Always observe the following items for preventing accidental activation.

- When working near the Air Bag Diagnosis Sensor Unit or other Air Bag System sensors with the ignition ON or engine running, never use air or electric power tools or strike near the sensor(s) with a hammer. Heavy vibration could activate the sensor(s) and deploy the air bag(s), possibly causing serious injury.
- When using air or electric power tools or hammers, always switch the ignition OFF, disconnect the battery, and wait at least 3 minutes before performing any service.

#### Precautions Necessary for Steering Wheel Rotation After Battery Disconnection

INFOID:000000007461002

#### **CAUTION:**

Comply with the following cautions to prevent any error and malfunction.

- Before removing and installing any control units, first turn the ignition switch to the LOCK position, then disconnect both battery cables.
- After finishing work, confirm that all control unit connectors are connected properly, then re-connect both battery cables.
- Always use CONSULT to perform self-diagnosis as a part of each function inspection after finishing work. If a DTC is detected, perform trouble diagnosis according to self-diagnosis results.

For vehicle with steering lock unit, if the battery is disconnected or discharged, the steering wheel will lock and cannot be turned.

If turning the steering wheel is required with the battery disconnected or discharged, follow the operation procedure below before starting the repair operation.

#### OPERATION PROCEDURE

1. Connect both battery cables.

#### **NOTE:**

Supply power using jumper cables if battery is discharged.

2. Turn the ignition switch to ACC position.  
(At this time, the steering lock will be released.)
3. Disconnect both battery cables. The steering lock will remain released with both battery cables disconnected and the steering wheel can be turned.

A  
B  
C  
D  
E  
F  
G  
H  
VTL  
J  
K  
L  
M  
N  
O  
P

## PRECAUTIONS

### < PRECAUTION >

---

4. Perform the necessary repair operation.
5. When the repair work is completed, re-connect both battery cables. With the brake pedal released, turn the ignition switch from ACC position to ON position, then to LOCK position. (The steering wheel will lock when the ignition switch is turned to LOCK position.)
6. Perform self-diagnosis check of all control units using CONSULT.



# PREPARATION

< PREPARATION >

## PREPARATION

### PREPARATION

#### Commercial Service Tool

INFOID:000000007461003

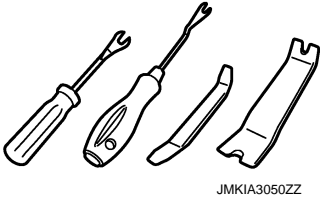
Tool name	Description
Remover tool  JMKIA3050ZZ	Remove clips, pawls and metal clips

A  
B  
C  
D  
E  
F  
G  
H  
J  
K  
L  
M  
N  
O  
P

VTL

# IN-CABIN MICROFILTER

< PERIODIC MAINTENANCE >

## PERIODIC MAINTENANCE

### IN-CABIN MICROFILTER

Exploded View

INFOID:000000007461004

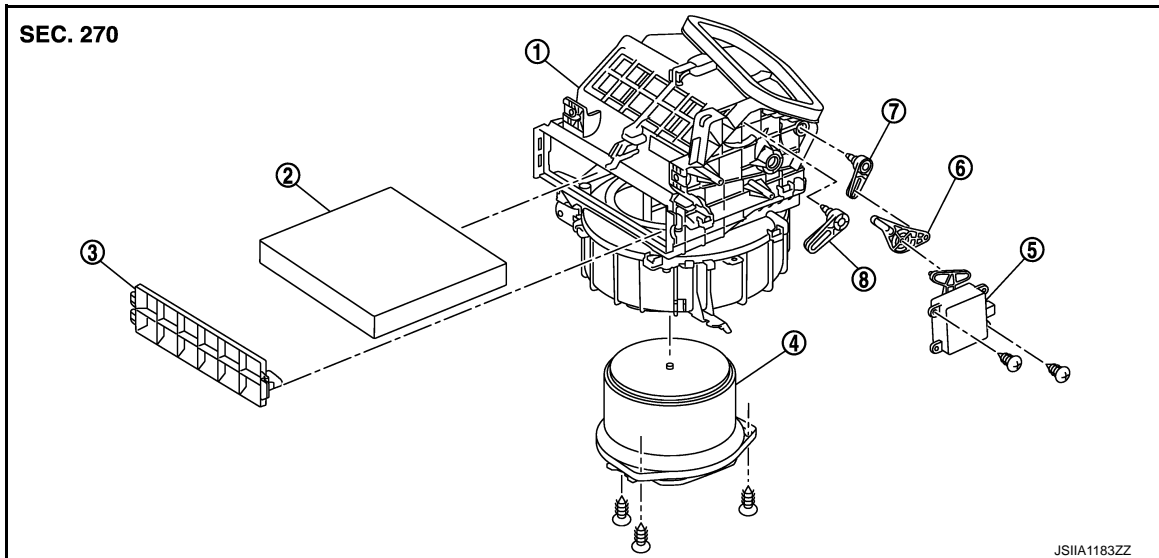

- |                          |                         |                     |
|--------------------------|-------------------------|---------------------|
| 1. Blower unit           | 2. In-cabin microfilter | 3. Filter cover     |
| 4. Blower motor assembly | 5. Intake door motor    | 6. Intake door link |
| 7. Intake door lever 1   | 8. Intake door lever 2  |                     |

## Removal and Installation

INFOID:000000007461005

### REMOVAL

1. Remove instrument lower panel RH. Refer to [IP-12, "Exploded View"](#).
2. Remove filter cover (1), and then remove in-cabin microfilter (2).

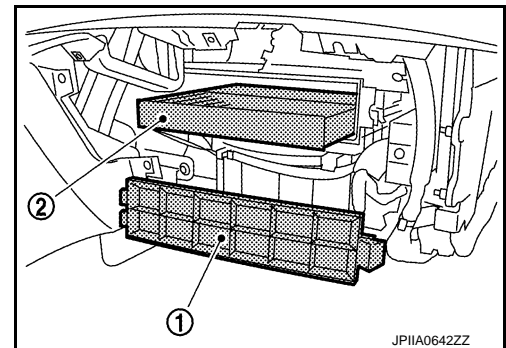

### INSTALLATION

Note the following items, and then install in the reverse order of removal.

#### CAUTION:

- If the filter is deformed/damaged when removing, replace it with a new one. Deformed/damaged filter may deteriorate the duct collecting performance.
- When installing, handle the filter with extreme care to avoid deforming/damaging.

### Replacement

INFOID:000000007461006

Replace in-cabin microfilter.

Refer to [MA-6, "Schedule 1"](#) and [MA-8, "Schedule 2"](#).

Affix a caution label inside the glove box when replacing filter.

# DUCT AND GRILLE

< REMOVAL AND INSTALLATION >

## REMOVAL AND INSTALLATION

### DUCT AND GRILLE

Exploded View

INFOID:000000007461007

FRONT

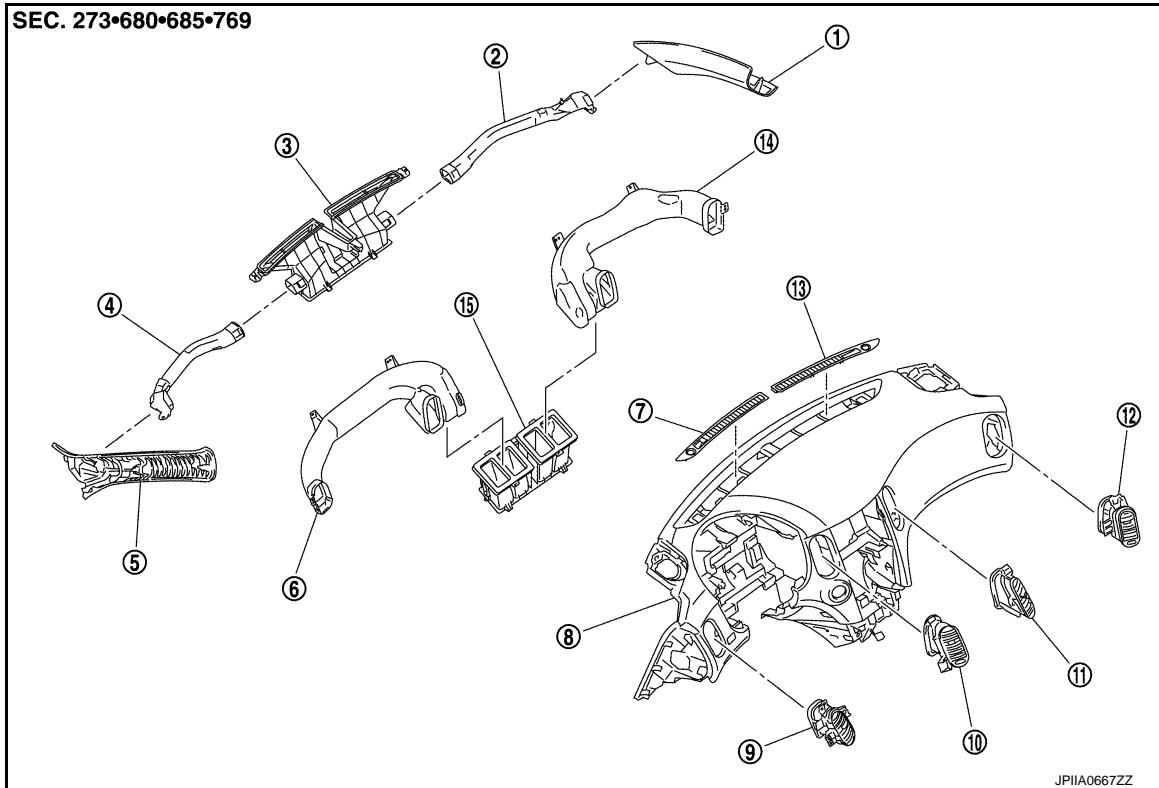

- |  |  |                               |
|--|--|-------------------------------|
| 1. Side defroster duct RH<br>(Front pillar garnish RH) | 2. Side defroster nozzle RH                            | 3. Defroster nozzle           |
| 4. Side defroster nozzle LH                            | 5. Side defroster duct LH<br>(Front pillar garnish LH) | 6. Ventilator duct LH         |
| 7. Front defroster grille LH                           | 8. Instrument panel assembly                           | 9. Side ventilator grille LH  |
| 10. Center ventilator grille LH                        | 11. Center ventilator grille RH                        | 12. Side ventilator grille RH |
| 13. Front defroster grille RH                          | 14. Ventilator duct RH                                 | 15. Adaptor duct              |

REAR

A  
B  
C  
D  
E  
F  
G  
H  
VTL  
J  
K  
L  
M  
N  
O  
P

# DUCT AND GRILLE

< REMOVAL AND INSTALLATION >

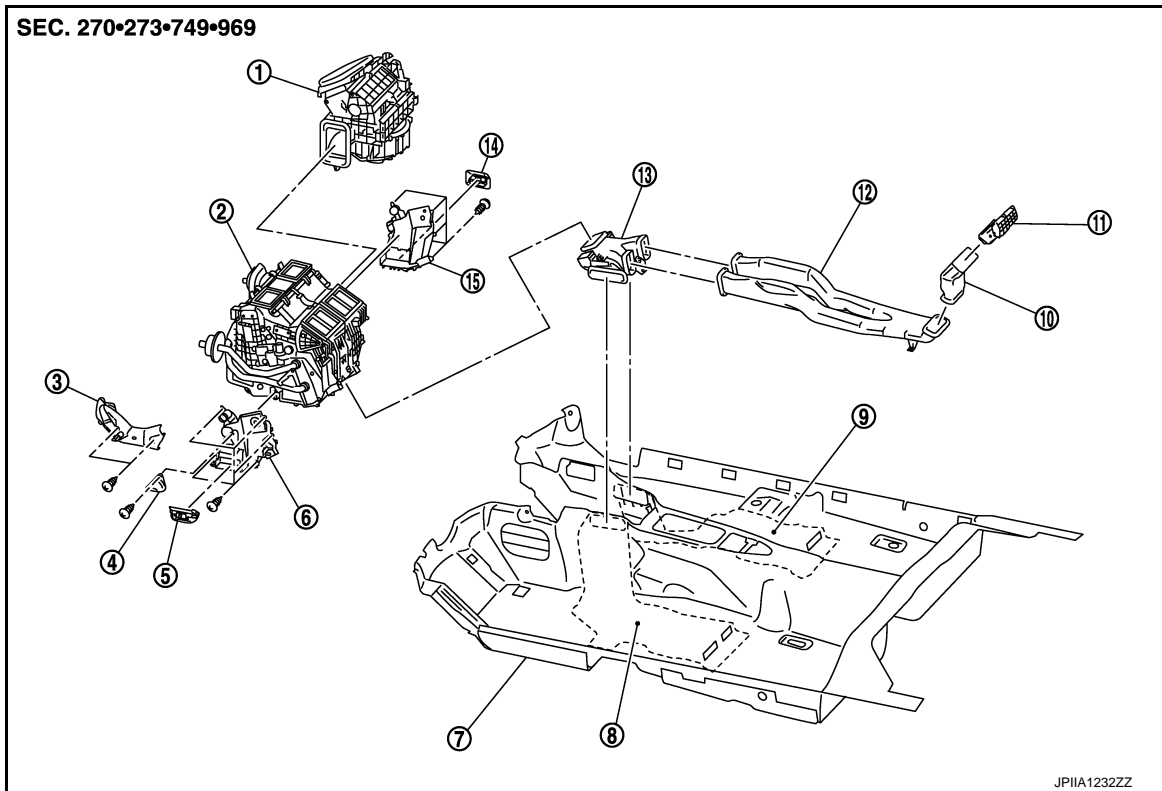

- |                            |                                   |                            |
|----------------------------|-----------------------------------|----------------------------|
| 1. Blower unit             | 2. Heater & cooling unit assembly | 3. Heater pipe cover       |
| 4. Heater duct             | 5. Foot grille LH                 | 6. Foot duct LH            |
| 7. Floor carpet            | 8. Rear floor duct 2 LH           | 9. Rear floor duct 2 RH    |
| 10. Rear ventilator duct 2 | 11. Rear ventilator grille        | 12. Rear ventilator duct 1 |
| 13. Rear floor duct 1      | 14. Foot grille RH                | 15. Foot duct RH           |

## CENTER VENTILATOR GRILLE

### CENTER VENTILATOR GRILLE : Removal and Installation

INFOID:000000007461008

#### REMOVAL

1. Remove instrument panel assembly. Refer to [IP-12. "Exploded View"](#).
2. Remove fixing screws (A), and then remove center ventilator grille (1).

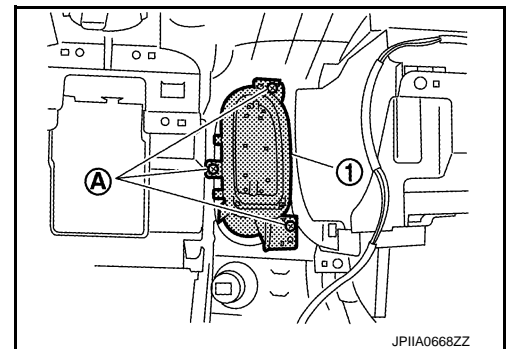

#### INSTALLATION

Install in the reverse order of removal.

## SIDE VENTILATOR GRILLE

### SIDE VENTILATOR GRILLE : Removal and Installation

INFOID:000000007461009

#### REMOVAL

# DUCT AND GRILLE

## < REMOVAL AND INSTALLATION >

1. Remove instrument panel assembly. Refer to [IP-12. "Exploded View"](#).
2. Remove fixing screws (A), and then remove side ventilator grille (1).

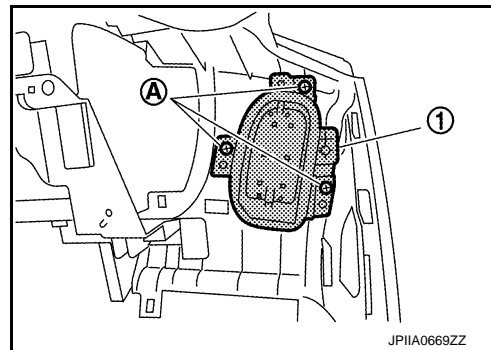

## INSTALLATION

Install in the reverse order of removal.

## FRONT DEFROSTER GRILLE

### FRONT DEFROSTER GRILLE : Removal and Installation

INFOID:000000007461010

## REMOVAL

Remove front defroster grilles (1), using a remover tool (A).

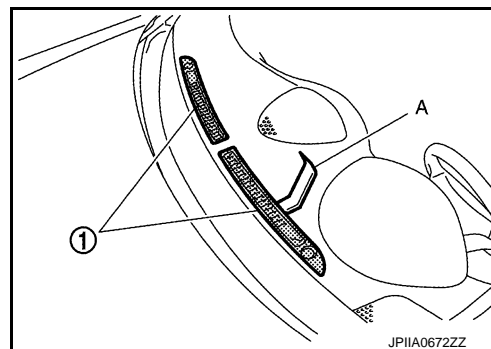

## INSTALLATION

Install in the reverse order of removal.

## VENTILATOR DUCT

### VENTILATOR DUCT : Removal and Installation

INFOID:000000007461011

## REMOVAL

1. Remove instrument panel assembly. Refer to [IP-12. "Exploded View"](#).
2. Remove fixing screws (A), and then remove ventilator duct LH (1) and RH (2).

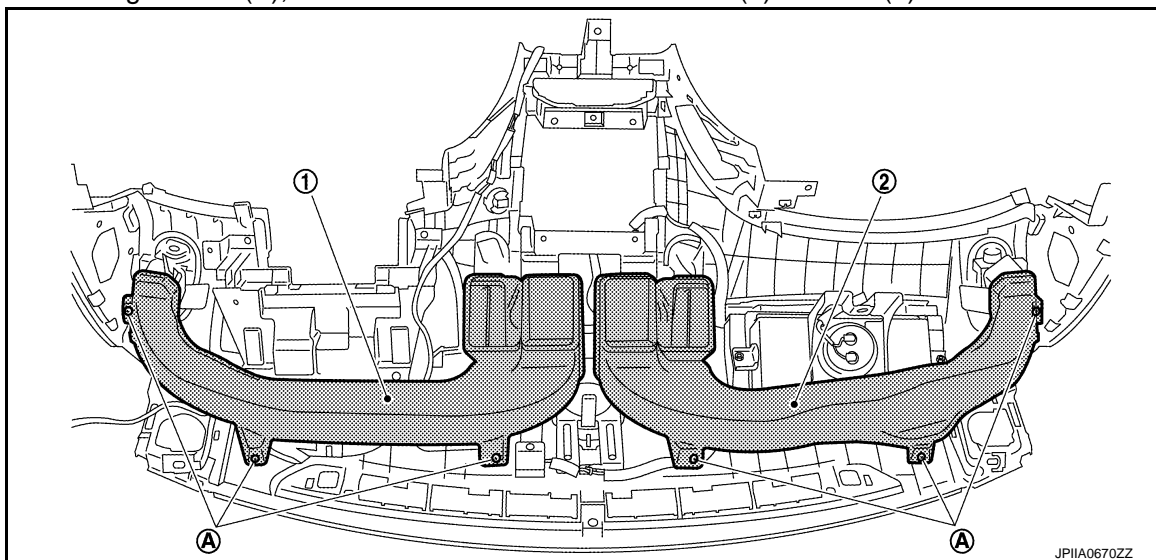

A  
B  
C  
D  
E  
F  
G  
H  
VTL  
J  
K  
L  
M  
N  
O  
P

## DUCT AND GRILLE

< REMOVAL AND INSTALLATION >

### INSTALLATION

Install in the reverse order of removal.

### ADAPTOR DUCT

#### ADAPTOR DUCT : Removal and Installation

INFOID:000000007461012

#### REMOVAL

1. Remove instrument panel assembly. Refer to [IP-12, "Exploded View"](#).
2. Remove fixing screw (A), and then remove adaptor duct (1).

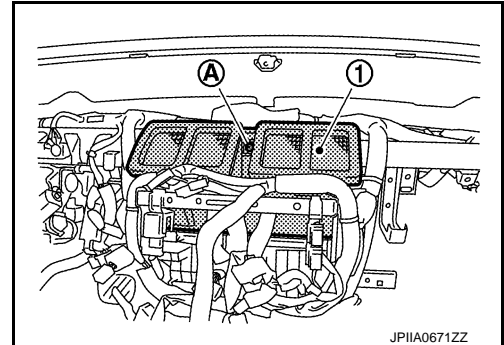

### INSTALLATION

Install in the reverse order of removal.

### DEFROSTER NOZZLE

#### DEFROSTER NOZZLE : Removal and Installation

INFOID:000000007461013

#### REMOVAL

1. Remove side defroster nozzles. Refer to [VTL-11, "Exploded View"](#).
2. Remove defroster nozzle (1).

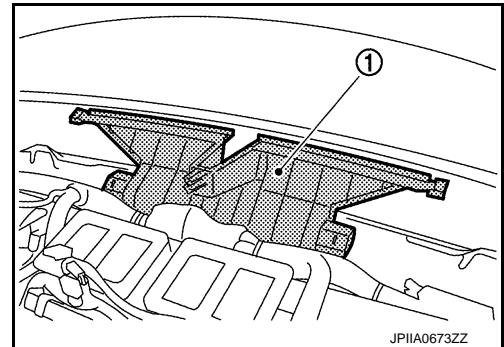

### INSTALLATION

Install in the reverse order of removal.

### SIDE DEFROSTER NOZZLE

#### SIDE DEFROSTER NOZZLE : Removal and Installation

INFOID:000000007461014

#### REMOVAL

Driver Side

1. Remove instrument panel assembly. Refer to [IP-12, "Exploded View"](#).

# DUCT AND GRILLE

## < REMOVAL AND INSTALLATION >

2. Remove fixing clip (A), and then remove side defroster nozzle LH (1).

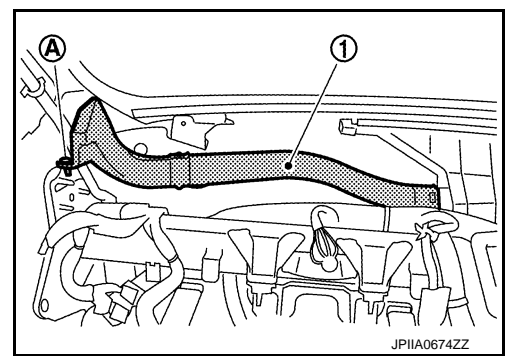

Passenger Side

- Remove fixing clip (A) and harness clip (B), and then remove side defroster nozzle RH (1).

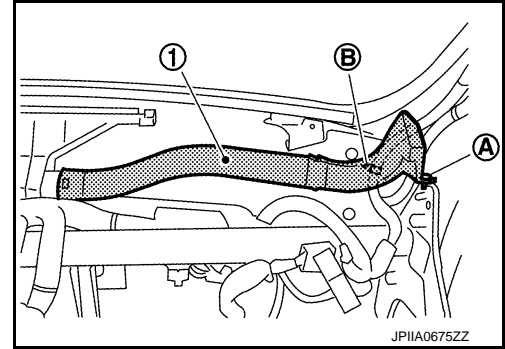

## INSTALLATION

Install in the reverse order of removal.

## SIDE DEFROSTER DUCT

### SIDE DEFROSTER DUCT : Removal and Installation

INFOID:000000007461015

## REMOVAL

- Remove front pillar garnish. Refer to [INT-20, "Exploded View"](#).

## INSTALLATION

Install in the reverse order of removal.

## REAR VENTILATOR GRILLE

### REAR VENTILATOR GRILLE : Removal and Installation

INFOID:000000007461016

## REMOVAL

1. Remove console rear finisher. Refer to [IP-22, "Exploded View"](#).
2. Disengage fixing pawls, and then remove rear ventilator grille (1).

 Pawl

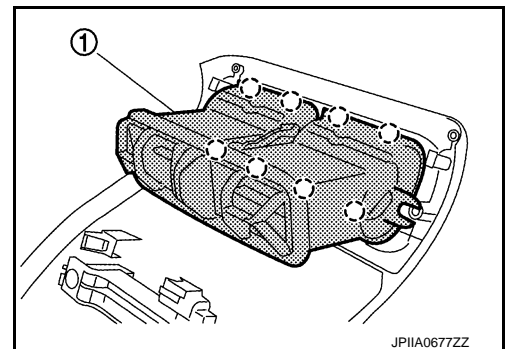

## INSTALLATION

Install in the reverse order of removal.

## REAR VENTILATOR DUCT 1

A  
B  
C  
D  
E  
F  
G  
H  
J  
K  
L  
M  
N  
O  
P

VTL

# DUCT AND GRILLE

< REMOVAL AND INSTALLATION >

## REAR VENTILATOR DUCT 1 : Removal and Installation

INFOID:000000007461017

### REMOVAL

1. Remove center console assembly. Refer to [IP-22, "Exploded View"](#).
2. Remove fixing screws (A), and then remove rear ventilator duct 1 (1).

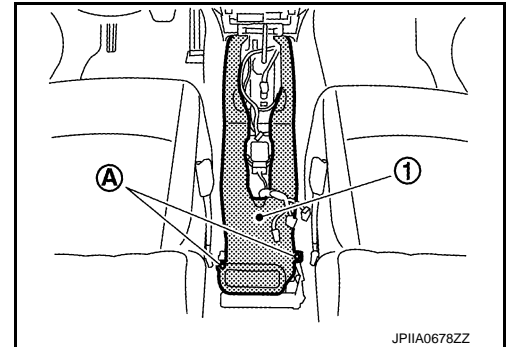

### INSTALLATION

Install in the reverse order of removal.

## REAR VENTILATOR DUCT 2

## REAR VENTILATOR DUCT 2 : Removal and Installation

INFOID:000000007461018

### REMOVAL

1. Remove console rear finisher. Refer to [IP-12, "Exploded View"](#).
2. Remove rear ventilator duct 2 (1).

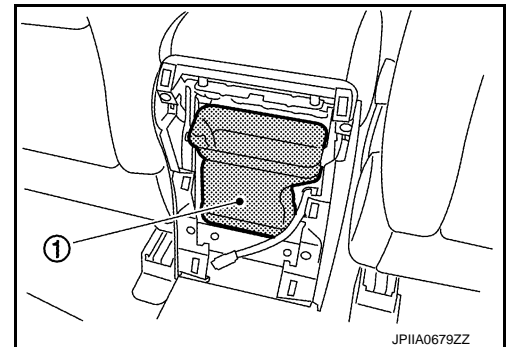

### INSTALLATION

Install in the reverse order of removal.

## FOOT GRILLE

## FOOT GRILLE : Removal and Installation

INFOID:000000007461019

### REMOVAL

Driver Side

Disengage fixing pawls, and then remove foot grille LH (1).



Pawl

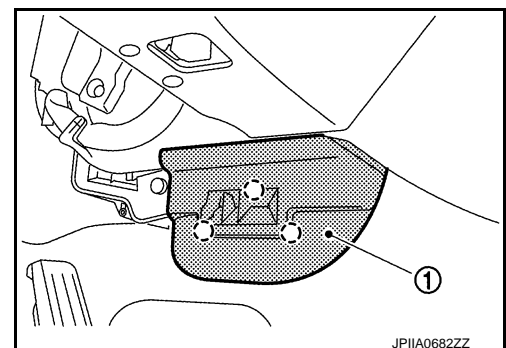

Passenger Side



# DUCT AND GRILLE

## < REMOVAL AND INSTALLATION >

Disengage fixing pawls, and then remove foot grille RH (1).

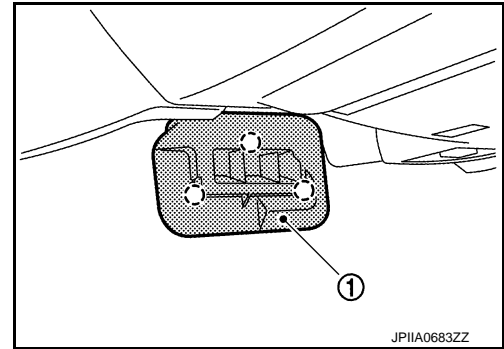

## INSTALLATION

Install in the reverse order of removal.

## FOOT DUCT

### FOOT DUCT : Removal and Installation

INFOID:000000007461020

## REMOVAL

### Driver Side

1. Remove fixing screws (A), and then remove heater pipe cover (1).
2. Remove fixing screws (B), and then remove foot duct LH (2).

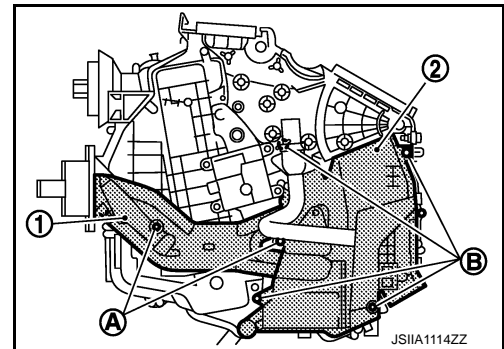

### Passenger Side

1. Set the temperature at 18°C (64°F).

#### **CAUTION:**

**The angle may be out, when installing the air mix door motor to the air mix door, unless the above procedure is performed.**

2. Disconnect the battery cable from the negative terminal.
3. Remove heater & cooling unit assembly. Refer to [HA-51. "Exploded View"](#).
4. Remove air mix door motor. Refer to [HAC-132. "Exploded View"](#).
5. Remove mode door motor and links. Refer to [HAC-132. "Exploded View"](#).
6. Remove fixing screws (A), and then remove evaporator cover (1).
7. Remove fixing screws (B), and then remove foot duct RH (2).

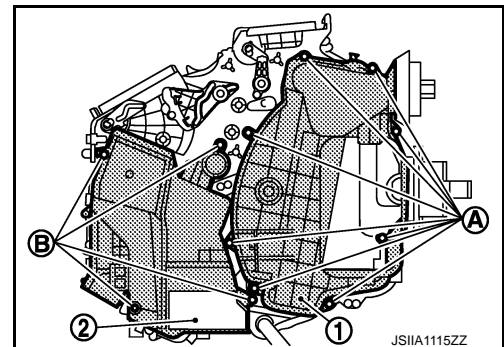

## INSTALLATION

Install in the reverse order of removal.

## HEATER DUCT

A  
B  
C  
D  
E  
F  
G  
H  
VTL  
J  
K  
L  
M  
N  
O  
P

## DUCT AND GRILLE

< REMOVAL AND INSTALLATION >

### HEATER DUCT : Removal and Installation

INFOID:000000007461021

#### REMOVAL

1. Remove instrument lower panel LH. Refer to [IP-12, "Exploded View"](#).
2. Remove fixing screw, and then remove heater duct.

#### INSTALLATION

Install in the reverse order of removal.

### REAR FLOOR DUCT 1

### REAR FLOOR DUCT 1 : Removal and Installation

INFOID:000000007461022

#### REMOVAL

1. Remove instrument panel assembly. Refer to [IP-12, "Exploded View"](#).
2. Remove fixing clips (A), and then remove rear floor duct 1 (1).

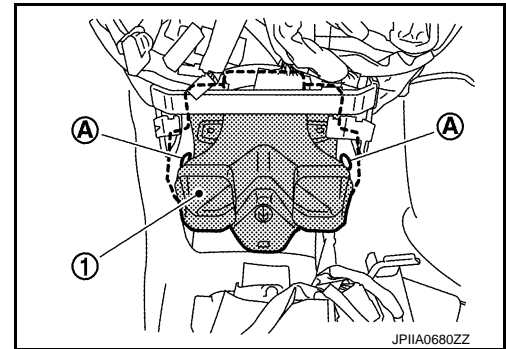

#### INSTALLATION

Install in the reverse order of removal.

# BLOWER UNIT

< REMOVAL AND INSTALLATION >

## BLOWER UNIT

Exploded View

INFOID:000000007461023

### REMOVAL

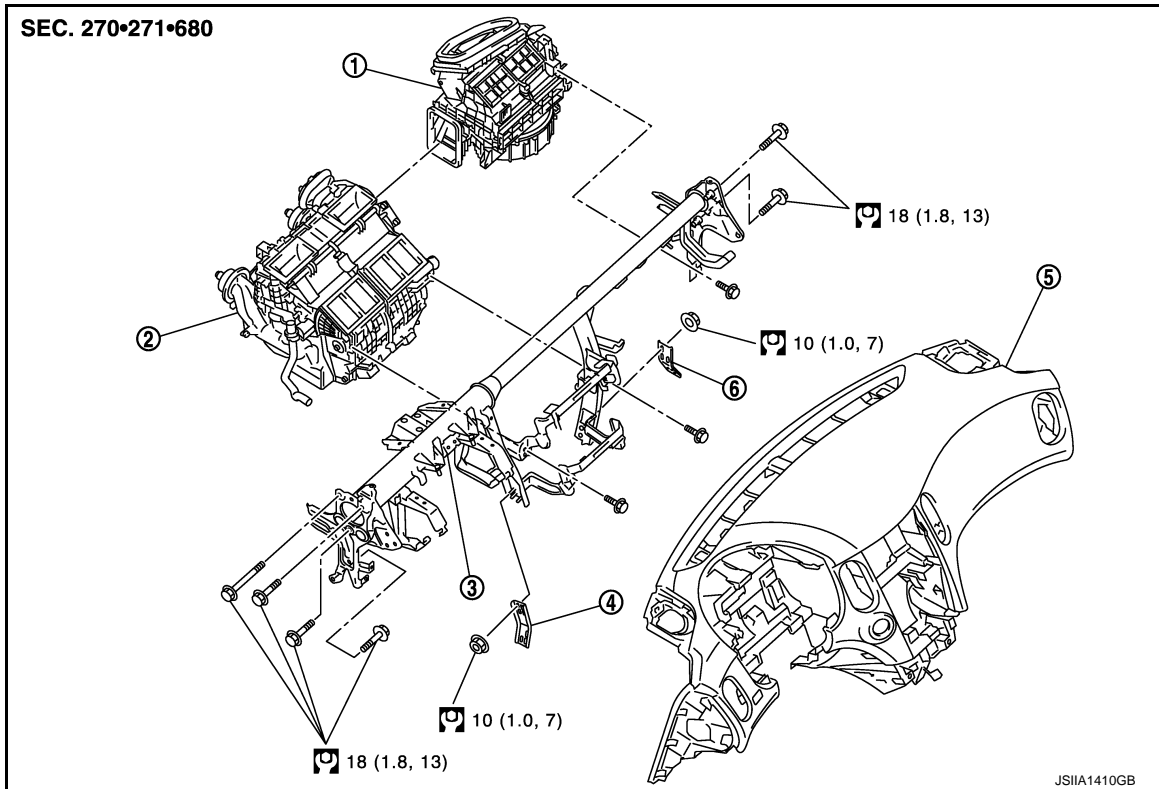

- |                       |                                   |                       |
|-----------------------|-----------------------------------|-----------------------|
| 1. Blower unit        | 2. Heater & cooling unit assembly | 3. Steering member    |
| 4. Instrument stay LH | 5. Instrument panel assembly      | 6. Instrument stay RH |

Refer to [GI-4, "Components"](#) for symbols in the figure.

### DISASSEMBLY

A  
B  
C  
D  
E  
F  
G  
H  
VTL  
J  
K  
L  
M  
N  
O  
P

# BLOWER UNIT

## < REMOVAL AND INSTALLATION >

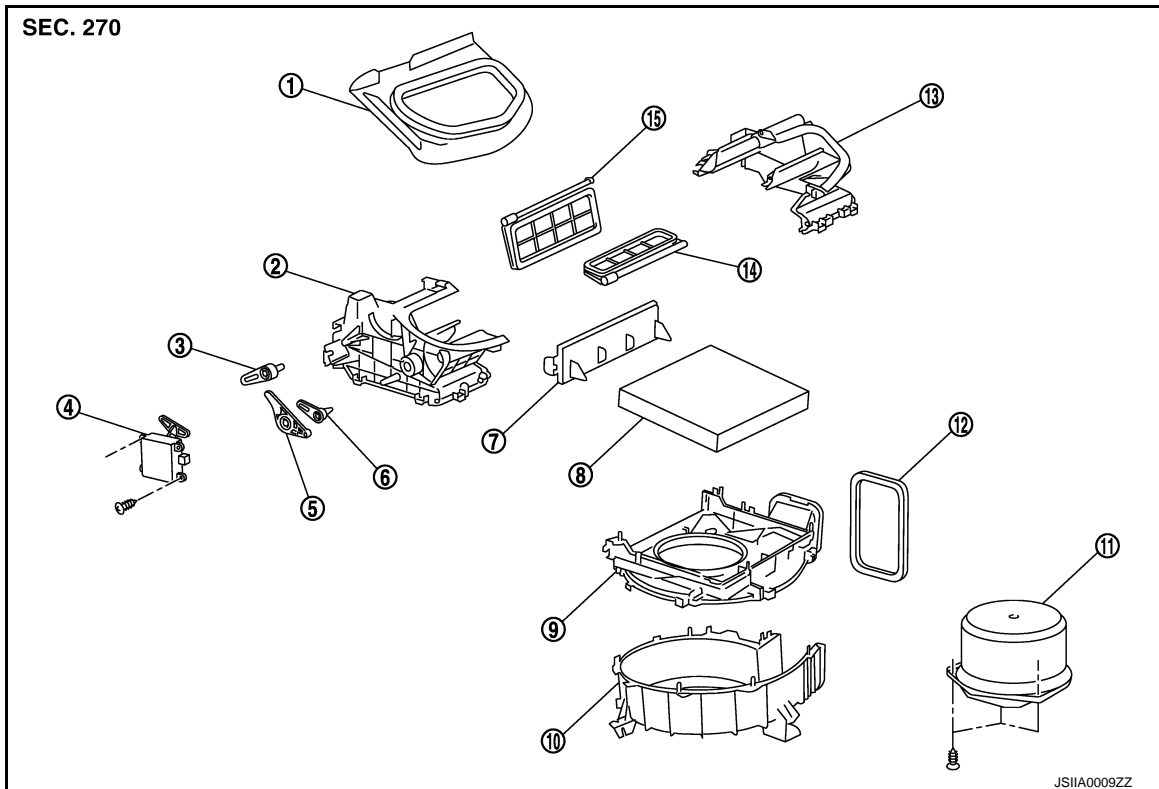

- |                       |                           |                        |
|-----------------------|---------------------------|------------------------|
| 1. Adapter            | 2. Intake box RH          | 3. Intake door lever 2 |
| 4. Intake door motor  | 5. Intake door link       | 6. Intake door lever 1 |
| 7. Filter cover       | 8. In-cabin microfilter   | 9. Intake upper case   |
| 10. Intake lower case | 11. Blower motor assembly | 12. Seal               |
| 13. Intake box LH     | 14. Intake door 1         | 15. Intake door 2      |

## BLOWER UNIT

### BLOWER UNIT : Removal and Installation

INFOID:000000007461024

#### REMOVAL

1. Remove instrument lower panel RH. Refer to [IP-12, "Exploded View"](#).
2. Disconnect AWD control unit connector (AWD). Refer to [DLN-57, "Removal and Installation"](#).
3. Disconnect ECM (1) connectors.
4. Remove mounting nuts (A), and then remove ECM with bracket attached.
5. Remove power steering control unit. Refer to [STC-21, "Exploded View"](#).

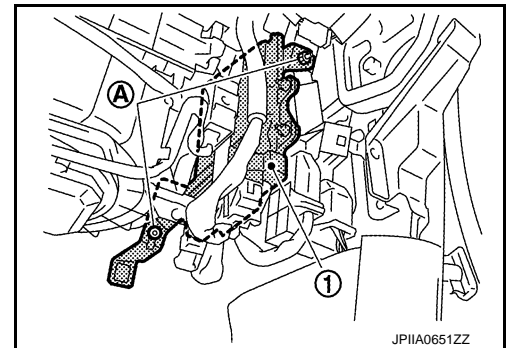

6. Disconnect intake door motor connector and blower motor connector.

# BLOWER UNIT

## < REMOVAL AND INSTALLATION >

7. Remove mounting bolt (A) and fixing screw (B), and then remove blower unit (1).

**CAUTION:**

Move blower unit rightward, and remove locating pin (1 part) and joint. Then remove blower unit downward.

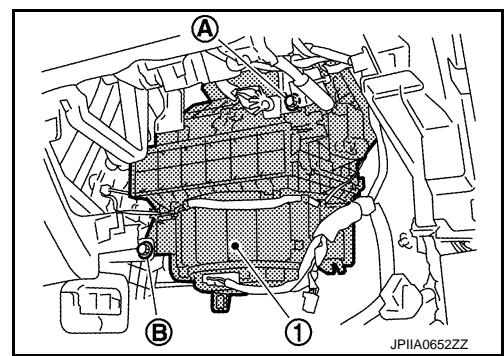

## INSTALLATION

Note the following item, and then install in the reverse order of removal.

**CAUTION:**

Make sure locating pin (A) and joint (B) are securely inserted.

←: Vehicle front

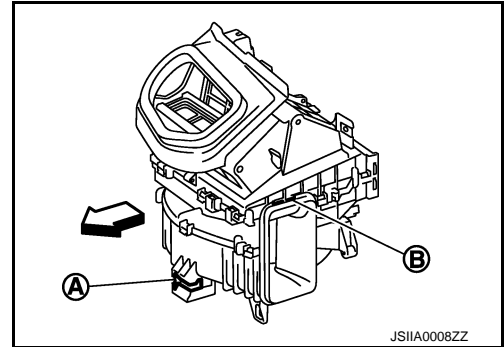

## BLOWER MOTOR

### BLOWER MOTOR : Removal and Installation

INFOID:000000007461025

VTL

## REMOVAL

1. Remove instrument lower cover. Refer to [IP-12. "Exploded View"](#).
2. Disconnect blower motor connector.
3. Remove fixing screws (A), and then remove blower motor (1).

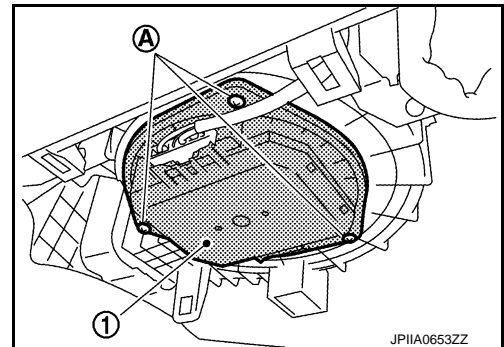

## INSTALLATION

Install in the reverse order of removal.