

SECTION **PWO**
POWER OUTLET

A
B
C
D
E
F
G
H
I
J
K
L
N
O
P

CONTENTS

HOW TO USE THIS MANUAL	2	POWER SOCKET	19
HOW TO USE THIS MANUAL	2	FRONT POWER SOCKET	19
Application Notice	2	FRONT POWER SOCKET : Exploded View	19
DTC/CIRCUIT DIAGNOSIS	3	FRONT POWER SOCKET : Removal and Installation	19
POWER SOCKET	3	CONSOLE POWER SOCKET	19
TYPE A	3	CONSOLE POWER SOCKET : Exploded View	20
TYPE A : Wiring Diagram - POWER SOCKET -	3	CONSOLE POWER SOCKET : Removal and Installation	20
TYPE B	10	REAR POWER SOCKET	20
TYPE B : Wiring Diagram - POWER SOCKET -	11	REAR POWER SOCKET : Exploded View	20
PRECAUTION	18	REAR POWER SOCKET : Removal and Installation	20
PRECAUTIONS	18	LUGGAGE ROOM POWER SOCKET	21
Precaution for Supplemental Restraint System (SRS) "AIR BAG" and "SEAT BELT PRE-TENSIONER"	18	LUGGAGE ROOM POWER SOCKET : Exploded View	21
REMOVAL AND INSTALLATION	19	LUGGAGE ROOM POWER SOCKET : Removal and Installation	21

PWO

HOW TO USE THIS MANUAL

< HOW TO USE THIS MANUAL >

HOW TO USE THIS MANUAL

HOW TO USE THIS MANUAL

Application Notice

INFOID:000000007095816

Check vehicle identification number to use the corresponding service information in this manual.

Service information	Vehicle identification number
TYPE A	Up to VIN: JN8AS1MU*BM710003 JN8AS1MW*BM730002 JN8BS1MW*BM760006
TYPE B	From VIN: JN8AS1MU*BM710004 JN8AS1MW*BM730003 JN8BS1MW*BM760007

*: Refer to [GI-24, "Information About Identification or Model Code"](#) to vehicle identification number

POWER SOCKET

< DTC/CIRCUIT DIAGNOSIS >

DTC/CIRCUIT DIAGNOSIS

POWER SOCKET

TYPE A

TYPE A : Wiring Diagram - POWER SOCKET -

INFOID:000000006567930

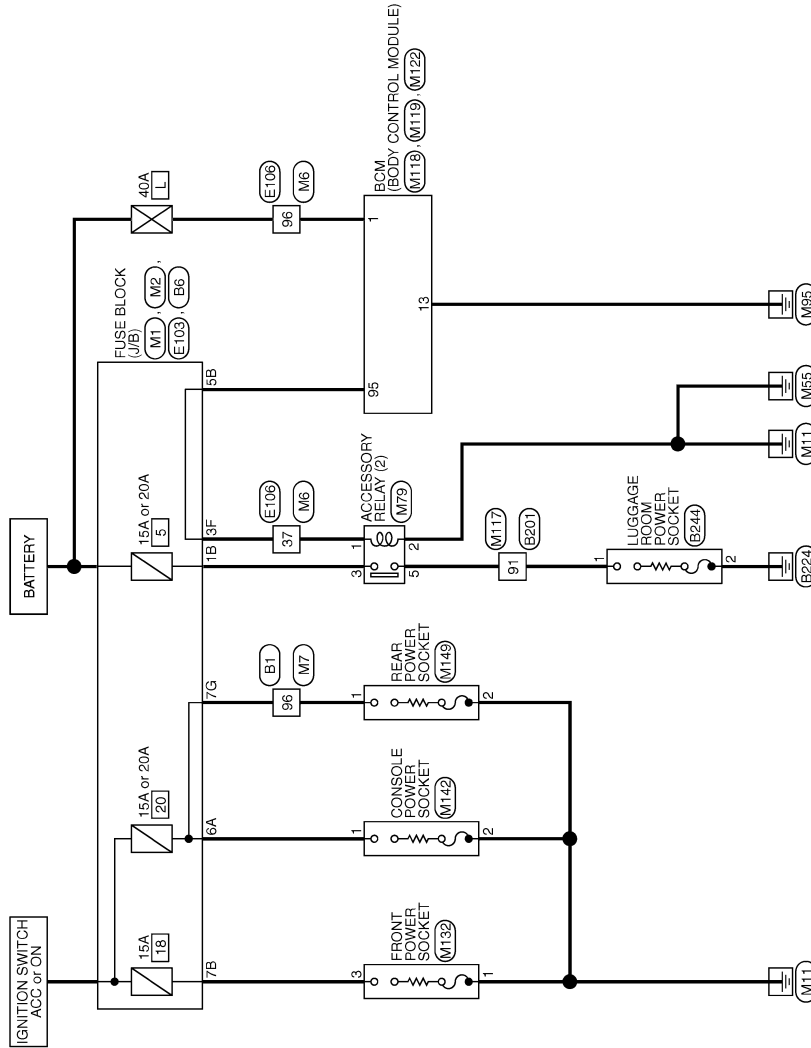

POWER SOCKET

POWER SOCKET

< DTC/CIRCUIT DIAGNOSIS >

POWER SOCKET

Connector No.	B1
Connector Name	WIRE TO WIRE
Connector Type	THBDFW-CS16-1M4

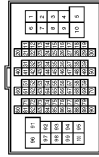

Terminal No.	Color of Wire	Signal Name [Specification]
1	G	-
2	L	-
3	W	-
5	G	-
6	G	-
7	P	-
8	O	-
9	W	-
10	SB	-
11	SB	-
12	B	-
13	G	-
14	R	-
15	W	-
16	SHIELD	-
17	L	-
18	P	-
19	G	-
20	Y	-
21	W	-
23	V	-
24	P	-
25	BR	-
26	GR	-
27	O	-
28	W	-
29	SHIELD	-
38	B	-
39	B	-
40	LG	-
41	G	-
42	GR	-
43	SB	-
44	V	-
45	GR	-
50	B	-
51	V	-
52	SB	-

53	SHIELD	-
54	BR	-
55	Y	-
56	SHIELD	-
57	P	-
58	L	-
59	SHIELD	-
60	L	-
61	P	-
62	GR	-
63	G	-
64	O	-
65	W	-
66	V	-
67	LG	-
68	Y	-
69	G	-
70	GR	-
71	G	-
72	B	-
73	W	-
74	V	-
75	O	-
76	LG	-
77	L	-
78	GR	-
79	W	-
80	L	-
81	P	-
82	L	-
83	P	-
84	SB	-
85	R	-
86	Y	-
87	B	-
88	G	-
89	BR	-
90	W	-
91	R	-
92	O	-
93	BR	-
94	V	-
95	Y	-
96	O	-
97	W	-
98	GR	-
99	W	-

Connector No.	B6
Connector Name	FUSE BLOCK (J/B)
Connector Type	NS12FBR-CS



Terminal No.	Color of Wire	Signal Name [Specification]
4G	R	-
5G	LG	-
7G	O	-
10G	W	-
11G	W	-
12G	GR	-

JCMWA4946GB

POWER SOCKET

< DTC/CIRCUIT DIAGNOSIS >

A
B
C
D
E
F
G
H
I
J
K
L
N
O
P

POWER SOCKET

Connector No.	B201
Connector Name	WIRE TO WIRE
Connector Type	TH02FW-CS16-TM4

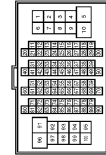

Terminal No.	Color of Wire	Signal Name [Specification]
1	G	-
2	R	-
3	BR	-
4	SB	-
6	O	-
7	GR	-
8	W	-
10	G	-
11	BR	-
12	Y	-
13	SHIELD	-
14	G	-
15	R	-
16	SHIELD	-
17	LG	-
18	GR	-
19	V	-
20	SB	-
21	LG	-
22	B	- [With entertainment system] - [Without entertainment system]
22	GR	- [With entertainment system] - [Without entertainment system]
23	W	- [With entertainment system] - [Without entertainment system]
23	LG	- [With entertainment system] - [Without entertainment system]
24	R	- [With entertainment system] - [Without entertainment system]
24	W	- [With entertainment system] - [Without entertainment system]
25	SHIELD	- [With entertainment system] - [Without entertainment system]
25	V	- [With entertainment system] - [Without entertainment system]
26	SB	-
27	V	-
28	SHIELD	-
29	O	-
30	P	-
31	W	-
32	GR	-
33	SB	-
33	LG	-
40	V	- [With ICC] - [Without ICC]
41	SB	- [With ICC] - [Without ICC]

41	Y	- [Without ICC] - [With ICC]
42	V	- [Without ICC] - [With ICC]
42	W	- [Without ICC] - [With ICC]
43	BR	- [Without ICC] - [With ICC]
43	B	- [Without ICC] - [With ICC]
44	R	-
44	G	-
45	O	-
46	SHIELD	- [With ICC] - [Without ICC]
47	L	- [With ICC] - [Without ICC]
47	B	- [Without ICC] - [With ICC]
48	P	- [With ICC] - [Without ICC]
48	R	- [Without ICC] - [With ICC]
49	G	- [Without ICC] - [With ICC]
49	W	- [Without ICC] - [With ICC]
50	SHIELD	-
51	W	-
52	R	-
53	G	-
54	L	-
55	SB	-
60	GR	-
61	LG	-
62	SB	-
63	P	-
64	BR	-
65	R	-
66	V	-
67	W	-
68	SHIELD	-
69	G	-
71	SB	-
72	V	-
73	LG	-
74	W	-
75	BR	-
76	V	-
77	LG	-
80	O	-
81	G	-
82	P	-
83	Y	-
84	R	-
85	SB	-
86	GR	-
87	L	-
91	V	-
92	W	-
92	R	-
93	R	-
94	LG	-
95	GR	-
96	W	-

97	G	-
98	O	-
99	L	-
100	Y	-

Connector No.	B244
Connector Name	LUGGAGE ROOM POWER SOCKET
Connector Type	P02FB-2



Terminal No.	Color of Wire	Signal Name [Specification]
1	V	-
2	B	-

Connector No.	E103
Connector Name	FUSE BLOCK (J/B)
Connector Type	NS16FW-CS



Terminal No.	Color of Wire	Signal Name [Specification]
1F	SB	-
2F	W	-
3F	Y	-
4F	G	-
6F	O	-
8F	L	-
9F	R	-
10F	L	-

JCMWA4947GB



POWER SOCKET

< DTC/CIRCUIT DIAGNOSIS >

POWER SOCKET

Connector No.	E106
Connector Name	WIRE TO WIRE
Connector Type	TH8DFW-CS16-TM4

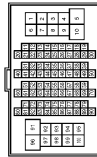

Terminal No.	Color of Wire	Signal Name [Specification]
1	G	-
2	O	-
3	SB	-
4	LG	-
5	Y	-
6	W	-
7	G	-
8	V	-
9	R	-
10	BR	-
11	B	-
12	G	-
13	R	-
14	W	-
15	SHIELD	-
16	SB	-
17	L	-
18	P	-
19	G	-
20	W	- [With ICC] - [Without ICC]
21	BR	- [With ICC] - [Without ICC]
22	R	- [With ICC] - [Without ICC]
23	G	- [With ICC] - [Without ICC]
24	L	- [With ICC] - [Without ICC]
25	Y	- [With ICC] - [Without ICC]
26	SHIELD	-
28	G	-
29	LG	-
30	O	-
31	BR	-
32	W	-
33	Y	-
34	O	-
35	SB	-

36	P	-
37	Y	-
38	GR	-
39	LG	-
41	LG	-
42	V	-
43	R	-
44	G	-
45	GR	-
46	W	-
47	L	-
48	P	-
49	SB	-
50	BR	-
51	B	-
52	Y	-
53	O	-
54	R	-
55	SB	-
56	P	-
59	P	-
60	SB	-
61	V	-
62	P	-
63	LG	-
64	L	-
65	O	-
66	L	-
68	L	-
70	SHIELD	-
71	G	-
72	G	-
73	R	-
74	BR	-
76	L	-
77	W	-
78	Y	-
80	SB	-
81	L	-
82	W	-
83	LG	-
84	GR	-
85	G	-
86	P	-
87	W	-
88	O	-
89	LG	-
90	BR	-
91	GR	-
92	BR	-
93	SB	-
94	W	-

95	Y	-
96	W	-
100	Y	-

Connector No.	M1
Connector Name	FLUSE BLOCK (J/B)
Connector Type	NS06FW-M2



Terminal No.	Color of Wire	Signal Name [Specification]
1A	O	-
2A	G	-
3A	L	-
4A	P	-
5A	V	-
6A	Y	-
7A	R	-
8A	L	-

Connector No.	M2
Connector Name	FLUSE BLOCK (J/B)
Connector Type	NS10FW-CS



Terminal No.	Color of Wire	Signal Name [Specification]
1B	LG	-
3B	P	-
4B	G	-
5B	O	-
6B	Y	-
7B	L	-
8B	R	-
9B	BR	-

JCMWA4948GB

POWER SOCKET

< DTC/CIRCUIT DIAGNOSIS >

A
B
C
D
E
F
G
H
I
J
K
L
N
O
P

94	L	-
95	G	-
96	W	-
100	Y	-

35	L	-
36	P	-
37	G	-
38	R	-
39	G	-
41	L	-
42	W	-
43	R	-
44	LG	-
45	GR	-
46	W	-
47	L	-
48	P	-
49	O	-
50	LG	-
51	SB	-
52	Y	-
53	O	-
54	BR	-
55	SB	-
56	P	-
59	SB	-
60	SB	-
61	V	-
62	P	-
63	R	-
64	L	-
65	O	-
66	L	-
69	V	-
70	SHIELD	-
71	O	-
72	GR	-
73	W	-
74	SB	-
76	V	-
77	V	-
78	Y	-
80	O	-
81	L	-
82	W	-
83	Y	-
84	L	-
85	P	-
86	BR	-
87	P	-
88	V	-
89	G	-
90	P	-
91	R	-
92	R	-
93	GR	-

POWER SOCKET

Connector No.	M6
Connector Name	WIRE TO WIRE
Connector Type	TH8DMW-CST16-TM4

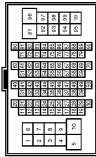

Terminal No.	Color of Wire	Signal Name [Specification]
1	G	-
2	O	-
3	SB	-
4	LG	-
5	GR	-
6	W	-
7	G	-
8	W	-
9	P	-
10	BR	-
11	B	-
12	G	-
13	R	-
14	W	-
15	SHIELD	-
16	BR	-
17	L	-
18	P	-
19	G	-
20	W	- [With ICC] - [Without ICC]
21	BR	- [With ICC] - [Without ICC]
22	R	- [With ICC] - [Without ICC]
23	G	- [With ICC] - [Without ICC]
24	P	- [With ICC] - [Without ICC]
25	Y	- [With ICC] - [Without ICC]
26	SHIELD	-
28	GR	-
29	V	-
30	O	-
31	BR	-
32	W	-
33	Y	-
34	L	-

PWO

JCMWA4949GB

POWER SOCKET

< DTC/CIRCUIT DIAGNOSIS >

POWER SOCKET

Connector No.	M7
Connector Name	WIRE TO WIRE
Connector Type	TH80MW-CS16-1M4

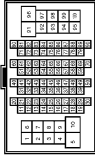

Terminal No.	Color of Wire	Signal Name [Specification]
1	G	-
2	B	-
3	W	-
5	G	-
6	P	-
7	V	-
8	O	-
9	W	-
10	W	-
11	O	-
12	B	-
13	G	-
14	R	-
15	W	-
16	SHIELD	-
17	L	-
18	P	-
19	G	-
20	R	-
21	LG	-
23	V	-
24	P	-
25	BR	-
26	GR	-
27	O	-
28	W	-
29	SHIELD	-
38	B	-
39	B	-
40	LG	-
41	G	-
42	Y	-
43	SB	-
44	W	-
45	B	-
50	B	-
51	V	-
52	LG	-

53	SHIELD	-
54	BR	-
55	Y	-
56	SHIELD	-
58	P	-
59	L	-
60	L	-
61	BR	-
62	R	-
63	Y	-
64	L	-
65	W	-
66	V	-
67	LG	-
68	Y	-
69	G	-
70	V	-
71	W	-
72	B	-
73	W	-
74	LG	-
75	P	-
76	LG	-
77	SB	-
78	GR	-
79	R	-
80	L	-
81	P	-
82	L	-
83	P	-
84	SB	-
85	W	-
86	Y	-
87	B	-
88	G	-
89	O	-
90	W	-
91	R	-
92	O	-
93	BR	-
94	V	-
95	Y	-
96	O	-
97	W	-
98	R	-
99	G	-
99	O	-

- [With VK engine]
- [With VG engine]

Connector No.	M79
Connector Name	ACCESSORY RELAY (2)
Connector Type	MS30FL-M2-LC



Terminal No.	Color of Wire	Signal Name [Specification]
1	G	-
2	B	-
3	LG	-
5	L	-

POWER SOCKET

< DTC/CIRCUIT DIAGNOSIS >

POWER SOCKET

Connector No.	M117
Connector Name	WIRE TO WIRE
Connector Type	TH8DMW-CS16-TM44

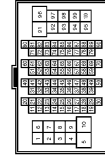

Terminal No.	Color of Wire	Signal Name [Specification]
1	GR	-
2	BR	-
3	V	-
4	SB	-
6	Y	-
7	B	-
8	W	-
10	W	-
11	BR	-
12	GR	-
13	SHIELD	-
14	B	-
15	P	-
16	SHIELD	-
17	Y	-
18	Y	-
19	LG	-
20	SB	-
21	LG	-
22	B	- [With entertainment system]
22	GR	- [Without entertainment system]
23	W	- [With entertainment system]
23	V	- [Without entertainment system]
24	R	- [With entertainment system]
24	W	- [Without entertainment system]
25	SHIELD	- [With entertainment system]
25	R	- [Without entertainment system]
26	SB	-
27	V	-
28	SHIELD	-
29	O	-
30	P	-
31	W	-
32	W	-
33	SB	-
34	Y	-
40	V	- [With ICC]
41	SB	- [Without ICC]
41	Y	-

42	V	- [With ICC]
42	W	- [Without ICC]
43	P	- [With ICC]
43	P	- [Without ICC]
44	R	- [With ICC]
44	R	- [Without ICC]
45	L	- [With ICC]
45	G	- [Without ICC]
46	O	- [With ICC]
46	SHIELD	- [Without ICC]
47	L	- [With ICC]
47	B	- [Without ICC]
48	P	- [With ICC]
48	R	- [Without ICC]
49	G	- [With ICC]
49	G	- [Without ICC]
50	SHIELD	-
51	O	-
52	GR	-
53	G	-
54	L	-
55	P	-
60	LG	-
61	R	-
62	SB	-
63	V	-
64	Y	-
65	BR	-
66	BR	-
67	W	-
68	SHIELD	-
69	G	-
71	SB	-
72	V	-
73	V	-
74	LG	-
75	R	- [With VK engine]
75	BR	- [With VQ engine]
76	V	-
77	LG	-
80	R	-
81	L	-
82	Y	-
83	O	-
84	W	-
85	SB	-
86	B	-
87	P	-
91	L	-
92	L	-
93	G	-
94	W	- [With VK engine]
94	W	- [With VQ engine]
94	O	-

95	V	-
96	G	-
97	G	-
98	L	-
99	LG	-
100	Y	-

Connector No.	M118
Connector Name	BCM (BODY CONTROL MODULE)
Connector Type	M03FB-LC



Terminal No.	Color of Wire	Signal Name [Specification]
1	W	BAT (F/L)
2	Y	POWER WINDOW POWER SUPPLY (BAT)
3	O	POWER WINDOW POWER SUPPLY (RAP)

Connector No.	M119
Connector Name	BCM (BODY CONTROL MODULE)
Connector Type	NS16FW-CS

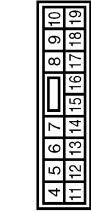

Terminal No.	Color of Wire	Signal Name [Specification]
4	P	INT ROOM LAMP PWR SUPPLY (BAT SAVE)
5	V	PASSENGER DOOR UNLOCK OUTPUT
7	Y	STEP LAMP OUTPUT
8	V	ALL DOOR FUEL LID LOCK OUTPUT
9	G	DRIVER DOOR FUEL LID LOCK OUTPUT
10	BR	REAR DOOR UNLOCK OUTPUT
11	R	BAT (ELUSE)
13	B	GND
15	Y	ASC IND
17	W	TURN SIGNAL RR (FRONT)
18	O	TURN SIGNAL LH (FRONT)

19	SB	ROOM LAMP TIMER
----	----	-----------------

Connector No.	M122
Connector Name	BCM (BODY CONTROL MODULE)
Connector Type	TH4GFB-NH

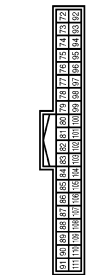

Terminal No.	Color of Wire	Signal Name [Specification]
72	R	ROOM ANT2-
73	G	ROOM ANT2+
74	SB	PASSENGER DOOR ANT-
75	BR	PASSENGER DOOR ANT+
76	V	DRIVER DOOR ANT-
77	LG	DRIVER DOOR ANT+
78	Y	ROOM ANT1-
79	BR	ROOM ANT1+
80	GR	NATS ANT AMP
81	W	NATS ANT AMP
82	P	IGN RELAY (F/B) CONT
83	GR	KEYLESS ENTRY RECEIVER SIGNAL
87	BR	COMBI SW INPUT 5
88	V	COMBI SW INPUT 3
89	SB	PUSH SW
90	P	CAN-L
91	L	CAN-H
92	LG	KEY SLOT ILL
93	V	ON IND
95	O	ACC RELAY CONT
96	GR	A/T SHIFT SELECTOR POWER SUPPLY
97	L	S/L CONDITION 1
98	P	S/L CONDITION 2
99	R	SHIFT P
100	G	PASSENGER DOOR REQUEST SW
101	SB	DRIVER DOOR REQUEST SW
102	O	BLOWER FAN MOTOR RELAY CONT
103	BR	KEYLESS ENTRY RECEIVER POWER SUPPLY
106	W	S/L LIMIT POWER SUPPLY
107	LG	COMBI SW INPUT 1
108	R	COMBI SW INPUT 4
109	V	COMBI SW INPUT 2
110	G	HAZARD SW
111	GR	S/L UNIT COMM

A B C D E F G H I J K L N O P

PWO

POWER SOCKET

< DTC/CIRCUIT DIAGNOSIS >

2	B	-
---	---	---

POWER SOCKET

Connector No.	M132
Connector Name	FRONT POWER SOCKET
Connector Type	HS08PW-GS



Terminal No.	Color of Wire	Signal Name [Specification]
1	B	-
2	R	-
3	L	-

POWER SOCKET

Connector No.	M142
Connector Name	CONSOLE POWER SOCKET
Connector Type	P02FEB-Z



Terminal No.	Color of Wire	Signal Name [Specification]
1	Y	-
2	B	-

POWER SOCKET

Connector No.	M143
Connector Name	REAR POWER SOCKET
Connector Type	P02FEB-Z



Terminal No.	Color of Wire	Signal Name [Specification]
1	O	-

TYPE B

JCMWA4952GB

POWER SOCKET

< DTC/CIRCUIT DIAGNOSIS >

TYPE B : Wiring Diagram - POWER SOCKET -

INFOID:000000007071251

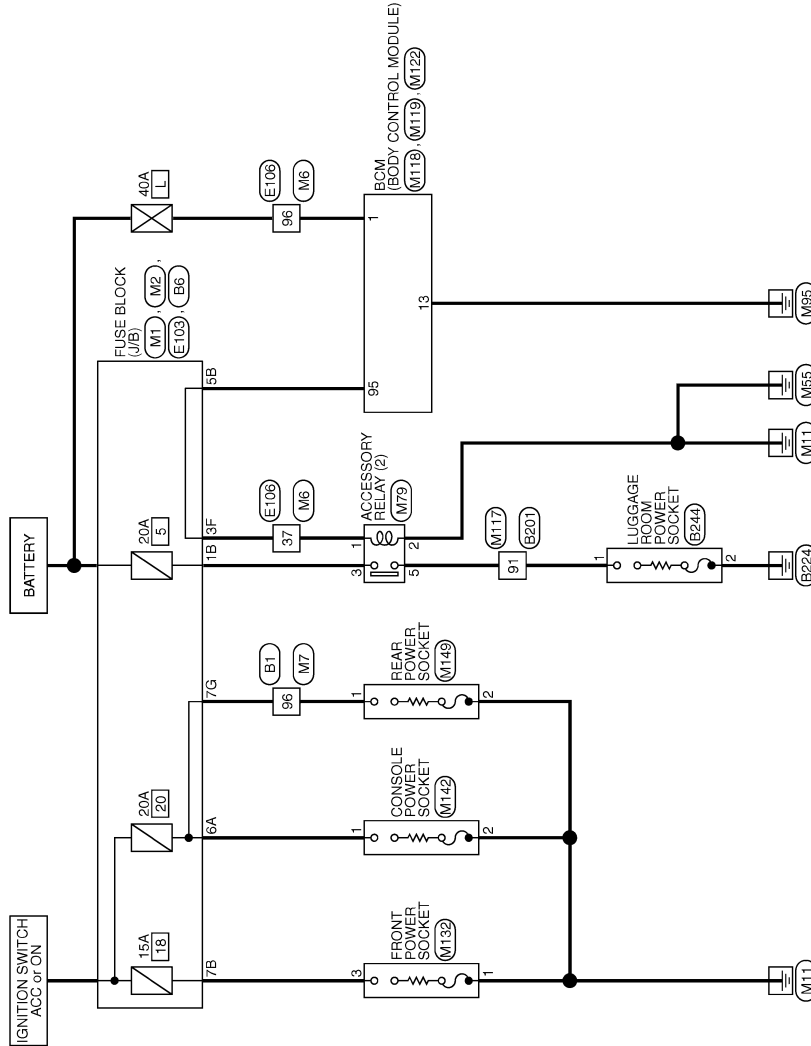

POWER SOCKET

A
B
C
D
E
F
G
H
I
J
K
L

PWO

N
O
P

2010/10/27

JCMWA7013GB

POWER SOCKET

< DTC/CIRCUIT DIAGNOSIS >

POWER SOCKET

Connector No.	B1
Connector Name	WIRE TO WIRE
Connector Type	THB07V-CS16-TM4



Terminal No.	Color of Wire	Signal Name [Specification]
1	G	-
2	L	-
3	W	-
5	G	-
6	G	-
7	P	-
8	EG	-
9	W	-
10	SB	-
11	SB	-
12	B	-
13	G	-
14	R	-
15	W	-
16	SHIELD	-
17	L	-
18	P	-
19	G	-
20	Y	-
21	W	-
23	V	-
24	P	-
25	ER	-
26	GR	-
27	EG	-
28	W	-
38	B	-
39	B	-
40	LG	-
41	G	-
42	GR	-
43	SB	-
44	V	-
45	GR	-
50	B	-
51	V	-
52	SB	-
53	SHIELD	-

54	BR	-
55	Y	-
56	SHIELD	-
57	P	-
58	-	-
59	SHIELD	-
60	L	-
61	P	-
62	GR	-
63	G	-
64	EG	-
65	W	-
66	V	-
67	LG	-
68	Y	-
69	G	-
70	GR	-
71	G	-
72	B	-
73	W	-
74	V	-
75	EG	-
76	LG	-
77	L	-
78	GR	-
79	W	-
80	L	-
81	P	-
82	L	-
83	P	-
84	SB	-
85	R	-
86	Y	-
87	B	-
88	G	-
89	BR	-
91	R	-
92	EG	-
93	ER	-
94	V	-
95	Y	-
96	EG	-
97	W	-
98	GR	-
99	W	-

Connector No.	B6
Connector Name	FUSE BLOCK (J/B)
Connector Type	NS1ZFBR-CS



Terminal No.	Color of Wire	Signal Name [Specification]
4G	R	-
5G	LG	-
7G	BG	-
10G	W	-
11G	W	-
12G	GR	-

JCMWA7014GB

POWER SOCKET

< DTC/CIRCUIT DIAGNOSIS >

A
B
C
D
E
F
G
H
I
J
K
L
N
O
P

POWER SOCKET

Connector No.	B201
Connector Name	WIRE TO WIRE
Connector Type	TH80FW-CS16-TM4

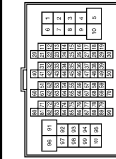

Terminal No.	Color of Wire	Signal Name [Specification]
1	G	-
2	R	-
3	BR	-
4	SB	-
6	BG	-
7	GR	-
8	W	-
10	G	-
11	BR	-
12	Y	-
13	SHIELD	-
14	G	-
15	R	-
16	SHIELD	-
17	LG	-
18	GR	-
19	V	-
22	B	- [With entertainment system]
22	GR	- [Without entertainment system]
23	W	- [With entertainment system]
23	LG	- [Without entertainment system]
24	R	- [With entertainment system]
24	W	- [Without entertainment system]
25	SHIELD	- [With entertainment system]
25	V	- [Without entertainment system]
26	SB	-
27	V	-
28	SHIELD	-
29	BG	-
30	P	-
31	W	-
32	GR	-
33	SB	-
36	L	-
37	P	-
38	L	-
38	P	-
40	LG	- [With ICC]

40	V	- [Without ICC]
41	SB	- [With ICC]
41	Y	- [Without ICC]
42	Y	- [With ICC]
42	W	- [Without ICC]
43	BR	- [With ICC]
43	B	- [Without ICC]
44	R	-
45	G	-
46	BG	- [With ICC]
46	SHIELD	- [Without ICC]
47	L	- [With ICC]
47	B	- [Without ICC]
48	P	- [With ICC]
48	R	- [Without ICC]
49	G	- [With ICC]
49	W	- [Without ICC]
50	SHIELD	-
51	W	-
52	R	-
53	G	-
54	L	-
55	SB	-
60	GR	-
61	LG	-
62	SB	-
63	P	-
64	BR	-
65	BG	-
66	Y	-
67	W	-
69	G	-
71	SB	-
72	V	-
73	LG	-
74	W	-
75	BR	-
76	V	-
77	LG	-
80	BG	-
81	G	-
82	P	-
83	Y	-
84	R	-
85	SB	-
86	GR	-
87	L	-
91	V	-
92	W	-
93	R	-
94	LG	-
95	GR	-

96	W	-
97	G	-
98	BG	-
99	L	-
100	Y	-

Connector No.	B244
Connector Name	LUGGAGE ROOM POWER SOCKET
Connector Type	P02FB-Z



Terminal No.	Color of Wire	Signal Name [Specification]
1	V	-
2	B	-

Connector No.	E103
Connector Name	FUSE BLOCK (J/B)
Connector Type	NS18FW-CS



Terminal No.	Color of Wire	Signal Name [Specification]
1F	SB	-
2F	W	-
3F	Y	-
4F	G	-
6F	BG	-
8F	L	-
9F	R	-
10F	L	-

JCMWA7015GB

PWO

POWER SOCKET

< DTC/CIRCUIT DIAGNOSIS >

POWER SOCKET

Connector No.	E106
Connector Name	WIRE TO WIRE
Connector Type	THBDFW-CS16-TM4

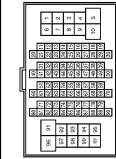

Terminal No.	Color of Wire	Signal Name [Specification]
1	G	-
2	BG	-
3	SB	-
4	LG	-
5	Y	-
6	W	-
7	G	-
8	V	-
9	R	-
10	BR	-
11	B	-
12	G	-
13	R	-
14	W	-
15	SHIELD	-
16	SB	-
17	L	-
18	P	-
19	G	-
20	W	- [With ICC]
21	Y	- [Without ICC]
22	R	- [With ICC]
23	V	- [Without ICC]
24	L	- [With ICC]
25	Y	- [Without ICC]
26	SHIELD	-
28	G	-
29	LG	-
30	BG	-
31	BR	-
32	W	-
33	Y	-
34	BG	-
35	SB	-

36	P	-
37	Y	-
38	GR	-
39	LG	-
41	LG	-
42	V	-
43	R	-
44	G	-
45	GR	-
46	W	-
47	L	-
48	P	-
49	SB	-
50	BR	-
51	B	-
52	Y	-
53	BG	-
54	R	-
55	SB	-
56	P	-
60	SB	-
61	V	-
62	P	-
63	LG	-
64	L	-
65	BG	-
69	L	-
70	SHIELD	-
71	G	-
72	G	-
73	R	-
74	BR	-
76	L	-
77	W	-
78	Y	-
80	SB	-
81	L	-
82	W	-
83	LG	-
84	GR	-
85	G	-
86	P	-
87	W	-
88	BG	-
89	LG	-
90	BR	-
91	GR	-
92	BR	-
93	SB	-
94	W	-
95	Y	-
96	W	-

97	W	-
98	SHIELD	-
100	Y	-

Connector No.	M1
Connector Name	FUSE BLOCK (J/B)
Connector Type	NS10FW-M2



Terminal No.	Color of Wire	Signal Name [Specification]
1A	BG	-
2A	G	-
3A	L	-
4A	P	-
5A	V	-
6A	Y	-
7A	R	-
8A	L	-

Connector No.	M2
Connector Name	FUSE BLOCK (J/B)
Connector Type	NS10FW-CS



Terminal No.	Color of Wire	Signal Name [Specification]
1B	LG	-
3B	P	-
4B	G	-
5B	BG	-
8B	Y	-
7B	L	-
9B	R	-
9B	BR	-

JCMWA7016GB

POWER SOCKET

< DTC/CIRCUIT DIAGNOSIS >

POWER SOCKET

Connector No.	M6
Connector Name	WIRE TO WIRE
Connector Type	TH80MW-CS16-TM4



Terminal No.	Color of Wire	Signal Name [Specification]
1	G	
2	EG	
3	SB	
4	LG	
5	GR	
6	W	
7	G	
8	W	
9	P	
10	BR	
11	B	
12	G	
13	R	
14	W	
15	SHIELD	
16	BR	
17	L	
18	P	
19	G	
20	W	
20	GR	- [With ICC] - [Without ICC]
21	BR	- [With ICC] - [Without ICC]
21	R	- [Without ICC]
22	L	- [With ICC] - [Without ICC]
23	G	
24	L	- [With ICC] - [Without ICC]
24	P	- [With ICC] - [Without ICC]
25	Y	- [With ICC] - [Without ICC]
25	W	- [Without ICC]
26	SHIELD	
28	GR	
29	V	
30	EG	
31	BR	
32	W	
33	Y	
34	L	

35	L	
36	P	
37	C	
38	R	
39	G	
41	L	
42	W	
43	R	
44	LG	
45	GR	
46	W	
47	L	
48	P	
49	BG	
50	LG	
51	SB	
52	Y	
53	BG	
54	BR	
55	SB	
59	SB	
60	SB	
61	V	
62	P	
63	R	
64	L	
65	BG	
69	V	
70	SHIELD	
71	BG	
72	GR	
73	W	
74	SB	
76	V	
77	Y	
78	Y	
80	BG	
81	L	
82	W	
83	Y	
84	L	
85	P	
86	BR	
87	P	
88	V	
89	G	
90	P	
91	R	
92	R	
93	GR	
94	L	
95	G	

96	W	
97	W	
98	SHIELD	
100	Y	

Connector No.	M7
Connector Name	WIRE TO WIRE
Connector Type	TH80MW-CS16-TM4

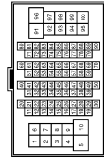

Terminal No.	Color of Wire	Signal Name [Specification]
1	G	
2	B	
3	W	
5	G	
6	P	
7	V	
8	BG	
9	W	
10	W	
11	BG	
12	B	
13	G	
14	R	
15	W	
16	SHIELD	
17	L	
18	P	
19	G	
20	R	
21	LG	
23	V	
24	P	
25	BR	
26	GR	
27	BG	
28	W	
38	B	
39	B	
40	LG	
41	G	
42	Y	
43	SB	

44	W	
45	B	
50	B	
51	V	
52	LG	
53	SHIELD	
54	BR	
55	Y	
56	SHIELD	
57	P	
58	L	
59	SHIELD	
60	L	
61	BR	
62	R	
63	Y	
64	L	
65	W	
66	W	
67	LG	
68	Y	
69	G	
70	V	
71	W	
72	B	
73	W	
74	LG	
75	P	
76	LG	
77	SB	
78	GR	
79	R	
80	L	
81	P	
82	L	
83	P	
84	SB	
85	W	
86	Y	
87	B	
88	G	
89	BG	
91	R	
92	BG	
93	BR	
94	V	
96	BG	
97	W	
98	R	
99	BG	

JCMWA7017GB

A
B
C
D
E
F
G
H
I
J
K
L
N
O
P

PWO

POWER SOCKET

< DTC/CIRCUIT DIAGNOSIS >

POWER SOCKET

Connector No.	M79
Connector Name	ACCESSORY RELAY (2)
Connector Type	MS02FL-MZ-LC



Terminal No.	Color of Wire	Signal Name [Specification]
1	G	-
2	B	-
3	LG	-
5	L	-

Connector No.	M117
Connector Name	WIRE TO WIRE
Connector Type	TH80MW-CS1F-TM4

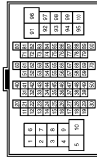

Terminal No.	Color of Wire	Signal Name [Specification]
1	GR	-
2	BR	-
3	V	-
4	SB	-
6	Y	-
7	B	-
8	W	-
10	W	-
11	BR	-
12	GR	-
13	SHIELD	-
14	L	-
15	P	-
16	SHIELD	-
17	Y	-
18	Y	-
19	LG	-
22	B	- [With entertainment system]

22	GR	- [Without entertainment system]
23	W	- [With entertainment system]
23	V	- [Without entertainment system]
24	R	- [With entertainment system]
24	W	- [Without entertainment system]
25	SHIELD	- [With entertainment system]
25	R	- [Without entertainment system]
26	SB	-
27	V	-
28	SHIELD	-
29	BG	-
30	P	-
31	W	-
32	W	-
33	SB	-
36	L	-
37	P	-
38	L	-
39	P	-
40	V	-
41	SB	- [With ICC]
41	Y	- [Without ICC]
42	V	- [With ICC]
42	W	- [Without ICC]
43	P	- [With ICC]
43	B	- [Without ICC]
44	R	-
45	L	- [With ICC]
45	G	- [Without ICC]
46	BG	- [With ICC]
46	SHIELD	- [Without ICC]
47	L	- [With ICC]
47	B	- [Without ICC]
48	P	- [With ICC]
48	R	- [Without ICC]
49	G	- [With ICC]
49	W	- [Without ICC]
50	SHIELD	-
51	BG	-
52	GR	-
53	G	-
54	L	-
55	P	-
60	LG	-
61	R	-
62	SB	-
63	V	-
64	Y	-
65	BR	-
66	BG	-
67	W	-
69	G	-

71	SB	-
72	V	-
73	V	-
74	LG	-
75	R	- [With V6 engine]
75	BR	- [With V6 engine]
76	V	-
77	LG	-
80	R	-
81	L	-
82	Y	-
83	BG	-
84	W	-
85	SB	-
86	B	-
87	P	-
91	L	-
92	L	-
93	G	-
94	BG	- [With V6 engine]
95	V	-
96	G	-
97	G	-
98	L	-
99	LG	-

Connector No.	M118
Connector Name	BCM (BODY CONTROL MODULE)
Connector Type	MD3PEF-LC



Terminal No.	Color of Wire	Signal Name [Specification]
1	W	BAT (F/L)
2	Y	POWER WINDOW POWER SUPPLY (BAT)
3	BG	POWER WINDOW POWER SUPPLY (RAP)

Connector No.	M119
Connector Name	BCM (BODY CONTROL MODULE)
Connector Type	NS16FW-CS



Terminal No.	Color of Wire	Signal Name [Specification]
4	P	INT ROOM LAMP PWR SUPPLY (BAT SAVE)
5	V	PASSENGER DOOR UNLOCK OUTPUT
7	Y	STEP LAMP OUTPUT
8	V	ALL DOOR FUEL LID LOCK OUTPUT
9	G	DRIVER DOOR FUEL LID LOCK OUTPUT
10	BR	REAR DOOR UNLOCK OUTPUT
11	R	BAT (FUSE)
13	B	GND
15	Y	ACC IND
17	W	TURN SIGNAL RH (FRONT)
18	BG	TURN SIGNAL LH (FRONT)
19	SB	ROOM LAMP TIMER

POWER SOCKET

< DTC/CIRCUIT DIAGNOSIS >

A
B
C
D
E
F
G
H
I
J
K
L
N
O
P

2	B	-
---	---	---

Connector No.	M132
Connector Name	FRONT POWER SOCKET
Connector Type	NS3CF1F-CS



Terminal No.	Color of Wire	Signal Name [Specification]
1	B	-
2	R	-
3	L	-

Connector No.	M142
Connector Name	CONSOLE POWER SOCKET
Connector Type	P02FB-Z



Terminal No.	Color of Wire	Signal Name [Specification]
1	Y	-
2	B	-

Connector No.	M149
Connector Name	REAR POWER SOCKET
Connector Type	P02FB-Z



Terminal No.	Color of Wire	Signal Name [Specification]
1	BG	-

POWER SOCKET

Connector No.	M122
Connector Name	BCM (BODY CONTROL MODULE)
Connector Type	TH4CFB-NH



Terminal No.	Color of Wire	Signal Name [Specification]
72	R	ROOM ANT2-
73	G	ROOM ANT2+
74	SB	PASSENGER DOOR ANT-
75	BR	PASSENGER DOOR ANT+
76	V	DRIVER DOOR ANT-
77	LG	DRIVER DOOR ANT+
78	Y	ROOM ANTI-
79	BR	ROOM ANTI+
80	GR	NATS ANT AMP
81	W	NATS ANT AMP
82	P	IGN RELAY (F/B) COINT
83	GR	KEYLESS ENTRY RECEIVER SIGNAL
87	BR	COMBI SW INPUT 5
88	V	COMBI SW INPUT 3
89	SB	PUSH SW
90	P	CAN-L
91	L	CAN-H
92	LG	KEY SLOT ILL
93	V	ON IND
95	BG	ACC RELAY COINT
96	GR	A/T SHIFT SELECTOR POWER SUPPLY
97	L	S/L CONDITION 1
98	P	S/L CONDITION 2
99	R	SHIFT P
100	G	PASSENGER DOOR REQUEST SW
101	SB	DRIVER DOOR REQUEST SW
102	BG	BLOWER FAN MOTOR RELAY COINT
103	BR	KEYLESS ENTRY RECEIVER POWER SUPPLY
106	W	S/L UNIT POWER SUPPLY
107	LG	COMBI SW INPUT 1
108	R	COMBI SW INPUT 4
109	Y	COMBI SW INPUT 2
110	G	HAZARD SW
111	GR	S/L UNIT COMM

JCMWA7019GB

PWO

PRECAUTIONS

< PRECAUTION >

PRECAUTION

PRECAUTIONS

Precaution for Supplemental Restraint System (SRS) "AIR BAG" and "SEAT BELT PRE-TENSIONER"

INFOID:000000006567931

The Supplemental Restraint System such as "AIR BAG" and "SEAT BELT PRE-TENSIONER", used along with a front seat belt, helps to reduce the risk or severity of injury to the driver and front passenger for certain types of collision. This system includes seat belt switch inputs and dual stage front air bag modules. The SRS system uses the seat belt switches to determine the front air bag deployment, and may only deploy one front air bag, depending on the severity of a collision and whether the front occupants are belted or unbelted. Information necessary to service the system safely is included in the "SRS AIR BAG" and "SEAT BELT" of this Service Manual.

WARNING:

Always observe the following items for preventing accidental activation.

- To avoid rendering the SRS inoperative, which could increase the risk of personal injury or death in the event of a collision that would result in air bag inflation, all maintenance must be performed by an authorized NISSAN/INFINITI dealer.
- Improper maintenance, including incorrect removal and installation of the SRS, can lead to personal injury caused by unintentional activation of the system. For removal of Spiral Cable and Air Bag Module, see "SRS AIR BAG".
- Never use electrical test equipment on any circuit related to the SRS unless instructed to in this Service Manual. SRS wiring harnesses can be identified by yellow and/or orange harnesses or harness connectors.

PRECAUTIONS WHEN USING POWER TOOLS (AIR OR ELECTRIC) AND HAMMERS

WARNING:

Always observe the following items for preventing accidental activation.

- When working near the Air Bag Diagnosis Sensor Unit or other Air Bag System sensors with the ignition ON or engine running, never use air or electric power tools or strike near the sensor(s) with a hammer. Heavy vibration could activate the sensor(s) and deploy the air bag(s), possibly causing serious injury.
- When using air or electric power tools or hammers, always switch the ignition OFF, disconnect the battery, and wait at least 3 minutes before performing any service.

POWER SOCKET

< REMOVAL AND INSTALLATION >

REMOVAL AND INSTALLATION

POWER SOCKET

FRONT POWER SOCKET

FRONT POWER SOCKET : Exploded View

INFOID:000000006567932

- 1 : Inner socket
- 2 : Ring

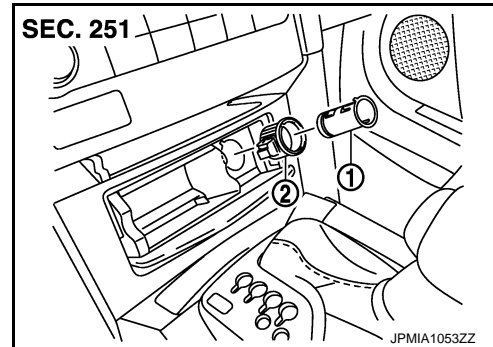

FRONT POWER SOCKET : Removal and Installation

INFOID:000000006567933

REMOVAL

1. Remove console pocket assembly. Refer to [IP-23. "Exploded View"](#).
2. Disconnect power socket connector (A) from reverse side inner socket (1).

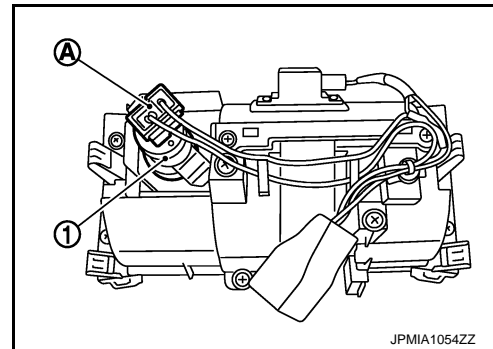

3. Pull out inner socket (1) by pushing the ring pawl (B) from the inner socket hole (square) (C).

A : Cut out

4. Remove ring (2) from console pocket assembly while pressing pawls.

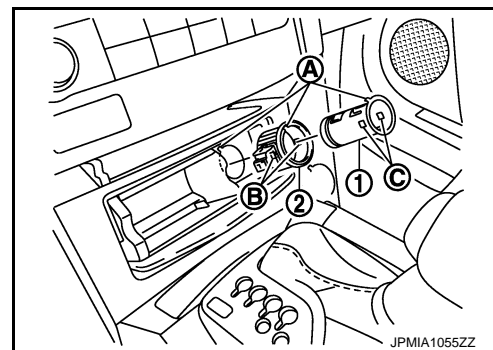

INSTALLATION

Install in the reverse order of removal.

NOTE:

Align the cut outs of inner socket, ring, and console pocket assembly.

CONSOLE POWER SOCKET

A
B
C
D
E
F
G
H
I
J
K
L
PWO
N
O
P

POWER SOCKET

< REMOVAL AND INSTALLATION >

CONSOLE POWER SOCKET : Exploded View

INFOID:000000006567934

- 1 : Inner socket
- 2 : Ring

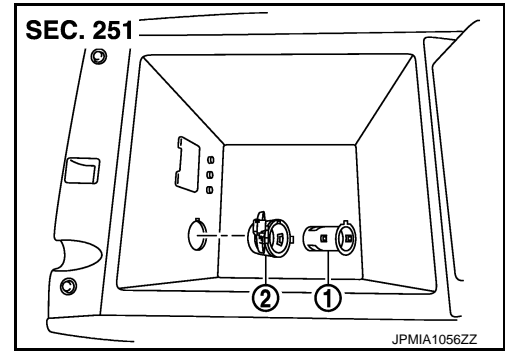

CONSOLE POWER SOCKET : Removal and Installation

INFOID:000000006567935

REMOVAL

1. Remove center console assembly. Refer to [IP-23, "Exploded View"](#).
2. Disconnect power socket connector (A).

B : Cut out

3. Pull out inner socket (1) by pushing the ring pawl (C) from the inner socket hole (square) (D).
4. Remove ring (2) from console box assembly while pressing pawls.

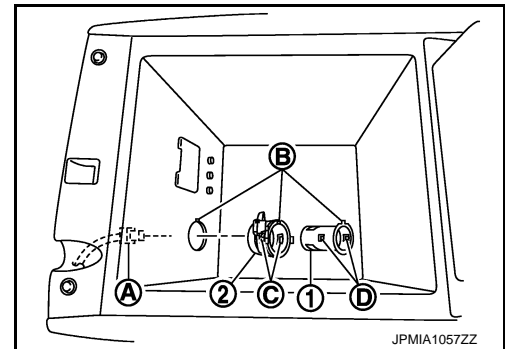

INSTALLATION

Install in the reverse order of removal.

NOTE:

Align the cut outs of inner socket, ring, and console box assembly.

REAR POWER SOCKET

REAR POWER SOCKET : Exploded View

INFOID:000000006567936

- 1 : Inner socket
- 2 : Ring

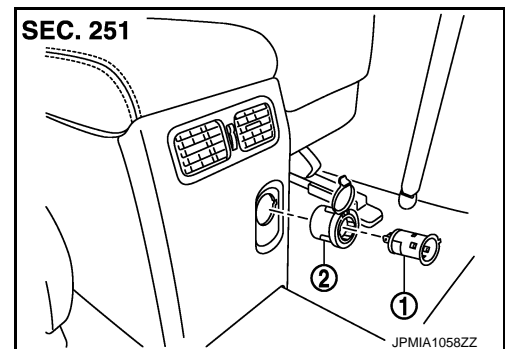

REAR POWER SOCKET : Removal and Installation

INFOID:000000006567937

REMOVAL

1. Remove console rear finisher. Refer to [IP-23, "Exploded View"](#).

POWER SOCKET

< REMOVAL AND INSTALLATION >

2. Disconnect power socket connector (A).

B : Cut out

3. Pull out inner socket (1) by pushing the ring pawl (C) from the inner socket hole (square) (D).
4. Remove ring (2) from console rear finisher while pressing pawls.

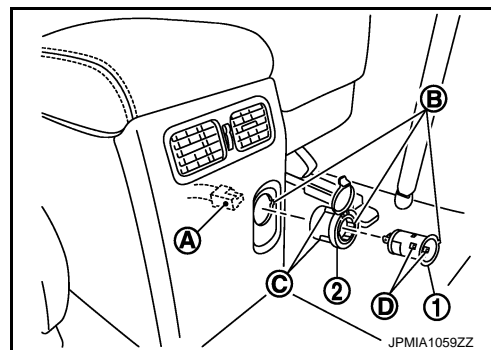

INSTALLATION

Install in the reverse order of removal.

NOTE:

Align the cut outs of inner socket, ring, and console rear finisher.

LUGGAGE ROOM POWER SOCKET

LUGGAGE ROOM POWER SOCKET : Exploded View

INFOID:0000000006567938

- 1 : Inner socket
- 2 : Ring
- 3 : Retainer

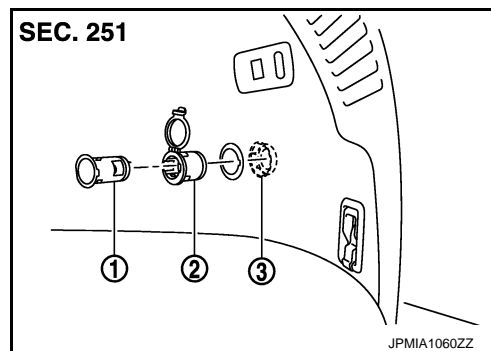

LUGGAGE ROOM POWER SOCKET : Removal and Installation

INFOID:0000000006567939

REMOVAL

1. Remove clips on the back of the luggage side finisher lower (RH) to obtain space for work. Refer to [INT-30. "Exploded View"](#).
2. Disconnect power socket connector (A).

B : Cut out

3. Remove retainer (1) and remove power socket assembly.
4. Pull out inner socket (2) by pushing the ring pawl (C) from the inner socket hole (square) (D).
5. Remove ring (3) from luggage side finisher lower (RH) while pressing pawls.

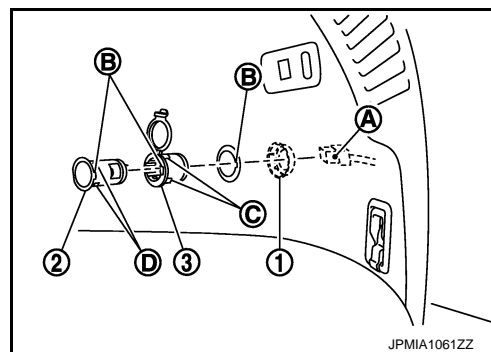

INSTALLATION

Install in the reverse order of removal.

NOTE:

Align the cut outs of inner socket, ring, and luggage side finisher lower (RH).