

SECTION BF

CONTENTS

BODY END	2	Exterior — TRUCK	12
Rear End — TRUCK	2	High Mount Stop Lamp	12
Back Door Window Opener — WAGON	3	SEAT	13
Wiring Diagram	3	Heated Seat	13
DOOR	4	Wiring Diagram	13
Power Door Lock — TRUCK	4	WINDSHIELD AND WINDOWS	14
Wiring Diagram	4	Back Window — TRUCK	14
Power Door Lock — WAGON	6	MIRROR	15
Wiring Diagram	6	Door Mirror/Wiring Diagram	15
Electrical Components Inspection	8	Truck Model	15
Door lock actuator	8	Wagon Model	16
Power Window	10	Rearview Mirror	17
Wiring Diagram	10	Removal	17
INTERIOR AND EXTERIOR	12	Installation	17

When you read wiring diagrams:

- Read G1 section, "HOW TO READ WIRING DIAGRAMS".
- See EL section, "POWER SUPPLY ROUTING" for power distribution circuit.

★ For seat belt, refer to MA section.

G1
MA
EM
LC
EF &
EC
FE
GL
MT
AT
TF
PD
FA
RA
BR
ST
BF
HA
EL
IDX

BODY END

Rear End — TRUCK

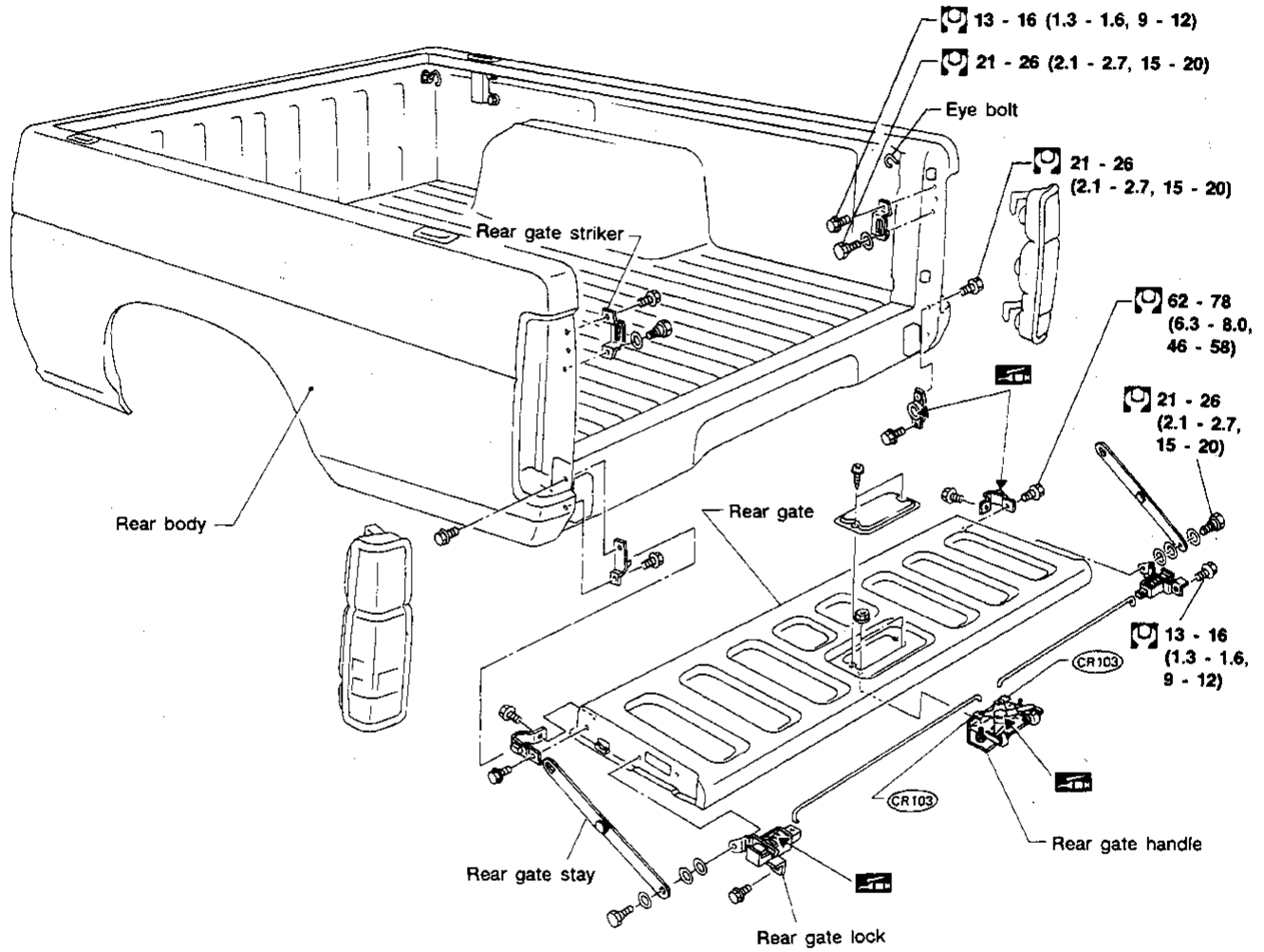

: N·m (kg-m, ft-lb)
 : Grease-up points

ABF296

Back Door Window Opener — WAGON

WIRING DIAGRAM

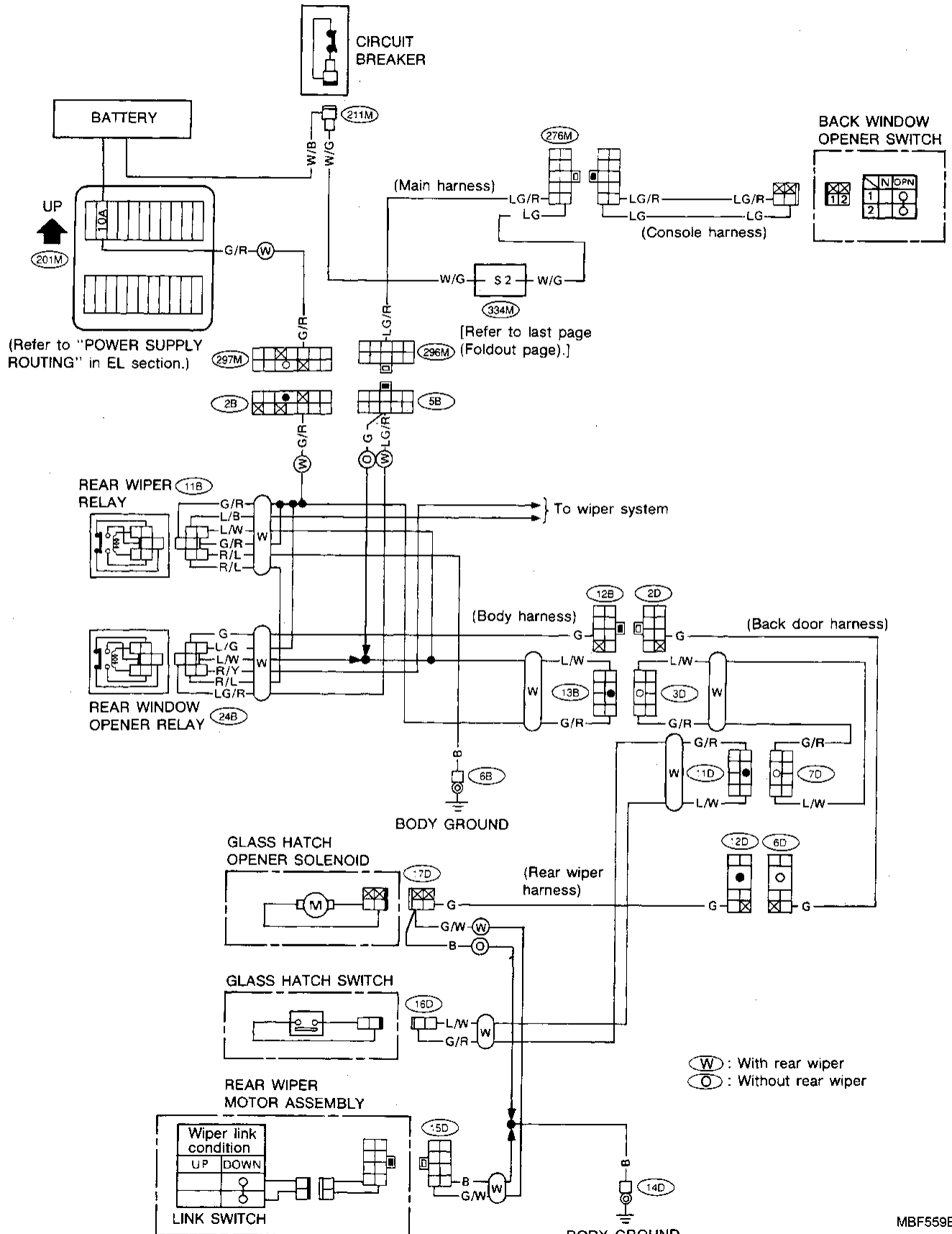

GI
MA
EM
LC
EF & EC
FE
CL
MT
AT
TF
PD
FA
RA
BR
ST
BF
HA
EL
IOX

DOOR

Power Door Lock — TRUCK

- When Lock-Unlock (Unlock-Lock) is repeated more than two or three times rapidly using the door lock-&-unlock switch connected to driver side door lock knob, the door may either be locked or unlocked by itself, or the actuator may not be activated. This depends on the Lock-Unlock operation period and other conditions.
Avoid this type of operation as a system malfunction may occur.

WIRING DIAGRAM

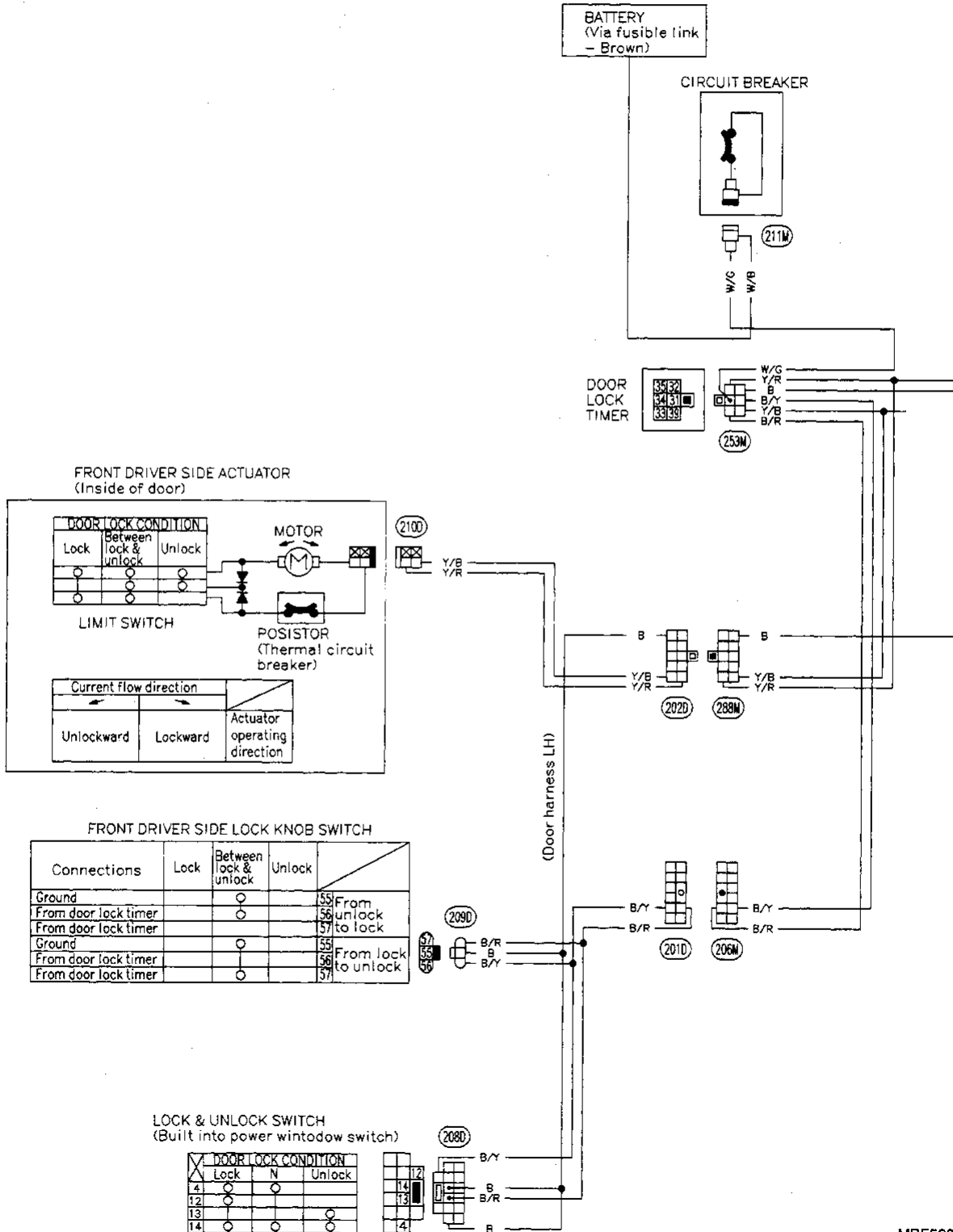

MBF560B1

DOOR

Power Door Lock — TRUCK (Cont'd)

GI
 MA
 EM
 LC
 EF &
 EC
 FE
 CL
 MT
 AT
 TF
 PD
 FA
 RA
 BR
 ST
BF
 HA
 EL
 IDX

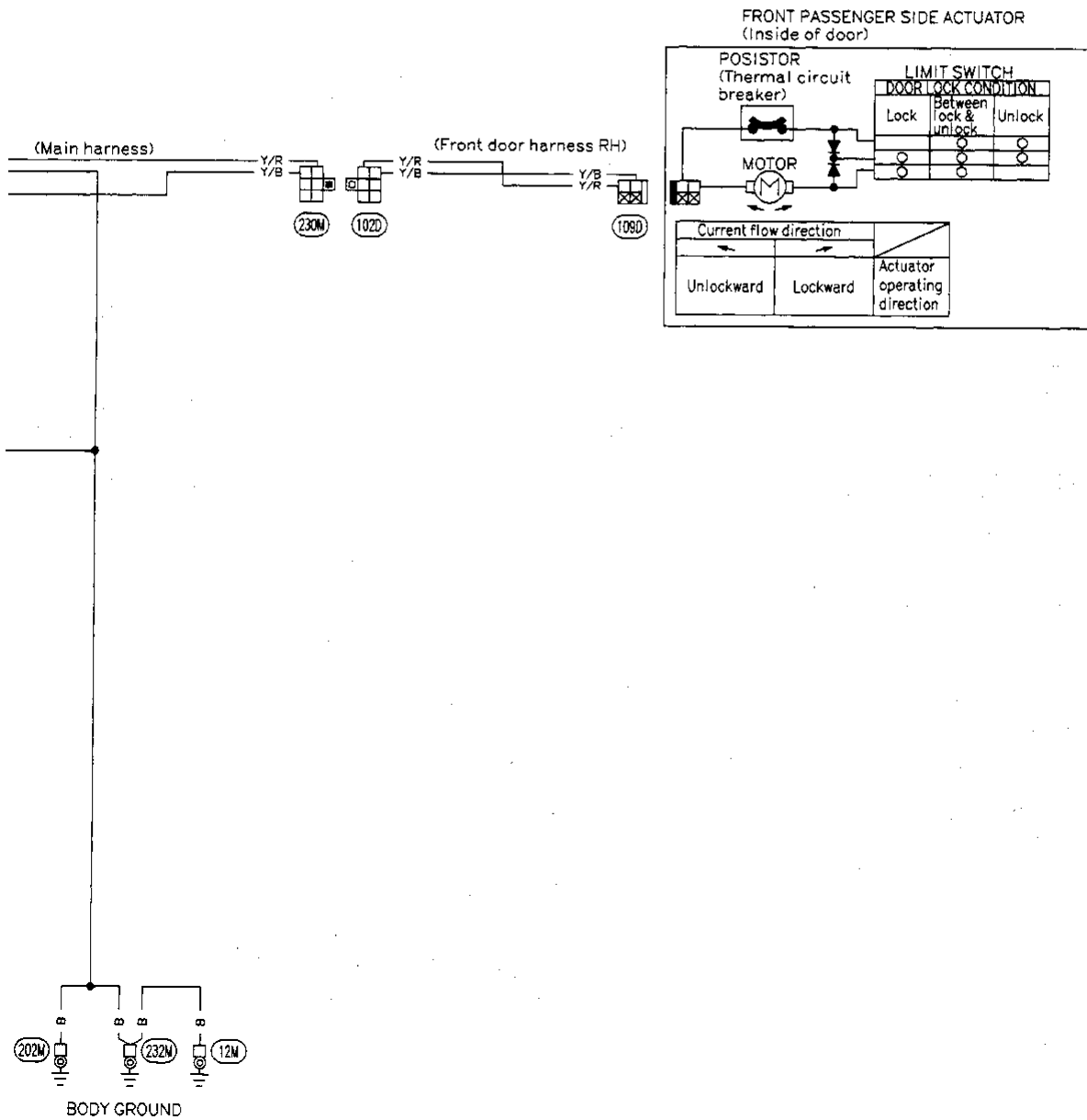

DOOR

Power Door Lock — WAGON

WIRING DIAGRAM

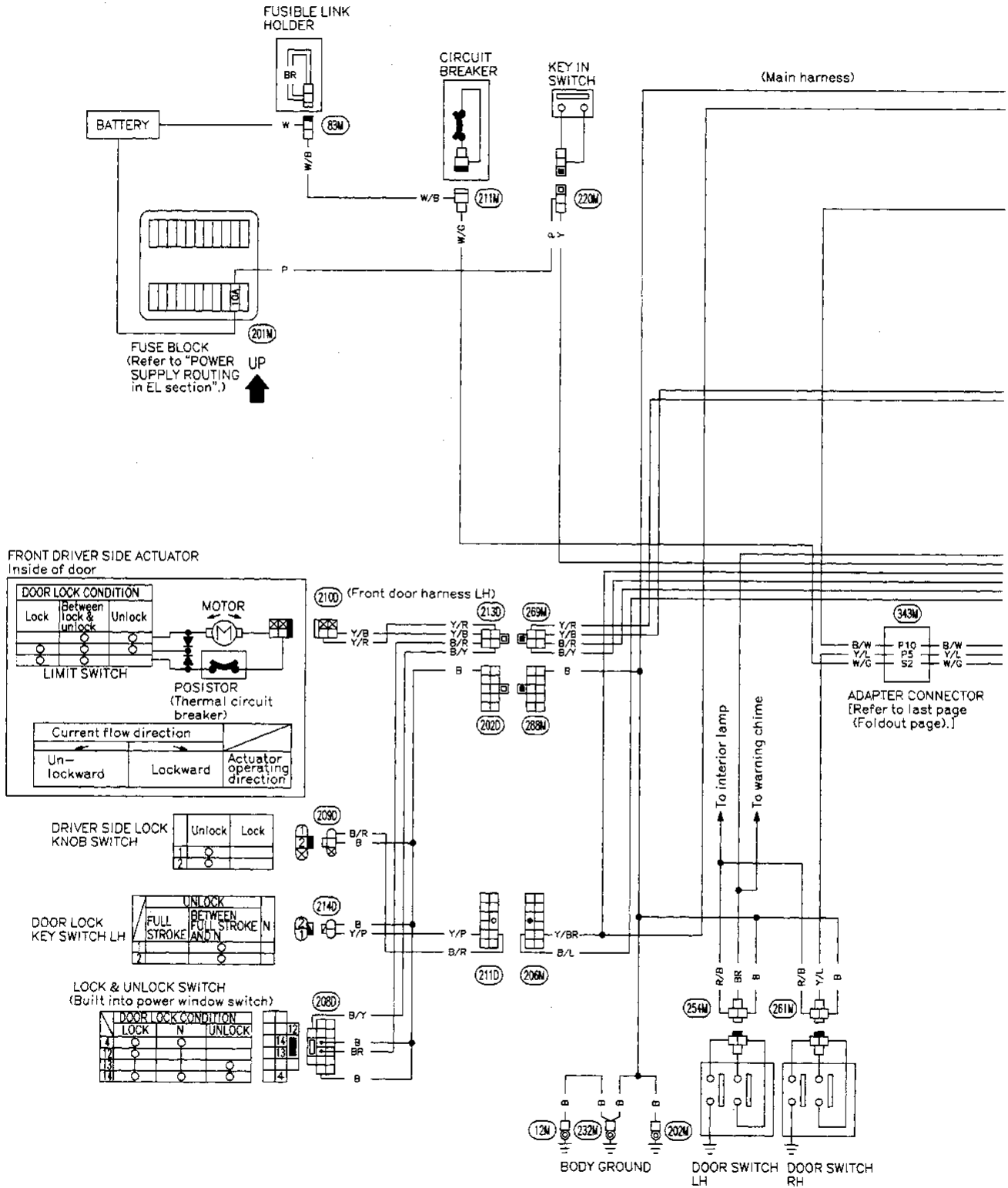

DOOR

Power Door Lock — WAGON (Cont'd)

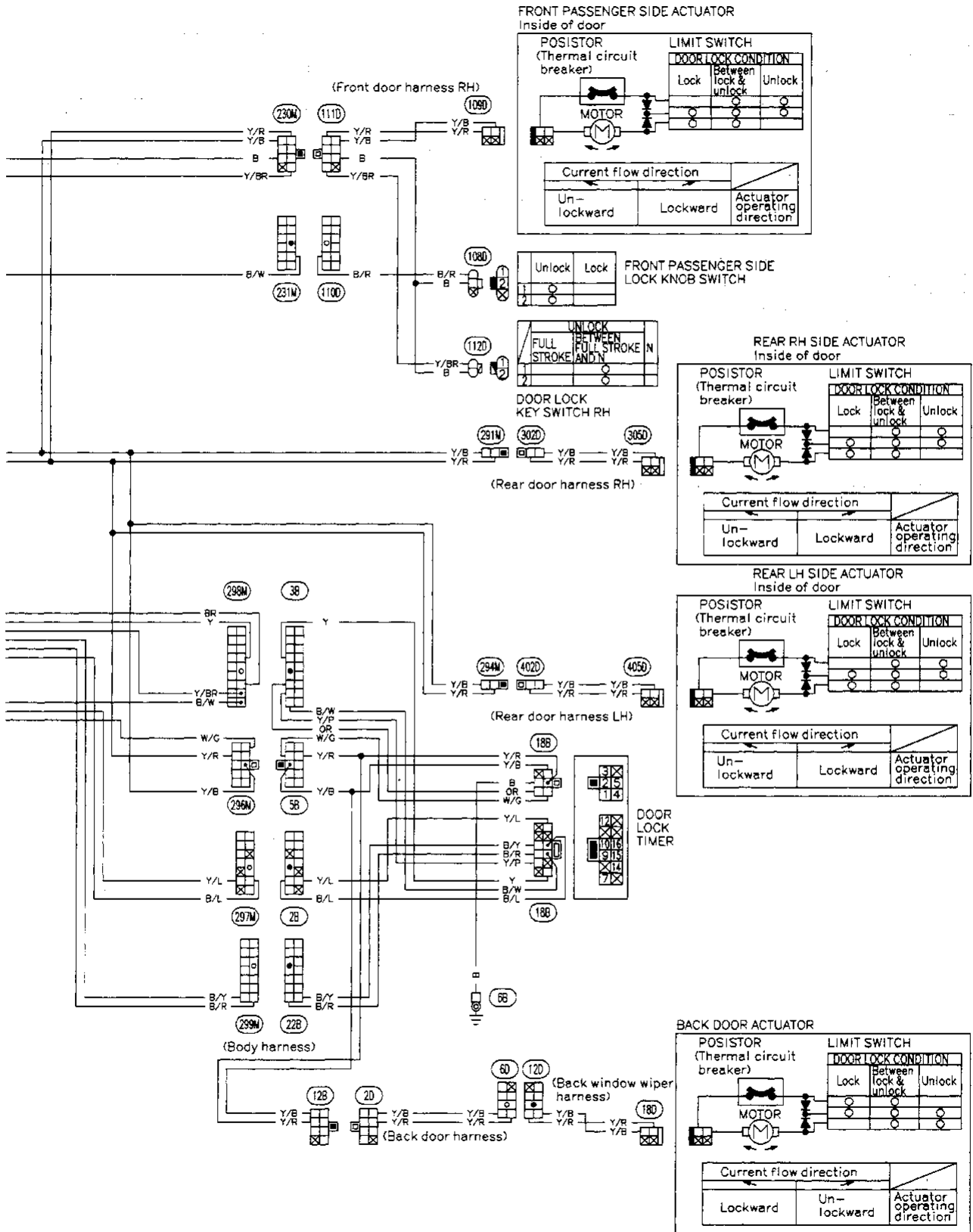

GI
MA
EM
LC
EF & EC
FE
CL
MT
AT
TF
PD
FA
RA
BR
ST
BF
HA
EL
IDX

DOOR

Power Door Lock — WAGON (Cont'd)

ELECTRICAL COMPONENTS INSPECTION

Door lock actuator

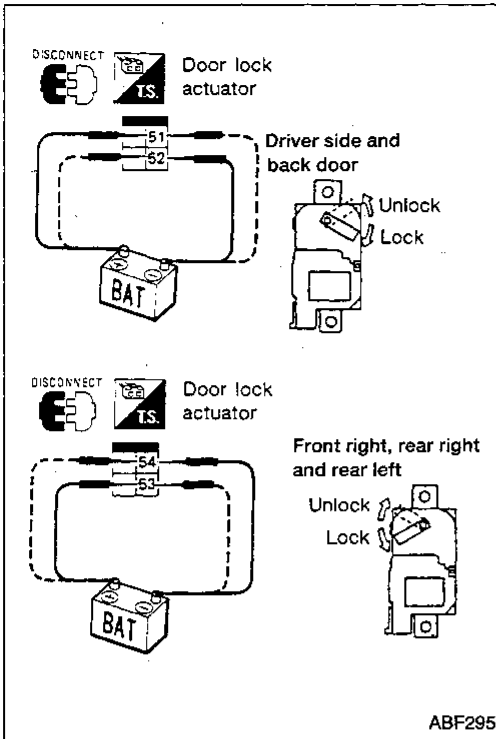

	Terminals		Operation
	⊕	⊖	
Driver side and back door	51	52	Lock
	52	51	Unlock
Front right, rear right and rear left	53	54	Lock
	54	53	Unlock

DOOR

NOTE

GI

MA

EM

LC

EF &
EC

FE

CL

MT

AT

TF

PD

FA

RA

BR

ST

BF

HA

EL

IDX

DOOR

Power Window

WIRING DIAGRAM

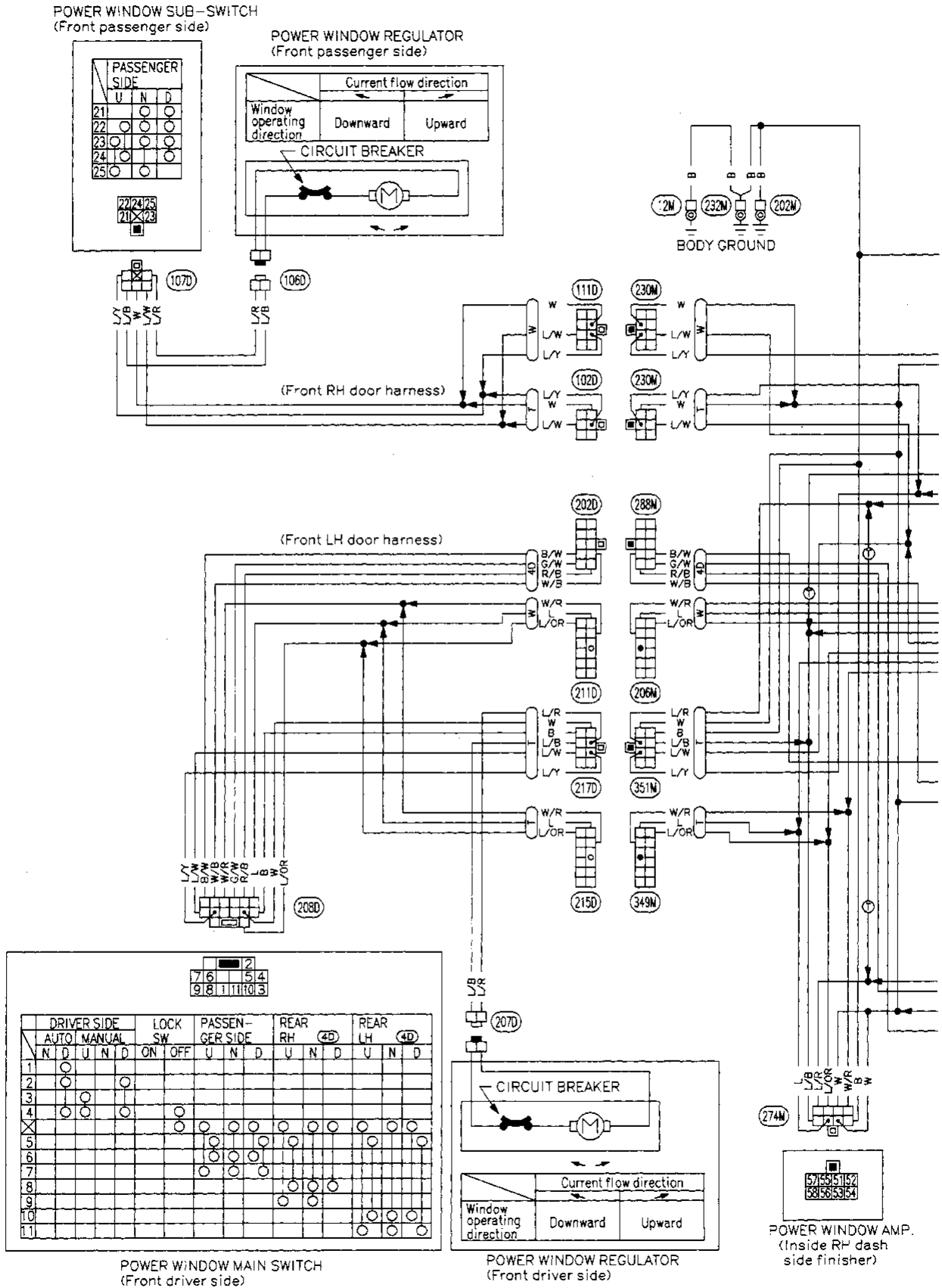

DOOR Power Window (Cont'd)

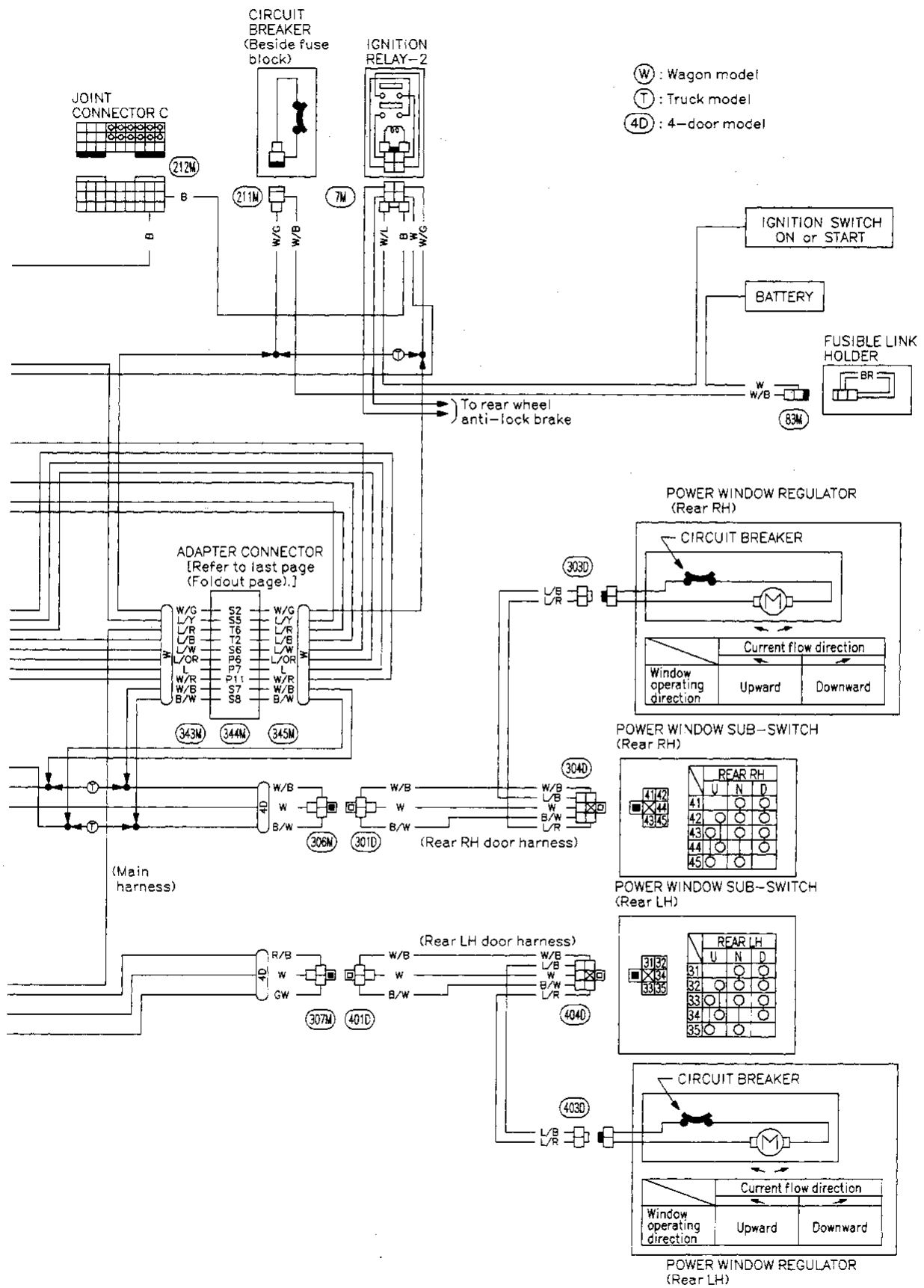

GI
MA
EM
LC
EF & EC
FE
CL
MT
AT
TF
PD
FA
RA
BR
ST
BF
HA
EL
IDX

Exterior — TRUCK

HIGH MOUNT STOP LAMP

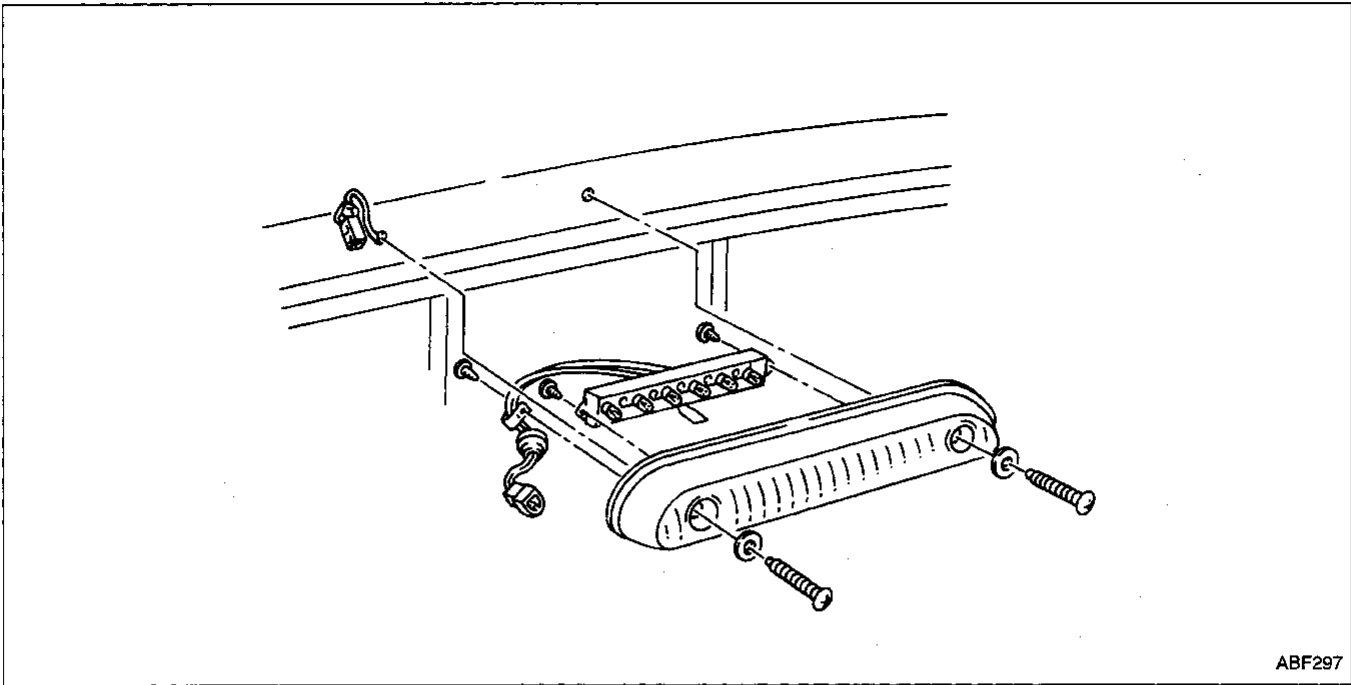

Heated Seat

WIRING DIAGRAM

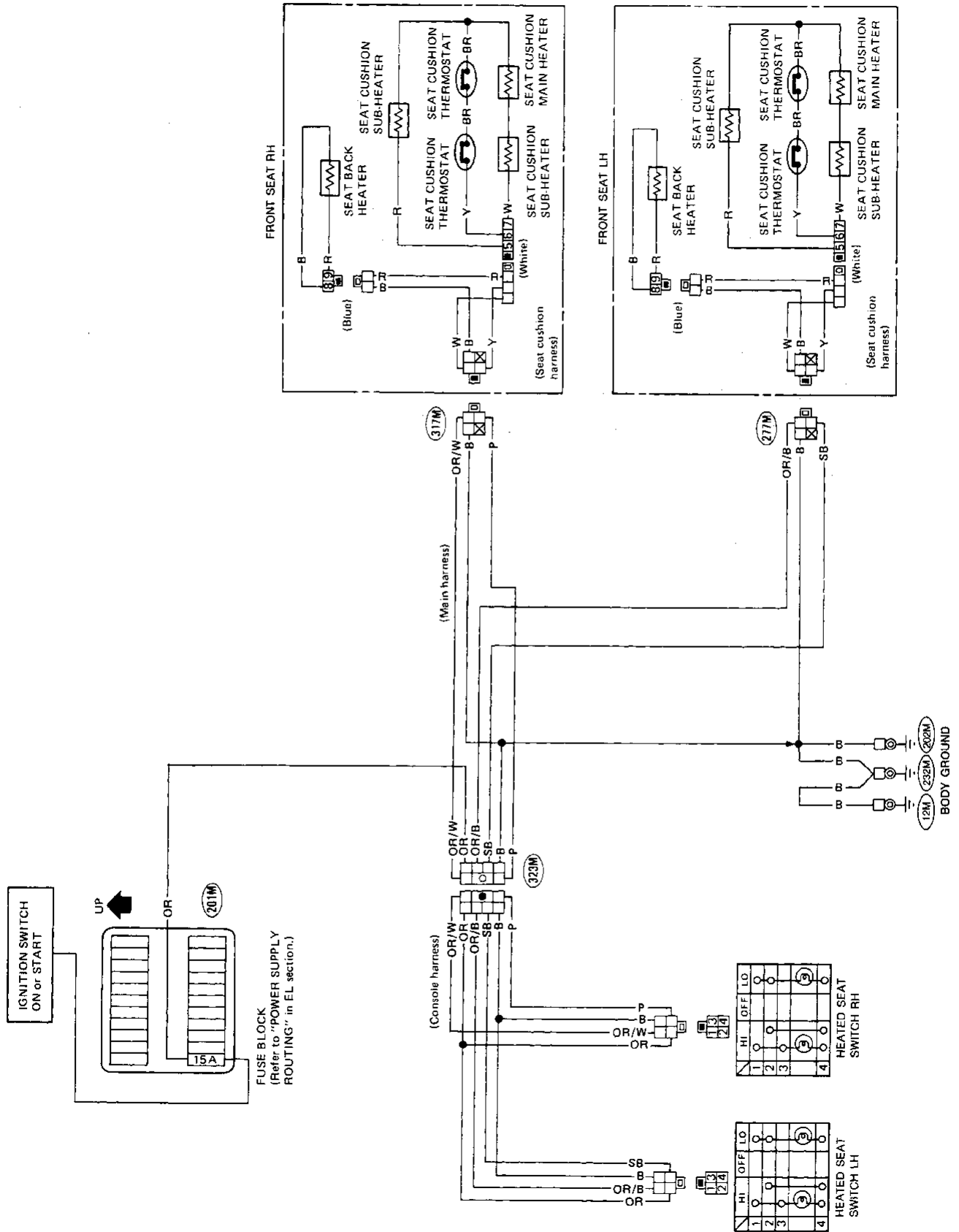

- CI
- MA
- EM
- LC
- EF & EC
- FE
- CL
- MT
- AT
- TF
- PD
- FA
- RA
- BR
- ST
- BF
- HA
- EL
- IDX

WINDSHIELD AND WINDOWS

Back Window — TRUCK

- Window glass is held in place by weatherstripping. For details regarding weatherstrip, refer to "Exterior".
- Apply sealant to clearances between vehicle body panel and weatherstrip as necessary.

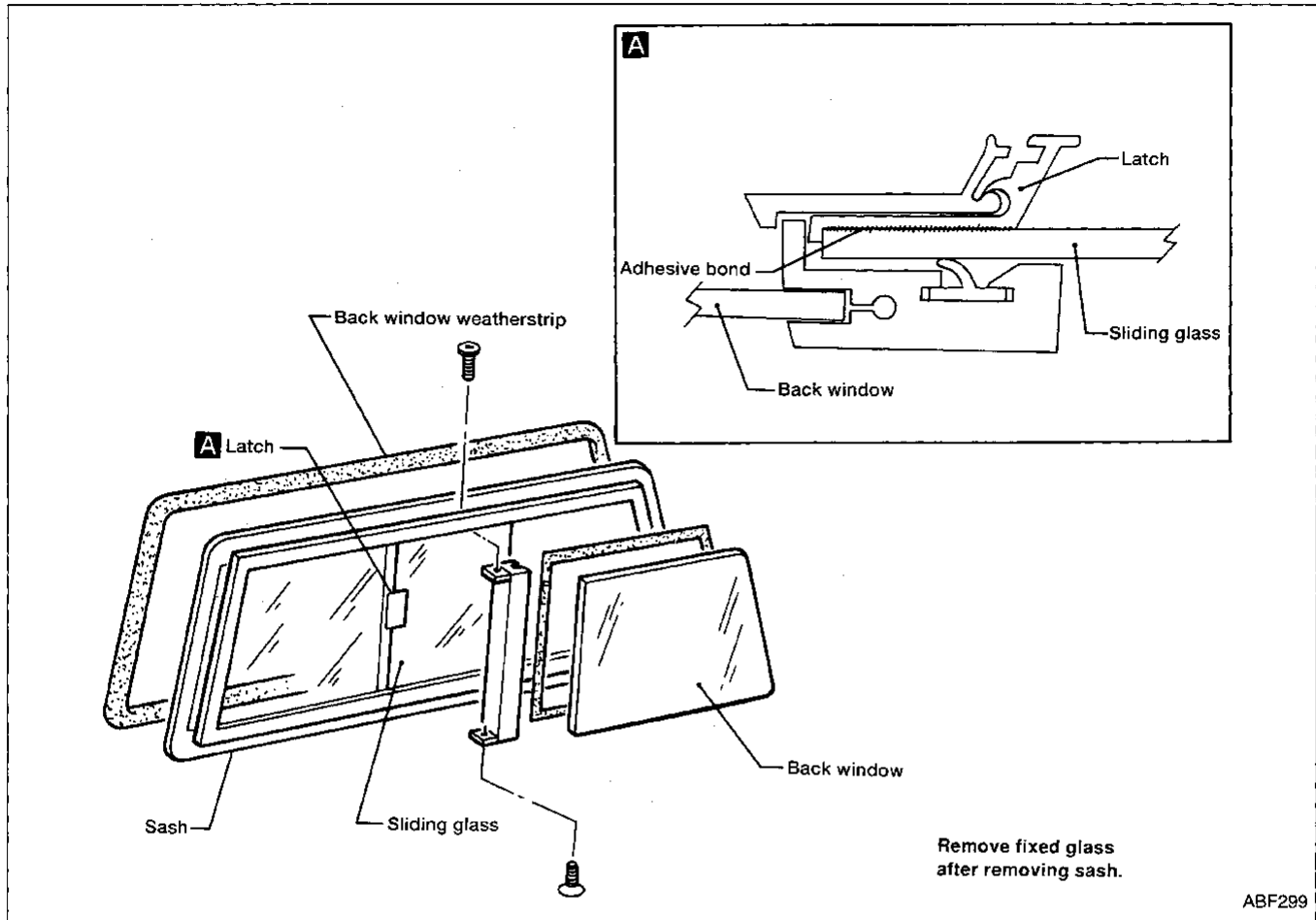

MIRROR

Door Mirror/Wiring Diagram

TRUCK MODEL

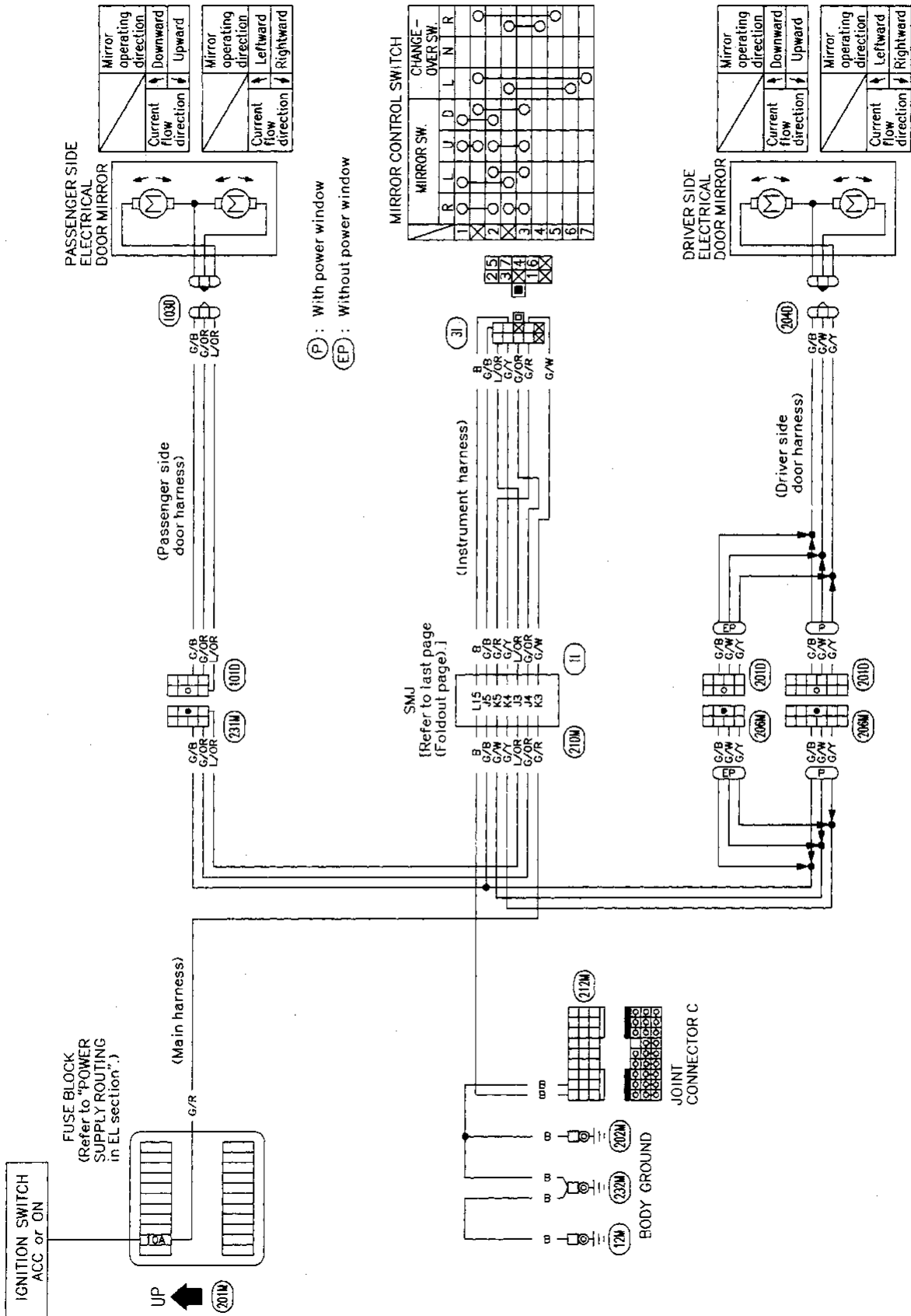

- GI
- MA
- EM
- LC
- EF & EC
- FE
- CL
- MT
- AT
- TF
- PD
- FA
- RA
- BR
- ST
- BF**
- HA
- EL
- IDX

MIRROR

Door Mirror/Wiring Diagram (Cont'd)

WAGON MODEL

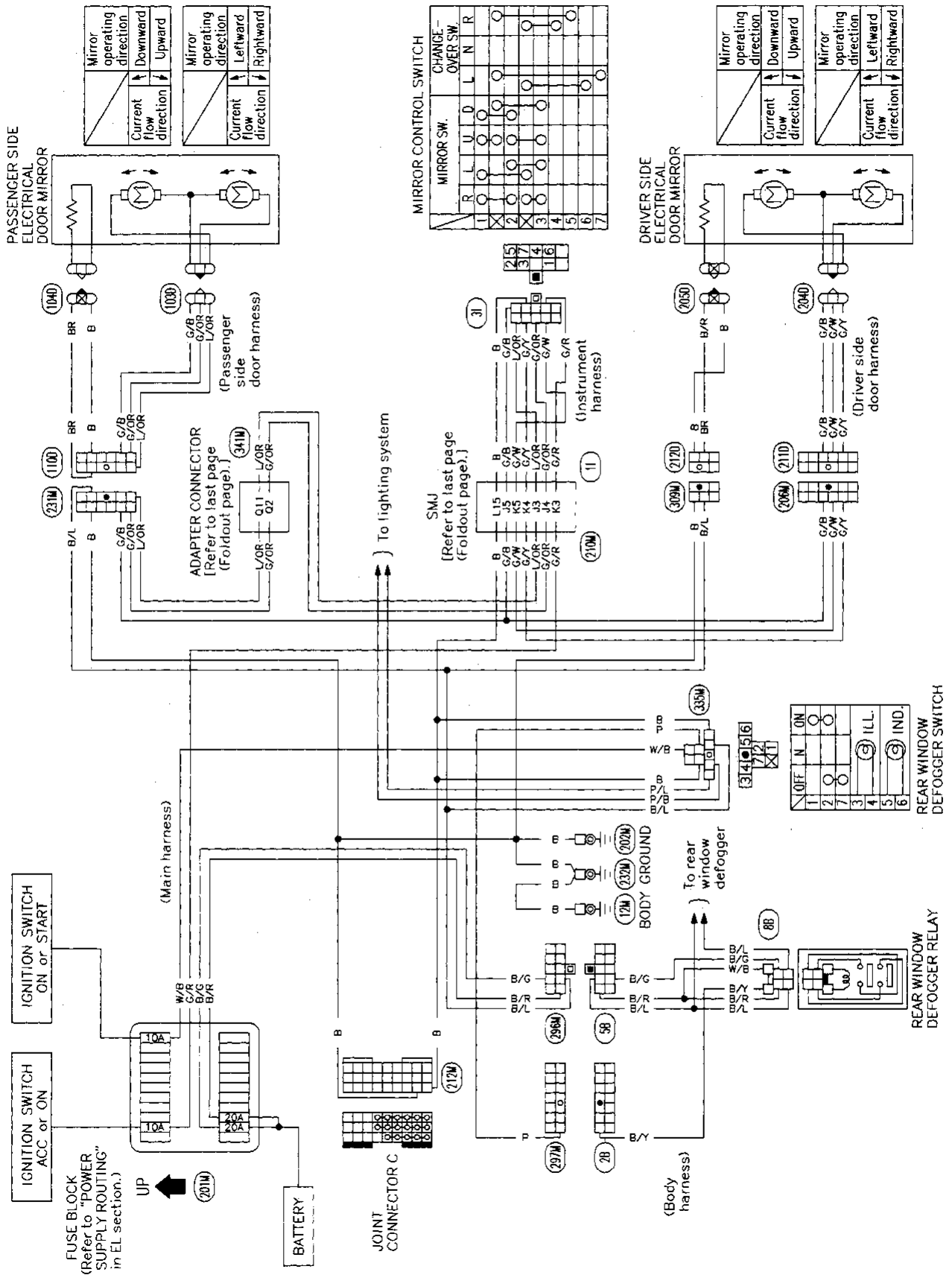

MIRROR

Rearview Mirror

REMOVAL

Remove rearview mirror by pushing deflect spring with screwdriver as shown in the figure.

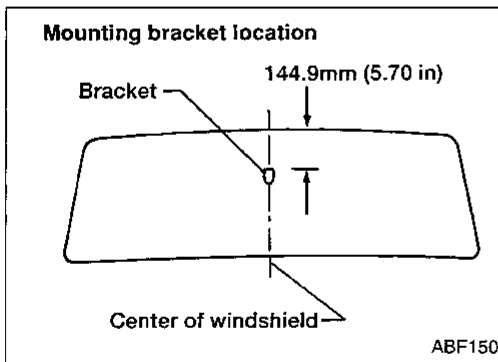
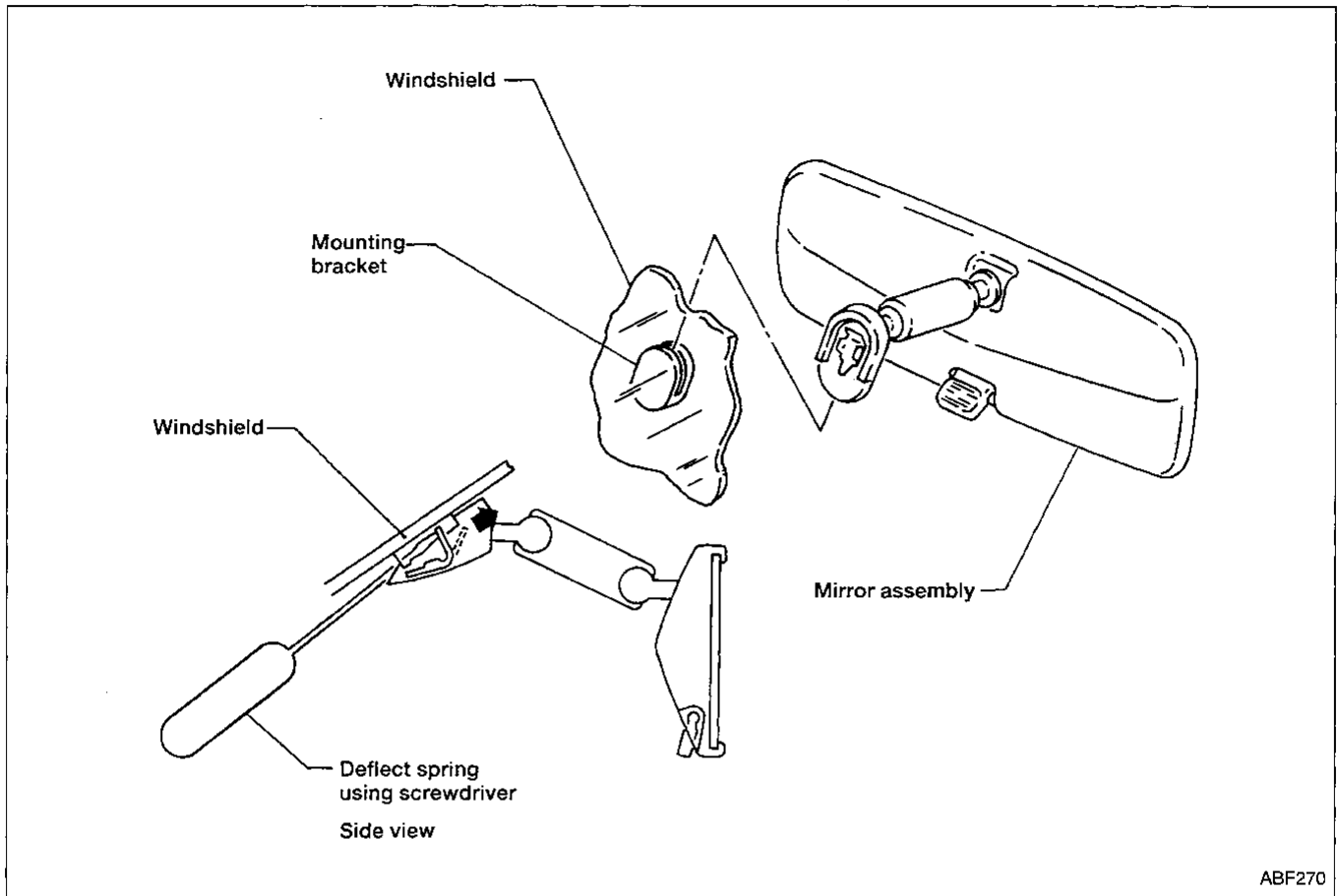

INSTALLATION

1. Install mounting bracket as follows:
 - (1) Determine mounting bracket position on windshield by measuring from top of windshield to top of mounting bracket as shown in the figure.
 - (2) Mark location on outside of windshield with wax pencil or equivalent.
 - (3) Clean attaching point on inside of windshield with an alcohol-saturated paper towel.
 - (4) Sand bonding surface of mounting bracket with sandpaper (No. 320 or No. 360).
 - (5) Clean bonding surface of mounting bracket with an alcohol-saturated paper towel.
 - (6) Apply Loctite Adhesive 11067-2 or equivalent to bonding surface of mounting bracket.
 - (7) Install mounting bracket at premarked position and press mounting bracket against glass for 30 to 60 seconds.
 - (8) After five minutes, wipe off excess adhesive with an alcohol-moistened paper towel.
2. Install rearview mirror.