

SECTION

EX

EX

EXHAUST SYSTEM

CONTENTS

PRECAUTION	2	PERIODIC MAINTENANCE	4
PRECAUTIONS	2	EXHAUST SYSTEM	4
Precautions for Removing of Battery Terminal	2	Inspection	4
Removal and Installation	2	REMOVAL AND INSTALLATION	5
PREPARATION	3	EXHAUST SYSTEM	5
PREPARATION	3	Exploded View	5
Commercial Service Tool	3	Removal and Installation	5
		Inspection	6

PRECAUTIONS

< PRECAUTION >

PRECAUTION

PRECAUTIONS

Precautions for Removing of Battery Terminal

INFOID:000000009953392

- When removing the 12V battery terminal, turn OFF the ignition switch and wait at least 30 seconds.

NOTE:

ECU may be active for several tens of seconds after the ignition switch is turned OFF. If the battery terminal is removed before ECU stops, then a DTC detection error or ECU data corruption may occur.

- For vehicles with the 2-batteries, be sure to connect the main battery and the sub battery before turning ON the ignition switch.

NOTE:

If the ignition switch is turned ON with any one of the terminals of main battery and sub battery disconnected, then DTC may be detected.

- After installing the 12V battery, always check "Self Diagnosis Result" of all ECUs and erase DTC.

NOTE:

The removal of 12V battery may cause a DTC detection error.

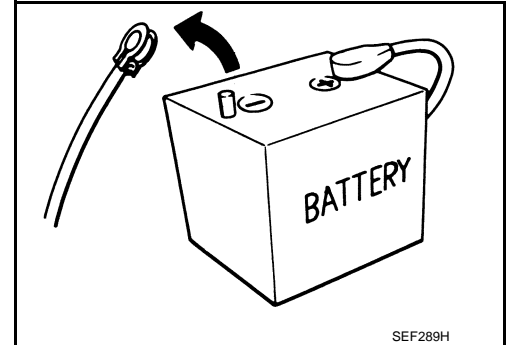

SEF289H

Removal and Installation

INFOID:000000009718025

CAUTION:

- Be sure to use genuine exhaust system parts or equivalents which are specially designed for heat resistance, corrosion resistance, and shape.
- Perform the operation with the exhaust system fully cooled down because the system will be hot just after engine stops.
- Be careful not to cut your hand on the heat insulator edge.

PREPARATION

< PREPARATION >

PREPARATION

PREPARATION

Commercial Service Tool

INFOID:0000000009718026

A

EX

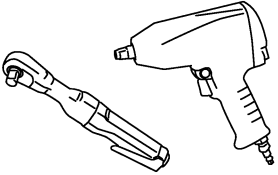
Tool name	Description
Power tool	Loosening nuts and bolts
 PBIC0190E	

C

D

E

F

G

H

I

J

K

L

M

N

O

P

EXHAUST SYSTEM

< PERIODIC MAINTENANCE >

PERIODIC MAINTENANCE

EXHAUST SYSTEM

Inspection

Check exhaust pipes, muffler, and mounting for improper attachment, leakage, cracks, damage or deterioration.

- If anything is found, repair or replace damaged parts.

INFOID:000000009718027

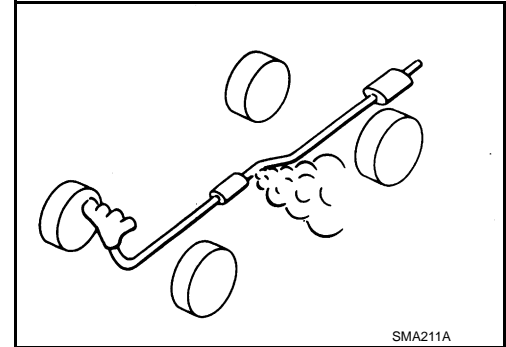

SMA211A

EXHAUST SYSTEM

< REMOVAL AND INSTALLATION >

REMOVAL AND INSTALLATION

EXHAUST SYSTEM

Exploded View

INFOID:000000009718028

A

EX

C

D

E

F

G

H

I

J

K

L

M

N

O

P

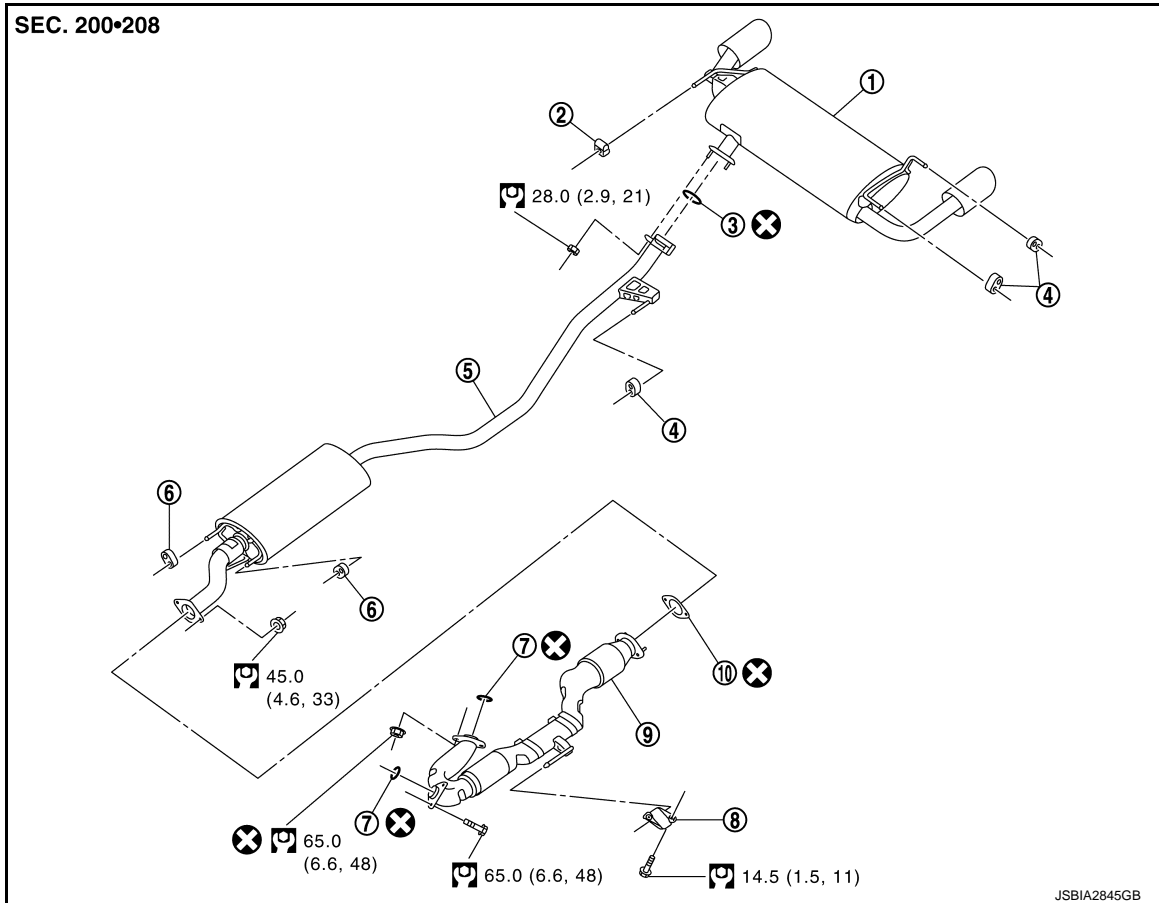

- | | | |
|--------------------|--------------------|-----------------------|
| 1. Main muffler | 2. Mounting rubber | 3. Gasket |
| 4. Mounting rubber | 5. Center muffler | 6. Mounting rubber |
| 7. Gasket | 8. Mounting rubber | 9. Exhaust front tube |
| 10. Gasket | | |

⊗ : Always replace after every disassembly.

⌚ : N-m (kg-m, ft-lb)

Removal and Installation

INFOID:000000009718029

REMOVAL

Disconnect each joint and mounting using power tool.

INSTALLATION

Note the following, and install in the reverse order of removal.

- If exhaust front tube stud bolts were removed, and install them and tighten to the specified torque below.

⌚: 14.7 N-m (1.5 kg-m, 11 ft-lb)

CAUTION:

- Always replace exhaust tube gaskets with new ones when reassembling.
- If heat insulator is badly deformed, repair or replace it. If deposits such as mud pile up on the heat insulator, remove them.

EXHAUST SYSTEM

< REMOVAL AND INSTALLATION >

- When installing heat insulator avoid large gaps or interference between heat insulator and each exhaust pipe.
- Remove deposits from the sealing surface of each connection. Connect them securely to avoid gas leakage.
- Temporarily tighten mounting nuts and bolts. Check each part for unusual interference, and then tighten them to the specified torque.
- When installing each mounting rubber, avoid twisting or unusual extension in up/down and right/left directions.

Inspection

INFOID:000000009718030

INSPECTION AFTER INSTALLATION

- Check clearance between tail tube and rear bumper is even at right and left.
- With engine running, check exhaust tube joints for gas leakage and unusual noises.
- Check to ensure that mounting brackets and mounting rubbers are installed properly and free from undue stress. Improper installation could result in excessive noise and vibration.