

SECTION **SB**
SEAT BELT

A
B
C
D
E
F
G
SB
I
J
K
L
M
N
O
P

CONTENTS

PRECAUTION	2	COMPONENT INSPECTION	5
PRECAUTIONS	2	Inspection	5
Precaution for Supplemental Restraint System (SRS) "AIR BAG" and "SEAT BELT PRE-TEN- SIONER"	2	REMOVAL AND INSTALLATION	8
Precaution for Seat Belt Service	2	FRONT SEAT BELT	8
Precaution for Work	2	Front Seat Belt	8
PREPARATION	4	SECOND ROW SEAT BELT	12
PREPARATION	4	Removal and Installation	12
Special Service Tool	4	THIRD ROW SEAT BELT	16
BASIC INSPECTION	5	Removal and Installation	16
		FOURTH ROW SEAT BELT	20
		Removal and Installation	20

PRECAUTIONS

< PRECAUTION >

PRECAUTION

PRECAUTIONS

Precaution for Supplemental Restraint System (SRS) "AIR BAG" and "SEAT BELT PRE-TENSIONER"

INFOID:000000012521392

The Supplemental Restraint System such as "AIR BAG" and "SEAT BELT PRE-TENSIONER", used along with a front seat belt, helps to reduce the risk or severity of injury to the driver and front passenger for certain types of collision. This system includes seat belt switch inputs and dual stage front air bag modules. The SRS system uses the seat belt switches to determine the front air bag deployment, and may only deploy one front air bag, depending on the severity of a collision and whether the front occupants are belted or unbelted. Information necessary to service the system safely is included in the SR and SB section of this Service Manual.

WARNING:

- To avoid rendering the SRS inoperative, which could increase the risk of personal injury or death in the event of a collision which would result in air bag inflation, all maintenance must be performed by an authorized NISSAN/INFINITI dealer.
- Improper maintenance, including incorrect removal and installation of the SRS, can lead to personal injury caused by unintentional activation of the system. For removal of Spiral Cable and Air Bag Module, see the SR section.
- Do not use electrical test equipment on any circuit related to the SRS unless instructed to in this Service Manual. SRS wiring harnesses can be identified by yellow and/or orange harnesses or harness connectors.

PRECAUTIONS WHEN USING POWER TOOLS (AIR OR ELECTRIC) AND HAMMERS

WARNING:

- When working near the Airbag Diagnosis Sensor Unit or other Airbag System sensors with the Ignition ON or engine running, DO NOT use air or electric power tools or strike near the sensor(s) with a hammer. Heavy vibration could activate the sensor(s) and deploy the air bag(s), possibly causing serious injury.
- When using air or electric power tools or hammers, always switch the Ignition OFF, disconnect the battery and wait at least three minutes before performing any service.

Precaution for Seat Belt Service

INFOID:000000012857598

CAUTION:

- Before removing the front seat belt pre-tensioner assembly, turn the ignition switch off, disconnect both battery cables and wait at least 3 minutes.
- Do not use electrical test equipment for front seat belt pre-tensioner connector.
- After replacing or reinstalling front seat belt pre-tensioner assembly, or reconnecting front seat belt pre-tensioner connector, check the system function. Refer to [SRC-13, "SRS Operation Check"](#).
- Do not disassemble buckle or seat belt assembly.
- Replace anchor bolts if they are deformed or worn out.
- Do not oil tongue and buckle.
- If any component of seat belt assembly is questionable, do not repair. Replace the whole seat belt assembly.
- If webbing is cut, frayed, or damaged, replace seat belt assembly.
- When replacing seat belt assembly, use a genuine NISSAN seat belt assembly.

Precaution for Work

INFOID:000000012521393

- When removing or disassembling each component, be careful not to damage or deform it. If a component may be subject to interference, be sure to protect it with a shop cloth.
- When removing (disengaging) components with a screwdriver or similar tool, be sure to wrap the component with a shop cloth or vinyl tape to protect it.
- Protect the removed parts with a shop cloth and prevent them from being dropped.
- Replace a deformed or damaged clip.
- If a part is specified as a non-reusable part, always replace it with a new one.
- Be sure to tighten bolts and nuts securely to the specified torque.
- After installation is complete, be sure to check that each part works properly.

PRECAUTIONS

< PRECAUTION >

- Follow the steps below to clean components:
- Water soluble dirt:
 - Dip a soft cloth into lukewarm water, wring the water out of the cloth and wipe the dirty area.
 - Then rub with a soft, dry cloth.
- Oily dirt:
 - Dip a soft cloth into lukewarm water with mild detergent (concentration: within 2 to 3%) and wipe the dirty area.
 - Then dip a cloth into fresh water, wring the water out of the cloth and wipe the detergent off.
 - Then rub with a soft, dry cloth.
- Do not use organic solvent such as thinner, benzene, alcohol or gasoline.
- For genuine leather seats, use a genuine leather seat cleaner.

A

B

C

D

E

F

G

SB

I

J

K

L

M

N

O

P

PREPARATION

< PREPARATION >

PREPARATION

PREPARATION

Special Service Tool

INFOID:000000012521394

The actual shape of the tools may differ from those illustrated here.

Tool number (TechMate No.) Tool name	Description
— (J-46534) Trim Tool Set	Removing trim components

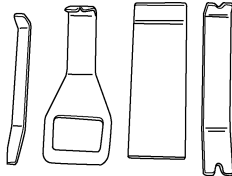

AWJIA0483ZZ

COMPONENT INSPECTION

< BASIC INSPECTION >

BASIC INSPECTION

COMPONENT INSPECTION

Inspection

INFOID:0000000012521395

AFTER A COLLISION

WARNING:

Inspect all seat belt assemblies including retractors and attaching hardware after any collision. NISSAN/INFINITI recommends that all seat belt assemblies in use during a collision be replaced unless the collision was minor and the belts show no damage and continue to operate properly. Failure to do so could result in serious personal injury in an accident. Seat belt assemblies not in use during a collision should also be replaced if either damage or improper operation is noted. Seat belt pretensioners should be replaced even if the seat belts are not in use during a frontal collision in which the air bags are deployed.

Replace any seat belt assembly (including anchor bolts) if:

- The seat belt was in use at the time of a collision (except for minor collisions and the belts, retractors and buckles show no damage and continue to operate properly).
- The seat belt was damaged in an accident (i.e. torn webbing, bent retractor or guide, etc.).
- The seat belt attaching point is damaged in an accident. Inspect the seat belt attaching area for damage or distortion and repair if necessary before installing a new seat belt assembly.
- Anchor bolts are deformed or worn out.
- The seat belt pre-tensioner should be replaced even if the seat belts are not in use during the collision in which the air bags are deployed.

PRELIMINARY CHECKS

1. Check the seat belt warning lamp for proper operation per the following:
 - a. Turn ignition switch ON. The seat belt warning lamp should illuminate.
 - b. Fasten driver seat belt. The seat belt warning lamp should turn OFF.
 2. If the air bag warning lamp is blinking, perform self-diagnosis with CONSULT and air bag warning lamp. Refer to [SRC-15. "Trouble Diagnosis without CONSULT"](#).
 3. Check that the seat belt retractor, seat belt anchor and buckle bolts are tightened firmly.
 4. Check the shoulder seat belt guide and shoulder belt height adjuster for front seats. Check that guide swivels freely and that webbing lays flat and does not bind in guide. Check that height adjuster operates properly and holds securely.
 5. Check retractor operation:
 - a. Fully extend the seat belt webbing and check for twists, tears or other damage.
 - b. Allow the seat belt to retract. Check that webbing returns smoothly and completely into the retractor. If the seat belt does not return smoothly, wipe the inside of the loops with a clean paper cloth. Dirt build-up in the loops of the upper anchors can cause the seat belts to retract slowly.
 - c. Fasten the seat belt. Check that seat belt returns smoothly and completely to the retractor. If the webbing does not return smoothly, the cause may be an accumulation of dust or dirt. Use the "SEAT BELT TAPE SET" and perform the following steps.
 - d. Inspect the front seat belt D-ring anchor
 1. Pull the seat belt out to a length of 500 mm (19.69 in) or more.
 2. Hold the seat belt at the center pillar webbing opening with a clip or other device.
 3. Pass a thin wire through the D-ring anchor webbing opening. Hold both ends of the wire and pull it tightly while moving it up and down several times along the webbing opening surface to remove dirt stuck there.
 4. Any dirt that cannot be removed with the wire can be removed by cleaning the opening with a clean cloth.
 5. Apply tape at the point where the webbing contacts the D-ring anchor webbing opening.
NOTE:
Apply the tape so that there is no slack or wrinkling.
 6. Remove the clip holding the seat belt and check that the webbing returns smoothly.
6. Repeat steps above if necessary to check the other seat belts.

COMPONENT INSPECTION

< BASIC INSPECTION >

SEAT BELT RETRACTOR ON-VEHICLE CHECK

Emergency Locking Retractors (ELR) and Automatic Locking Retractors (ALR)

NOTE:

All seat belt retractors are Emergency Locking Retractors (ELR) type. In an emergency (sudden stop) the retractor will lock and prevent the webbing from extending any further. All 3-point type seat belt retractors except the driver seat belt also have an Automatic Locking Retractors (ALR) mode. The ALR mode (also called child restraint mode) is used when installing child seats. The ALR mode is activated when the seat belt is fully extended. When the webbing is then retracted partially, the ALR mode automatically locks the seat belt in a specific position so the webbing cannot be extended any further. To cancel the ALR mode, allow the seat belt to fully wind back into the retractor.

Check the seat belt retractors with the following test(s) to determine if a retractor assembly is operating properly.

ELR Function Stationary Check

Grasp the shoulder webbing and pull forward quickly. The retractor should lock and prevent the belt from extending further.

ALR Function Stationary Check

1. Pull out the entire length of seat belt from retractor until a click is heard.
2. Retract the webbing partially. A clicking noise should be heard as the webbing retracts, indicating that the retractor is in the Automatic Locking Retractors (ALR) mode.
3. Grasp the seat belt and try to pull out the retractor. The webbing must lock and not extend any further. If it does not operate normally, replace the retractor assembly.
4. Allow the entire length of the webbing to retract to cancel the automatic locking mode.

ELR Function Moving Check

WARNING:

Perform the following test in a safe, open area clear of other vehicles and obstructions (for example, a large, empty parking lot). Road surface must be paved and dry. Never perform the following test on wet or gravel roads or on public streets and highways. This could result in an accident and serious personal injury. The driver and passenger must be prepared to brace themselves in the event that the retractor does not lock.

1. Fasten driver seat belt. Buckle a passenger into the seat for the belt that is to be tested.
2. Proceed to the designated safe area.
3. Drive the vehicle at approximately 16 km/h (10 MPH). Notify any passengers of a pending sudden stop and the driver and passenger must be prepared to brace themselves in the event that the retractor does not lock. Apply brakes firmly and make a very hard stop.

During stopping, seat belts should lock and not be extended. If the seat belt retractor assembly does not lock, perform the retractor off-vehicle check.

FRONT SEAT BELT RETRACTOR OFF-VEHICLE CHECK

1. Remove the front seat belt retractor. Refer to [SB-8, "Front Seat Belt"](#).
2. Slowly pull out webbing while tilting the seat belt retractor forward from the mounted position without twisting the seat belt retractor as shown.

A : The webbing can be pulled out if the retractor is tilted 15° degree or less.

B : The webbing can not be pulled out if the retractor is tilted 27° degrees or more.

NOTE:

A and B show tilting angles.

↔: Front

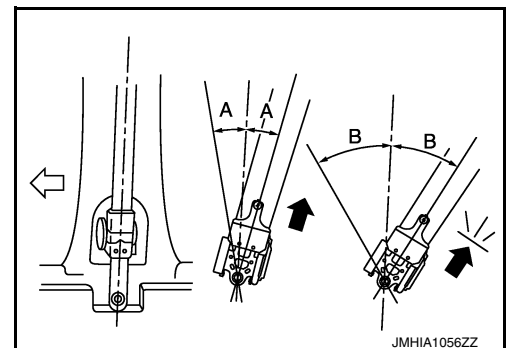

3. Replace the seat belt retractor if it does not operate within specifications.

REAR SEAT BELT CENTER RETRACTOR OFF-VEHICLE CHECK

COMPONENT INSPECTION

< BASIC INSPECTION >

1. Remove the rear seat belt center retractor. Refer to [SB-12. "Removal and Installation"](#).
2. Slowly pull out webbing while tilting the seat belt retractor forward from the mounted position without twisting the seat belt retractor as shown.

A : The webbing can be pulled out if the retractor is tilted 25° degree or less.

B : The webbing can not be pulled out if the retractor is tilted 39° degrees or more.

NOTE:

A and B show tilting angles.

⇐: Front

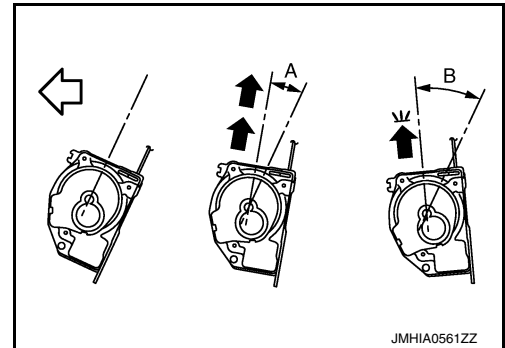

3. Replace the seat belt retractor if it does not operate within specifications.

A
B
C
D
E
F
G
I
J
K
L
M
N
O
P

SB

FRONT SEAT BELT

< REMOVAL AND INSTALLATION >

REMOVAL AND INSTALLATION

FRONT SEAT BELT

Front Seat Belt

INFOID:000000012521396

EXPLODED VIEW - SEAT BELT RETRACTOR AND HEIGHT ADJUSTER

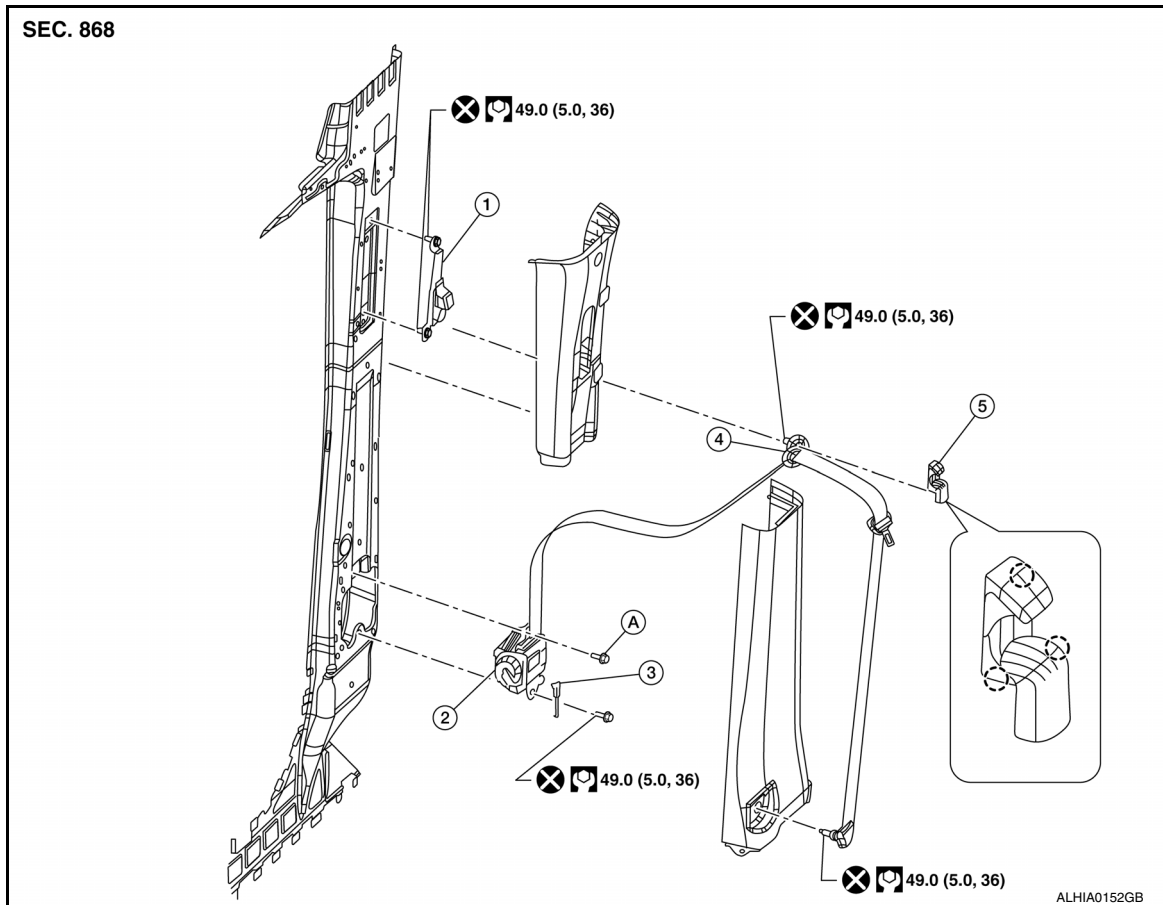

- | | | |
|------------------------------|-----------------------------|--|
| 1. Seat belt height adjuster | 2. Seat belt retractor | 3. Seat belt pre-tensioner harness connector |
| 4. D-ring anchor | 5. D-ring anchor bolt cover | A. Seat belt retractor upper bolt |

NOTE:

RH side shown; LH side similar

REMOVAL AND INSTALLATION - SEAT BELT RETRACTOR AND HEIGHT ADJUSTER

Removal - Seat Belt Retractor

CAUTION:

Before servicing SRS, turn the ignition switch off, disconnect both battery terminals and wait at least three minutes.

1. Disconnect both the negative and positive battery terminals, then wait at least three minutes. Refer to [PG-95, "Removal and Installation"](#).

FRONT SEAT BELT

< REMOVAL AND INSTALLATION >

2. Release the pawls to remove the D-ring anchor bolt cover, using a suitable tool (A).

⇐: Front

○: Pawl

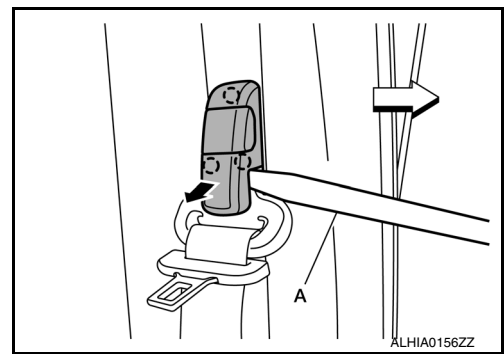

3. Remove the D-ring anchor bolt.
4. Pull back the lower anchor bolt cover and remove the lower anchor bolt.
5. Remove the center pillar lower finisher. Refer to [INT-26. "CENTER PILLAR LOWER FINISHER : Removal and Installation"](#).
6. Disconnect the harness connector from the seat belt pre-tensioner.

CAUTION:

- For removing pre-tensioner connector, insert a thin screwdriver (1) wrapped in tape (3) into the notch. Lift the locking tab to unlock (2), then remove the connector.
- Install the pre-tensioner connector with the locking tab raised, then push the locking tab into the connector to lock (4).

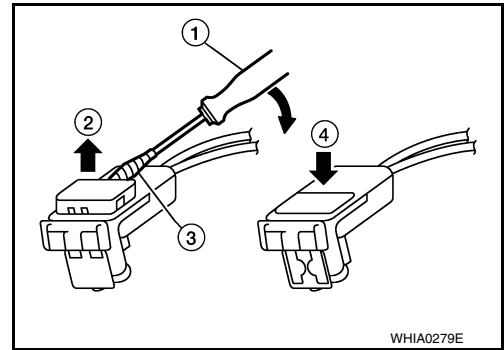

7. Remove the seat belt retractor anchor bolt and upper bolt, then remove the seat belt retractor.

Installation - Seat Belt Retractor

Installation is in the reverse order of removal.

- Install the seat belt retractor upper bolt first.
- Make sure that seat belt height adjuster is locked in the lowest position during installation.

Removal - Seat Belt Height Adjuster

1. Release the pawls to remove the D-ring anchor bolt cover, using a suitable tool (A).

⇐: Front

○: Pawl

2. Remove the D-ring anchor bolt.
3. Pull back the lower anchor bolt cover and remove the lower anchor bolt.
4. Remove the center pillar upper finisher. Refer to [INT-27. "CENTER PILLAR UPPER FINISHER : Removal and Installation"](#).
5. Remove the seat belt height adjuster bolts and the seat belt height adjuster.

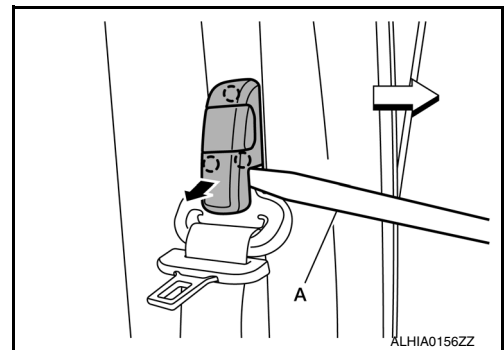

Installation - Seat Belt Height Adjuster

Installation is in the reverse order of removal.

- Make sure that seat belt height adjuster is locked in the lowest position during installation.

EXPLODED VIEW - SEAT BELT BUCKLE

FRONT SEAT BELT

< REMOVAL AND INSTALLATION >

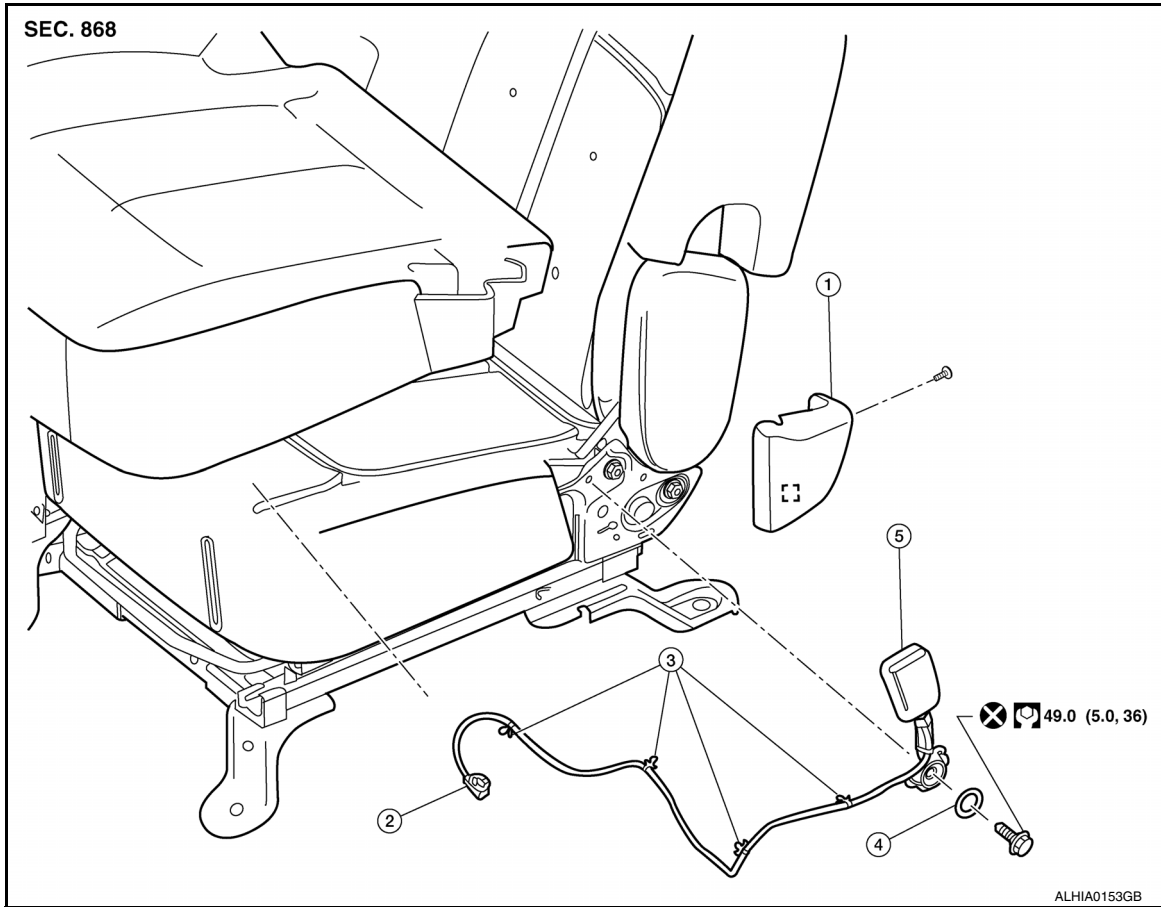

- | | | |
|-------------------------------------|---------------------------------------|-----------------------------------|
| 1. Seat cushion outer finisher (LH) | 2. Seat belt buckle harness connector | 3. Seat belt buckle harness clips |
| 4. Washer | 5. Seat belt buckle | ☐ Metal clip |

NOTE:

RH side shown; LH side similar

REMOVAL AND INSTALLATION - SEAT BELT BUCKLE

Removal

1. Remove the front center console (if equipped). Refer to [IP-25, "Removal and Installation"](#).
2. Remove the seat cushion outer finisher (RH-driver seat or LH-passenger seat) screw.
3. Release the seat cushion outer finisher metal clip and remove the seat cushion outer finisher.
4. For passenger seat, release the J-clip (A) and hook fastener (B), then peel back the passenger seat cushion trim to access the seat belt buckle harness connector. Refer to [SE-47, "Disassembly and Assembly"](#).

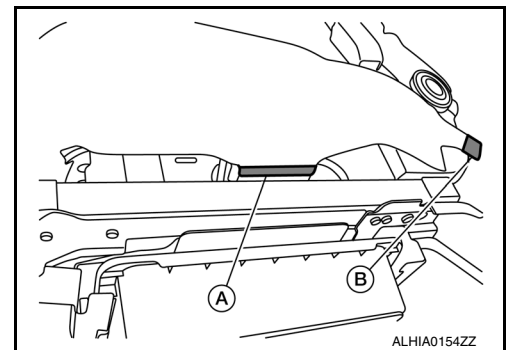

FRONT SEAT BELT

< REMOVAL AND INSTALLATION >

5. For driver seat, using a suitable tool (A), release the clip (B) and the J-clip, then peel back the driver seat cushion trim to access the seat belt buckle harness connector. Refer to [SE-47. "Disassembly and Assembly"](#).
6. Release the seat belt buckle harness clips from the front seat frame.
NOTE:
Be sure to identify the seat belt buckle harness routing and clip positions for installation.
7. Remove the front seat belt buckle anchor bolt and seat belt buckle from the front seat frame.

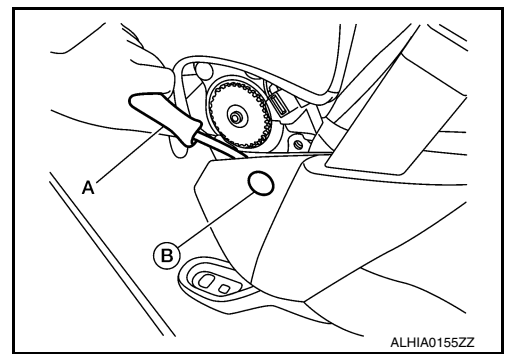

Installation

Installation is in the reverse order of removal.

CAUTION:

During installation, the front seat belt buckle switch harness clips must be installed in the holes they were originally in. Do not add additional clips or route the harness differently.

A
B
C
D
E
F
G
SB
I
J
K
L
M
N
O
P

SECOND ROW SEAT BELT

< REMOVAL AND INSTALLATION >

3. Remove seat belt retractor lower anchor bolt (A) from the seat belt (1).
⇐: Front
4. Remove the RH seatback trim. Refer to [SE-60, "Disassembly and Assembly - RH Seat"](#).
5. Release the push pin and remove the seat belt retractor shield.

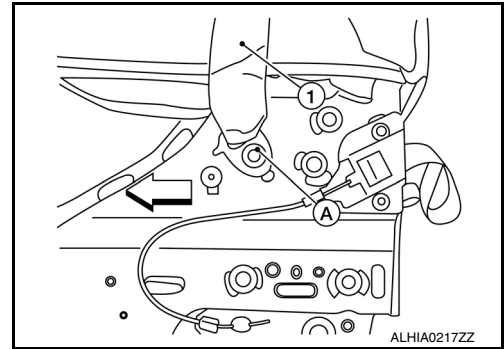

6. Remove the seat belt retractor upper anchor bolt (A), then remove the seat belt retractor (1).
⇐: Front

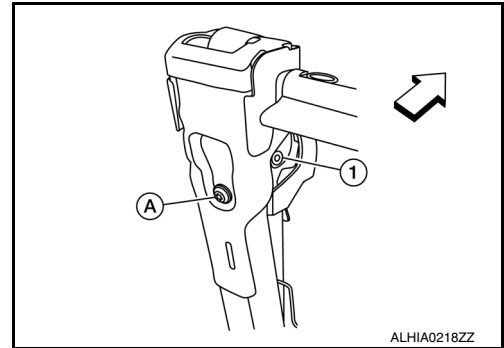

Installation

Installation is in the reverse order of removal.

SEAT BELT BUCKLE - RH SEAT

Removal

1. Pull back the seat cushion trim (1) enough to expose the seat belt buckle anchor bolt (A).
2. Remove seat belt buckle anchor bolt (A), then remove the seat belt buckle.

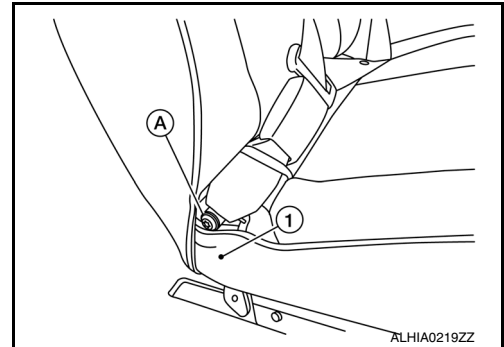

Installation

Installation is in the reverse order of removal.

SEAT BELT RETRACTOR - LH BENCH SEAT

Removal

1. Remove the second row LH bench seat. Refer to [SE-33, "Removal and Installation"](#).
2. Remove seat belt retractor.

A
B
C
D
E
F
G
SB
I
J
K
L
M
N
O
P

SECOND ROW SEAT BELT

< REMOVAL AND INSTALLATION >

- a. For seat belt retractor (LH), remove the lower anchor bolt (A) from the seat belt.

⇐: Front

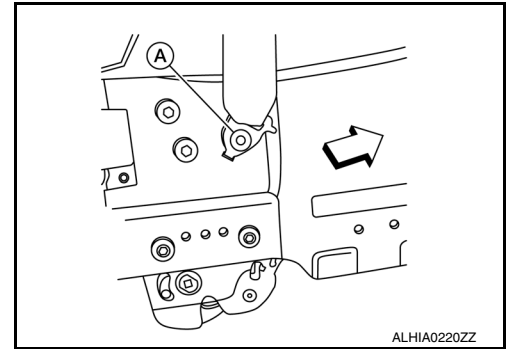

- b. For seat belt retractor (center), remove the lower anchor bolt (A) (along with the seat belt buckle-center), then thread the seat belt through the opening in the seat cushion trim.

⇐: Front

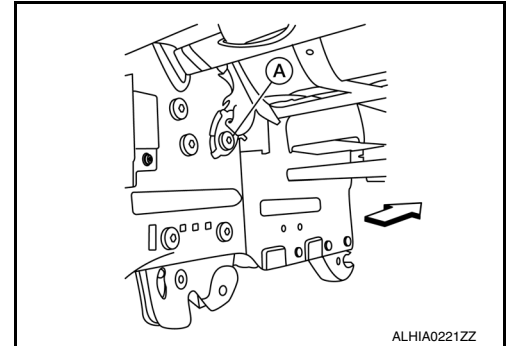

3. Remove the LH bench seat seatback trim, refer to [SE-58. "Disassembly and Assembly - LH Bench Seat"](#).

4. Release the push pin and remove the seat belt retractor shield.

5. Remove the seat belt retractor upper anchor bolt (A), then remove the seat belt retractor (1).

⇐: Front

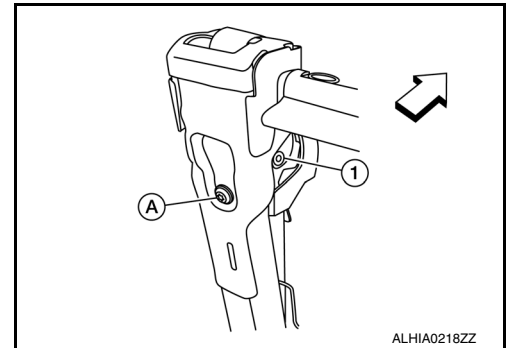

Installation

Installation is in the reverse order of removal.

SEAT BELT BUCKLE - LH BENCH SEAT

Removal

1. Remove the second row LH bench seat. Refer to [SE-33. "Removal and Installation"](#).

2. Remove the seat belt buckle.

- a. For seat belt buckle (center):

- Remove the center seat belt buckle anchor bolt (A) along with the center seat belt retractor anchor.
- Then thread the seat belt buckle (center) through the opening in the seat cushion trim.

⇐: Front

- b. For seat belt buckle (LH):

- Pull back the seat cushion trim enough to expose the seat belt buckle anchor bolt.
- Remove the seat belt buckle anchor bolt and seat belt buckle (LH).

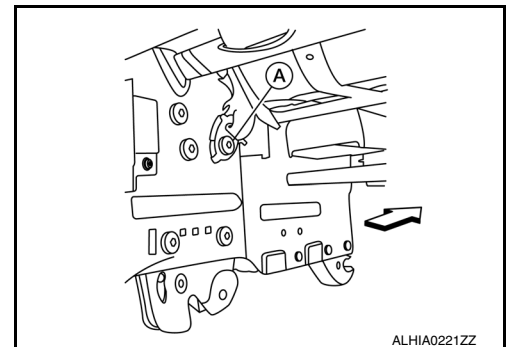

Installation

SECOND ROW SEAT BELT

< REMOVAL AND INSTALLATION >

Installation is in the reverse order of removal.

A

B

C

D

E

F

G

SB

I

J

K

L

M

N

O

P

THIRD ROW SEAT BELT

< REMOVAL AND INSTALLATION >

THIRD ROW SEAT BELT

Removal and Installation

INFOID:000000012521398

EXPLODED VIEW

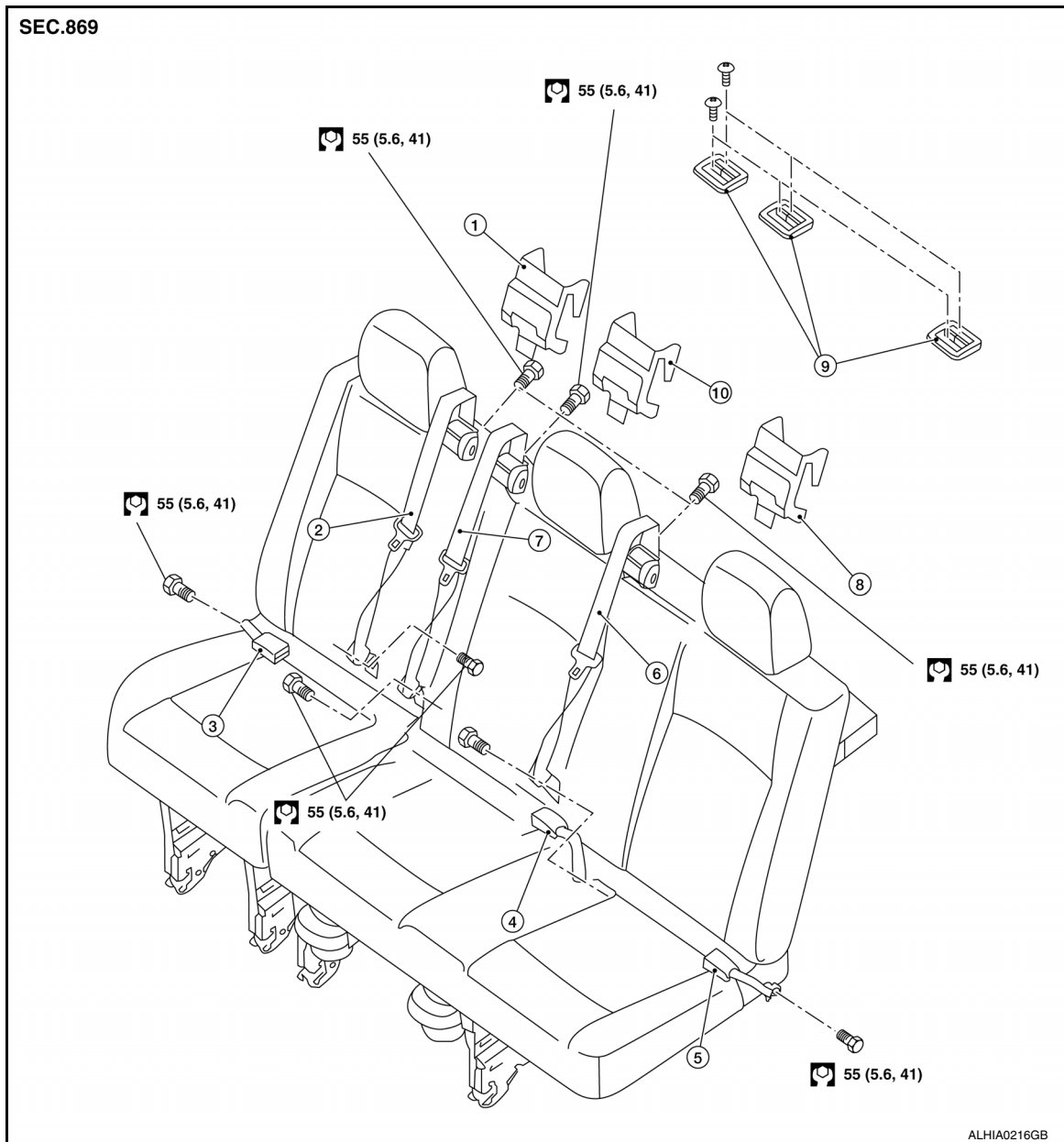

- | | | |
|---|------------------------------------|-----------------------------|
| 1. Seat belt retractor shield (RH) | 2. Seat belt retractor (RH) | 3. Seat belt buckle (RH) |
| 4. Seat belt buckle (center) | 5. Seat belt buckle (LH) | 6. Seat belt retractor (LH) |
| 7. Seat belt retractor (center) | 8. Seat belt retractor shield (LH) | 9. Seat belt escutcheon |
| 10. Seat belt retractor shield (center) | | |

SEAT BELT RETRACTOR - RH SEAT

Removal

1. Remove the third row RH seat. Refer to [SE-36, "Removal and Installation"](#).
2. Remove the seat rear floor latch cover screws, then remove the seat rear floor latch cover from the seat cushion frame. Refer to [SE-60, "Disassembly and Assembly - RH Seat"](#).

THIRD ROW SEAT BELT

< REMOVAL AND INSTALLATION >

3. Remove seat belt retractor lower anchor bolt (A) from the seat belt (1).
⇐: Front
4. Remove the RH seat seatback trim. Refer to [SE-60. "Disassembly and Assembly - RH Seat"](#).
5. Release the push pin and remove the seat belt retractor shield.

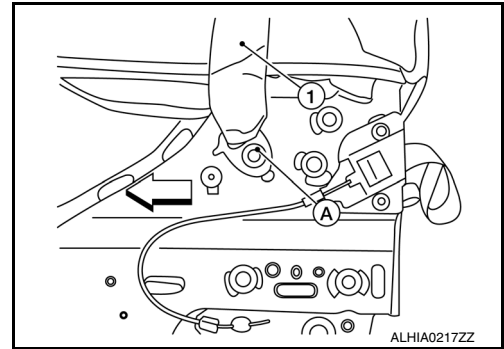

6. Remove the seat belt retractor upper anchor bolt (A), then remove the seat belt retractor (1).
⇐: Front

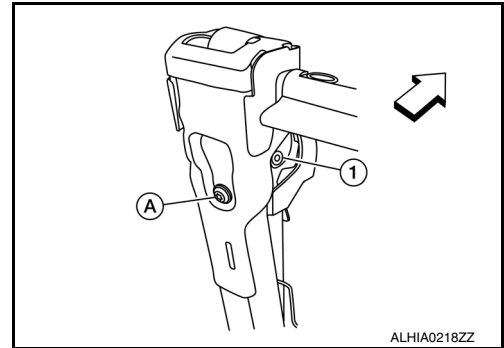

Installation

Installation is in the reverse order of removal.

SEAT BELT BUCKLE - RH SEAT

Removal

1. Pull back the seat cushion trim (1) enough to expose the seat belt buckle anchor bolt (A).
2. Remove seat belt buckle anchor bolt (A), then remove the seat belt buckle.

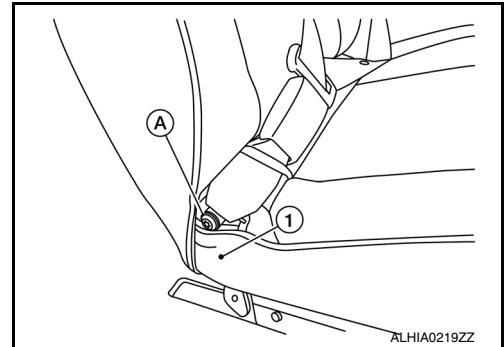

Installation

Installation is in the reverse order of removal.

SEAT BELT RETRACTOR - LH BENCH SEAT

Removal

1. Remove the third row LH bench seat. Refer to [SE-36. "Removal and Installation"](#).
2. Remove seat belt retractor.

A
B
C
D
E
F
G
SB
I
J
K
L
M
N
O
P

THIRD ROW SEAT BELT

< REMOVAL AND INSTALLATION >

- a. For seat belt retractor (LH), remove the lower anchor bolt (A) from the seat belt.

⇐: Front

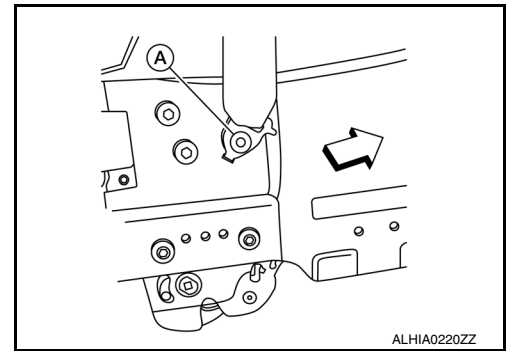

- b. For seat belt retractor (center), remove the lower anchor bolt (A) (along with the seat belt buckle-center), then thread the seat belt through the opening in the seat cushion trim.

⇐: Front

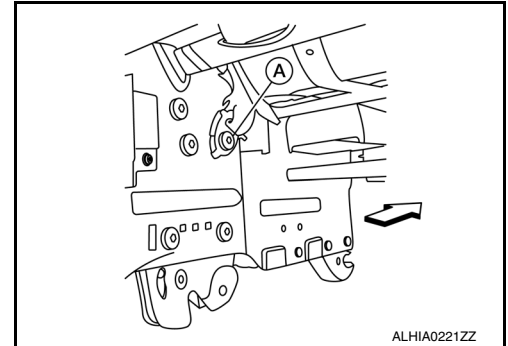

3. Remove the LH bench seat seatback trim, refer to [SE-58, "Disassembly and Assembly - LH Bench Seat"](#).

4. Release the push pin and remove the seat belt retractor shield.

5. Remove the seat belt retractor upper anchor bolt (A), then remove the seat belt retractor (1).

⇐: Front

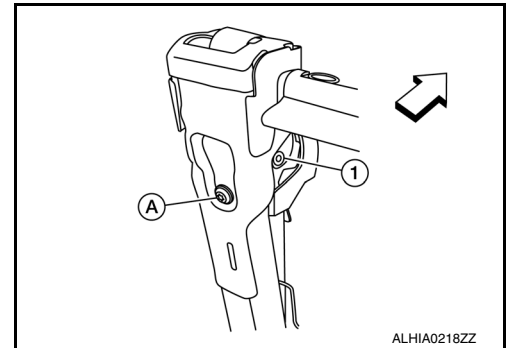

Installation

Installation is in the reverse order of removal.

SEAT BELT BUCKLE - LH BENCH SEAT

Removal

1. Remove the third row LH bench seat. Refer to [SE-36, "Removal and Installation"](#).

2. Remove the seat belt buckle.

- a. For seat belt buckle (center):

- Remove the center seat belt buckle anchor bolt (A) along with the center seat belt retractor anchor.
- Then thread the seat belt buckle (center) through the opening in the seat cushion trim.

⇐: Front

- b. For seat belt buckle (LH):

- Pull back the seat cushion trim enough to expose the seat belt buckle anchor bolt.
- Remove the seat belt buckle anchor bolt and seat belt buckle (LH).

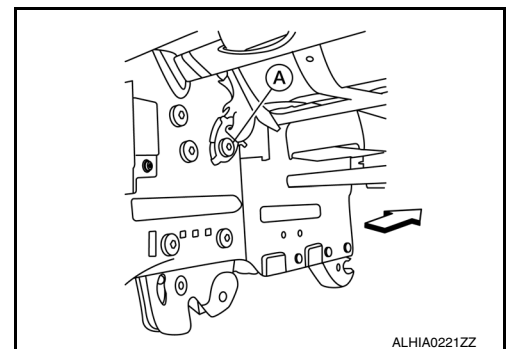

Installation

THIRD ROW SEAT BELT

< REMOVAL AND INSTALLATION >

Installation is in the reverse order of removal.

A

B

C

D

E

F

G

SB

I

J

K

L

M

N

O

P

FOURTH ROW SEAT BELT

< REMOVAL AND INSTALLATION >

FOURTH ROW SEAT BELT

Removal and Installation

INFOID:000000012521399

EXPLODED VIEW

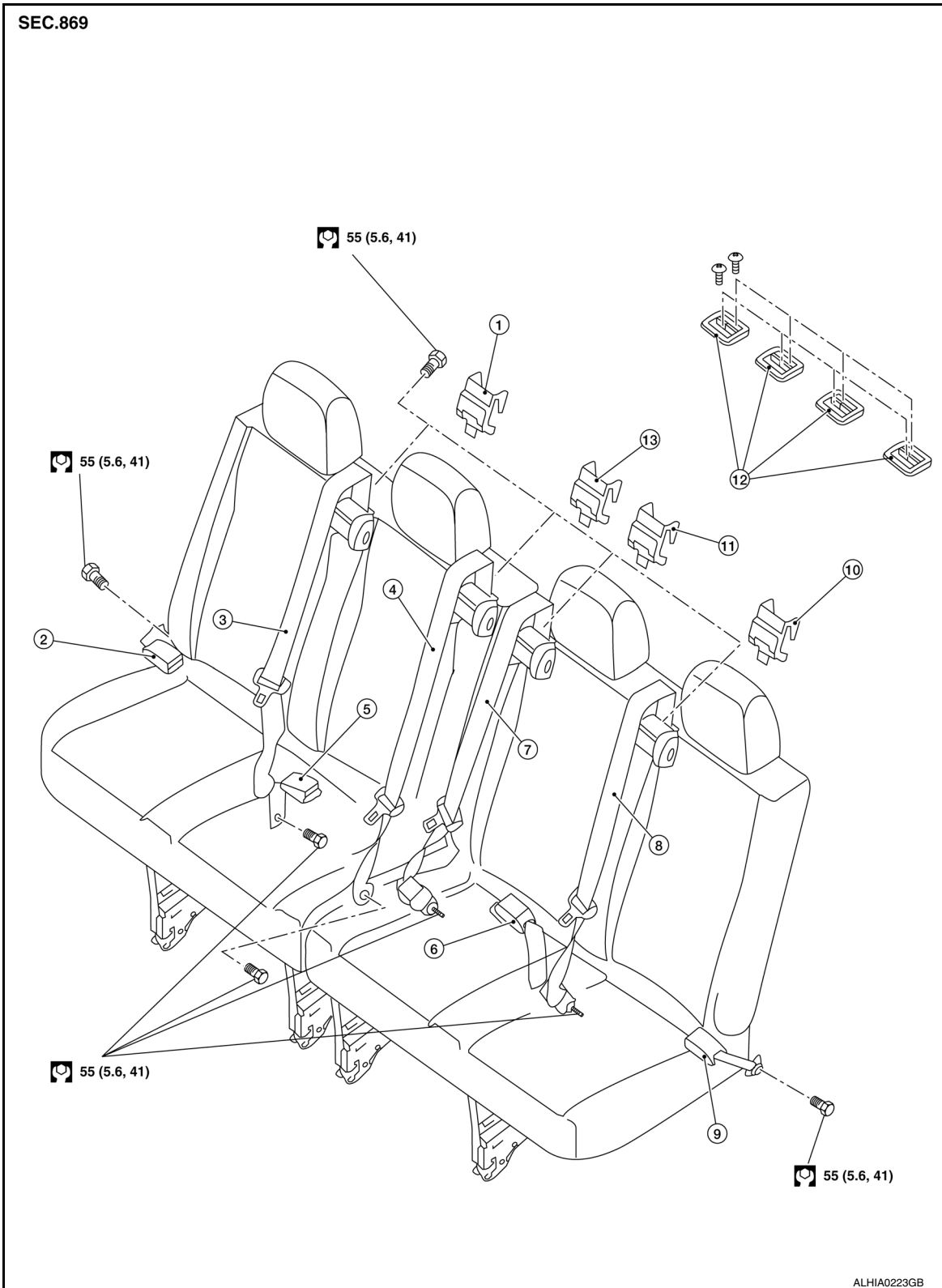

FOURTH ROW SEAT BELT

< REMOVAL AND INSTALLATION >

- | | | | |
|--|--|---------------------------------|---|
| 1. Seat belt retractor shield (RH) | 2. Seat belt buckle (RH) | 3. Seat belt retractor (RH) | A |
| 4. Seat belt retractor (RH center) | 5. Seat belt buckle (RH center) | 6. Seat belt buckle (LH center) | |
| 7. Seat belt retractor (LH center) | 8. Seat belt retractor (LH) | 9. Seat belt buckle (LH) | B |
| 10. Seat belt retractor shield (LH) | 11. Seat belt retractor shield (LH center) | 12. Seat belt escutcheon | |
| 13. Seat belt retractor shield (RH center) | | | C |

SEAT BELT RETRACTOR

Removal

1. Remove the fourth row RH bench seat. Refer to [SE-39, "Removal and Installation"](#).

2. Remove seat belt retractor.

- a. For seat belt retractor (RH), remove the lower anchor bolt (A) from the seat belt (1).

↔: Front

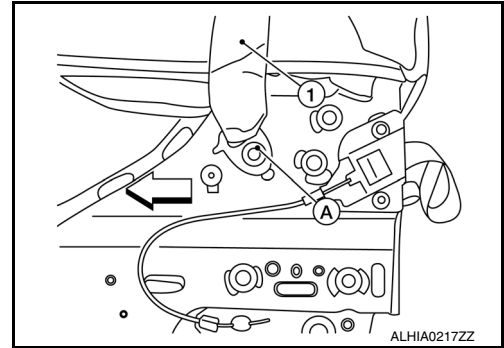

- b. For seat belt retractor (RH center), remove the lower anchor bolt (A) (along with the seat belt buckle-RH center), then thread the seat belt through the opening in the seat cushion trim.

↔: Front

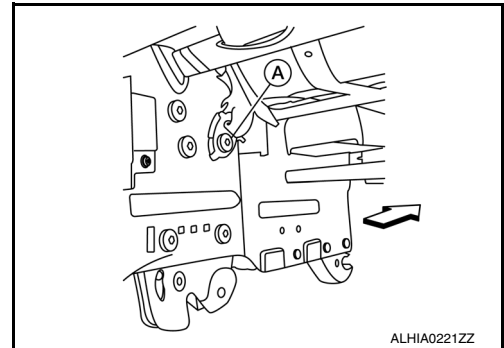

3. Remove the RH bench seat seatback trim. Refer to [SE-76, "Disassembly and Assembly - RH Bench Seat"](#).

4. Release the push pin and remove the seat belt retractor shield.

5. Remove the seat belt retractor upper anchor bolt (A), then remove the seat belt retractor.

↔: Front

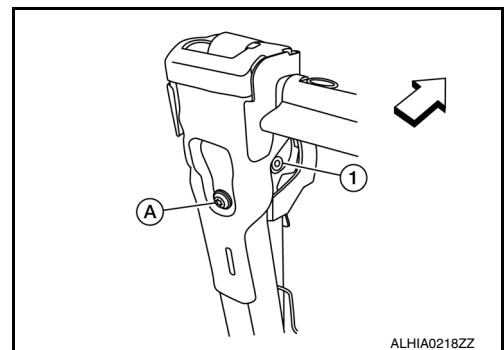

Installation

Installation is in the reverse order of removal.

SEAT BELT BUCKLE

Removal

1. Remove the fourth row RH bench seat. Refer to [SE-39, "Removal and Installation"](#).

2. Remove the seat belt buckle.

FOURTH ROW SEAT BELT

< REMOVAL AND INSTALLATION >

- a. For seat belt buckle (RH center):
 - Remove the center seat belt buckle anchor bolt (A) along with the center seat belt retractor anchor.
 - Then thread the seat belt buckle (RH center) through the opening in the seat cushion trim.

⇐: Front
- b. For seat belt buckle (RH):
 - Pull back the seat cushion trim enough to expose the seat belt buckle anchor bolt.
 - Remove the seat belt buckle anchor bolt and seat belt buckle (RH).

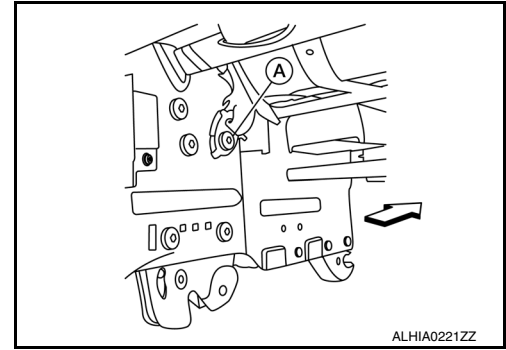

Installation

Installation is in the reverse order of removal.

SEAT BELT RETRACTOR

Removal

1. Remove the fourth row LH bench seat. Refer to [SE-39, "Removal and Installation"](#).
 2. Remove seat belt retractor.
 - a. For seat belt retractor (LH), remove the lower anchor bolt (A) from the seat belt.
- ⇐: Front

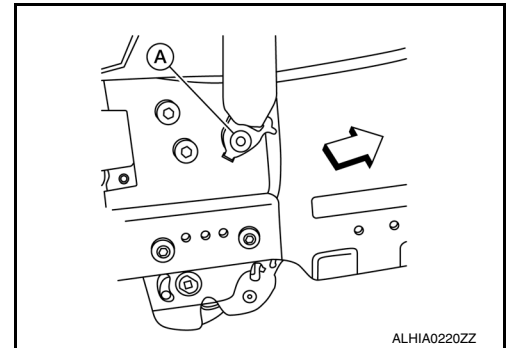

- b. For seat belt retractor (LH center), remove the lower anchor bolt (A) (along with the seat belt buckle-LH center), then thread the seat belt through the opening in the seat cushion trim.
- ⇐: Front

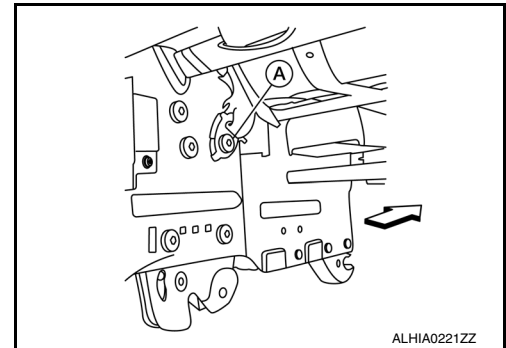

3. Remove the LH bench seat seatback trim. Refer to [SE-74, "Disassembly and Assembly - LH Bench Seat"](#).
 4. Release the push pin and remove the seat belt retractor shield.
 5. Remove the seat belt retractor upper anchor bolt (A), then remove the seat belt retractor (1).
- ⇐: Front

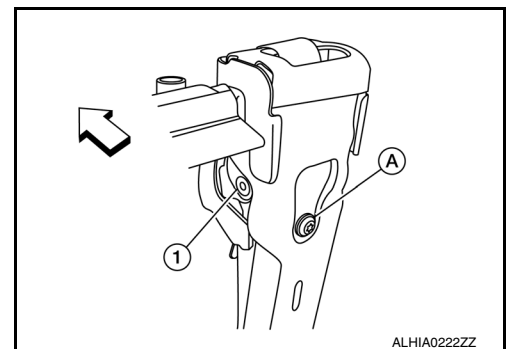

Installation

FOURTH ROW SEAT BELT

< REMOVAL AND INSTALLATION >

Installation is in the reverse order of removal.

SEAT BELT BUCKLE

Removal

1. Remove the fourth row LH bench seat. Refer to [SE-39, "Removal and Installation"](#).
2. Remove the seat belt buckle.
 - a. For seat belt buckle (LH center):
 - Remove the center seat belt buckle anchor bolt (A) along with the center seat belt retractor anchor.
 - Then thread the seat belt buckle (LH center) through the opening in the seat cushion trim.

⇐: Front
 - b. For seat belt buckle (LH):
 - Pull back the seat cushion trim enough to expose the seat belt buckle anchor bolt.
 - Remove the seat belt buckle anchor bolt and seat belt buckle (LH).

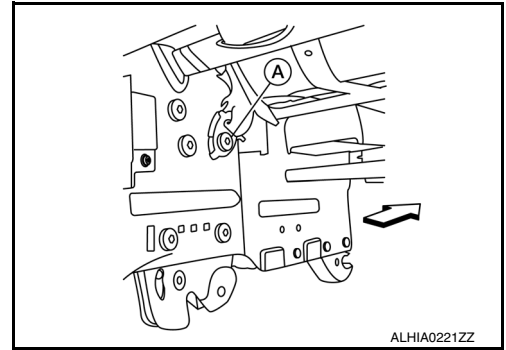

Installation

Installation is in the reverse order of removal.

A

B

C

D

E

F

G

SB

I

J

K

L

M

N

O

P