

A
B
C
D
E
F
G
H
VTL
J
K
L
M
N
O
P

SECTION VTL

VENTILATION SYSTEM

CONTENTS

<p>SYSTEM DESCRIPTION 3</p> <p>SWITCHES AND THEIR CONTROL FUNCTION 3</p> <p style="padding-left: 20px;">System Description3</p> <p>AIR DISTRIBUTION 6</p> <p style="padding-left: 20px;">System Description6</p> <p>PRECAUTION 7</p> <p>PRECAUTIONS 7</p> <p style="padding-left: 20px;">Precaution for Supplemental Restraint System (SRS) "AIR BAG" and "SEAT BELT PRE-TENSIONER"7</p> <p style="padding-left: 20px;">Precaution for Procedure without Cowl Top Cover.....7</p> <p>PREPARATION 8</p> <p>PREPARATION 8</p> <p style="padding-left: 20px;">Commercial Service Tool8</p> <p>PERIODIC MAINTENANCE 9</p> <p>IN-CABIN MICROFILTER 9</p> <p style="padding-left: 20px;">Exploded View9</p> <p style="padding-left: 20px;">Removal and Installation9</p> <p style="padding-left: 20px;">Replacement9</p> <p>REMOVAL AND INSTALLATION10</p> <p>DUCT AND GRILLE10</p> <p style="padding-left: 20px;">Exploded View 10</p> <p>CENTER VENTILATOR GRILLE 11</p> <p style="padding-left: 20px;">CENTER VENTILATOR GRILLE : Removal and Installation 11</p> <p>SIDE VENTILATOR GRILLE 11</p> <p style="padding-left: 20px;">SIDE VENTILATOR GRILLE : Removal and Installation 11</p> <p>FRONT DEFROSTER GRILLE 12</p>	<p style="padding-left: 20px;">FRONT DEFROSTER GRILLE : Removal and Installation12</p> <p>VENTILATOR DUCT12</p> <p style="padding-left: 20px;">VENTILATOR DUCT : Removal and Installation12</p> <p>ADAPTOR DUCT13</p> <p style="padding-left: 20px;">ADAPTOR DUCT : Removal and Installation13</p> <p>DEFROSTER NOZZLE13</p> <p style="padding-left: 20px;">DEFROSTER NOZZLE : Removal and Installation13</p> <p>SIDE DEFROSTER NOZZLE13</p> <p style="padding-left: 20px;">SIDE DEFROSTER NOZZLE : Removal and Installation 13</p> <p>SIDE DEFROSTER DUCT14</p> <p style="padding-left: 20px;">SIDE DEFROSTER DUCT : Removal and Installation 14</p> <p>REAR VENTILATOR GRILLE14</p> <p style="padding-left: 20px;">REAR VENTILATOR GRILLE : Removal and Installation 14</p> <p>REAR VENTILATOR DUCT 114</p> <p style="padding-left: 20px;">REAR VENTILATOR DUCT 1 : Removal and Installation 15</p> <p>REAR VENTILATOR DUCT 215</p> <p style="padding-left: 20px;">REAR VENTILATOR DUCT 2 : Removal and Installation 15</p> <p>FOOT GRILLE15</p> <p style="padding-left: 20px;">FOOT GRILLE : Removal and Installation15</p> <p>FOOT DUCT16</p> <p style="padding-left: 20px;">FOOT DUCT : Removal and Installation 16</p> <p>HEATER DUCT16</p> <p style="padding-left: 20px;">HEATER DUCT : Removal and Installation17</p> <p>REAR FLOOR DUCT 117</p>
--	---

REAR FLOOR DUCT 1 : Removal and Installation		BLOWER UNIT	19
...	17	BLOWER UNIT : Removal and Installation	19
BLOWER UNIT	18	BLOWER MOTOR	20
Exploded View	18	BLOWER MOTOR : Removal and Installation	20

SWITCHES AND THEIR CONTROL FUNCTION

< SYSTEM DESCRIPTION >

SYSTEM DESCRIPTION

SWITCHES AND THEIR CONTROL FUNCTION

System Description

INFOID:000000009059674

SWITCHES AND THEIR CONTROL FUNCTION

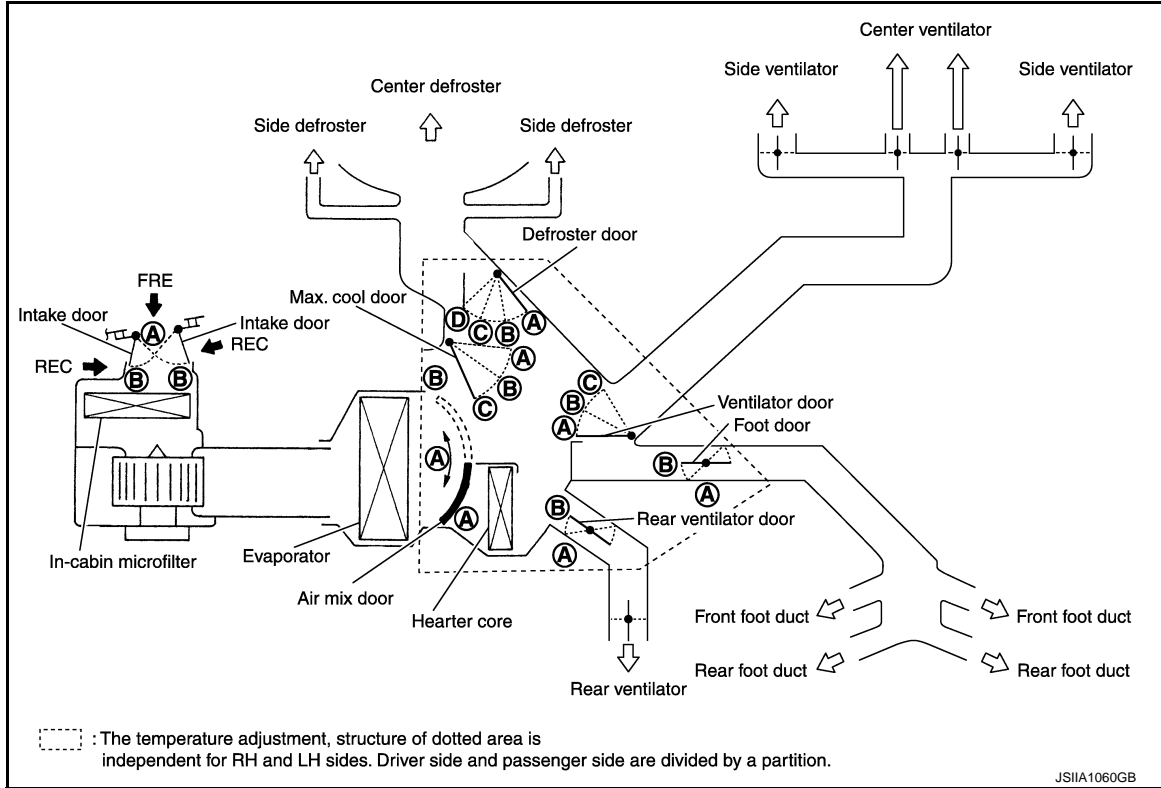

Without ACCS

Switch position		Door position						
		Ventila- tor door	Max. cool door	Defroster door	Foot door	Rear ventila- tor door	Intake door	Air mix door (Driver side)
AUTO switch	☀	AUTO						

SWITCHES AND THEIR CONTROL FUNCTION

< SYSTEM DESCRIPTION >

Switch position			Door position							Air mix door (Driver side)	Air mix door (Passenger side)
			Ventilator door	Max. cool door	Defroster door	Foot door	Rear ventilator door	Intake door			
MODE switch	VENT		A	A	D	B	B	—	—		
	B/L		B	B	D	B	B				
	FOOT		C	C	C	B	B				
	D/F				B	B	B			B	
DEF switch					A	A	A	B	—	—	
Intake switch	FRE								B*		
	REC								A*		
DUAL switch	DUAL									ON	
	OFF									OFF	
Temperature control dial (Driver side)	DUAL switch: OFF	18.0°C (60°F)								A	
		18.5°C ⇄ 31.5°C (61°F ⇄ 89°F)								AUTO	
		32.0°C (90°F)								B	
Temperature control dial (Driver side)	DUAL switch: ON	18.0°C (60°F)	—	—	—	—	—	—	A		
		18.5°C ⇄ 31.5°C (61°F ⇄ 89°F)							AUTO	—	
		32.0°C (90°F)							B		
Temperature control dial (Passenger side)	DUAL switch: ON	18.0°C (60°F)								A	
		18.5°C ⇄ 31.5°C (61°F ⇄ 89°F)							—	AUTO	
		32.0°C (90°F)								B	
OFF switch			C	C	C	B	B	B	—	—	

*: Inlet status is displayed by indicator when activating automatic control

With ACCS

Switch position		Door position							Air mix door (Driver side)	Air mix door (Passenger side)
		Ventilator door	Max. cool door	Defroster door	Foot door	Rear ventilator door	Intake door			
AUTO switch										AUTO

SWITCHES AND THEIR CONTROL FUNCTION

< SYSTEM DESCRIPTION >

Switch position			Door position							
			Ventila- tor door	Max. cool door	Defrost- er door	Foot door	Rear ventila- tor door	Intake door	Air mix door (Driver side)	Air mix door (Passen- ger side)
MODE switch	VENT		A	A	D	B	B	—	—	
	B/L		B	B	D	B	B			
	FOOT		C	C	C	B	B			
	D/F				B	B	B	B		
DEF switch					A	A	A	B	—	
Intake switch	AUTO							AUTO*2	—	
	REC							A*1		
	FRE							B*1		
DUAL switch	DUAL								ON	
	OFF								OFF	
Temperature control dial (Driver side)	DUAL switch: OFF	18.0°C (60°F)	—	—	—	—	—	—	A	
		18.5°C ⇔ 31.5°C (61°F ⇔ 89°F)							AUTO	
		32.0°C (90°F)							B	
Temperature control dial (Driver side)	DUAL switch: ON	18.0°C (60°F)	—	—	—	—	—	—	A	
		18.5°C ⇔ 31.5°C (61°F ⇔ 89°F)							AUTO	
		32.0°C (90°F)							B	
Temperature control dial (Passenger side)	DUAL switch: ON	18.0°C (60°F)	—	—	—	—	—	—	A	
		18.5°C ⇔ 31.5°C (61°F ⇔ 89°F)							—	
		32.0°C (90°F)							B	
OFF switch			C	C	C	B	B	B	—	—

*1: Inlet status is displayed by indicator when activating automatic control

*2: Intake door control applies a exhaust gas / outside odor detecting sensor





AIR DISTRIBUTION

< SYSTEM DESCRIPTION >

AIR DISTRIBUTION

System Description

INFOID:000000009059675

Discharge air flow						
Mode position indication	Condition	Air outlet/distribution				
		VENT		FOOT		DEF
		Front	Rear	Front	Rear	
	DUAL switch: OFF Rear ventilator : OPEN	88%	12%	—	—	—
		49%	10%	25%	16%	—
		10%	12%	33%	22%	23%
		9%	11%	29%	18%	33%
		15%	—	—	—	85%

JSIIA0888GB

PRECAUTIONS

< PRECAUTION >

PRECAUTION

PRECAUTIONS

Precaution for Supplemental Restraint System (SRS) "AIR BAG" and "SEAT BELT PRE-TENSIONER"

INFOID:000000009059676

The Supplemental Restraint System such as "AIR BAG" and "SEAT BELT PRE-TENSIONER", used along with a front seat belt, helps to reduce the risk or severity of injury to the driver and front passenger for certain types of collision. This system includes seat belt switch inputs and dual stage front air bag modules. The SRS system uses the seat belt switches to determine the front air bag deployment, and may only deploy one front air bag, depending on the severity of a collision and whether the front occupants are belted or unbelted. Information necessary to service the system safely is included in the "SRS AIR BAG" and "SEAT BELT" of this Service Manual.

WARNING:

Always observe the following items for preventing accidental activation.

- To avoid rendering the SRS inoperative, which could increase the risk of personal injury or death in the event of a collision that would result in air bag inflation, all maintenance must be performed by an authorized NISSAN/INFINITI dealer.
- Improper maintenance, including incorrect removal and installation of the SRS, can lead to personal injury caused by unintentional activation of the system. For removal of Spiral Cable and Air Bag Module, see "SRS AIR BAG".
- Never use electrical test equipment on any circuit related to the SRS unless instructed to in this Service Manual. SRS wiring harnesses can be identified by yellow and/or orange harnesses or harness connectors.

PRECAUTIONS WHEN USING POWER TOOLS (AIR OR ELECTRIC) AND HAMMERS

WARNING:

Always observe the following items for preventing accidental activation.

- When working near the Air Bag Diagnosis Sensor Unit or other Air Bag System sensors with the ignition ON or engine running, never use air or electric power tools or strike near the sensor(s) with a hammer. Heavy vibration could activate the sensor(s) and deploy the air bag(s), possibly causing serious injury.
- When using air or electric power tools or hammers, always switch the ignition OFF, disconnect the battery, and wait at least 3 minutes before performing any service.

Precaution for Procedure without Cowl Top Cover

INFOID:000000009360305

When performing the procedure after removing cowl top cover, cover the lower end of windshield with urethane, etc to prevent damage to windshield.

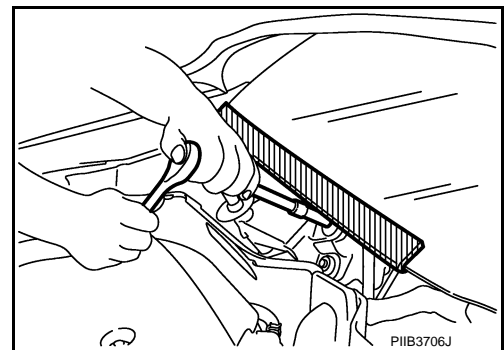

A
B
C
D
E
F
G
H
VTL
J
K
L
M
N
O
P

PREPARATION

< PREPARATION >

PREPARATION

PREPARATION

Commercial Service Tool

INFOID:000000009059678

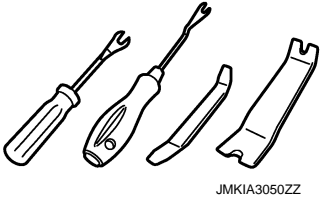
Tool name	Description
Remover tool  JMKIA3050ZZ	Remove clips, pawls and metal clips

IN-CABIN MICROFILTER

< PERIODIC MAINTENANCE >

PERIODIC MAINTENANCE

IN-CABIN MICROFILTER

Exploded View

INFOID:000000009059679

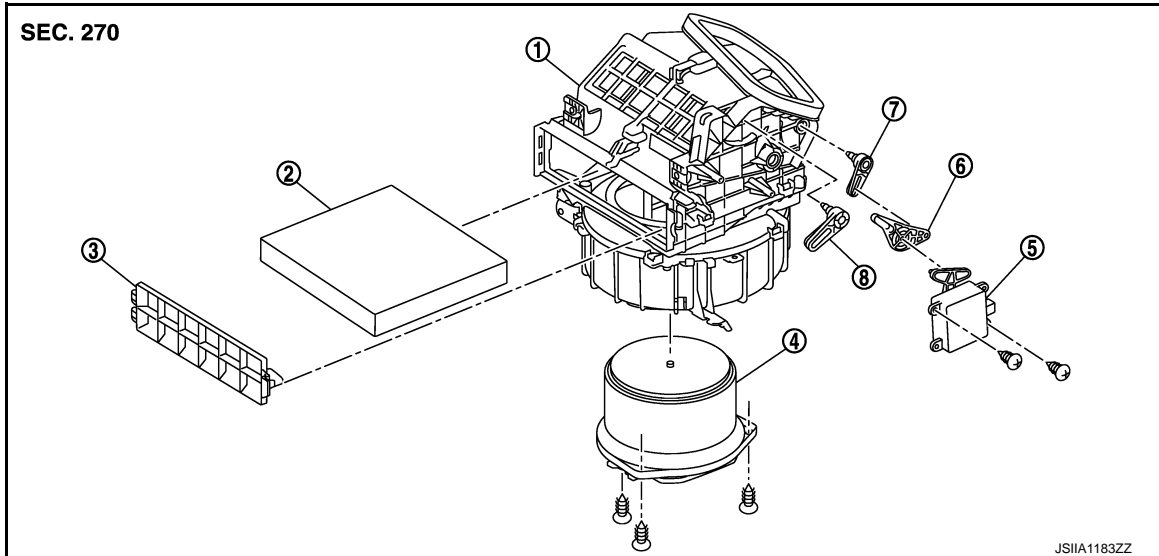

- | | | |
|--------------------------|-------------------------|---------------------|
| 1. Blower unit | 2. In-cabin microfilter | 3. Filter cover |
| 4. Blower motor assembly | 5. Intake door motor | 6. Intake door link |
| 7. Intake door lever 1 | 8. Intake door lever 2 | |

Removal and Installation

INFOID:000000009059680

REMOVAL

1. Remove instrument lower panel RH. Refer to [IP-12. "Exploded View"](#).
2. Remove filter cover (1), and then remove in-cabin microfilter (2).

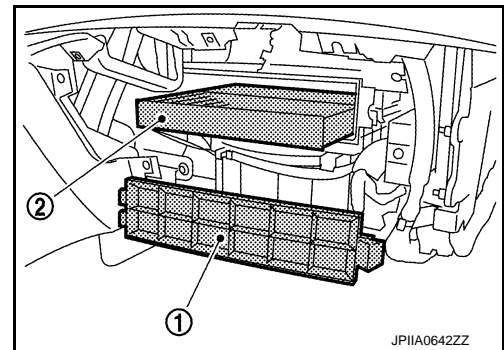

INSTALLATION

Note the following items, and then install in the reverse order of removal.

CAUTION:

- If the filter is deformed/damaged when removing, replace it with a new one. Deformed/damaged filter may deteriorate the duct collecting performance.
- When installing, handle the filter with extreme care to avoid deforming/damaging.

Replacement

INFOID:000000009059681

Replace in-cabin microfilter.

Refer to [MA-6. "Introduction of Periodic Maintenance"](#).

Affix a caution label inside the glove box when replacing filter.

A
B
C
D
E
F
G
H

VTL

J
K
L
M
N

O
P

DUCT AND GRILLE

< REMOVAL AND INSTALLATION >

REMOVAL AND INSTALLATION

DUCT AND GRILLE

Exploded View

INFOID:000000009059682

FRONT

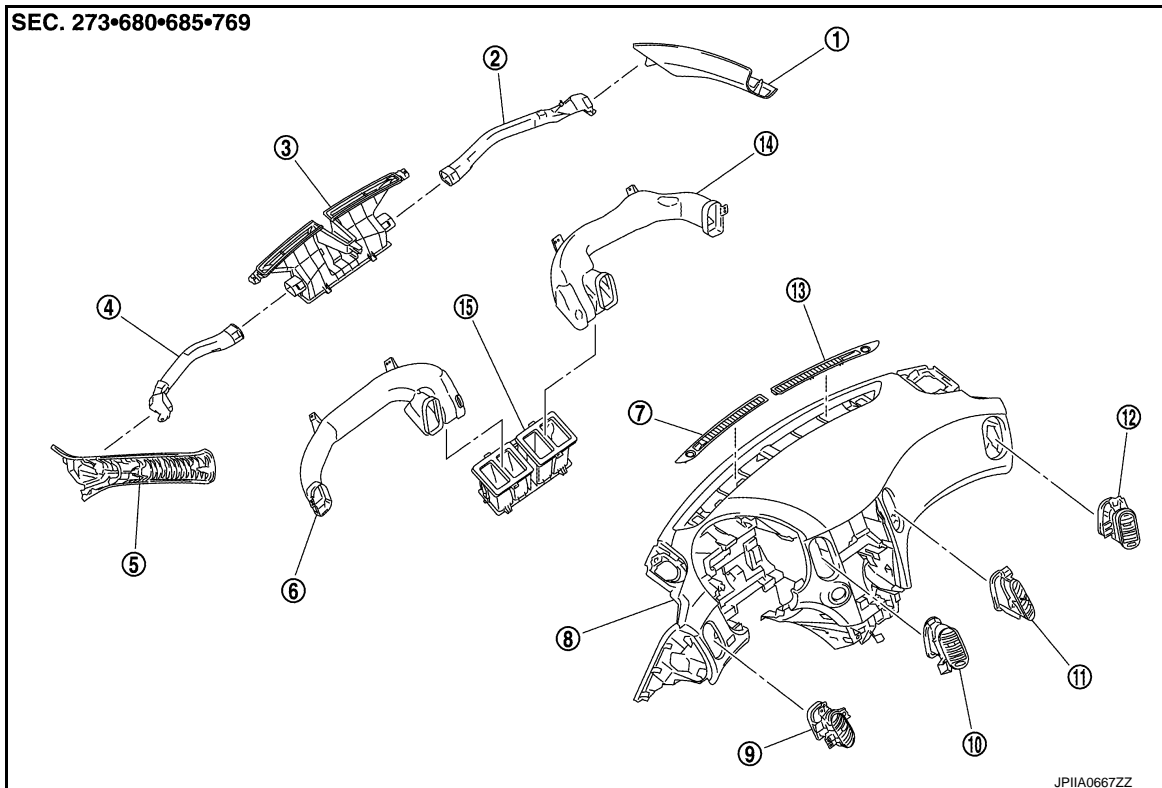

- | | | |
|--|--|-------------------------------|
| 1. Side defroster duct RH
(Front pillar garnish RH) | 2. Side defroster nozzle RH | 3. Defroster nozzle |
| 4. Side defroster nozzle LH | 5. Side defroster duct LH
(Front pillar garnish LH) | 6. Ventilator duct LH |
| 7. Front defroster grille LH | 8. Instrument panel assembly | 9. Side ventilator grille LH |
| 10. Center ventilator grille LH | 11. Center ventilator grille RH | 12. Side ventilator grille RH |
| 13. Front defroster grille RH | 14. Ventilator duct RH | 15. Adaptor duct |

REAR

DUCT AND GRILLE

< REMOVAL AND INSTALLATION >

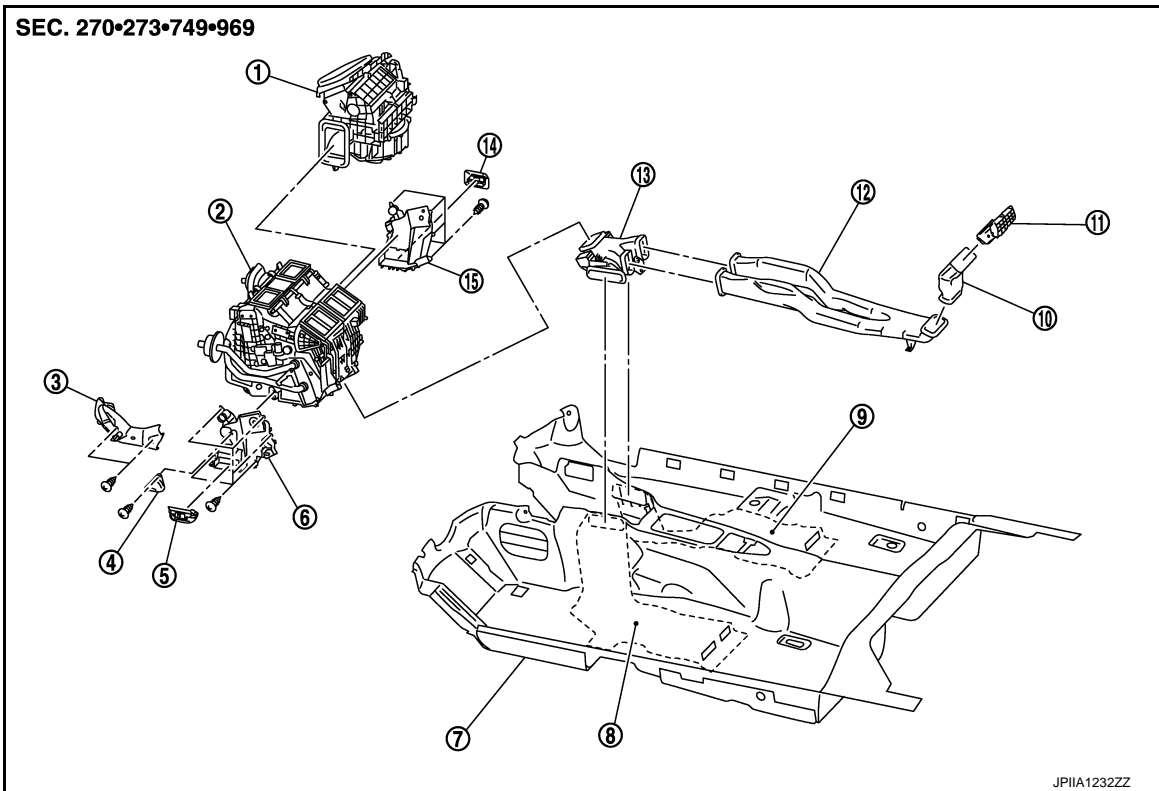

- | | | |
|----------------------------|-----------------------------------|----------------------------|
| 1. Blower unit | 2. Heater & cooling unit assembly | 3. Heater pipe cover |
| 4. Heater duct | 5. Foot grille LH | 6. Foot duct LH |
| 7. Floor carpet | 8. Rear floor duct 2 LH | 9. Rear floor duct 2 RH |
| 10. Rear ventilator duct 2 | 11. Rear ventilator grille | 12. Rear ventilator duct 1 |
| 13. Rear floor duct 1 | 14. Foot grille RH | 15. Foot duct RH |

CENTER VENTILATOR GRILLE

CENTER VENTILATOR GRILLE : Removal and Installation

INFOID:000000009059683

REMOVAL

1. Remove instrument panel assembly. Refer to [IP-12. "Exploded View"](#).
2. Remove fixing screws (A), and then remove center ventilator grille (1).

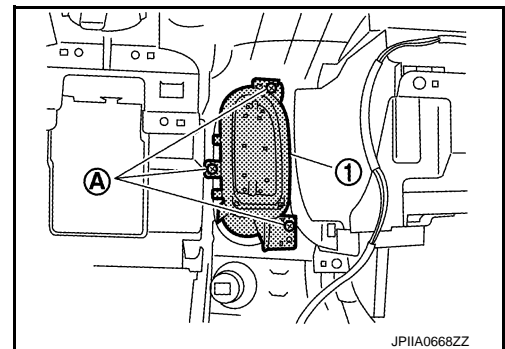

INSTALLATION

Install in the reverse order of removal.

SIDE VENTILATOR GRILLE

SIDE VENTILATOR GRILLE : Removal and Installation

INFOID:000000009059684

REMOVAL

A
B
C
D
E
F
G
H
VTL
J
K
L
M
N
O
P

DUCT AND GRILLE

< REMOVAL AND INSTALLATION >

1. Remove instrument panel assembly. Refer to [IP-12. "Exploded View"](#).
2. Remove fixing screws (A), and then remove side ventilator grille (1).

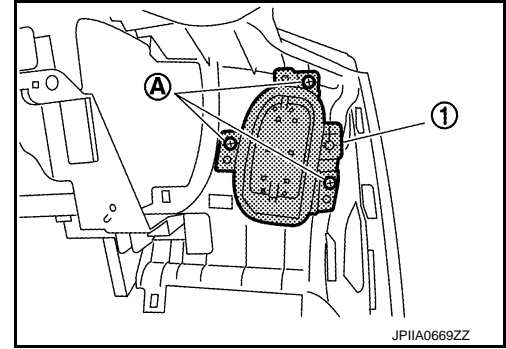

INSTALLATION

Install in the reverse order of removal.

FRONT DEFROSTER GRILLE

FRONT DEFROSTER GRILLE : Removal and Installation

INFOID:000000009059685

REMOVAL

Remove front defroster grilles (1), using a remover tool (A).

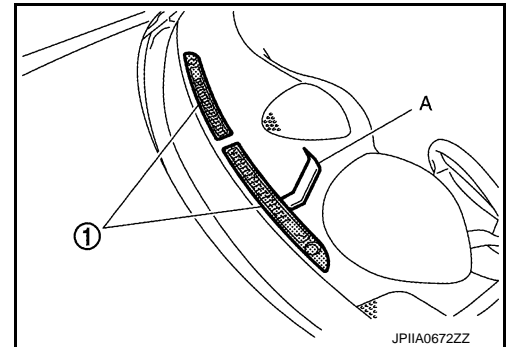

INSTALLATION

Install in the reverse order of removal.

VENTILATOR DUCT

VENTILATOR DUCT : Removal and Installation

INFOID:000000009059686

REMOVAL

1. Remove instrument panel assembly. Refer to [IP-12. "Exploded View"](#).
2. Remove fixing screws (A), and then remove ventilator duct LH (1) and RH (2).

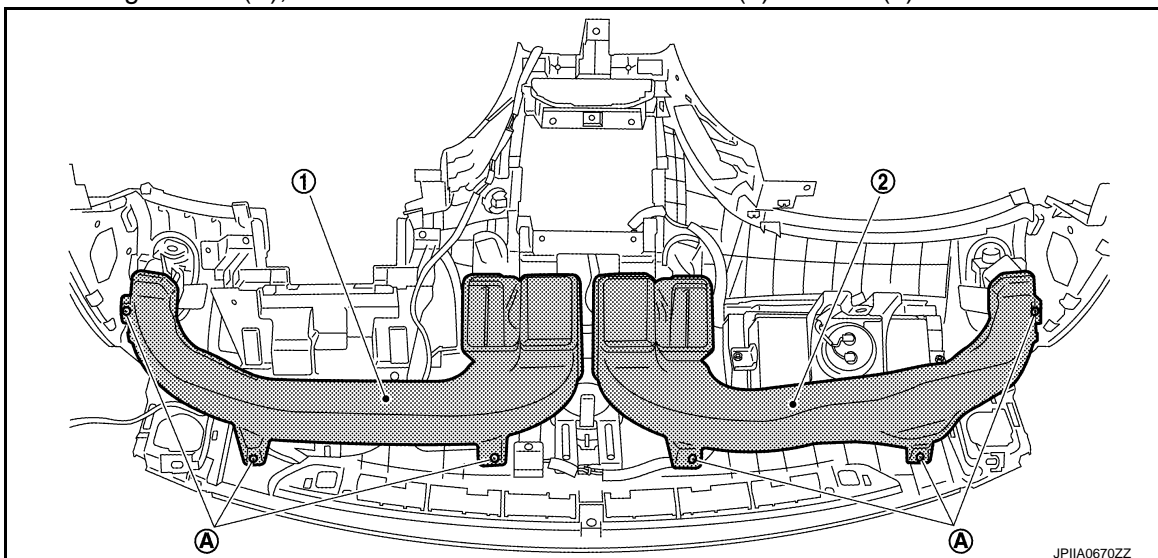

DUCT AND GRILLE

< REMOVAL AND INSTALLATION >

INSTALLATION

Install in the reverse order of removal.

ADAPTOR DUCT

ADAPTOR DUCT : Removal and Installation

INFOID:000000009059687

REMOVAL

1. Remove instrument panel assembly. Refer to [IP-12, "Exploded View"](#).
2. Remove fixing screw (A), and then remove adaptor duct (1).

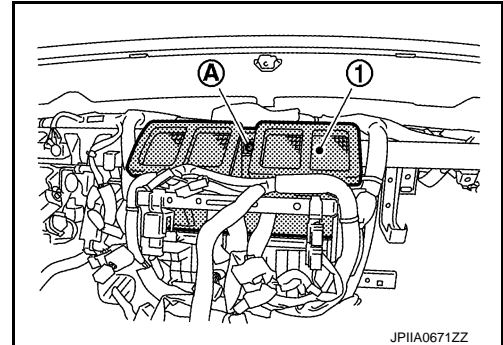

INSTALLATION

Install in the reverse order of removal.

DEFROSTER NOZZLE

DEFROSTER NOZZLE : Removal and Installation

INFOID:000000009059688

REMOVAL

1. Remove side defroster nozzles. Refer to [VTL-10, "Exploded View"](#).
2. Remove defroster nozzle (1).

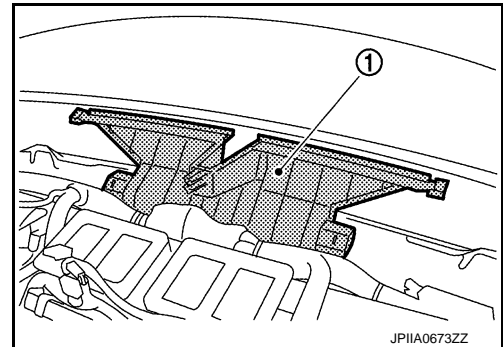

INSTALLATION

Install in the reverse order of removal.

SIDE DEFROSTER NOZZLE

SIDE DEFROSTER NOZZLE : Removal and Installation

INFOID:000000009059689

REMOVAL

Driver Side

1. Remove instrument panel assembly. Refer to [IP-12, "Exploded View"](#).

A
B
C
D
E
F
G
H
VTL
J
K
L
M
N
O
P

DUCT AND GRILLE

< REMOVAL AND INSTALLATION >

2. Remove fixing clip (A), and then remove side defroster nozzle LH (1).

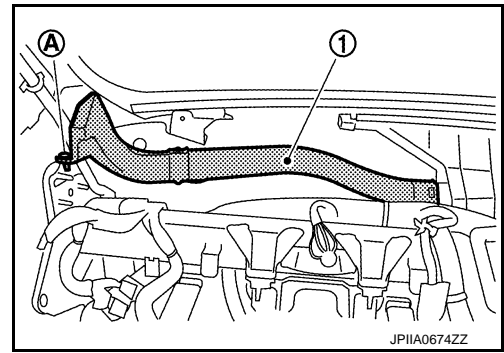

Passenger Side

- Remove fixing clip (A) and harness clip (B), and then remove side defroster nozzle RH (1).

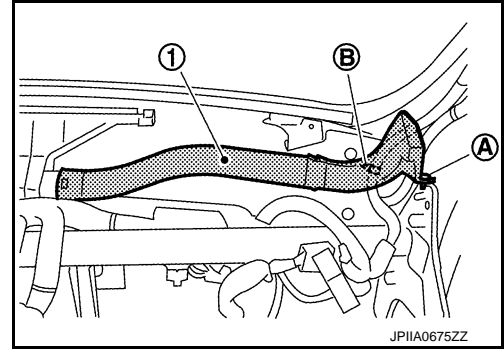

INSTALLATION

Install in the reverse order of removal.

SIDE DEFROSTER DUCT

SIDE DEFROSTER DUCT : Removal and Installation

INFOID:000000009059690

REMOVAL

Remove front pillar garnish. Refer to [INT-20. "Exploded View"](#).

INSTALLATION

Install in the reverse order of removal.

REAR VENTILATOR GRILLE

REAR VENTILATOR GRILLE : Removal and Installation

INFOID:000000009059691

REMOVAL

1. Remove console rear finisher. Refer to [IP-22. "Exploded View"](#).
2. Disengage fixing pawls, and then remove rear ventilator grille (1).

 Pawl

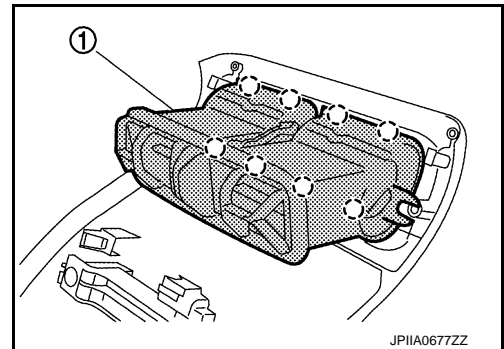

INSTALLATION

Install in the reverse order of removal.

REAR VENTILATOR DUCT 1

DUCT AND GRILLE

< REMOVAL AND INSTALLATION >

REAR VENTILATOR DUCT 1 : Removal and Installation

INFOID:000000009059692

REMOVAL

1. Remove center console assembly. Refer to [IP-22, "Exploded View"](#).
2. Remove fixing screws (A), and then remove rear ventilator duct 1 (1).

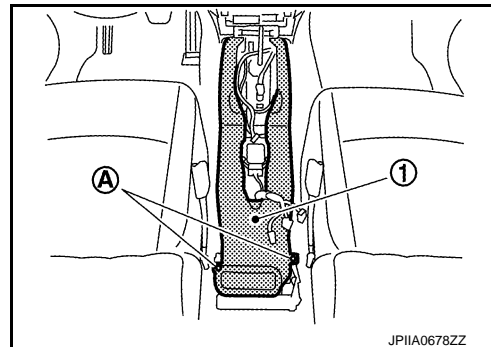

INSTALLATION

Install in the reverse order of removal.

REAR VENTILATOR DUCT 2

REAR VENTILATOR DUCT 2 : Removal and Installation

INFOID:000000009059693

REMOVAL

1. Remove console rear finisher. Refer to [IP-12, "Exploded View"](#).
2. Remove rear ventilator duct 2 (1).

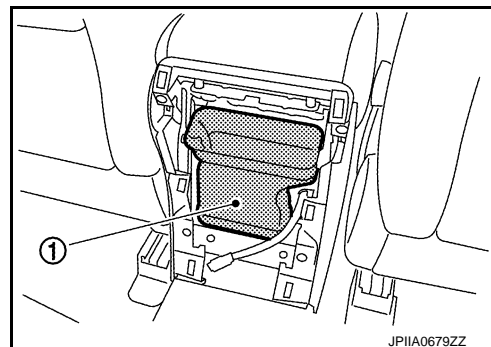

INSTALLATION

Install in the reverse order of removal.

FOOT GRILLE

FOOT GRILLE : Removal and Installation

INFOID:000000009059694

REMOVAL

Driver Side

Disengage fixing pawls, and then remove foot grille LH (1).

 Pawl

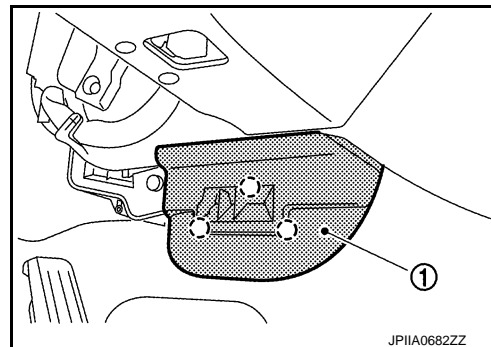

Passenger Side

A
B
C
D
E
F
G
H
VTL
J
K
L
M
N
O
P

DUCT AND GRILLE

< REMOVAL AND INSTALLATION >

Disengage fixing pawls, and then remove foot grille RH (1).

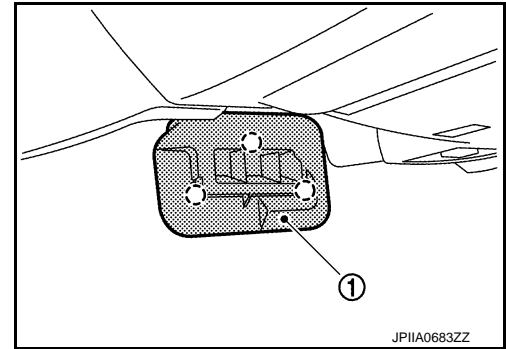

INSTALLATION

Install in the reverse order of removal.

FOOT DUCT

FOOT DUCT : Removal and Installation

INFOID:000000009059695

REMOVAL

Driver Side

1. Remove fixing screws (A), and then remove heater pipe cover (1).
2. Remove fixing screws (B), and then remove foot duct LH (2).

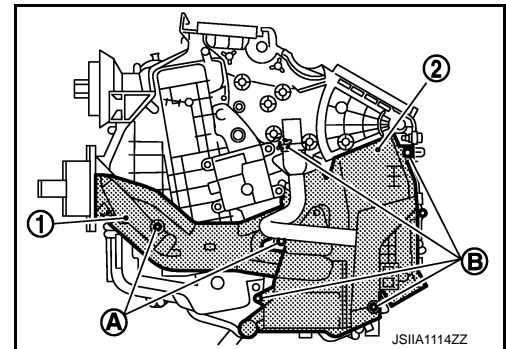

Passenger Side

1. Set the temperature at 18°C (64°F).

CAUTION:

The angle may be out, when installing the air mix door motor to the air mix door, unless the above procedure is performed.

2. Disconnect the battery cable from the negative terminal.
3. Remove heater & cooling unit assembly. Refer to [HA-51, "Exploded View"](#).
4. Remove air mix door motor. Refer to [HAC-132, "Exploded View"](#).
5. Remove mode door motor and links. Refer to [HAC-132, "Exploded View"](#).
6. Remove fixing screws (A), and then remove evaporator cover (1).
7. Remove fixing screws (B), and then remove foot duct RH (2).

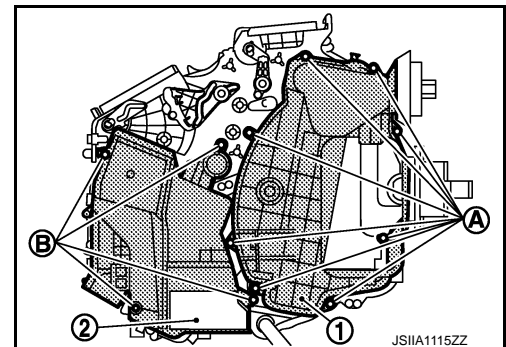

INSTALLATION

Install in the reverse order of removal.

HEATER DUCT

DUCT AND GRILLE

< REMOVAL AND INSTALLATION >

HEATER DUCT : Removal and Installation

INFOID:000000009059696

REMOVAL

1. Remove instrument lower panel LH. Refer to [IP-12, "Exploded View"](#).
2. Remove fixing screw, and then remove heater duct.

INSTALLATION

Install in the reverse order of removal.

REAR FLOOR DUCT 1

REAR FLOOR DUCT 1 : Removal and Installation

INFOID:000000009059697

REMOVAL

1. Remove instrument panel assembly. Refer to [IP-12, "Exploded View"](#).
2. Remove fixing clips (A), and then remove rear floor duct 1 (1).

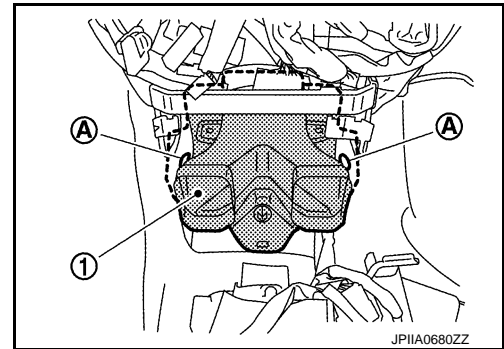

INSTALLATION

Install in the reverse order of removal.

A
B
C
D
E
F
G
H
J
K
L
M
N
O
P

VTL

BLOWER UNIT

< REMOVAL AND INSTALLATION >

BLOWER UNIT

Exploded View

INFOID:000000009059698

REMOVAL

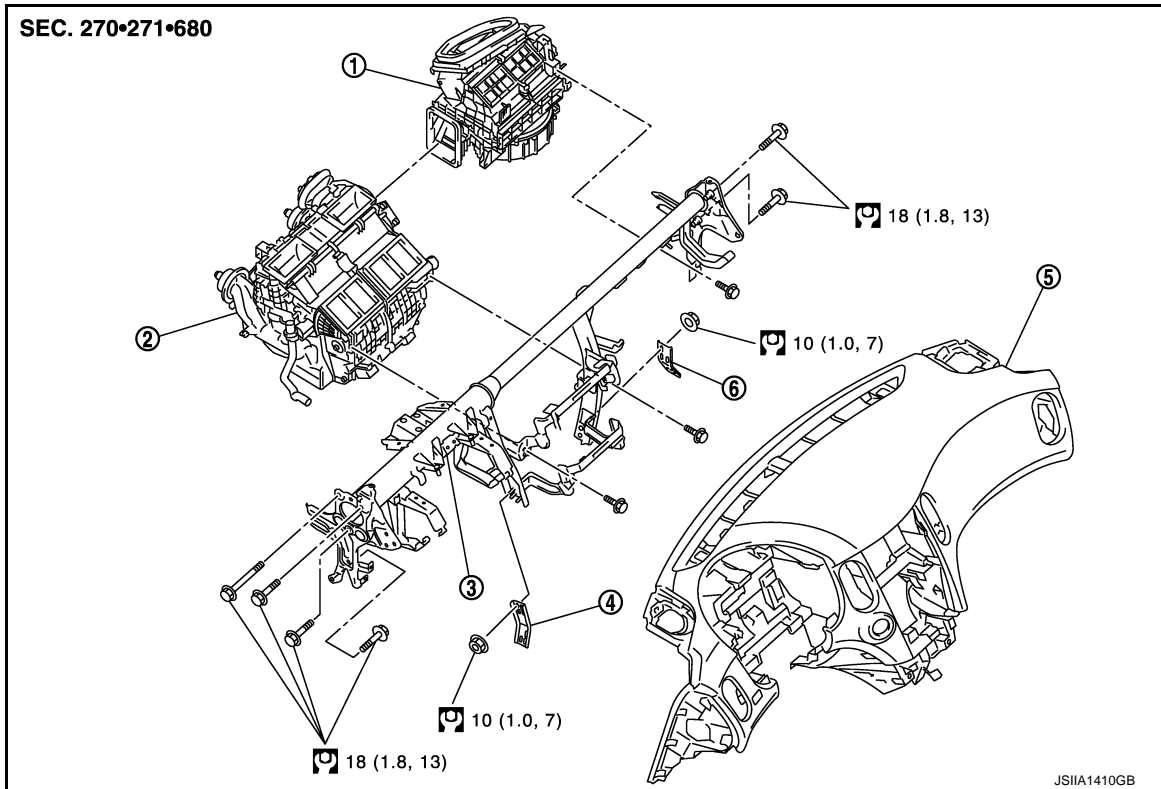

- 1. Blower unit
- 4. Instrument stay LH

- 2. Heater & cooling unit assembly
- 5. Instrument panel assembly

- 3. Steering member
- 6. Instrument stay RH

 : N·m (kg-m, ft-lb)

DISASSEMBLY

BLOWER UNIT

< REMOVAL AND INSTALLATION >

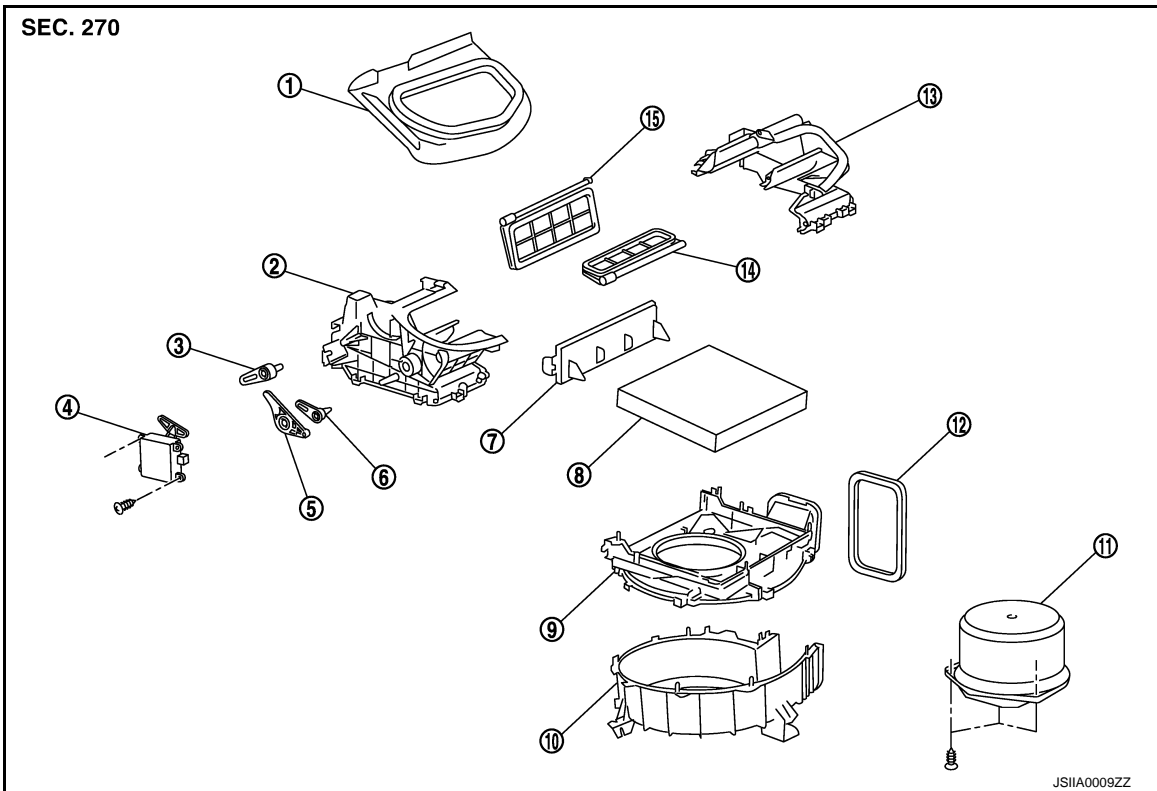

- | | | |
|-----------------------|---------------------------|------------------------|
| 1. Adapter | 2. Intake box RH | 3. Intake door lever 2 |
| 4. Intake door motor | 5. Intake door link | 6. Intake door lever 1 |
| 7. Filter cover | 8. In-cabin microfilter | 9. Intake upper case |
| 10. Intake lower case | 11. Blower motor assembly | 12. Seal |
| 13. Intake box LH | 14. Intake door 1 | 15. Intake door 2 |

BLOWER UNIT

BLOWER UNIT : Removal and Installation

INFOID:000000009059699

REMOVAL

1. Remove instrument lower panel RH. Refer to [IP-12. "Exploded View"](#).
2. Disconnect AWD control unit connector (AWD). Refer to [DLN-57. "Removal and Installation"](#).
3. Disconnect ECM (1) connectors.
4. Remove mounting nuts (A), and then remove ECM with bracket attached.
5. Remove power steering control unit. Refer to [STC-21. "Exploded View"](#).

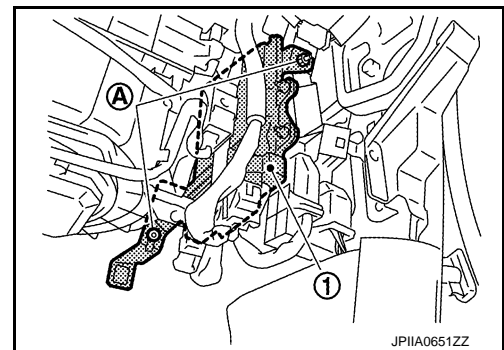

6. Disconnect intake door motor connector and blower motor connector.

BLOWER UNIT

< REMOVAL AND INSTALLATION >

7. Remove mounting bolt (A) and fixing screw (B), and then remove blower unit (1).

CAUTION:

Move blower unit rightward, and remove locating pin (1 part) and joint. Then remove blower unit downward.

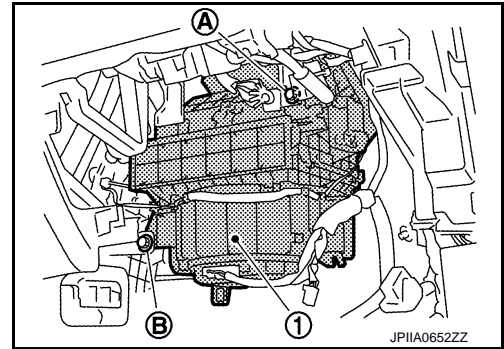

INSTALLATION

Note the following item, and then install in the reverse order of removal.

CAUTION:

Make sure locating pin (A) and joint (B) are securely inserted.

←: Vehicle front

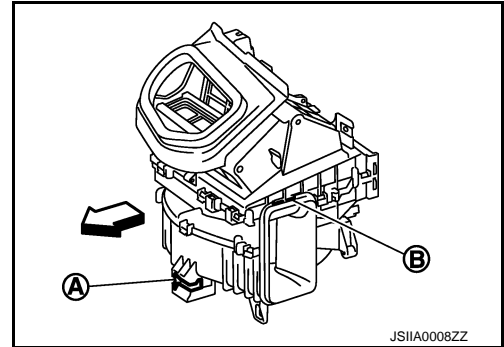

BLOWER MOTOR

BLOWER MOTOR : Removal and Installation

INFOID:000000009059700

REMOVAL

1. Remove instrument lower cover. Refer to [IP-12. "Exploded View"](#).
2. Disconnect blower motor connector.
3. Remove fixing screws (A), and then remove blower motor (1).

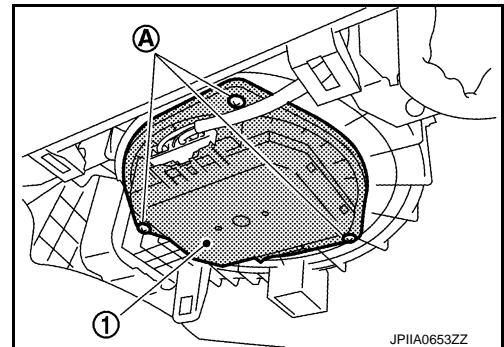

INSTALLATION

Install in the reverse order of removal.