

SECTION **EX**
EXHAUST SYSTEM

A
EX

CONTENTS

PRECAUTION	2	PERIODIC MAINTENANCE	4	F
PRECAUTIONS	2	EXHAUST SYSTEM	4	G
Removal and Installation	2	Inspection	4	
PREPARATION	3	REMOVAL AND INSTALLATION	5	
PREPARATION	3	EXHAUST SYSTEM	5	H
Special Service Tool	3	Exploded View	5	
Commercial Service Tool	3	Removal and Installation	5	
		Inspection	6	I
				J
				K
				L
				M
				N
				O
				P

PRECAUTIONS

< PRECAUTION >

PRECAUTION

PRECAUTIONS

Removal and Installation

INFOID:000000006289691

CAUTION:

- Be sure to use genuine exhaust system parts or equivalents which are specially designed for heat resistance, corrosion resistance, and shape.
- Perform the operation with the exhaust system fully cooled down because the system will be hot just after engine stops.
- Be careful not to cut your hand on the heat insulator edge.

PREPARATION

< PREPARATION >

PREPARATION

PREPARATION

Special Service Tool

INFOID:000000006289692

A

EX

Tool number (Kent-Moore No.) Tool name	Description
KV10114400 (J-38365) Heated oxygen sensor wrench	Loosening or tightening heated oxygen sensor 2 For 22 mm (0.87 in) (a) width hexagon nut

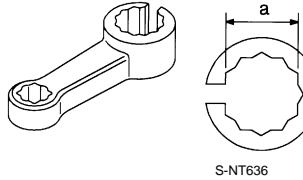

C

D

E

Commercial Service Tool

INFOID:000000006289693

Tool name	Description
Power tool	Loosening bolts and nuts

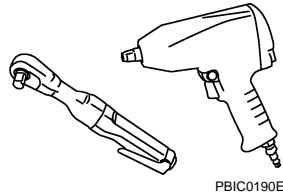

F

G

H

I

J

K

L

M

N

O

P

EXHAUST SYSTEM

< PERIODIC MAINTENANCE >

PERIODIC MAINTENANCE

EXHAUST SYSTEM

Inspection

INFOID:000000006289694

Check exhaust pipes, muffler and mounting for improper attachment, leakage, cracks, damage or deterioration.

- If damage is found, repair or replace damaged parts.

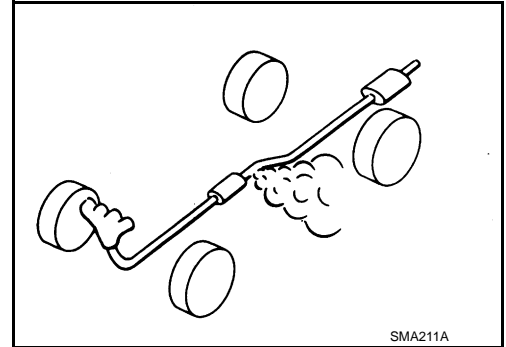

SMA211A

EXHAUST SYSTEM

< REMOVAL AND INSTALLATION >

REMOVAL AND INSTALLATION

EXHAUST SYSTEM

Exploded View

INFOID:000000006289695

A

EX

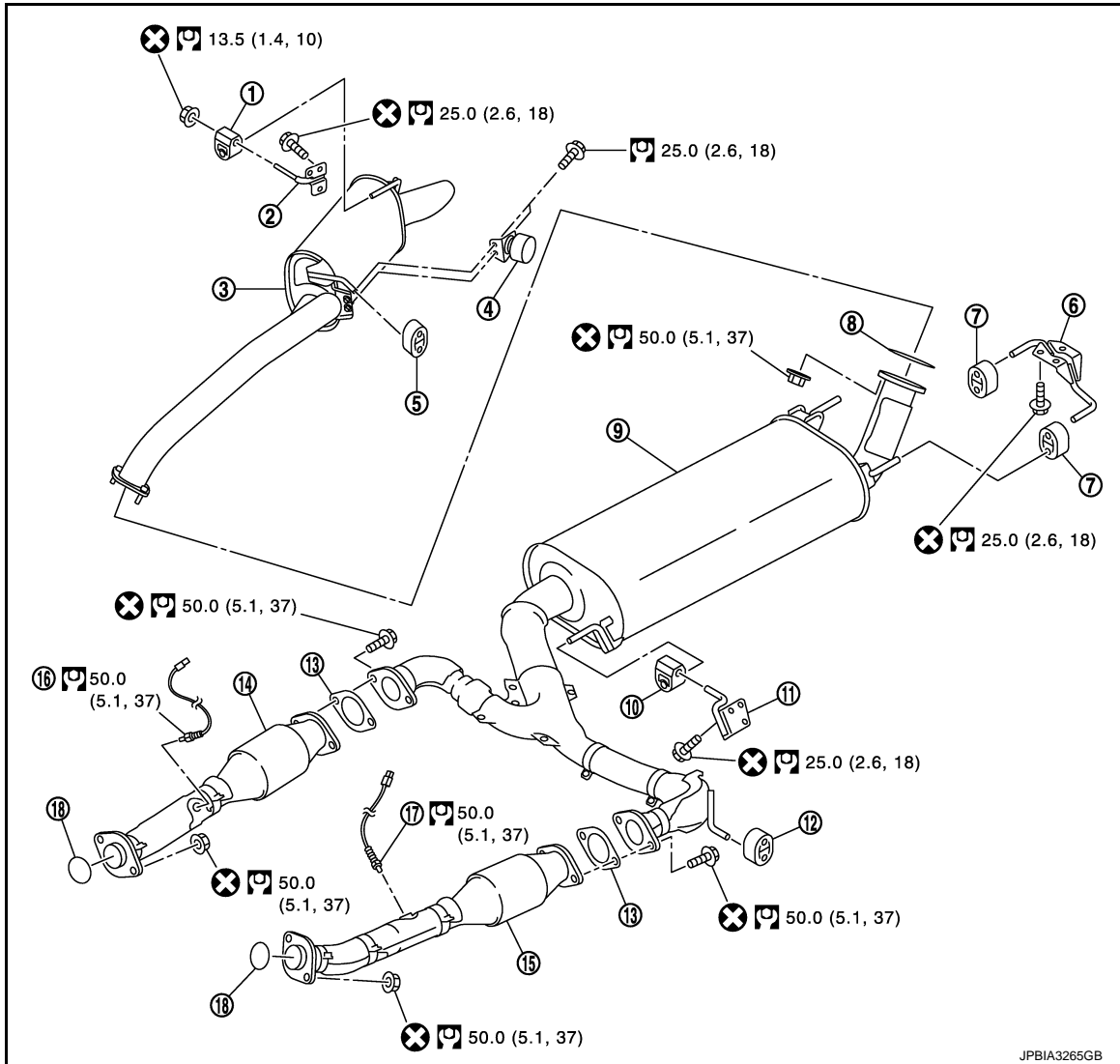

C

D

E

F

G

H

I

J

K

L

M

- | | | |
|-------------------------------------|-------------------------------------|-----------------------------|
| 1. Mounting rubber | 2. Mounting bracket | 3. Rear muffler |
| 4. Dynamic damper | 5. Mounting rubber | 6. Mounting bracket |
| 7. Mounting rubber | 8. Gasket | 9. Main muffler |
| 10. Mounting rubber | 11. Mounting bracket | 12. Mounting rubber |
| 13. Gasket | 14. Exhaust front tube (RH) | 15. Exhaust front tube (LH) |
| 16. Heated oxygen sensor 2 (bank 2) | 17. Heated oxygen sensor 2 (bank 1) | 18. Ring gasket |

Refer to [GI-4. "Components"](#) for symbols in the figure.

Removal and Installation

INFOID:000000006289696

REMOVAL

- Disconnect each joint and mounting using power tool.
- Remove heated oxygen sensor 2, as follows:.

N

O

P

EXHAUST SYSTEM

< REMOVAL AND INSTALLATION >

- Using heated oxygen sensor wrench [SST: KV10114400] (C), removal heated oxygen sensor 2.

- A : Bank 1
- B : Bank 2
- ⇐ : Vehicle front

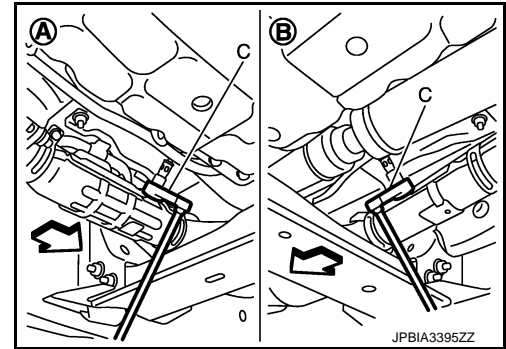

INSTALLATION

Note the following items, and install in the reverse order of removal.

- Temporarily tighten bolts and nuts when installing exhaust pipe assembly. Tighten them to the specified torque when connecting the vehicle rear to the vehicle front.

CAUTION:

- **Always replace exhaust tube gaskets with new ones when reassembling.**
- **If heat insulator is badly deformed, repair or replace it. If deposits such as mud pile up on the heat insulator, remove them.**
- **When installing heat insulator avoid large gaps or interference between heat insulator and each exhaust pipe.**
- **Remove deposits from the sealing surface of each connection. Connect them securely to avoid gases leakage.**
- **Check each part for unusual interference, and then tighten them to the specified torque.**
- **When installing each mounting rubber, avoid twisting or unusual extension in up/down and right/left directions.**

Inspection

INFOID:000000006289697

INSPECTION AFTER INSTALLATION

- Check clearance between tail tube and rear bumper is even.
- With engine running, check exhaust tube joints for gas leakage and unusual noises.
- Check to ensure that mounting brackets and mounting rubbers are installed properly and free from undue stress. Improper installation could result in excessive noise and vibration.