

ACCELERATOR CONTROL, FUEL & EXHAUST SYSTEMS

SECTION FE

CONTENTS

PREPARATION	2	FUEL SYSTEM	4	AT
Special Service Tool	2	Removal and Installation	4	
Commercial Service Tool	2	FUEL TANK	5	AX
ACCELERATOR CONTROL SYSTEM	3	FUEL PUMP AND GAUGE	6	
Removal and Installation	3	EXHAUST SYSTEM	8	
Adjusting Accelerator Wire	3	Removal and Installation	8	SU

GI
MA
EM
LC
EC
FE
AT
AX
SU
BR
ST
RS
BT
HA
SC
EL
IDX

PREPARATION

Special Service Tool

Special Service Tool

NDFE0001

The actual shapes of Kent-Moore tools may differ from those of special service tools illustrated here.

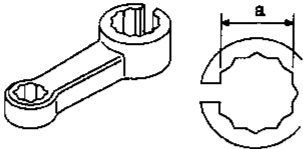
Tool number (Kent-Moore No.) Tool name	Description	
KV10114400 (J38365) Heated oxygen sensor wrench		Loosening or tightening rear heated oxygen sensor a: 22 mm (0.87 in)
	NT636	

Commercial Service Tool

NDFE0006

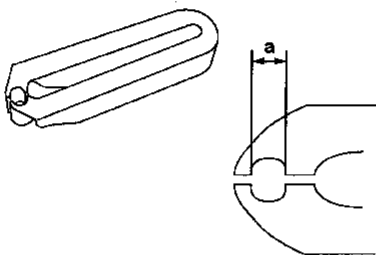
Tool name	Description	
Fuel tube removal tool		For disconnecting fuel tube quick connectors a: 7.9 mm (5/16 in)
	AFE111	

Removal and Installation

NDFE0002

CAUTION:

- When removing accelerator wire, make a mark to indicate lock nut's initial position.
- Check that throttle valve opens fully when accelerator pedal is fully depressed. Also check that it returns to idle position when pedal is released.
- Check accelerator control parts for improper contact with any adjacent parts.
- When connecting accelerator wire, be careful not to twist or scratch its inner wire.
- Refer to EL section ("AUTOMATIC SPEED CONTROL DEVICE") for ASCD wire adjustment.

SEC. 180

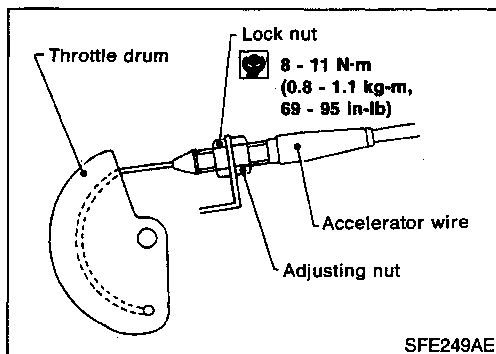
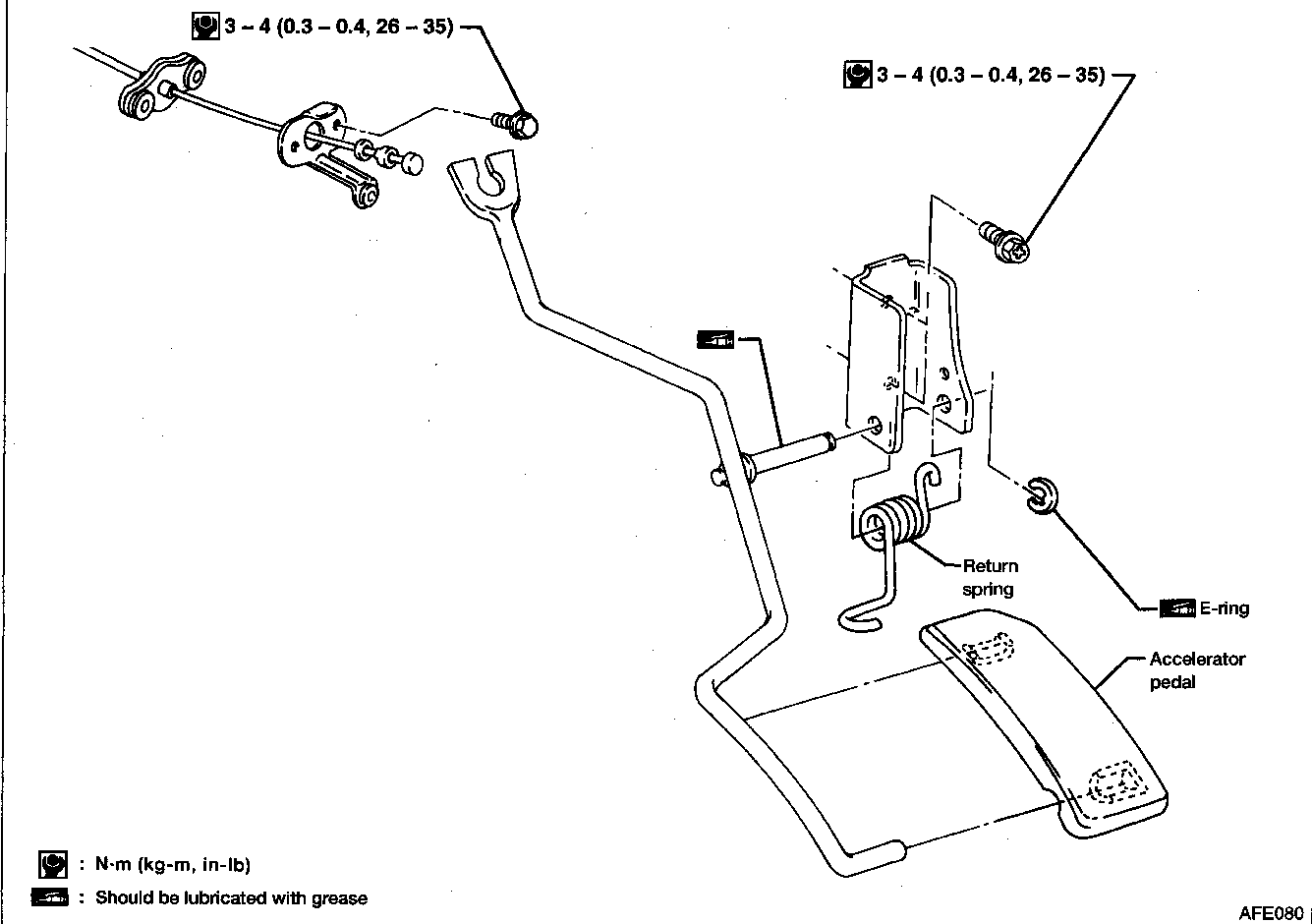

Adjusting Accelerator Wire

NDFE0003

NOTE:

Adjust accelerator wire with the engine warmed up to normal operating temperature and ignition switch turned to OFF.

1. Loosen lock nut, and tighten adjusting nut until throttle drum starts to move.
2. From that position turn back adjusting nut 1.5 to 2 turns, and secure lock nut.

FUEL SYSTEM

Removal and Installation

NDFE0004

WARNING:

When replacing fuel line parts, be sure to observe the following:

- Put a "CAUTION: INFLAMMABLE" sign in workshop.
- Do not smoke while servicing fuel system. Keep open flames and sparks away from work area.
- Be sure to furnish the workshop with a CO₂ fire extinguisher.

CAUTION:

- Before removing fuel line parts, carry out the following procedures:
 - a) Put drained fuel in an explosion-proof container and put lid on securely.
 - b) Release fuel pressure from fuel line. Refer to MA section ("Changing Fuel Filter").
 - c) Disconnect battery ground cable.
- Remove quick connectors with Commercial Service Tool.
- Always replace O-ring with a new one.
- Do not kink or twist hoses and tubes when installed.
- Do not tighten hose clamps excessively to avoid damaging hoses.
- When installing fuel check valve, be careful of its designated direction. Refer to EC section ("EVAPORATIVE EMISSION SYSTEM").
- After installation, run engine and check for fuel leaks at connections.

FUEL SYSTEM

Removal and Installation (Cont'd)

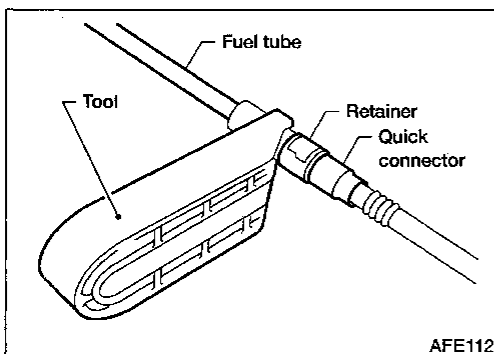
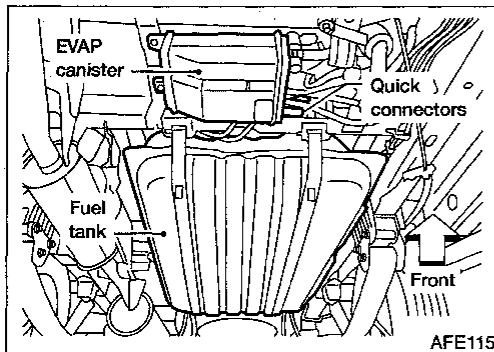
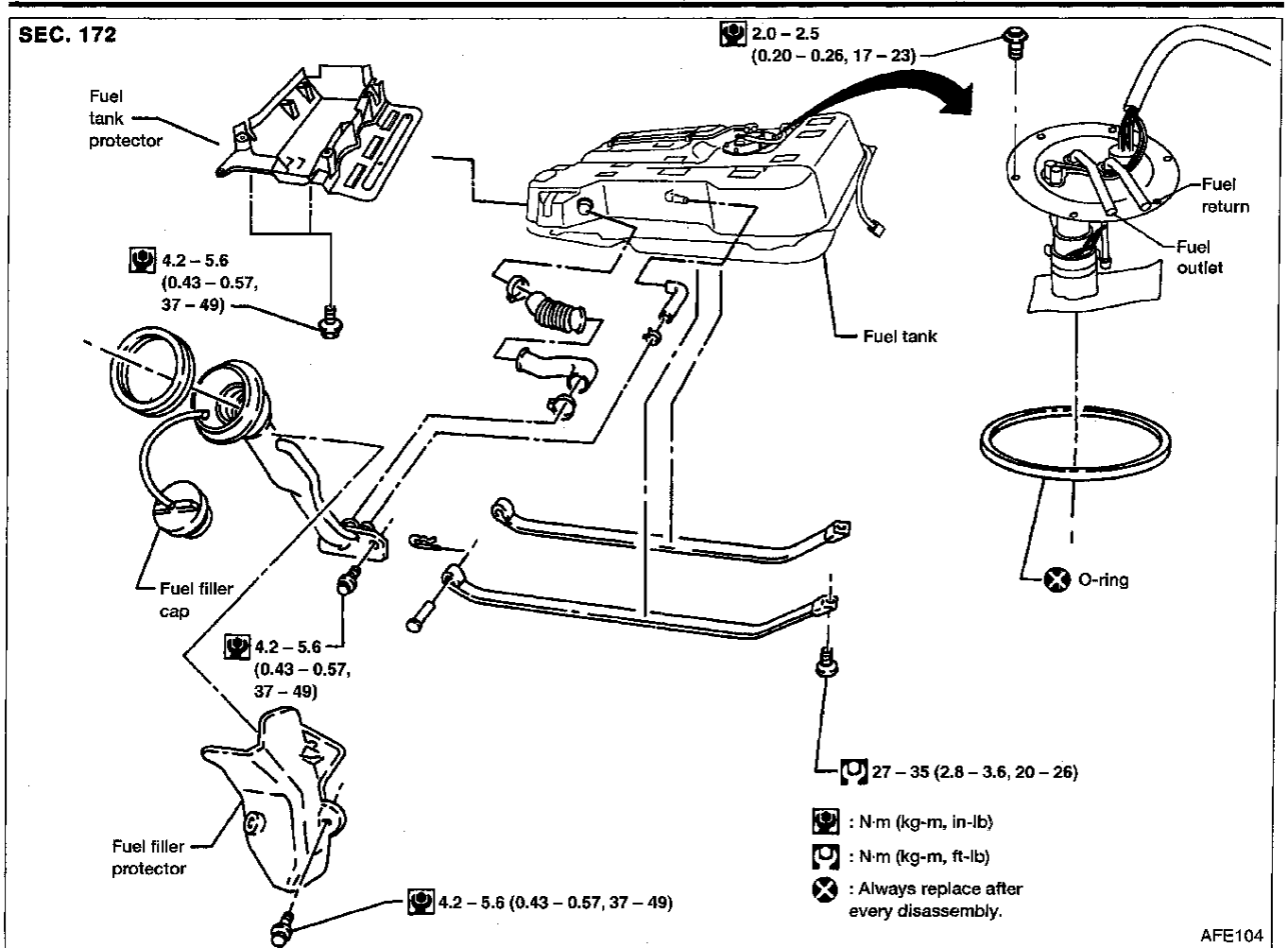

FUEL TANK

1. Release fuel pressure from fuel line. Refer to MA section ("Changing Fuel Filter").
2. Disconnect battery ground cable.
3. Drain fuel from fuel tank.
4. Disconnect electrical connectors.
5. Remove filler protector.
6. Disconnect filler tube.

7. Disconnect the quick connectors as follows.

CAUTION:

To prevent damaging fuel lines, remove quick connectors with Tool.

- 1) Put mating marks on tubes and connectors for correct installation.
- 2) Hold side of connector, slide tool inside of quick connector to open retainer and pull tube out of quick connector.

FUEL SYSTEM

Removal and Installation (Cont'd)

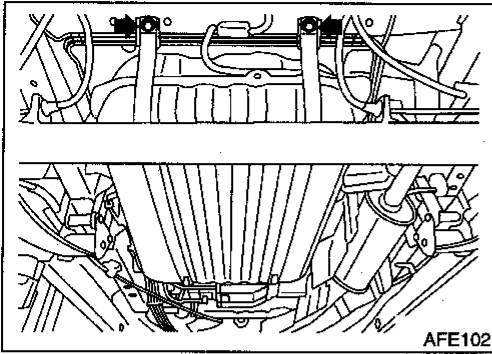

8. Remove tank mounting band bolts while supporting fuel tank.

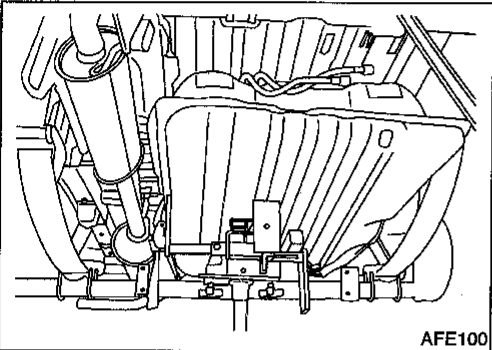

9. Remove fuel tank.

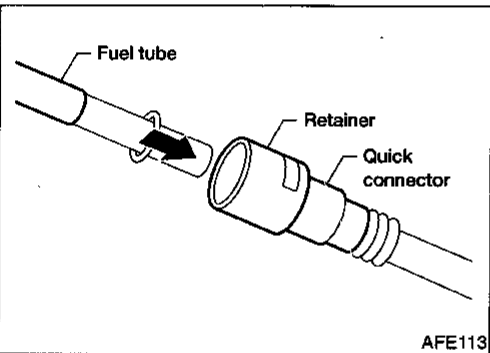

To install, reverse the removal procedure. Connect the quick connectors as follows.

- Align mating marks.
- Insert tube into the center of the connector until you hear a click.

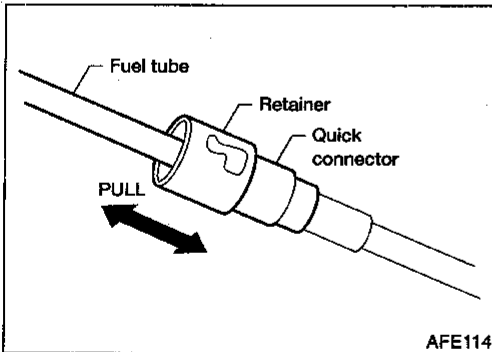

After connecting quick connectors, make sure the connection is firmly made using the following method.

- Pull on the fuel tube and connector to make sure they are firmly connected.
- Start the engine, increase engine speed and verify that there are no leaks.

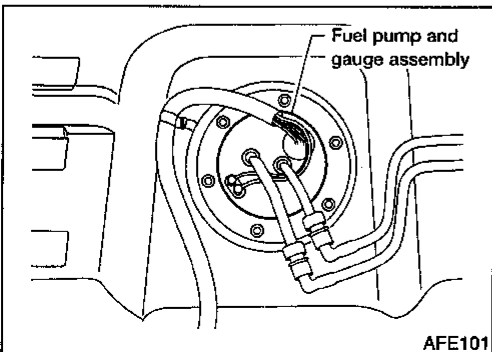

FUEL PUMP AND GAUGE

NDFE0004S02

1. Remove fuel tank. Refer to "FUEL TANK", FE-5.
- For removal of quick connectors, refer to step 7 of "FUEL TANK", FE-5.
2. Disconnect battery ground cable.
3. Disconnect fuel tubes and electrical connectors.
4. Remove the six bolts.

FUEL SYSTEM

Removal and Installation (Cont'd)

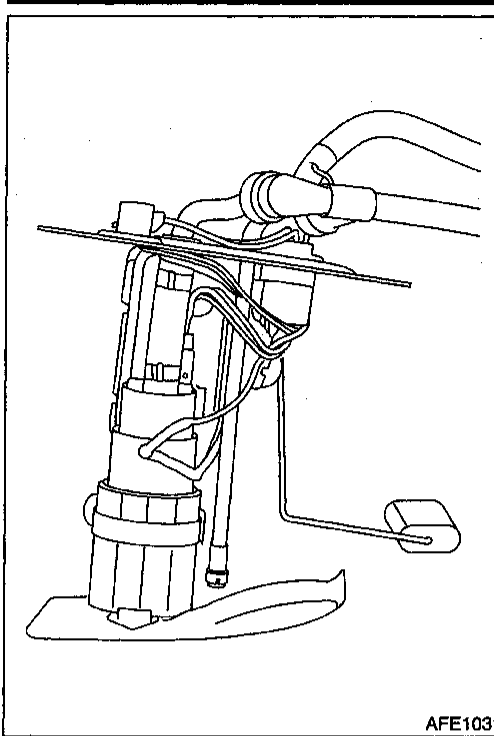

5. Remove fuel gauge assembly.

Installation procedure is the reverse order of removal.

CAUTION:

- Tighten bolts to specified torque.
 ⊗ : 2.0 - 2.5 N·m (0.20 - 0.26 kg-m, 17.4 - 22.6 in-lb)
- Always replace O-ring with a new one.
- After installation, run engine and check for leaks at connectors.

GI

MA

EM

LC

EC

FE

AT

AX

SU

BR

ST

RS

BT

HA

SC

EL

IDX

EXHAUST SYSTEM

Removal and Installation

Removal and Installation

NDFE0005

CAUTION:

- Always replace exhaust gaskets with new ones when reassembling.
- With engine running, check all tube connections for exhaust gas leaks, and entire system for unusual noises.
- Check to ensure that mounting brackets and mounting insulators are installed properly and free from undue stress. Improper installation could result in excessive noise or vibration.
- Discard any heated oxygen sensor which has been dropped from a height of more than 0.5 m (19.7 in) onto a hard surface such as a concrete floor; use a new one.
- Do not overtorque the oxygen sensor. Doing so may cause damage to the oxygen sensor, resulting in the MIL coming on.

EXHAUST SYSTEM

Removal and Installation (Cont'd)

Except California
SEC. 200

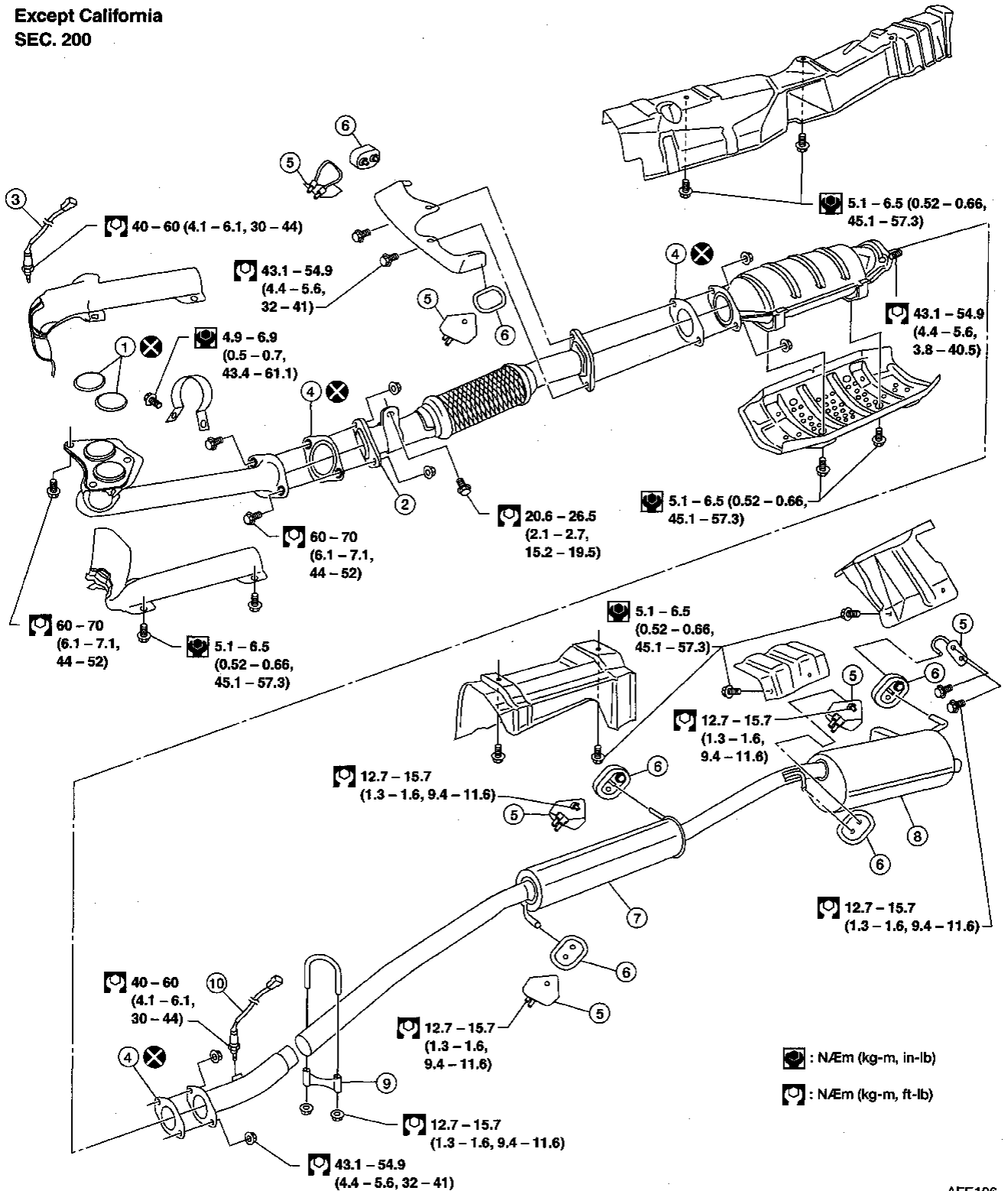

1. Gasket
2. Front tube
3. Front heated oxygen sensor
4. Gasket

5. Mounting bracket
6. Mounting rubber
7. Center muffler

8. Rear muffler
9. Clamp
10. Rear heated oxygen sensor

FE-9

AFE106

EXHAUST SYSTEM

Removal and Installation (Cont'd)

California exhaust
SEC. 200

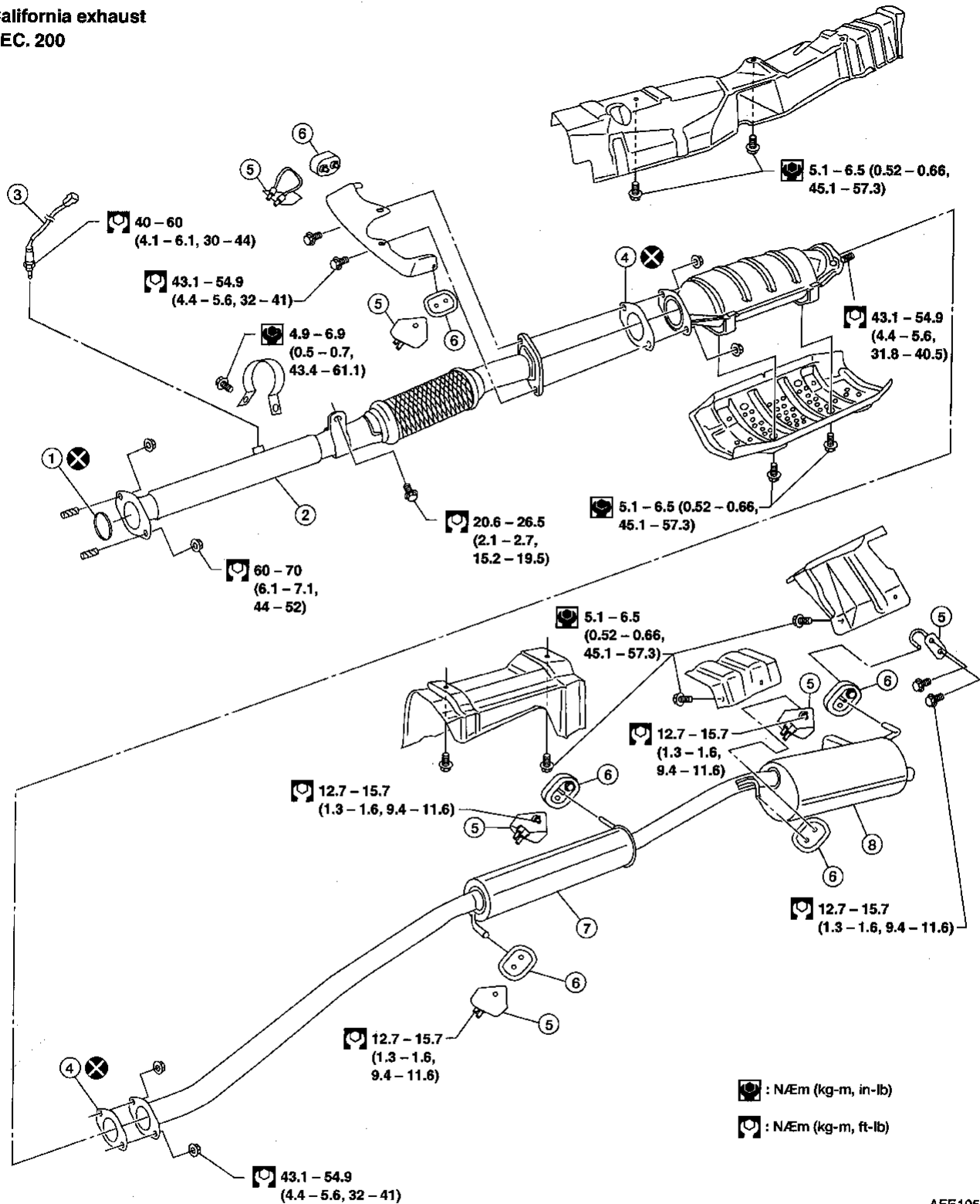

AFE105

- 1. Gasket
- 2. Front tube
- 3. Rear heated oxygen sensor

- 4. Gasket
- 5. Mounting bracket
- 6. Mounting rubber

- 7. Center muffler
- 8. Rear muffler