

SECTION

EX

EX

EXHAUST SYSTEM

CONTENTS

REGULAR GRADE		
PRECAUTION .....	2	
PRECAUTIONS .....	2	
Removal and Installation .....	2	
PREPARATION .....	3	
PREPARATION .....	3	
Special Service Tool .....	3	
Commercial Service Tool .....	3	
PERIODIC MAINTENANCE .....	4	
EXHAUST SYSTEM .....	4	F
Inspection .....	4	
REMOVAL AND INSTALLATION .....	5	G
EXHAUST SYSTEM .....	5	
Exploded View .....	5	
Removal and Installation .....	5	H
Inspection .....	6	
Krom		
SYSTEM DESCRIPTION .....	7	I
COMPONENT PARTS .....	7	J
Muffler .....	7	
		K
		L
		M
		N
		O
		P

## PRECAUTION

### PRECAUTIONS

#### Removal and Installation

INFOID:000000006204660

#### **CAUTION:**

- Be sure to use genuine exhaust system parts or equivalents which are specially designed for heat resistance, corrosion resistance, and shape.
- Perform the operation with the exhaust system fully cooled down because the system will be hot just after engine stops.
- Be careful not to cut your hand on the heat insulator edge.

# PREPARATION

< PREPARATION >

[REGULAR GRADE]

## PREPARATION

### PREPARATION

#### Special Service Tool

INFOID:0000000006204661

The actual shapes of Kent-Moore tools may differ from those of special service tools illustrated here.

Tool number (Kent-Moore No.) Tool name	Description
KV10114400 (J-38365) Heated oxygen sensor wrench	Loosening or tightening heated oxygen sensor 3 <b>For 22 mm (0.87 in) (a) width hexagon nut</b>

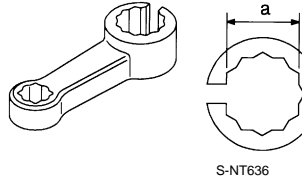

#### Commercial Service Tool

INFOID:0000000006204662

(Kent-Moore No.) Tool name	Description
A: (J-43897-18) B: (J-43897-12) Heated oxygen sensor thread cleaner	Reconditioning the exhaust system threads before installing a heated oxygen sensor (Use with anti-seize lubricant shown below.) <b>A: J-43897-18 [18 mm (0.71 in) dia.] for zirconia heated oxygen sensor</b> <b>B: J-43897-12 [12 mm (0.47 in) dia.] for titania heated oxygen sensor</b> <b>C: Mating surface shave cylinder</b> <b>D: Flutes</b>
( — ) Anti-seize lubricant (Permatex 133AR or equivalent meeting MIL specification MIL-A-907)	Lubricating air fuel ratio sensor and heated oxygen sensor thread cleaner when reconditioning exhaust system threads

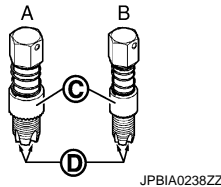

## PERIODIC MAINTENANCE

### EXHAUST SYSTEM

#### Inspection

INFOID:000000006204663

Check exhaust pipes, muffler, and mounting for improper attachment, leakage, cracks, damage or deterioration.

- If anything is found, repair or replace damaged parts.

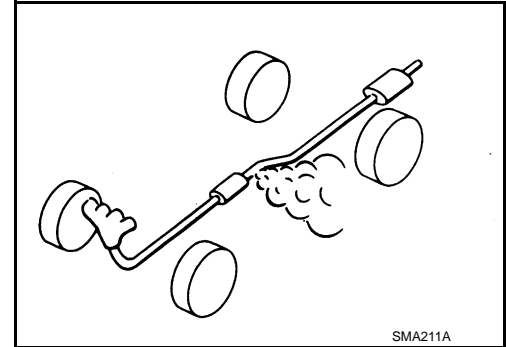

# EXHAUST SYSTEM

< REMOVAL AND INSTALLATION >

[REGULAR GRADE]

## REMOVAL AND INSTALLATION

### EXHAUST SYSTEM

Exploded View

INFOID:0000000006204664

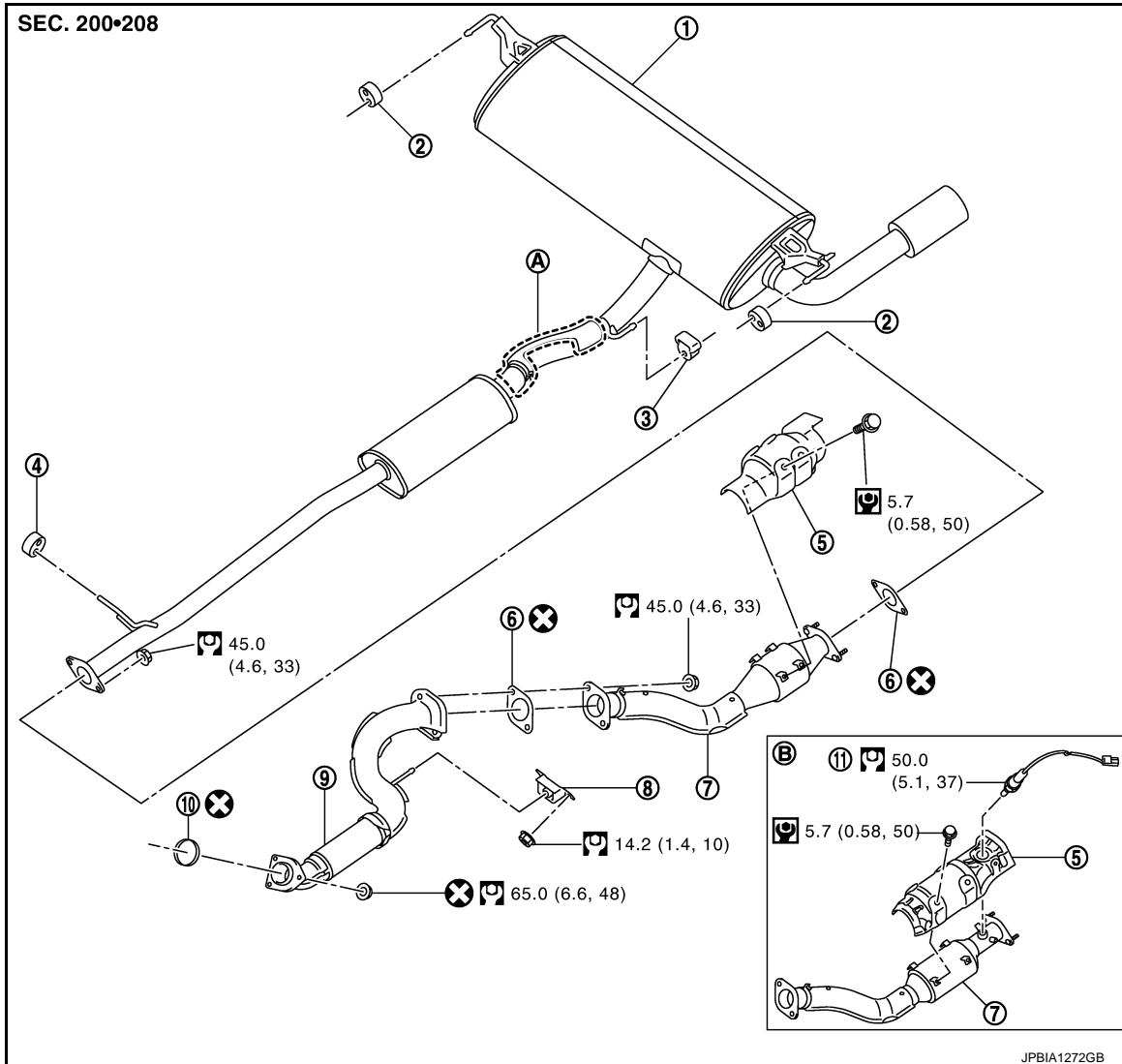

- |                           |                            |                       |
|---------------------------|----------------------------|-----------------------|
| 1. Muffer assembly        | 2. Mounting rubber         | 3. Mounting rubber    |
| 4. Mounting rubber        | 5. Insulator               | 6. Gasket             |
| 7. Exhaust center tube    | 8. Mounting rubber         | 9. Exhaust front tube |
| 10. Gasket                | 11. Heated oxygen sensor 3 |                       |
| A. Insulator (AWD models) | B. For California          |                       |

Refer to [GI-4, "Components"](#) for symbols in the figure.

### Removal and Installation

INFOID:0000000006204665

#### REMOVAL

- Disconnect each joint and mounting.
- Remove heated oxygen sensor 3 with following procedure. (For California)

# EXHAUST SYSTEM

## < REMOVAL AND INSTALLATION >

[REGULAR GRADE]

- Using heated oxygen sensor wrench [SST: KV10114400 (J-38365)] (A), remove heated oxygen sensor 3 (1).

**CAUTION:**

Be careful not to damage heated oxygen sensor 3.

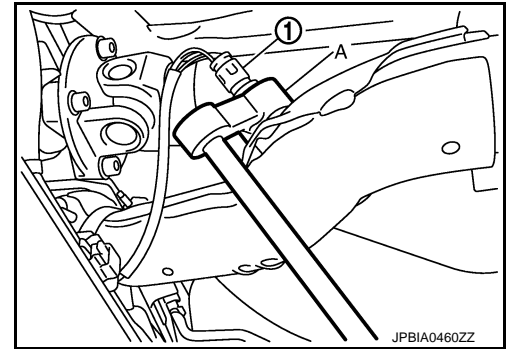

## INSTALLATION

Note the following, and install in the reverse order of removal.

**CAUTION:**

- Always replace exhaust gasket with new ones when reassembling.
- Discard any heated oxygen sensor 3 which has been dropped onto a hard surface such as a concrete floor. Use a new one. (For California)
- Before installing a new heated oxygen sensor 3, clean exhaust system threads using the heated oxygen sensor thread cleaner (commercial service tool: J-43897-18 or J-43897-12), and apply the anti-seize lubricant (commercial service tool). (For California)
- Never over torque heated oxygen sensor 3. Doing so may cause damage to heated oxygen sensor 3, resulting in the "MIL" coming on. (For California)
- If heat insulator is badly deformed, repair or replace it. If deposits such as mud pile up on the heat insulator, remove them.
- When installing heat insulator avoid large gaps or interference between heat insulator and each exhaust pipe.
- Remove deposits from the sealing surface of each connection. Connect them securely to avoid gas leakage.
- If it is difficult to install mounting rubber, use mild detergent for smooth installation.
- When installing each mounting rubber, avoid twisting or unusual extension in up/down and right/left directions.
- Temporarily tighten mounting nuts and bolts. Check each part for unusual interference, and then tighten them to the specified torque.

## Inspection

INFOID:0000000006204666

## INSPECTION AFTER INSTALLATION

- Check clearance between tail tube and rear bumper is even.
- With engine running, check exhaust tube joints for gas leakage and unusual noises.
- Check to ensure that mounting brackets and mounting rubbers are installed properly and free from undue stress. Improper installation could result in excessive noise and vibration.

## SYSTEM DESCRIPTION

### COMPONENT PARTS

#### Muffler

INFOID:0000000006204667

The main muffler specification is changed so as to match the vehicle characteristics. The servicing instructions are the same as the Rogue service manual.

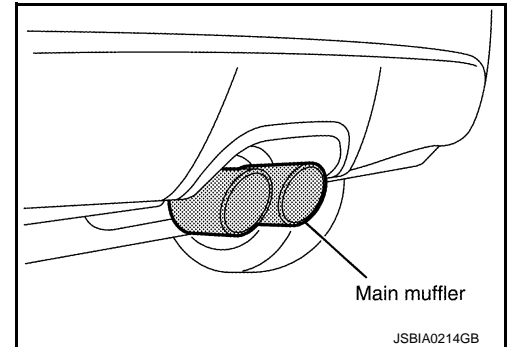

A

EX

C

D

E

F

G

H

I

J

K

L

M

N

O

P