

A  
LU

# SECTION LU

## ENGINE LUBRICATION SYSTEM

C

### CONTENTS

D  
E

<b>PRECAUTION</b> .....	2	<b>OIL FILTER</b> .....	11	F
<b>PRECAUTIONS</b> .....	2	Removal and Installation .....	11	
Precaution for Supplemental Restraint System (SRS) "AIR BAG" and "SEAT BELT PRE-TENSIONER" .....	2	<b>REMOVAL AND INSTALLATION</b> .....	12	G
Precaution for Liquid Gasket .....	2	<b>OIL COOLER</b> .....	12	
<b>PREPARATION</b> .....	4	Exploded View .....	12	H
<b>PREPARATION</b> .....	4	Removal and Installation .....	12	
Special Service Tool .....	4	<b>OIL PUMP</b> .....	14	
Commercial Service Tool .....	4	Exploded View .....	14	I
<b>SYSTEM DESCRIPTION</b> .....	6	Removal and Installation .....	14	
<b>LUBRICATION SYSTEM</b> .....	6	<b>UNIT DISASSEMBLY AND ASSEMBLY</b> ...	16	J
Lubrication Circuit .....	6	<b>OIL PUMP</b> .....	16	
Schematic .....	7	Disassembly and Assembly .....	16	K
<b>PERIODIC MAINTENANCE</b> .....	8	<b>SERVICE DATA AND SPECIFICATIONS (SDS)</b> .....	18	
<b>ENGINE OIL</b> .....	8	<b>SERVICE DATA AND SPECIFICATIONS (SDS)</b> .....	18	L
Inspection .....	8	Standard and Limit .....	18	
Changing Engine Oil .....	9			M

N  
O  
P

# PRECAUTIONS

< PRECAUTION >

## PRECAUTION

### PRECAUTIONS

#### Precaution for Supplemental Restraint System (SRS) "AIR BAG" and "SEAT BELT PRE-TENSIONER"

INFOID:000000006158398

The Supplemental Restraint System such as "AIR BAG" and "SEAT BELT PRE-TENSIONER", used along with a front seat belt, helps to reduce the risk or severity of injury to the driver and front passenger for certain types of collision. This system includes seat belt switch inputs and dual stage front air bag modules. The SRS system uses the seat belt switches to determine the front air bag deployment, and may only deploy one front air bag, depending on the severity of a collision and whether the front occupants are belted or unbelted. Information necessary to service the system safely is included in the SR and SB section of this Service Manual.

#### **WARNING:**

- To avoid rendering the SRS inoperative, which could increase the risk of personal injury or death in the event of a collision which would result in air bag inflation, all maintenance must be performed by an authorized NISSAN/INFINITI dealer.
- Improper maintenance, including incorrect removal and installation of the SRS, can lead to personal injury caused by unintentional activation of the system. For removal of Spiral Cable and Air Bag Module, see the SR section.
- Do not use electrical test equipment on any circuit related to the SRS unless instructed to in this Service Manual. SRS wiring harnesses can be identified by yellow and/or orange harnesses or harness connectors.

#### PRECAUTIONS WHEN USING POWER TOOLS (AIR OR ELECTRIC) AND HAMMERS

#### **WARNING:**

- When working near the Airbag Diagnosis Sensor Unit or other Airbag System sensors with the Ignition ON or engine running, DO NOT use air or electric power tools or strike near the sensor(s) with a hammer. Heavy vibration could activate the sensor(s) and deploy the air bag(s), possibly causing serious injury.
- When using air or electric power tools or hammers, always switch the Ignition OFF, disconnect the battery, and wait at least 3 minutes before performing any service.

#### Precaution for Liquid Gasket

INFOID:000000006158399

#### REMOVAL OF LIQUID GASKET SEALING

- After removing the bolts and nuts, separate the mating surface and remove the old liquid gasket sealing using Tool.

**Tool number** : KV10111100 (J-37228)

#### **CAUTION:**

**Do not damage the mating surfaces.**

- Tap the seal cutter to insert it (1).
- In areas where the Tool is difficult to use, lightly tap to slide it (2).

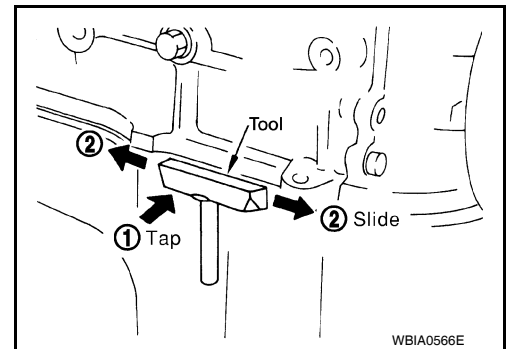

#### LIQUID GASKET APPLICATION PROCEDURE

# PRECAUTIONS

## < PRECAUTION >

1. Remove the old liquid gasket adhering to the gasket application surface and the mating surface using suitable tool.
  - Remove the liquid gasket completely from the groove of the liquid gasket application surface, bolts, and bolt holes.
2. Thoroughly clean the mating surfaces and remove adhering moisture, grease and foreign material.

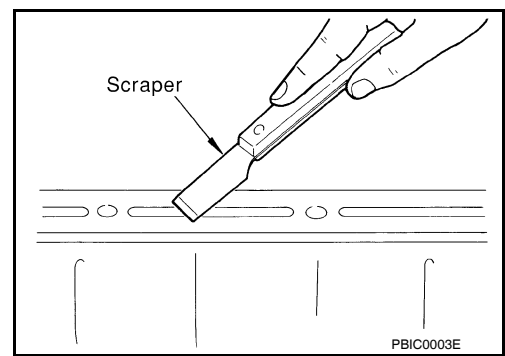

3. Attach the liquid gasket tube to the Tool.

**Tool number : WS39930000 ( — )**

**Use Genuine RTV Silicone Sealant or equivalent. Refer to [GI-15, "Recommended Chemical Products and Sealants"](#).**

4. Apply the liquid gasket without breaks to the specified location with the specified dimensions.

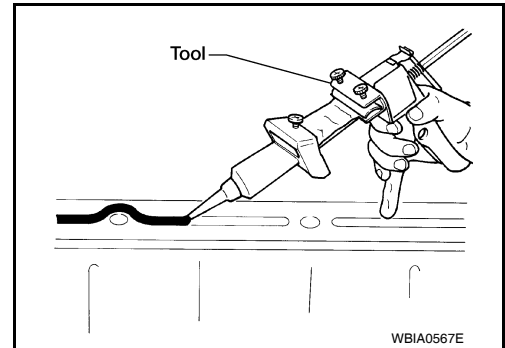

- If there is a groove for the liquid gasket application, apply the liquid gasket to the groove.
- As for the bolt holes, normally apply the liquid gasket inside the holes. If specified in the procedure, it should also be applied outside the holes.
- Within five minutes of liquid gasket application, install the mating component.
- If the liquid gasket protrudes, wipe it off immediately.
- Do not retighten after the installation.
- Wait 30 minutes or more after installation before refilling the engine with engine oil and engine coolant.

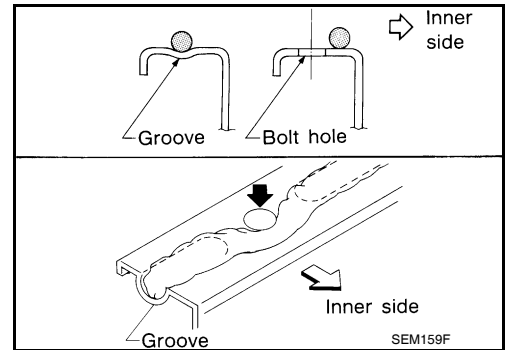

### **CAUTION:**

**If there are specific instructions in this manual, observe them.**

# PREPARATION

< PREPARATION >

## PREPARATION

### PREPARATION

#### Special Service Tool

INFOID:000000006158400

The actual shapes of Kent-Moore tools may differ from those of special service tools illustrated here.

Tool number (Kent-Moore No.) Tool name	Description
ST25051001 (J-25695-1) Oil pressure gauge <div data-bbox="673 535 868 667" data-label="Image"> </div> <div data-bbox="828 682 885 703" data-label="Caption"> <p>S-NT050</p> </div>	Measuring oil pressure <b>Maximum measuring range:</b> <b>2,452 kPa (25 kg/cm<sup>2</sup>, 356 psi)</b>
ST25052000 (J-25695-2) Hose <div data-bbox="617 787 933 913" data-label="Image"> </div> <div data-bbox="828 934 885 955" data-label="Caption"> <p>S-NT559</p> </div>	Adapting oil pressure gauge to cylinder block
KV10111100 (J-37228) Seal cutter <div data-bbox="706 1039 836 1171" data-label="Image"> </div> <div data-bbox="828 1186 876 1207" data-label="Caption"> <p>NT046</p> </div>	Removing steel oil pan and rear timing chain case
KV10115801 (J-38956) Oil filter wrench <div data-bbox="633 1270 893 1417" data-label="Image"> </div> <div data-bbox="828 1438 885 1459" data-label="Caption"> <p>S-NT375</p> </div>	Removing and installing oil filter <b>a: 64.3 mm (2.531 in)</b>
WS39930000 ( — ) Tube presser <div data-bbox="649 1543 893 1669" data-label="Image"> </div> <div data-bbox="828 1690 885 1711" data-label="Caption"> <p>S-NT052</p> </div>	Pressing the tube of liquid gasket

#### Commercial Service Tool

INFOID:000000006158401

# PREPARATION

## < PREPARATION >

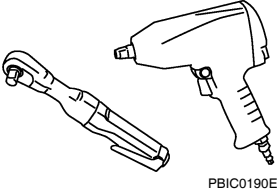
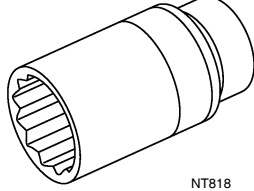
Tool name	Description
<p>Power tool</p>  <p>PBIC0190E</p>	<p>Loosening bolts and nuts</p>
<p>Deep socket</p>  <p>NT818</p>	<p>Removing and installing oil pressure switch Deep socket 26 mm</p>

A

**LU**

C

D

E

F

G

H

I

J

K

L

M

N

O

P

# LUBRICATION SYSTEM

< SYSTEM DESCRIPTION >

## SYSTEM DESCRIPTION

### LUBRICATION SYSTEM

#### Lubrication Circuit

INFOID:000000006158402

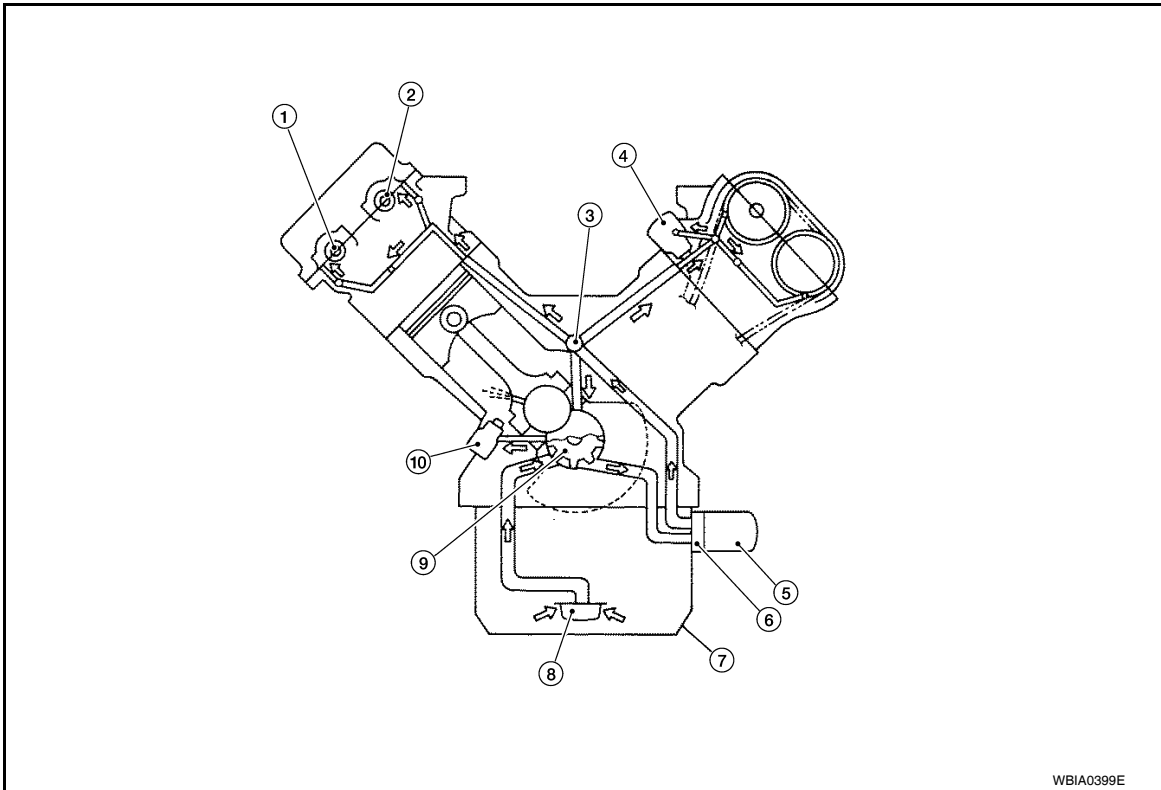

WBIA0399E

- |                                  |                    |                    |
|----------------------------------|--------------------|--------------------|
| 1. Exhaust camshaft              | 2. Intake camshaft | 3. Main oil galley |
| 4. Chain tensioner (Left bank)   | 5. Oil filter      | 6. Oil cooler      |
| 7. Oil pan                       | 8. Oil strainer    | 9. Oil pump        |
| 10. Chain tensioner (Right bank) |                    |                    |

# LUBRICATION SYSTEM

< SYSTEM DESCRIPTION >

## Schematic

INFOID:000000006158403

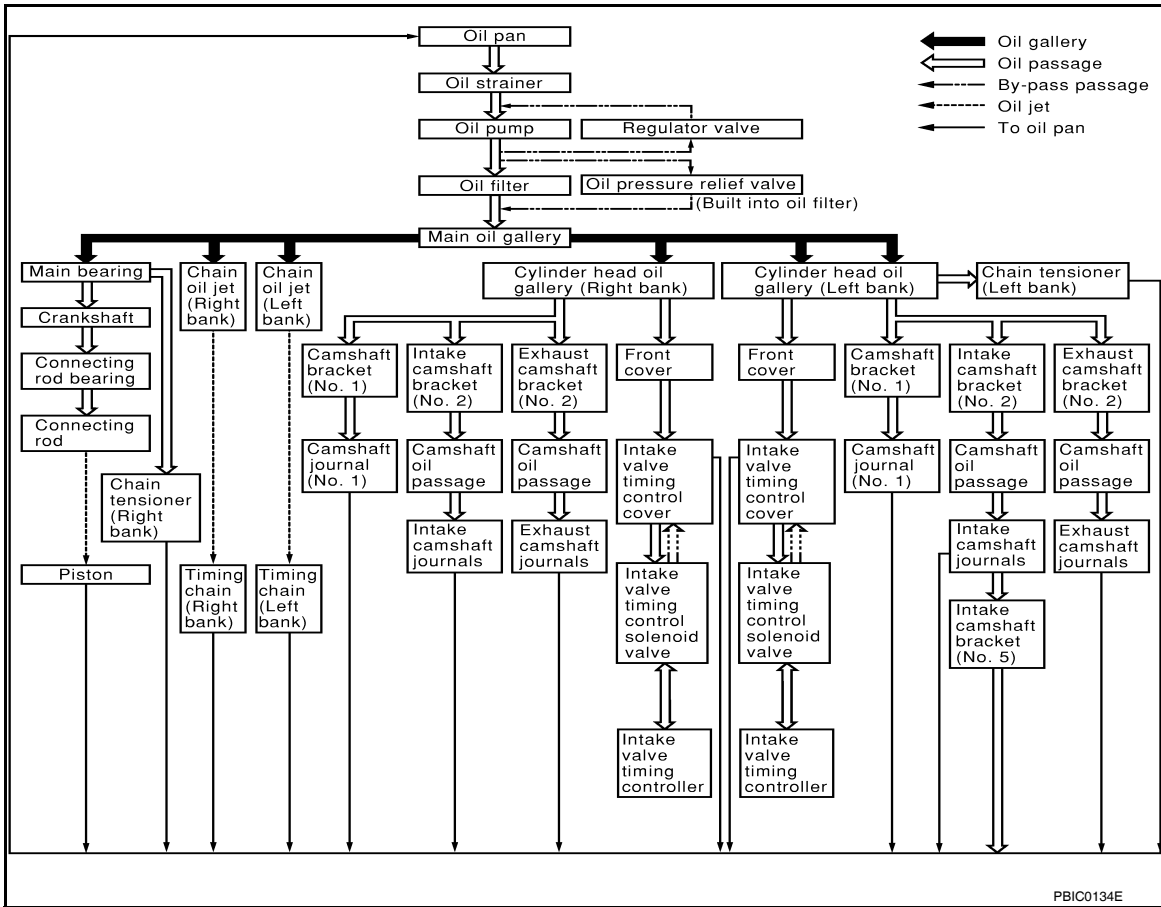

A

LU

C

D

E

F

G

H

I

J

K

L

M

N

O

P

# ENGINE OIL

< PERIODIC MAINTENANCE >

## PERIODIC MAINTENANCE

### ENGINE OIL

#### Inspection

INFOID:000000006158404

#### OIL LEVEL

- Before starting the engine make sure the vehicle is parked on a flat and level surface, then check the oil level. If the engine is already running, turn it off and allow 10 minutes before checking.
- Check that the oil level is within the low (L) and high (H) range as indicated on the dipstick.
- If the engine oil level is out of range, add oil as necessary. Refer to [MA-21. "FOR NORTH AMERICA : Fluids and Lubricants"](#), (United States and Canada), [MA-22. "FOR MEXICO : Fluids and Lubricants"](#) (Mexico).

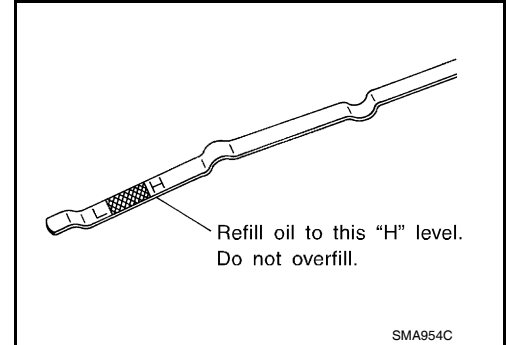

#### OIL APPEARANCE

- Check the engine oil for a white milky appearance or excessive contamination.
- If the engine oil is milky, it is highly probable that it is contaminated with engine coolant. Repair the broken parts.

#### OIL LEAKAGE

Check for oil leakage around the following areas:

- Oil pan
- Oil pan drain plug
- Oil pressure switch
- Oil filter
- Oil cooler
- Intake valve timing control cover
- Intake valve timing control solenoid valve
- Front cover
- Mating surface between cylinder block and cylinder head
- Mating surface between cylinder head and rocker cover
- Crankshaft oil seal (front and rear)

#### OIL PRESSURE CHECK

##### **WARNING:**

- **Be careful not to burn yourself, as engine oil may be hot.**
- **Put the A/T shift selector in the Park "P" position.**

1. Check the engine oil level. Refer to [LU-8. "Inspection"](#).
2. Remove engine under cover or skid plate. Refer to [EXT-15. "Removal and Installation"](#).
3. Disconnect the oil pressure switch harness connector.
4. Remove the oil pressure switch (A).

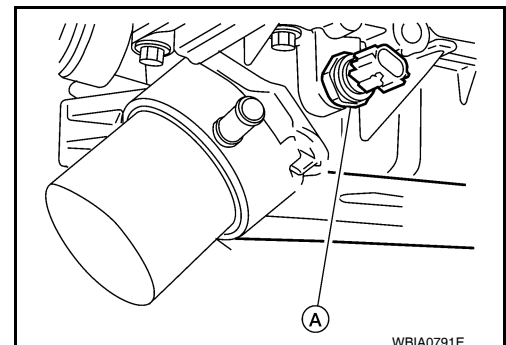



# ENGINE OIL

## < PERIODIC MAINTENANCE >

### 5. Install Tools.

**Tool number** : ST25051001 (J-25695-1)  
 : ST25052000 (J-25695-2)

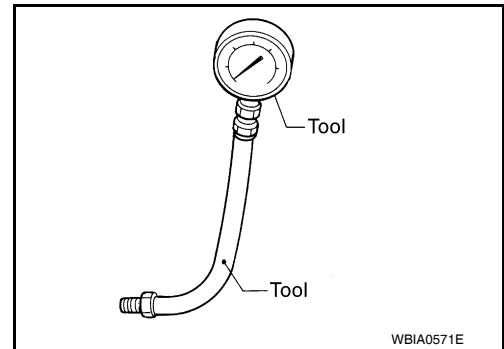

6. Start the engine and warm it up to normal operating temperature.
7. Check the engine oil pressure with engine running under no-load.

Unit: kPa (kg/cm<sup>2</sup>, psi)

Engine Speed	Approximate Discharge Oil Pressure*
Idle speed	More than 98 (1.0, 14)
2,000 rpm	More than 294 (3.0, 43)

\*: Engine oil temperature at 80°C (175°F)

### CAUTION:

**If the difference is extreme, check the oil passages and oil pump for leaks and blockages.**

8. After the inspections, install oil pressure switch as follows:
  - a. Remove old liquid gasket adhering to oil pressure switch and engine.
  - b. Apply liquid gasket and tighten oil pressure switch to the specification.  
**Use Genuine RTV Silicone Sealant or equivalent. Refer to [GI-15, "Recommended Chemical Products and Sealants"](#).**

**Oil pressure switch torque** : 14.8 N·m (1.5 kg-m, 11 ft-lb)

- c. After warming up engine, make sure there is no leakage of engine oil with engine running.

## Changing Engine Oil

INFOID:000000006158405

### WARNING:

- Be careful not to burn yourself, as the engine oil is hot.
- Prolonged and repeated contact with used engine oil may cause skin cancer. Try to avoid direct skin contact with used engine oil. If skin contact is made, wash thoroughly with soap or hand cleaner as soon as possible.

1. Remove engine under cover or skid plate. Refer to [EXT-15, "Removal and Installation"](#).
2. Warm up engine, and check for oil leakage from engine components. Refer to [LU-8, "Inspection"](#).
3. Stop engine and wait for 10 minutes.
4. Loosen oil filler cap, then remove drain plug.
5. Drain engine oil.
6. Install drain plug with new washer.

### CAUTION:

- Be sure to clean drain plug and install with new washer.

**Oil pan drain plug** : 34.3 N·m (3.5 kg-m, 25 ft-lb)

7. Refill with new engine oil. Refer to [MA-21, "FOR NORTH AMERICA : Fluids and Lubricants"](#), (United States and Canada), [MA-22, "FOR MEXICO : Fluids and Lubricants"](#). (Mexico).

### CAUTION:

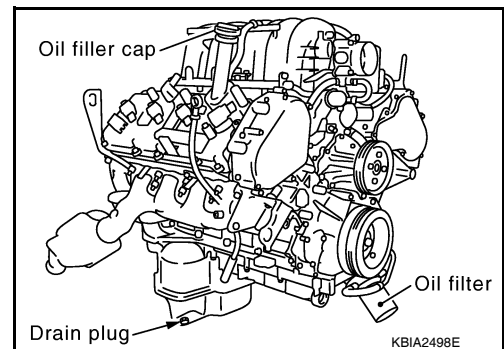

## ENGINE OIL

### < PERIODIC MAINTENANCE >

---

- **The refill capacity depends on the engine oil temperature and drain time. Use these specifications for reference only.**
  - **Always use the oil level gauge to determine when the proper amount of engine oil is in the engine.**
8. Warm up engine and check area around drain plug and oil filter for oil leakage.
  9. Stop engine and wait for 10 minutes.
  10. Check engine oil level. Refer to [LU-8, "Inspection"](#).

# OIL FILTER

< PERIODIC MAINTENANCE >

## OIL FILTER

### Removal and Installation

INFOID:000000006158406

#### REMOVAL

1. Remove engine undercover using a power tool.
2. Drain the engine oil. Refer to [LU-9, "Changing Engine Oil"](#).
3. Remove the oil filter using Tool.

**Tool number : KV10115801 (J-38956)**

#### **WARNING:**

- Be careful not to get burned when the engine and engine oil are hot.

#### **CAUTION:**

- The oil filter is provided with a relief valve. Use Genuine NISSAN oil filter or equivalent.
- When removing, prepare a shop cloth to absorb any engine oil leakage or spillage.
- Do not allow engine oil to adhere to the drive belts.
- Completely wipe off any engine oil that adheres to the engine and the vehicle.

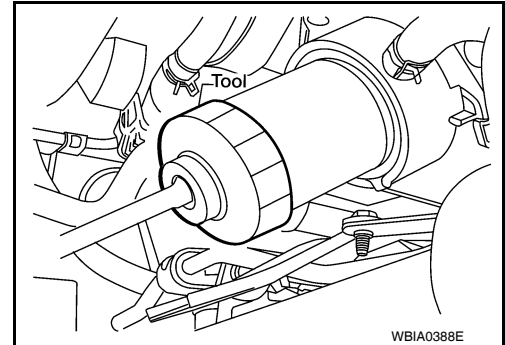

#### INSTALLATION

1. Remove foreign materials adhering to the oil filter installation surface.
2. Apply engine oil to the oil seal circumference of the new oil filter.

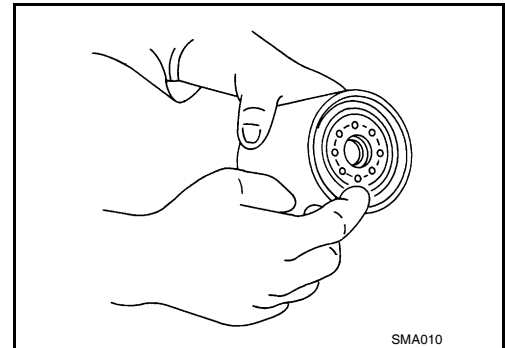

3. Screw the oil filter manually until it touches the installation surface, then tighten it by 2/3 turn. Or tighten to specification.

**Oil filter : 17.7 N·m (1.8 kg·m, 13 ft·lb)**

4. Refill the engine with new engine oil. Refer to [LU-9, "Changing Engine Oil"](#).
5. Inspect the engine for oil leakage. Follow the "INSPECTION AFTER INSTALLATION" procedure.
6. Install engine undercover using a power tool.

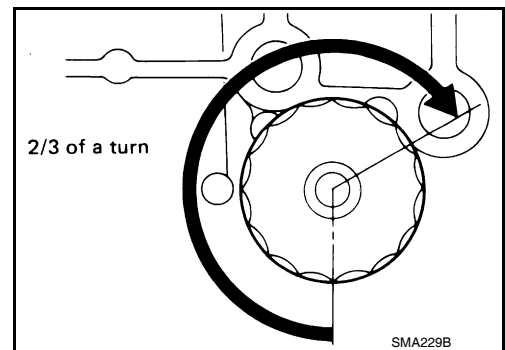

#### INSPECTION AFTER INSTALLATION

1. Check the engine oil level. Refer to [LU-8, "Inspection"](#).
2. Start the engine and check for engine oil leakage.
3. Stop the engine and wait for 10 minutes.
4. Check the engine oil level and add engine oil as required.

A  
LU  
C  
D  
E  
F  
G  
H  
I  
J  
K  
L  
M  
N  
O  
P

# OIL COOLER

< REMOVAL AND INSTALLATION >

## REMOVAL AND INSTALLATION

### OIL COOLER

Exploded View

INFOID:000000006158407

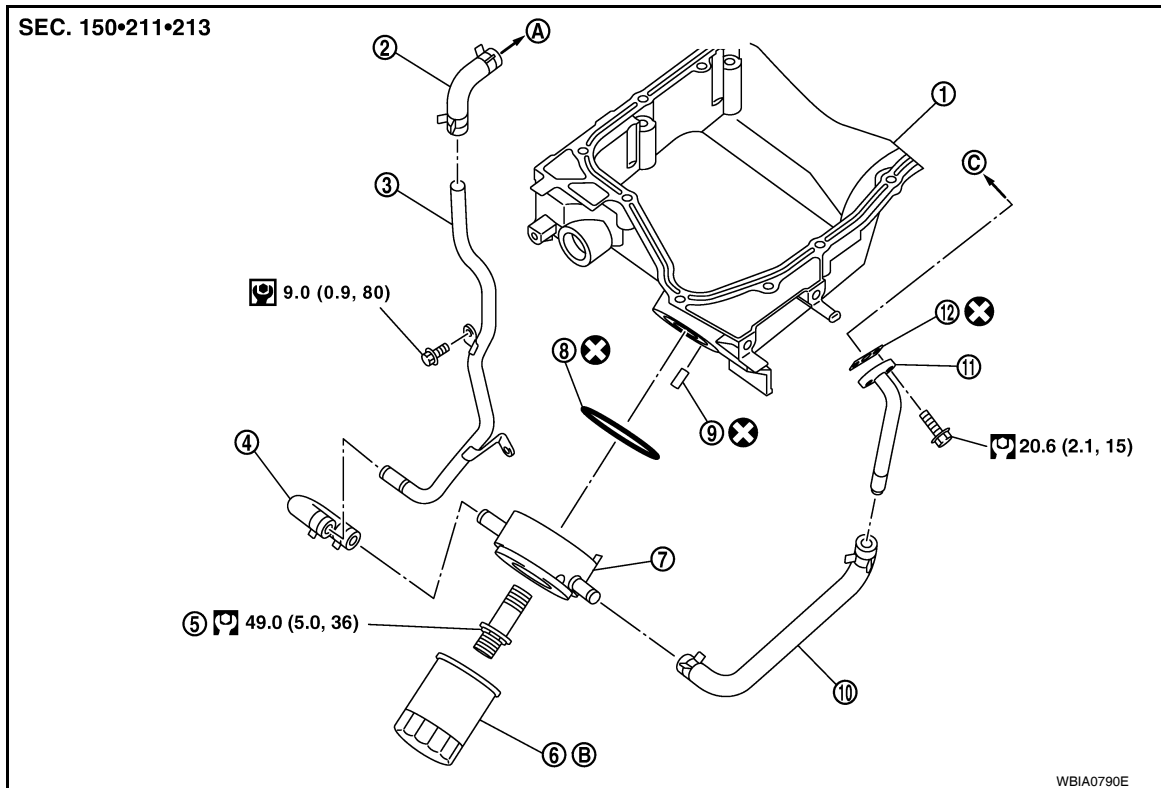

- |                          |                                   |                      |
|--------------------------|-----------------------------------|----------------------|
| 1. Oil pan (Upper)       | 2. Water hose                     | 3. Water pipe        |
| 4. Water hose            | 5. Connector bolt                 | 6. Oil filter        |
| 7. Oil cooler            | 8. O-ring                         | 9. Relief valve      |
| 10. Water hose           | 11. Connector pipe                | 12. Gasket           |
| A. To thermostat housing | B. Refer to <a href="#">LU-11</a> | C. To cylinder block |

### Removal and Installation

INFOID:000000006158408

#### **WARNING:**

**Be careful not to burn yourself, as the engine oil and engine coolant are hot.**

#### REMOVAL

1. Drain engine coolant from the radiator. Refer to [CO-11, "Changing Engine Coolant"](#).
2. Disconnect water hoses from the oil cooler.

#### **CAUTION:**

**Do not spill engine coolant on the drive belt.**

#### **NOTE:**

Cap or plug opening(s) to prevent fluid from spilling.

3. Remove oil filter. Refer to [LU-11, "Removal and Installation"](#).

#### **CAUTION:**

**Do not spill engine oil on the drive belts.**

4. Remove connector bolt, and remove oil cooler and O-ring.

#### INSPECTION AFTER REMOVAL

Oil Cooler

# OIL COOLER

## < REMOVAL AND INSTALLATION >

Check oil cooler for cracks. Check oil cooler for clogging by blowing compressed air through engine coolant inlet. If necessary, replace oil cooler assembly.

### Relief Valve

Inspect relief valve for movement, cracks and breaks by pushing the ball. If replacement is necessary, remove the valve by prying it out using a suitable tool. Install a new valve in place by tapping it.

### INSTALLATION

Installation is in the reverse order of removal, paying attention to the following:

- Confirm that no foreign objects are adhering to the sealing surfaces of the oil cooler or oil pan.
- Tighten the connecting bolt after aligning the stopper on the oil pan side with protrusion of the oil cooler.
- Install using a new O-ring.

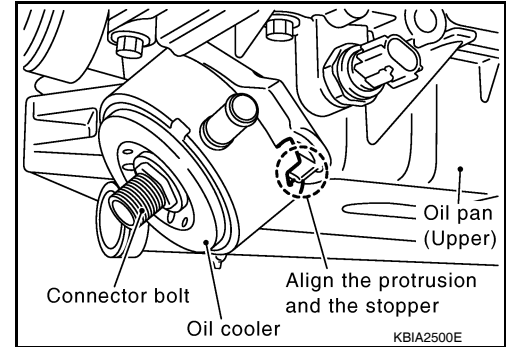

### INSPECTION AFTER INSTALLATION

1. Check levels and add engine oil and engine coolant. Refer to [LU-8, "Inspection"](#) and [CO-10, "Inspection"](#).
2. Start the engine, and check for engine oil and engine coolant leaks and repair as necessary.
3. Stop the engine and wait for 10 minutes.
4. Check engine oil level and engine coolant level again. Refer to [LU-8, "Inspection"](#) and [CO-10, "Inspection"](#).

# OIL PUMP

< REMOVAL AND INSTALLATION >

## OIL PUMP

### Exploded View

INFOID:000000006158409

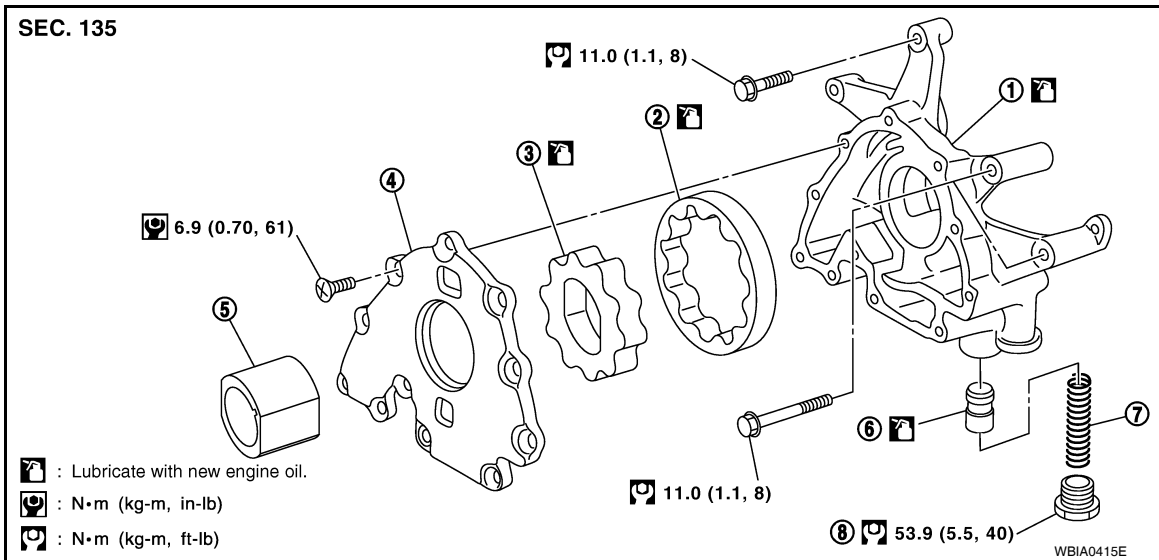

- |                     |                          |                    |
|---------------------|--------------------------|--------------------|
| 1. Oil pump body    | 2. Outer rotor           | 3. Inner rotor     |
| 4. Oil pump cover   | 5. Oil pump drive spacer | 6. Regulator valve |
| 7. Regulator spring | 8. Regulator plug        |                    |

## Removal and Installation

INFOID:000000006158410

### REMOVAL

1. Remove front cover. Refer to [EM-48, "Removal and Installation"](#).
2. Remove the oil pump drive spacer.
3. Remove the oil pump.

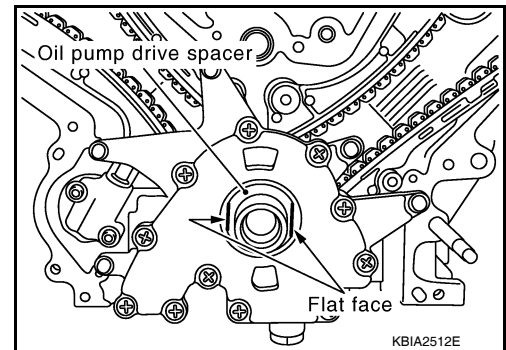

### INSTALLATION

Installation is in the reverse order of removal.

- When inserting the oil pump drive spacer, align the crankshaft key and the flat face of the inner rotor.
- If they are not aligned, rotate the oil pump inner rotor by hand.
- Make sure that each part is aligned and tap lightly until it reaches the end.

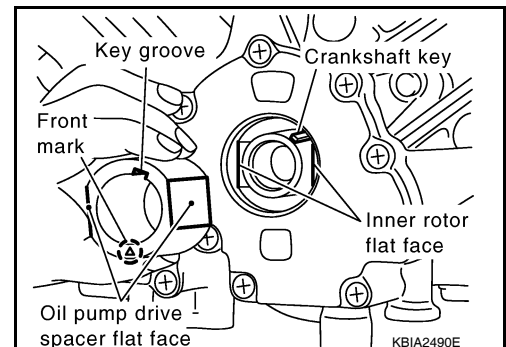

## INSPECTION AFTER INSTALLATION

# OIL PUMP

## < REMOVAL AND INSTALLATION >

---

- Start the engine, and check for engine oil and engine coolant leaks and repair as necessary.
- Stop engine and wait 10 minutes.
- Check level and add engine oil as required. Refer to [LU-8](#).

A

**LU**

C

D

E

F

G

H

I

J

K

L

M

N

O

P

# OIL PUMP

< UNIT DISASSEMBLY AND ASSEMBLY >

## UNIT DISASSEMBLY AND ASSEMBLY

### OIL PUMP

#### Disassembly and Assembly

INFOID:000000006158411

#### DISASSEMBLY

1. Remove oil pump cover.
2. Remove inner rotor and outer rotor from oil pump body.
3. Remove the regulator plug, regulator spring and regulator valve.

#### INSPECTION AFTER DISASSEMBLY

##### Clearance of Oil Pump Parts

- Measure radial clearance using a suitable tool.

**Body to outer rotor (position 1)**  
**: 0.114 - 0.200 mm (0.0045 - 0.0079 in)**

**Inner rotor to outer rotor tip (position 2)**  
**: Below 0.180 mm (0.0071 in)**

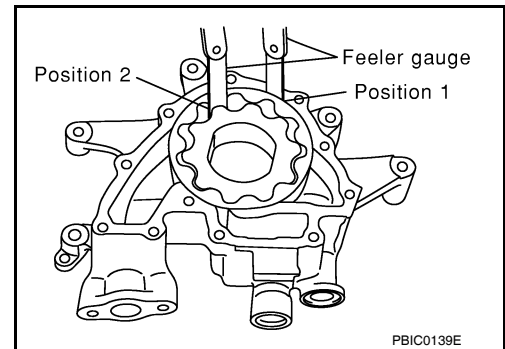

- Measure side clearance using suitable tools.

**Body to inner rotor (position 3)**  
**: 0.030 - 0.070 mm (0.0012 - 0.0028 in)**

**Body to outer rotor (position 4)**  
**: 0.030 - 0.090 mm (0.0012 - 0.0035 in)**

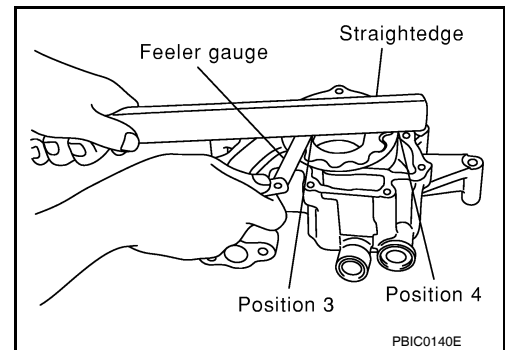

- Calculate the clearance between inner rotor and oil pump body as follows.

1. Measure the outer diameter of protruded portion of inner rotor (position 5) using suitable tool.

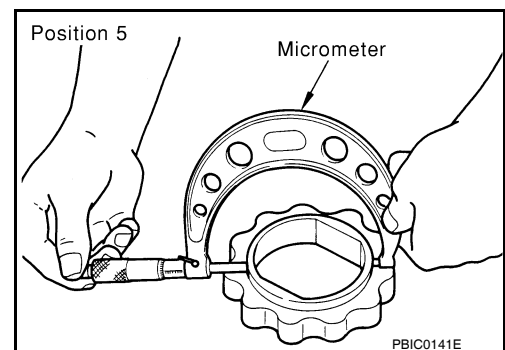



# OIL PUMP

## < UNIT DISASSEMBLY AND ASSEMBLY >

2. Measure the inner diameter of oil pump body to brazed portion (position 6) using suitable tool.

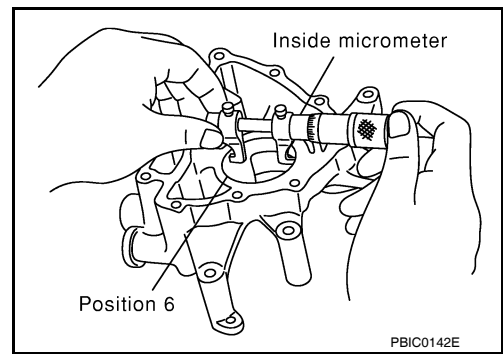

3. Calculate the clearance using the following formula.
  - (Clearance) = (Inner diameter of oil pump body) - (Outer diameter of inner rotor)

### Inner rotor to brazed portion of housing clearance

: 0.045 - 0.091 mm (0.0018 - 0.0036 in)

### Regulator Valve Clearance

Check regulator valve to oil pump cover clearance using the following formula.

- (Clearance) = D1 (Valve hole diameter) - D2 (Outer Diameter of valve)

### Regulator valve to oil pump cover

: 0.040 - 0.097 mm (0.0016 - 0.0038 in)

### CAUTION:

- Coat regulator valve with engine oil.
- Check that it falls smoothly into the regulator valve hole by its own weight.

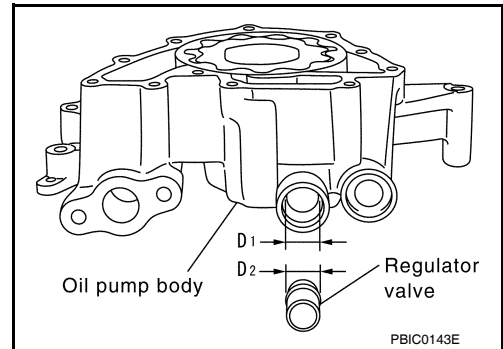

## ASSEMBLY

Assembly is in the reverse order of disassembly.

### NOTE:

Install the inner rotor and outer rotor with the punched marks on the oil pump cover side.

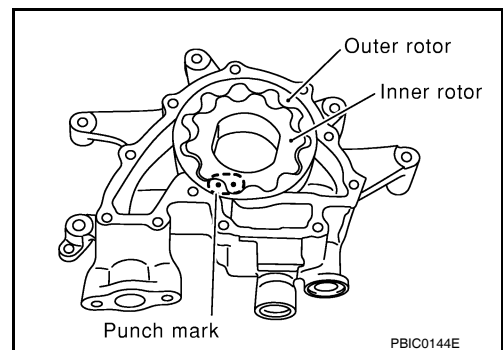

## SERVICE DATA AND SPECIFICATIONS (SDS)

< SERVICE DATA AND SPECIFICATIONS (SDS)

## SERVICE DATA AND SPECIFICATIONS (SDS)

### SERVICE DATA AND SPECIFICATIONS (SDS)

#### Standard and Limit

INFOID:000000006158412

#### OIL PRESSURE

Unit: kPa (kg/cm<sup>2</sup>, psi)

Engine speed	Approximate discharge oil pressure
Idle speed	More than 98 (1.0, 14)
2,000 rpm	More than 294 (3.0, 43)

#### OIL PUMP

Unit: mm (in)

Body to outer rotor radial clearance	0.114 - 0.200 (0.0045 - 0.0079)
Inner rotor to outer rotor tip clearance	Below 0.180 (0.0071)
Body to inner rotor side clearance	0.030 - 0.070 (0.0012 - 0.0028)
Body to outer rotor side clearance	0.030 - 0.090 (0.0012 - 0.0035)
Inner rotor to brazed portion of housing clearance	0.045 - 0.091 (0.0018 - 0.0036)

#### REGULATOR VALVE

Unit: mm (in)

Regulator valve to oil pump cover clearance	0.040 - 0.097 (0.0016 - 0.0038)
---	---------------------------------

#### ENGINE OIL CAPACITY (APPROXIMATE)

Unit: ℓ (US qt, Imp qt)

Drain and refill	With oil filter change	6.5 (6 7/8, 5 3/4)
	Without oil filter change	6.2 (6 1/2, 5 1/2)
Dry engine (engine overhaul)		7.6 (8, 6 3/4)