

SECTION **EX**  
EXHAUST SYSTEM

A

EX

C

D

E

CONTENTS

<b>SERVICE INFORMATION</b> .....	2	Special Service Tool .....	3	F
<b>PRECAUTIONS</b> .....	2	Commercial Service Tool .....	3	
Precaution for Supplemental Restraint System (SRS) "AIR BAG" and "SEAT BELT PRE-TEN- SIONER" .....	2	<b>EXHAUST SYSTEM</b> .....	4	G
<b>PREPARATION</b> .....	3	Checking Exhaust System .....	4	
		Component .....	4	
		Removal and Installation .....	4	H

F

G

H

I

J

K

L

M

N

O

P

# PRECAUTIONS

< SERVICE INFORMATION >

---

## SERVICE INFORMATION

### PRECAUTIONS

#### Precaution for Supplemental Restraint System (SRS) "AIR BAG" and "SEAT BELT PRE-TENSIONER"

INFOID:000000001830414

The Supplemental Restraint System such as "AIR BAG" and "SEAT BELT PRE-TENSIONER", used along with a front seat belt, helps to reduce the risk or severity of injury to the driver and front passenger for certain types of collision. This system includes seat belt switch inputs and dual stage front air bag modules. The SRS system uses the seat belt switches to determine the front air bag deployment, and may only deploy one front air bag, depending on the severity of a collision and whether the front occupants are belted or unbelted. Information necessary to service the system safely is included in the SRS and SB section of this Service Manual.

**WARNING:**

- **To avoid rendering the SRS inoperative, which could increase the risk of personal injury or death in the event of a collision which would result in air bag inflation, all maintenance must be performed by an authorized NISSAN/INFINITI dealer.**
- **Improper maintenance, including incorrect removal and installation of the SRS, can lead to personal injury caused by unintentional activation of the system. For removal of Spiral Cable and Air Bag Module, see the SRS section.**
- **Do not use electrical test equipment on any circuit related to the SRS unless instructed to in this Service Manual. SRS wiring harnesses can be identified by yellow and/or orange harnesses or harness connectors.**

# PREPARATION

< SERVICE INFORMATION >

## PREPARATION

### Special Service Tool

INFOID:000000001703104

Tool number Tool name	Description
KV10114400 (J-38365) Heated oxygen sensor wrench	Loosening or tightening heated oxygen sensor <b>a: 22 mm (0.87 in)</b>

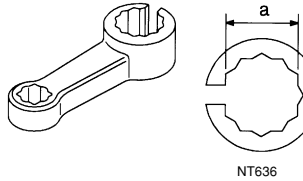

NT636

### Commercial Service Tool

INFOID:000000001703105

Tool name	Description
Heated oxygen sensor thread cleaner	Reconditioning the exhaust system threads before installing a new heated oxygen sensor (Use with anti-seize lubricant shown below.) <b>a: 18 mm (0.71 in) dia. for zirconia heated oxygen sensor</b> <b>b: 12 mm (0.47 in) dia. for titania heated oxygen sensor</b>
Anti-seize lubricant (Permatex 133AR or equivalent meeting MIL specification MIL-A-907)	Lubricating heated oxygen sensor thread cleaner when reconditioning exhaust system threads

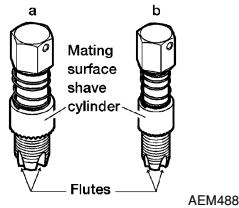

AEM488



AEM489

A  
EX  
C  
D  
E  
F  
G  
H  
I  
J  
K  
L  
M  
N  
O  
P

# EXHAUST SYSTEM

< SERVICE INFORMATION >

## EXHAUST SYSTEM

### Checking Exhaust System

INFOID:000000001703106

Check exhaust pipes, muffler and mounting for improper attachment, leaks, cracks, damage or deterioration.

- If necessary, repair or replace damaged parts.

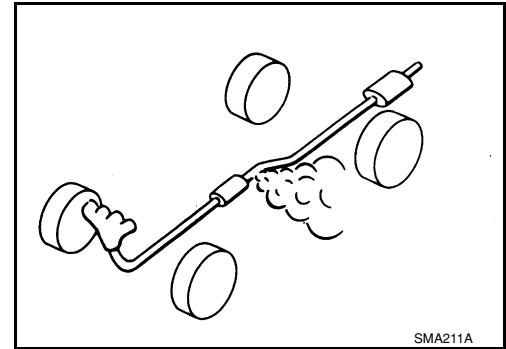

SMA211A

### Component

INFOID:000000001703107

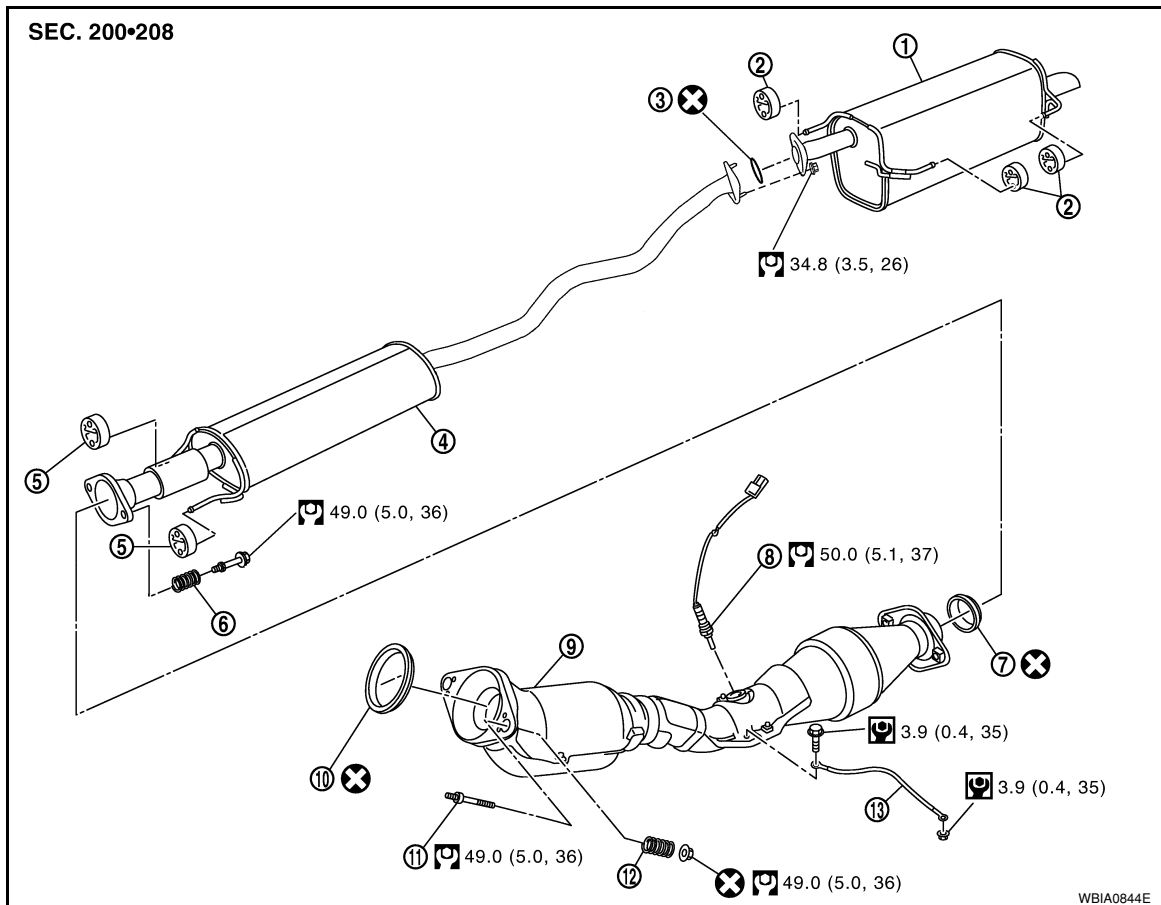

WBIA0844E

- |                   |                           |                       |
|-------------------|---------------------------|-----------------------|
| 1. Main muffler   | 2. Mounting rubber        | 3. Ring gasket        |
| 4. Center muffler | 5. Mounting rubber        | 6. Spring             |
| 7. Seal bearing   | 8. Heated oxygen sensor 2 | 9. Exhaust front tube |
| 10. Seal bearing  | 11. Stud bolt             | 12. Spring            |
| 13. Ground cable  |                           |                       |

### Removal and Installation

INFOID:000000001703108

#### REMOVAL

**CAUTION:**

# EXHAUST SYSTEM

## < SERVICE INFORMATION >

- Be sure to use genuine NISSAN exhaust system parts or equivalents which are specially designed for heat resistance, corrosion resistance and shape.
- Perform the operation with the exhaust system fully cooled down because the system will be hot just after the engine stops.
- Be careful not to cut your hand on heat insulator edge.

1. Disconnect harness connector of heated oxygen sensor 2.
  - Using Tool, remove heated oxygen sensor 2.

### CAUTION:

Be careful not to damage heated oxygen sensor 2.

Tool number : KV10114400 (J-38365)

2. Disconnect each joint and mounting rubber.

## INSTALLATION

Installation is in the reverse order of removal.

### CAUTION:

- Always replace exhaust gaskets and seal bearings with new ones when installing.
- Discard any heated oxygen sensor 2 which has been dropped from a height of more than 0.5 m (19.7 in) onto a hard surface such as a concrete floor; use a new one.
- Before installing a new heated oxygen sensor 2, clean exhaust system threads using the heated oxygen sensor thread cleaner and apply anti-seize lubricant (commercial service tool).
- Do not over tighten heated oxygen sensor 2. Doing so may cause damage to the heated oxygen sensor 2, resulting in the "MIL" coming on.
- Remove deposits from the sealing surface of each connection. Connect them securely to avoid exhaust leakage.
- Temporarily tighten nuts on the exhaust manifold side and bolts on the vehicle side. Check each part for unusual interference, and then tighten them to the specified torque.
- When installing each mounting rubber, avoid twisting or unusual extension in up/down and right/left directions.

### Exhaust Manifold to Exhaust Front Tube

1. Securely insert seal bearing (2) into exhaust manifold (1) side in the direction shown.
  - Exhaust front tube (5)

### CAUTION:

Be careful not to damage seal bearing surface when installing.

2. Install spring (3), tighten nut (4).
  - Be careful that the stud bolt nut does not interfere with the flanged area (←).
  - Make sure the spring (3) sits properly on the flange surface by aligning it to the locator dimples.

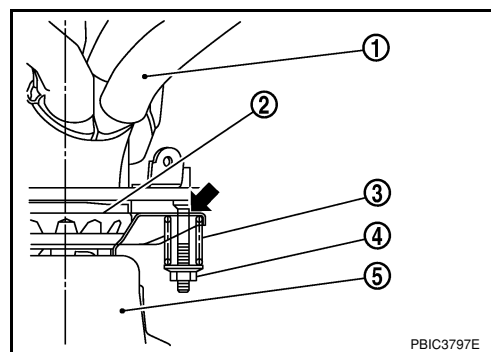

### Exhaust Front Tube to Center Muffler

1. Securely insert seal bearing (2) into exhaust front tube (1) side in the direction shown.
  - Center muffler (5)

### CAUTION:

Be careful not to damage seal bearing surface when installing.

2. With spring (3), tighten bolt (4).
  - Be careful that the stud bolt does not interfere with the flanged area (←).
  - Make sure the spring (3) sits properly on the flange surface by aligning it to the locator dimples.

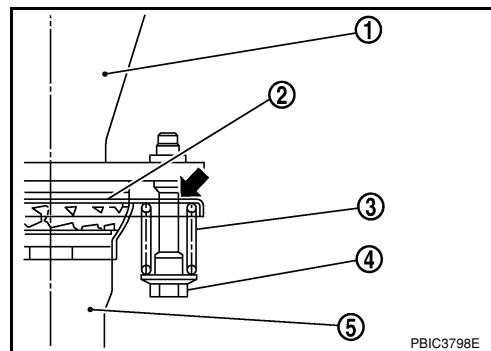

## INSPECTION AFTER INSTALLATION

- With the engine running, check exhaust tube joints for exhaust leakage and unusual noise.
- Check to ensure that brackets and mounting rubbers are installed properly and free from undue stress. Improper installation could result in excessive noise and vibration.